

**PAVONE SIDE POST  
ASSEMBLY INSTRUCTIONS**

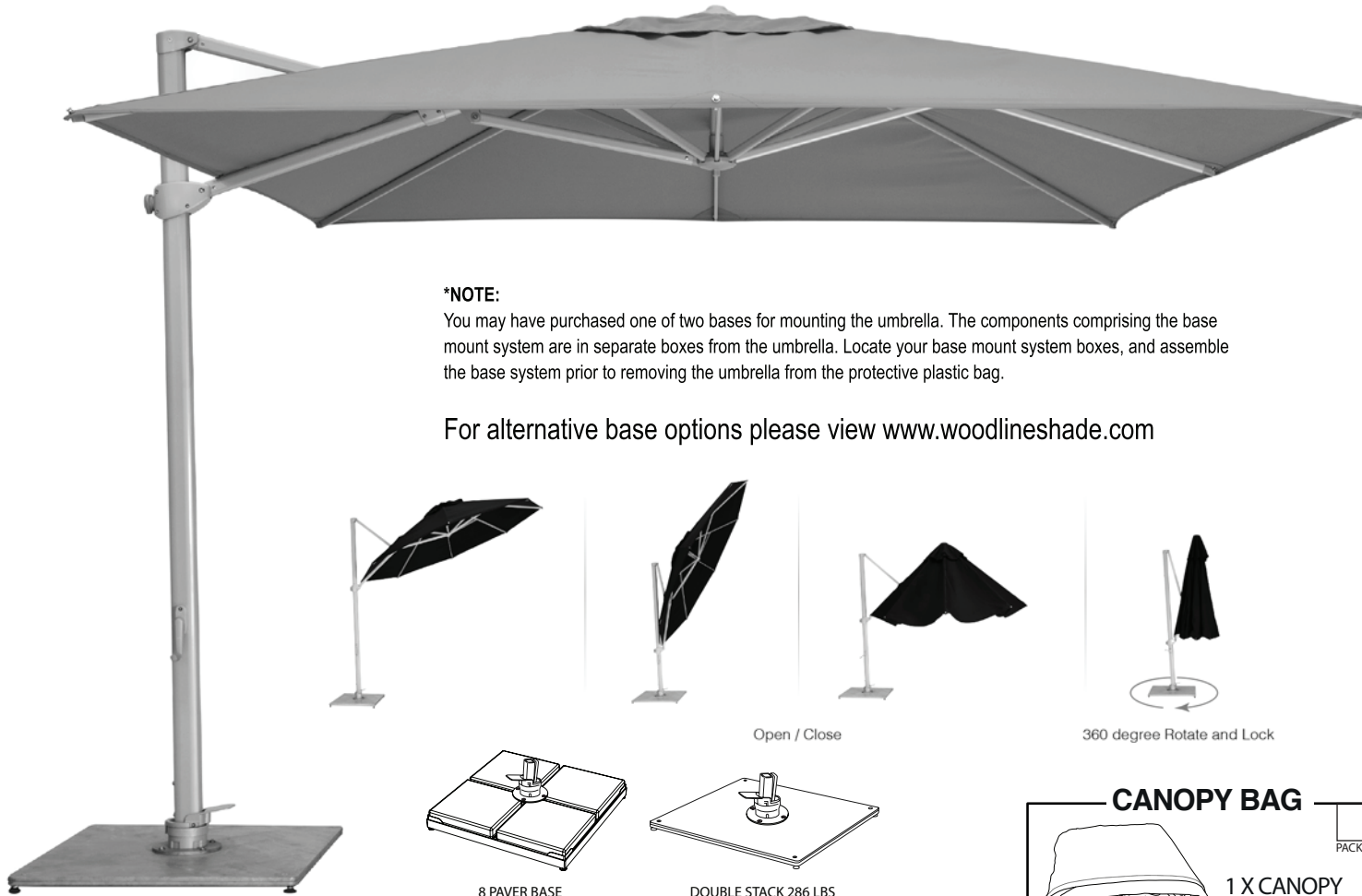

**\*NOTE:**

You may have purchased one of two bases for mounting the umbrella. The components comprising the base mount system are in separate boxes from the umbrella. Locate your base mount system boxes, and assemble the base system prior to removing the umbrella from the protective plastic bag.

For alternative base options please view [www.woodlineshade.com](http://www.woodlineshade.com)

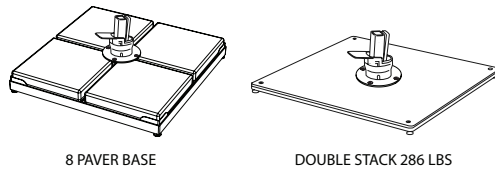
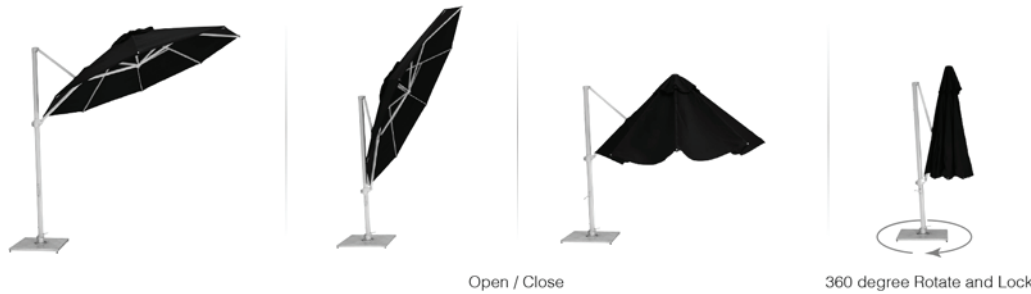

PACKED BY: \_\_\_\_\_ DATE: \_\_\_\_\_

CHECKED BY: \_\_\_\_\_ DATE: \_\_\_\_\_

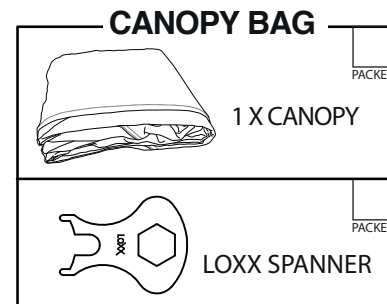

**SUPPLIED PARTS**

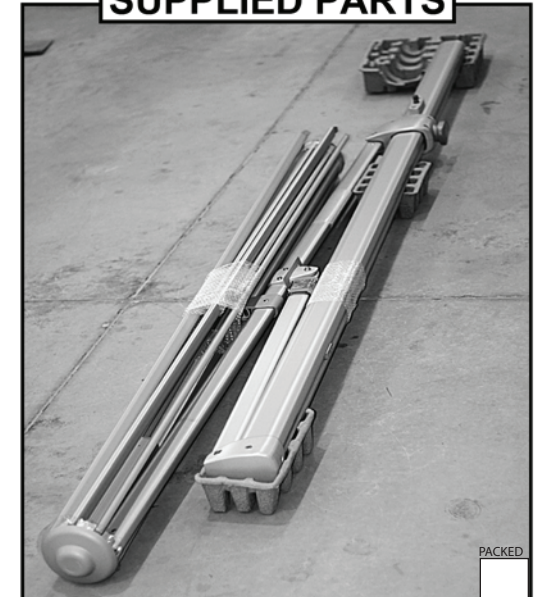

1 X UMBRELLA POST AND CANOPY STRUCTURE UNIT

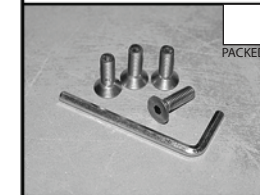

4 X COUNTERSUNK SCREWS  
M8 X 25MM + 1 X 6MM ALLEN KEY

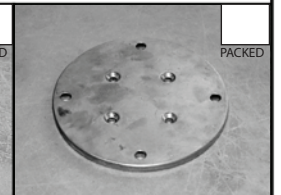

1 X ADAPTER PLATE

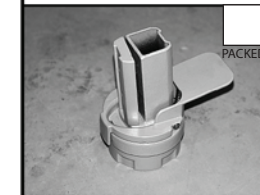

1 X FOOT PEDAL

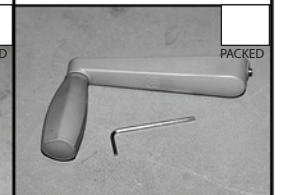

1 X CRANK HANDLE  
+ 1 X 2.5MM ALLEN KEY



2 X PAN HEAD SCREWS  
+ 6MM ALLEN KEY



1 X COVER BAG  
+ 1 X COVER STICK

## ASSEMBLING UMBRELLA STRUCTURE TO THE BASE:

1) Remove the individual parts from the packaging and locate the adapter plate and foot pedal. Using the supplied 5mm allen key, attach the adapter plate to the underside of the foot pedal with the 4 x M8 x 25mm screws, hand tightening to ensure a solid fit.

Connect the foot pedal and adapter plate to the base (supplied separately) using the 4 x M10 x 25mm dome head screws (supplied with the base) and tighten using the supplied 6mm allen key.

Raise the umbrella structure and slide it over the foot pedal mast, ensuring the canopy side of the structure is pointing in the same direction as the foot pedal.

2) Join the umbrella pole and foot pedal mast together using the 2 x pan head screws M8 x 25mm and hand tighten until they are securely connected to each other.

3) Attach the crank handle to the umbrella pole using the supplied 2.5mm allen key.

4) Loosen the hand wheel on the sliding arm, then turn the crank clockwise to fully extend the canopy.

Adjust your canopy to the preferred angle by manually pushing up the sliding arm mechanism.

5) By pressing on the foot pedal adapter the umbrella can be rotated to the required position.



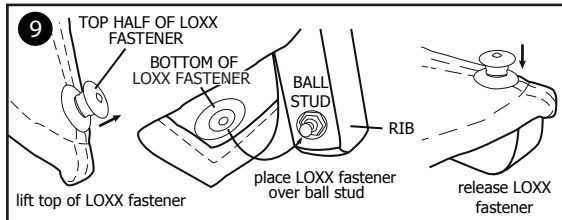
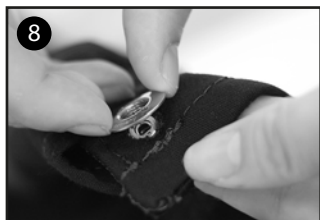
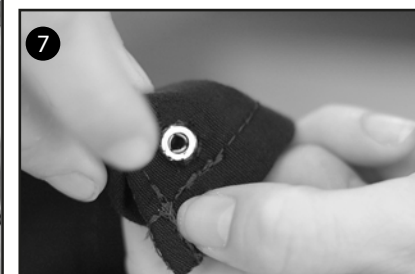
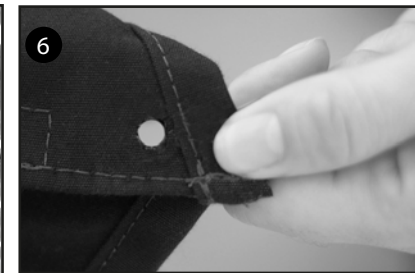
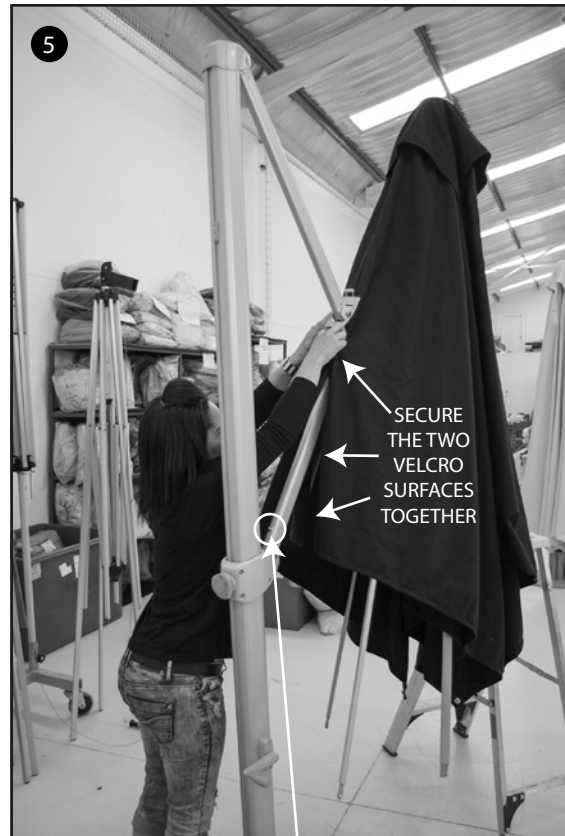

**ATTACHING THE CANOPY:**

1) Using a step ladder, lift the fabric of the canopy up and over the canopy structure.

2) Align the top hole with the cap thread and then place the plastic cap down in position.

3) Screw the cap firmly in place to secure the top of the canopy to the structure.

4) Slide the canopy down over the structure as indicated.

5) Secure the two velcro surfaces all the way down to close the fabric over the sliding arm.

6) Align the holes in the fabric.

7) Insert LOXX fastener through hole ensuring fabric does not interfere with the thread of the LOXX fastener.

8) Screw LOXX washer from underneath and tighten washer securely with LOXX key.

9) To attach the canopy to the umbrella structure use your fingers to pull the top half of the newly fitted LOXX fastener up then place it onto the ball stud that is fitted to the base of the sliding arm and release to attach. You can then attach the canopy ends to the rib ends using the same process until all 8 corners are attached.

## CANOPY FOLDING INSTRUCTIONS

- 1 In order to avoid the canopy fabric from being jammed between the frame components, it is important to pull the fabric out from the umbrella structure by putting a finger under the edge of the canopy and pulling the fabric outwards. Do this for all the panels and fold the panels over each other like you would with a hand-held umbrella.
- 2 Tie the canopy strap tightly otherwise the canopy can move in wind conditions and get damaged through rubbing.
- 3 Place cover bag over umbrella for extra protection to prolong the life and preserve the color of the canopy.
- 4 For extra protection always ensure your umbrella is in a dry condition before closing and applying the cover bag.

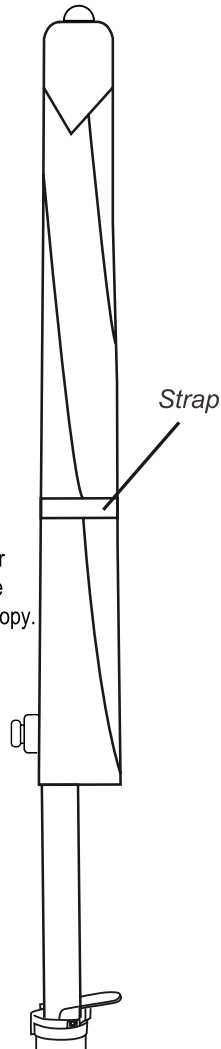

## HOW TO FIT YOUR COVER BAG CORRECTLY

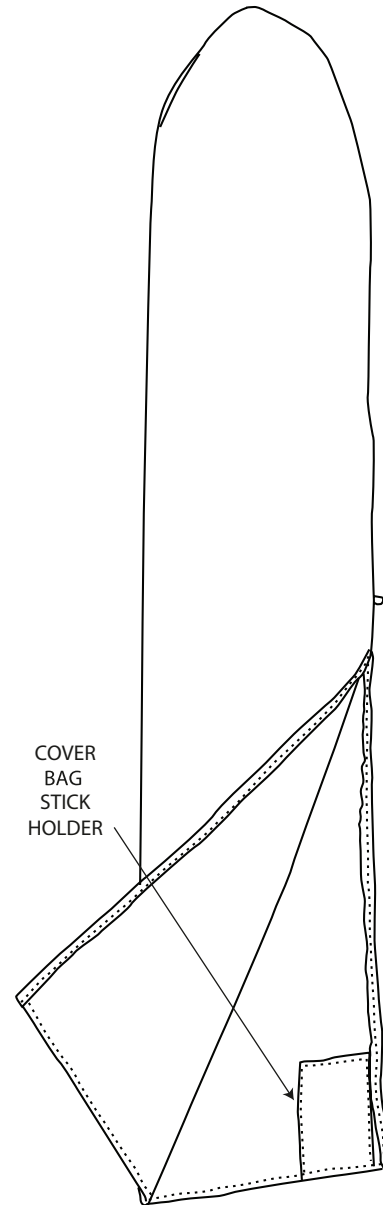

- 1 Lay out the cover bag flat on a table with the zip totally opened.

↑  
open zip all the way to the top



- 2 Insert the supplied cover bag stick into the bag all the way to the top, lift up the cover bag vertically and place it gently up and over the top of your closed umbrella so that it covers both pole and umbrella.

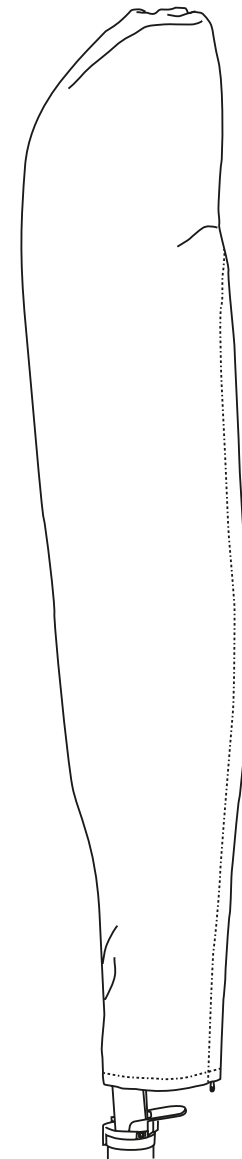

- 3 Lower it into position and zip it closed completely. The cover stick can be placed into its holder for safe keeping.

# woodline

## shade solutions

### PAVONE SIDE POST CORRECT PLACEMENT

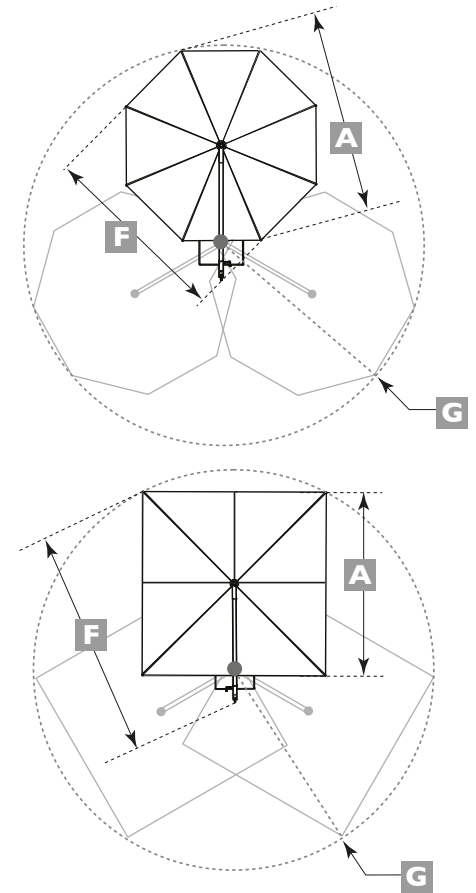
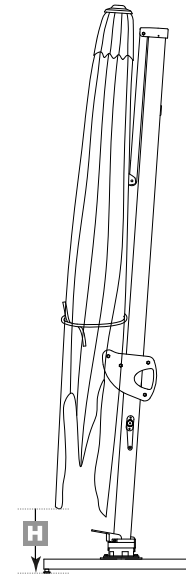
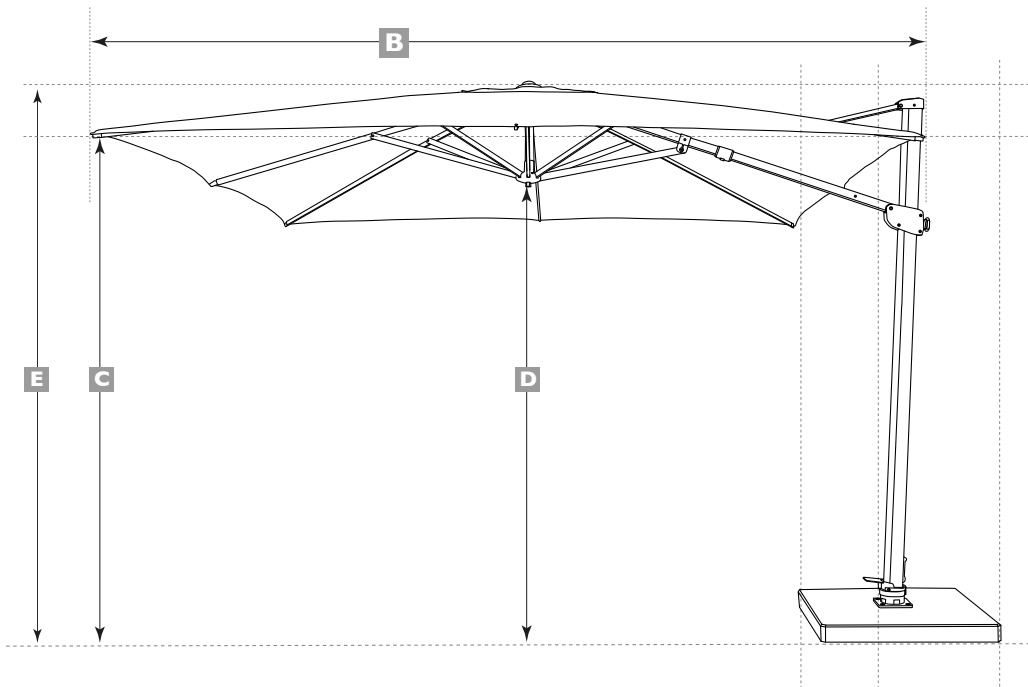

- A** Canopy size:  
Round – size is measured from tip to tip through the center  
Square – size is measured from tip to tip on one side
- B** Back of pulley to front of canopy
- C** Head clearance from arm tip
- D** Head clearance below hub
- E** Overall height
- F** Maximum distance between ends
- G\*** Rotation point to farthest arm tip
- H** Distance from arm tip to ground
- Rotation point, 360 degrees

model	shape	A (size)	B	C	D	E	F	G*	H
PA35RA	Round 8 arms & struts	11'5" 3,5m	11'7" 3,57m	7'1" 2,17m	6'6" 1,97m	8'10" 2,70m	11" 3,35m	9'3" 2,81m	3'1" 0,94m
PA30SA	Square 8 arms & struts	10'0" 3,0m	11' 3,35m	6'11" 2,10m	6'6" 1,97m	8'10" 2,70m	11'11" 3,63m	10'3" 3,12m	1'11" 0,60m

\*This is distance measured from the pivot point to the farthest distance from this point on the umbrella. The distance defines the radius of the circle created as the umbrella rotates 360 degrees.

All vertical measurements are taken from the ground level and include the paver base, including free-standing base (2-1/3" height). All imperial measurements have been converted from metric and are rounded to the nearest inch. For exact dimensions refer to metric measurements.

## CARE AND MAINTENANCE

Every Woodline shade solution is meticulously engineered to maximize not just their form and functions, but also to make sure that they outlast even the harshest conditions. Each item is crafted from the finest marine grade weather-resistant materials, specifically selected for their ability to endure. Though our shade solutions are built to last, the relentless and extreme nature of the outdoors dictates that proper care and maintenance will always extend the lifespan of any item.

### FRAMES

Constructed from the finest quality aluminum, high grade stainless steel and durable and sustainable eucalyptus timber. Our frames have been tested in some of the world's most inhospitable environments and have only ever benefited from the appropriate application of caution and common sense in excessive wind conditions.

We advocate the use of our cover bags to prolong the life of the canopy frames and their covering fabrics. We recommend the closure and safe storage of any collapsible and removable components when the parasol is not in use or when winds are expected to exceed 24.8 mph (40 km/h).

### WOODEN COMPONENTS

We only use sustainable eucalyptus timber hand-picked for its strength, weather-resistance, and replenishment efficiency from the world's finest FSC-accredited plantations and timber mills. Our wooden components are treated with marine yacht varnish to fortify them for outdoor living.

We recommend the periodic care of wooden components with a light sanding and reapplication of the varnish coating once a year to maintain the natural beauty of the wood.



### FITTINGS

All fittings, nuts, bolts, pulleys and cleat components are made with high grade stainless steel and weatherproof nylon. Maintaining these fittings and components is imperative to the longevity and the proper operation of the shade system. A simple occasional fresh water rinsing will help keep them working well and looking good.

### BASES

It is essential to pick the right base for your parasol, talk to our sales team to ensure that the parasol you choose has the appropriate base to keep it anchored properly.

### FABRICS

Our canopies and fabric covers are made from the most durable, colorfast, and dirt-repellent fabrics in the world. That said, proper care such as storage when not in use and cleaning from time to time will undoubtedly extend their lifespan.



UV RESISTANT



WATER/STAIN RESISTANT



BREATHABLE



MOLD RESISTANT



EASY CARE



PROTECTS FROM UV

### WIND GUIDELINES

\*The umbrella should always be closed during very windy conditions. As with all umbrellas, common sense wind guidelines prevail: if it is too windy to enjoy sitting outside under the umbrella, the umbrella structure should be lowered, folded and secured with the strap.

\*When unattended, the umbrella structure should always be left in the closed position with the canopy folded properly, securely strapped with the cover bag placed over the umbrella.

\*The umbrella structure must always be lowered, properly folded and strapped during heavy rains, thunderstorms, hail or any other severe weather conditions. Always anticipate to give time to properly fold the canopy, as during severe conditions if not folded properly, the fabric may become damaged.

\*If very extreme weather conditions are anticipated, the umbrella structure should first be lowered, folded properly, strapped and placed in the cover bag. Then the entire umbrella structure should be removed from the base and stored in a clean, dry location.

[www.woodlineshade.com](http://www.woodlineshade.com) | +1 848 266 0800