

Instructions

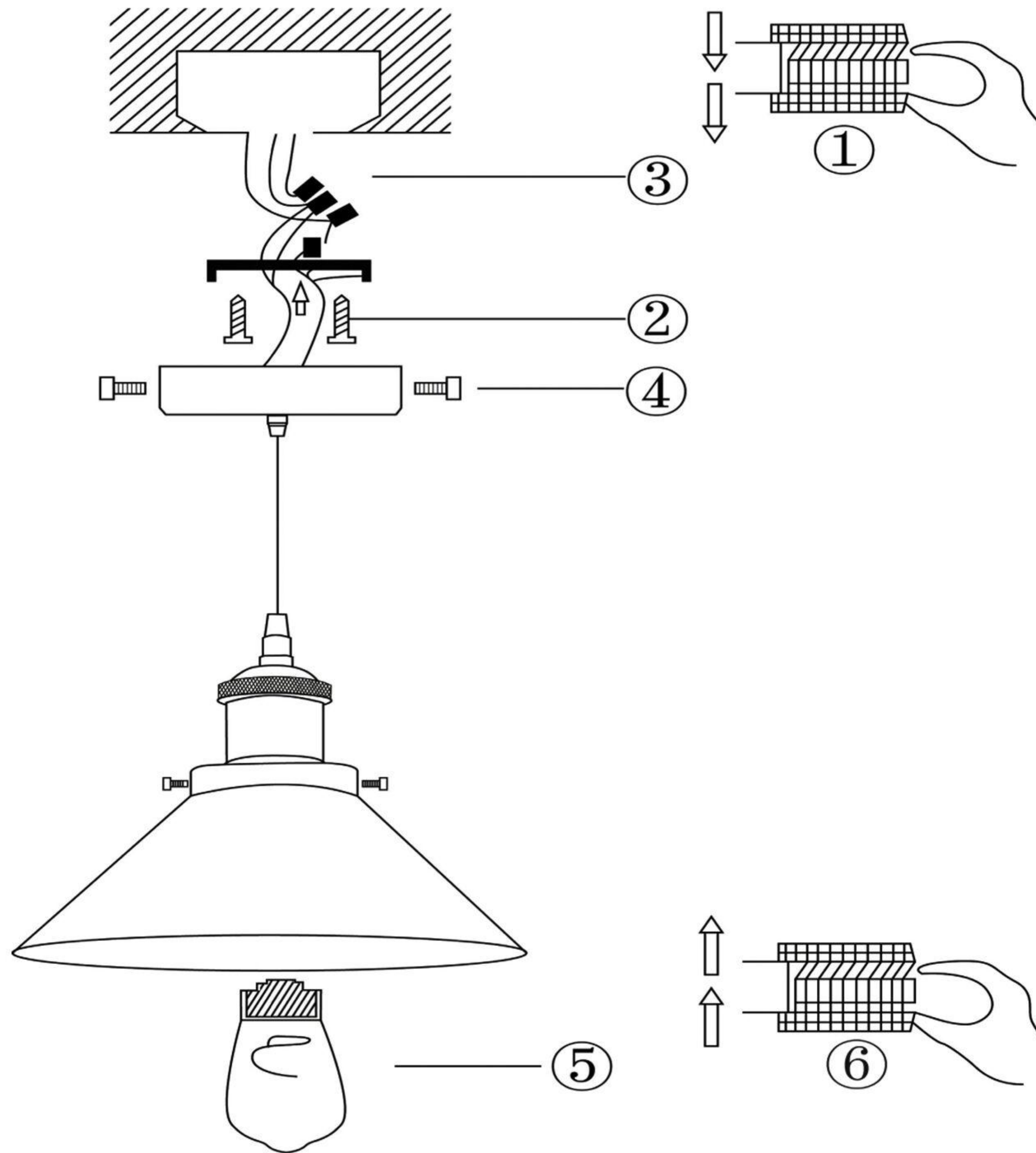

If you have any questions about how to assemble the ceiling canopy and the lampshade, please check our listing pictures.

1. Please turn off the power switch before installation.
2. Tightening the screws to hold the bracket to the box.
3. Connecting the Live-wire, Neutral-wire and Earth-wire.
4. Locking the screws to fix ceiling canopy.
5. Install the perfect bulb into lamp socket.
6. Turn on the power switch and check if it's well-work.