

# 使用指南

## Usage and Maintenance Instructions

### 所需工具 (Tools Required)

- .钻头 (Drill)
- .锤子 (Hammer)
- .十字螺丝刀 (Cross screwdriver)



### 准备工作 (Before Installation)

为了您的安全，我们建议您在安装前采取以下保护措施。

For your safety, we recommend that you take the following protective measures before installation.

- .防护手套(Protective gloves)
- .防护眼镜(Protective glasses)
- .防护鞋(Protective shoes)
- .防护服(Protective clothing)

### 注意事项 (Precautions)

- 1.产品必须安装在有承重能力的墙上，并用我们配套的螺丝安装在合适的位置。  
1. The product must be wall withad beacity andinsalledin without matching screws.
- 2.安装前请检查所有产品及配件件否齐全、完好。如果缺失或损坏，请联系我们，请勿继续使用。  
2.Please check whether all products and accessories are complete and intact before ion. ffins accessories are missing or damaged, please contact us and do not use damaged products or accessories
- 3.在确定折叠凳的位置时，请检查墙内是否有暗管。  
3. When determining the position of the folding stool, please check whether there is a hidden tube in the wall.

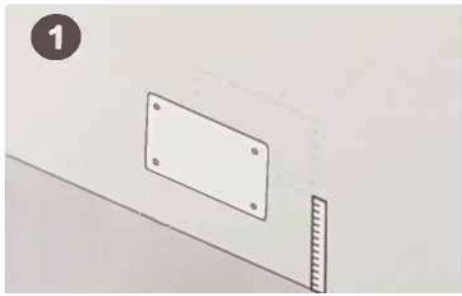

1.测量距离并将定位卡贴在墙上  
1.Measure the height from the ground and stick it on the wall.

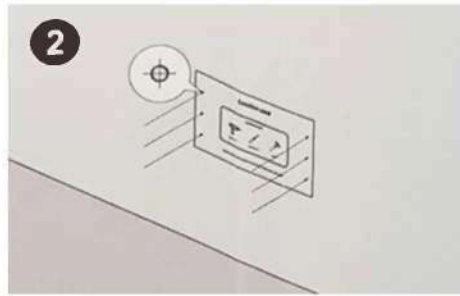

2.在定位卡的标记点上钻孔  
2. Drill holes at the positioning points on the template.

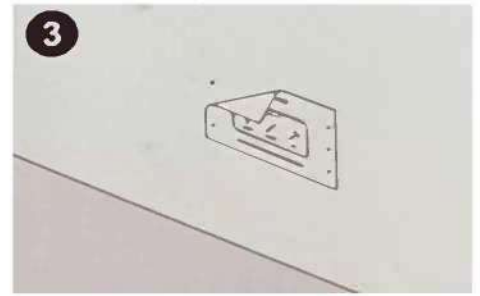

3.撕掉定位卡  
3. Remove the template.

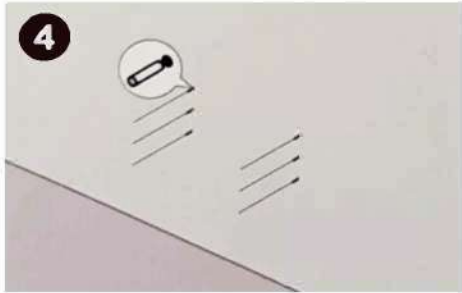

4. 插入膨胀螺栓，使它与墙壁齐平  
4. Insert the expansion bolt so that it is flush with the wall.

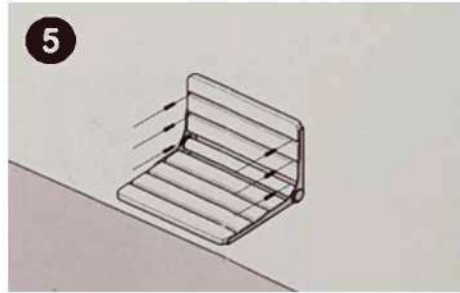

5.对准孔洞并拧紧螺钉  
5. Align the holes and tighten the screws.

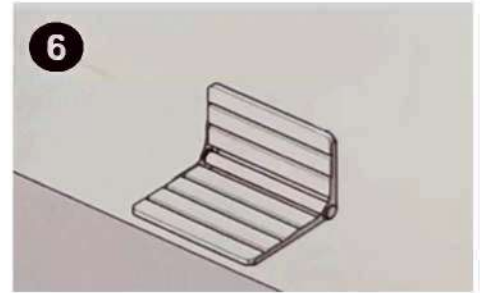

6.完成  
6.Enjoy!~

## 安全注意事项 (Important Safety Instructions)

—使用前检查墙壁螺丝是否拧紧。

- Check that the wall screws are tight before use.

不使用时将座椅折叠起来，以免走入其中造成损坏。

- Fold the seat when not in use to avoid walking into it and causing damage.

产品要远离高温。

Keep the product away from high temperatures.

—建议儿童、老人和残疾人在使用座椅时有人看管。

- It is recommended that children, the elderly and disabled people are supervised when using the seat.

— 请勿将本产品用作承重物。

- Do not use this product as a load-bearing object.

## 保养须知(Maintenance instructions)

1.使用完产品后，及时用干燥毛巾清理表面残留水渍，并将座椅折叠靠墙。

1.After using the product, in time with a dry towel to clean the residual water stains on the surface, and the seat against the wall.

2.定期检查产品是否松动，如发现松动可自行旋紧两侧螺丝至紧配程度。

2.Regularly check whether the product is loose. If it is found to be loose, you can tighten the screws on both sides to the tightness.