

400 Lumen LED Porch Light

Instructions and Installation

CAUTION: REMOVING ANY SCREWS FROM THE UNIT WILL VOID YOUR WARRANTY!

Features & General Information

The Porch Light is completely weatherproof and can safely be mounted outdoors without special tools. It works great indoors too!

This light operates by sensor only. It does not have an on/off switch. The built-in motion sensor automatically turns on the light when a moving heat source is detected. The light comes on for approximately 45 seconds and remains on as long as motion continues to be detected in the area. The Porch Light also has a built-in photo sensor which prevents the light from being activated during daylight hours.

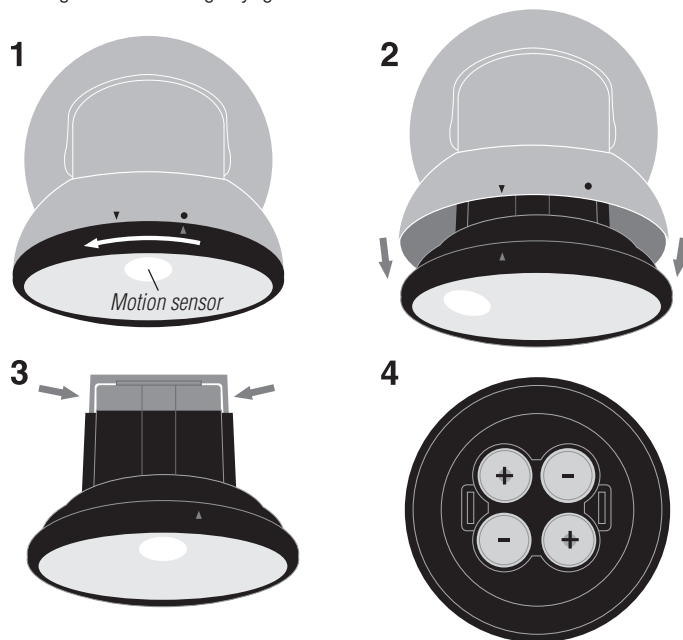

Battery Installation

- 1 To access the battery compartment, grasp the black circular frame of the LED panel and turn it counter-clockwise until it releases
- 2 Remove the panel and the battery housing from the body of the light.
- 3 Squeeze the tabs on the side of the battery cover to open it.
- 4 Install 4 D batteries noting the polarity symbols on the battery compartment.
- 5 Replace the battery cover and place the light head back into the body of the light, turning it clockwise, until the arrow aligns with the dot to seal.

Selecting Location

The Porch Light sensor detects both heat and motion. It has a maximum detection distance of 25 feet with a 100 degree angle. To ensure reliable detection, the Porch Light should be installed at a height between 6 to 8 feet. Whenever possible it should be installed at least 30 feet away from the street or in a shielded area to prevent activation by cars, pedestrians or animals.

Please note the following conditions may cause false activation or erratic operation:

Heat sources (barbeques, air conditioners, or exhaust vents)

Reflective surfaces (pools, ponds or light colored walls)

Shaded areas

External light sources such as street lights

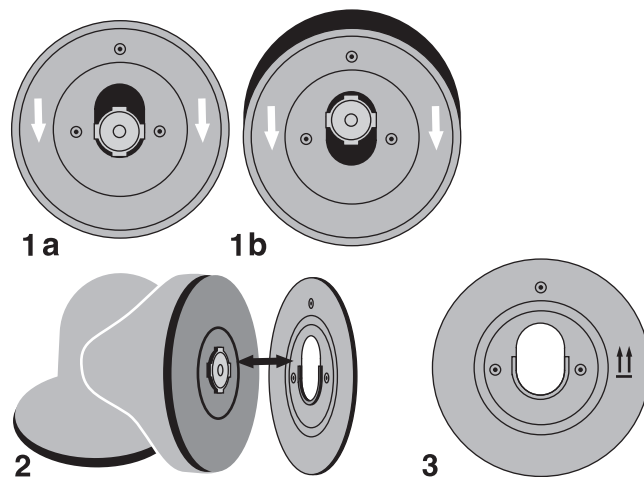

Installing The Light

1ab Slide the mounting plate off the back of the Porch Light as shown in the illustrations above. *Do not remove any of the screws on the back of the Porch Light.*

2 Remove the Porch Light from the mounting plate.

3 Making sure that the  arrows on the mounting plate are visible and pointed upwards, securely fasten it to the wall or other stable surface using 3 wood screws (included). *Please note that it is generally recommended to drill pilot holes prior to fastening the screws. In some cases, special fasteners for surfaces such as drywall, cement or brick may be required.*

4 Reattach the Porch Light to the mounting plate. Adjust the light and sensor as needed by swiveling it on the mounting plate and/or tilting the light head.

ATTENTION

To avoid damage to the electrical components, please observe the following precautions:

- Do not mix battery types
- Do not aim the sensor directly towards the sun.
- Do not shake or drop the light.
- Do not expose the light to static electricity.
- Please note that the light circuit requires 90 seconds to stabilize after the batteries are inserted.

TROUBLESHOOTING

Light will not turn off

If the light does not turn off after battery installation and initial circuitry set, we recommend testing it by placing it in dark room away from any possible heat and light sources. If operating normally, the light should turn off after 30-45 seconds if no motion is present.

Light will not turn on

Photo sensor only allows operation in low light.

Check to make certain your batteries are fresh.

Check the alignment (polarity) of the batteries.

Check to make certain that the battery cover has been properly installed.

Temporarily Deactivating the Light

Pivot the light head upward so that it cannot detect motion below.

SPECIFICATIONS

Batteries: 4 D cell alkaline or Ni-mh

Battery Life: 6 months to one year depending on the frequency of activation.

Voltage: 6V DC

Light Output: 400 Lumens

Color Temperature: 6,000 Kelvin

Light Duration: 30 - 45 sec, remains on if motion is detected

Detection Angle: 100° cone

Max Detection Distance: 25 feet