

①canopy 1PCS



②hanging tube 4PCS



③light fixture 1PCS

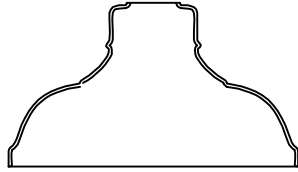

④glass lampshade 1PCS

⌘ X 3pcs ⌘ X 4pcs

⌘ X 4pcs ⌘ X 3pcs

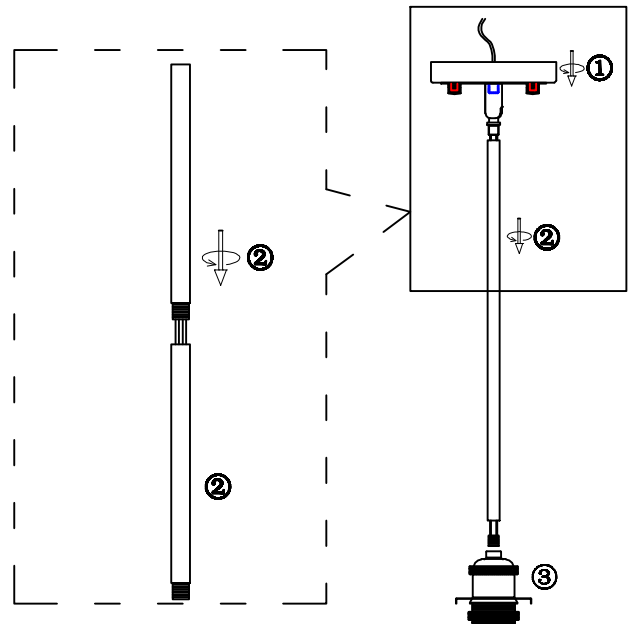

1. Let the wire go through the hanging tube ② and canopy ①, rotate to install the tube ② and canopy ② to the fixture ③, can connect more tubes to get the height you need.

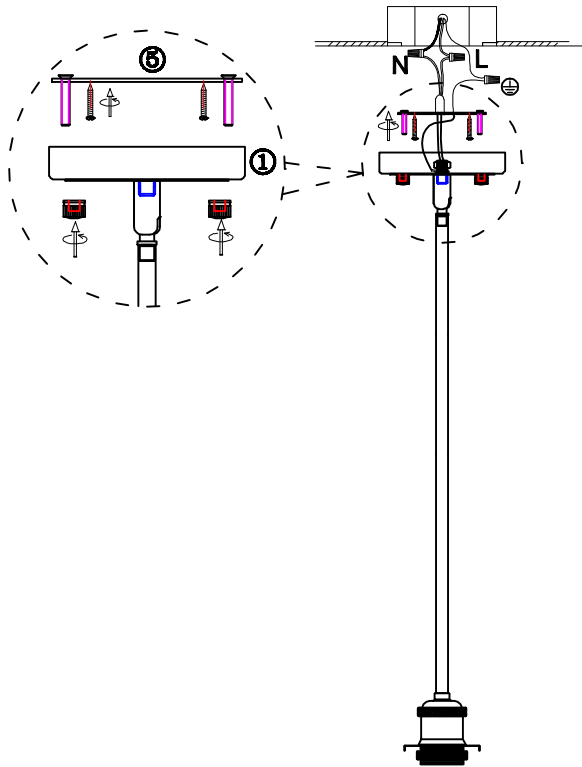

2. Install the bracket to the ceiling junction box with screw.
3. Connect the wires to your home line with cap connectors.
4. Install the canopy ① to the bracket with cap nuts.

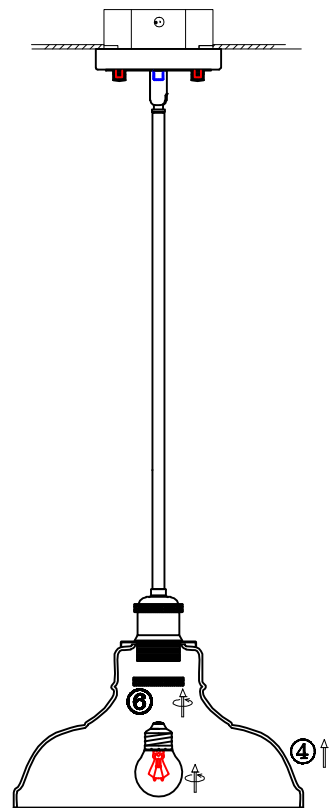

5. Install the lampshade to the fixture with socket ring.
6. Install the bulb.

Please read carefully before installation!!!

**Note : Please make sure that the electricity is powered off during installation!
Only a professional electrician should install this kind of product!**