

ASSEMBLY INSTRUCTION

ITEM: N715P206946

DINING TABLE

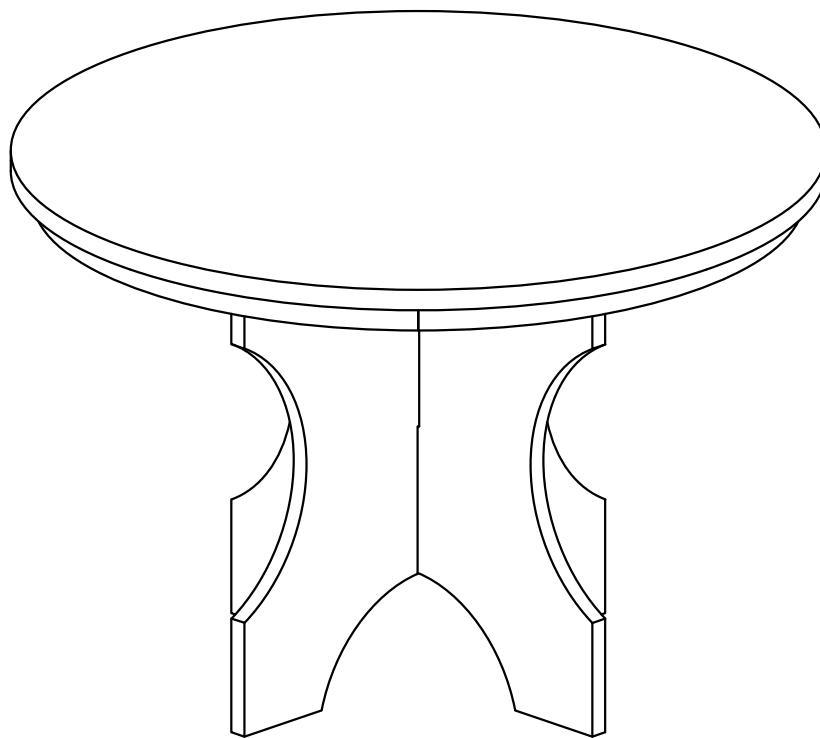

IMPORTANT NOTE :

Please read these instructions fully before starting assembly:

1. Place all wooden parts on a clean and smooth surface such as a rug or carpet to avoid scratching the parts.
2. Kindly follow the assembly instructions step by step.
3. Do not tighten all screws and bolts until the table is fully assembled.
4. Unscrew the protective plastique supports from the metal insert of the table legs before assembly.
5. Parts of the assembly will be easier with 2 people.

Care and maintenance:

Only clean using a damp cloth and mild detergent, do no use bleach or abrasive cleaners.

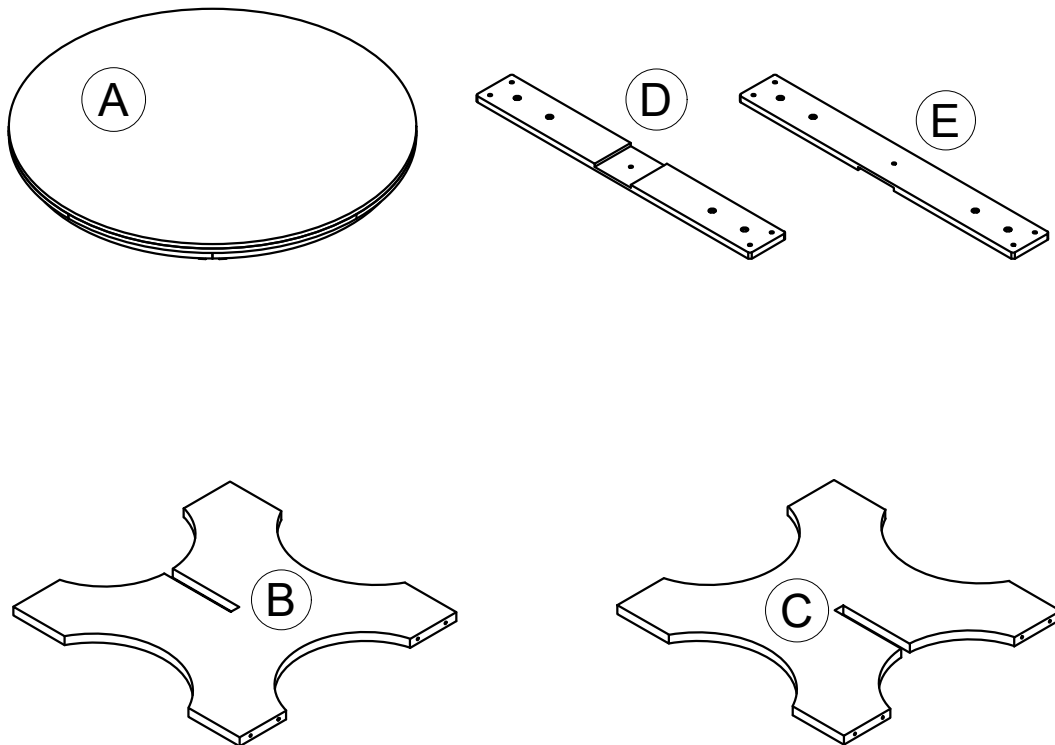

PART AND HARDWARE LIST

Part List For One

Hardware List For One

Ⓐ

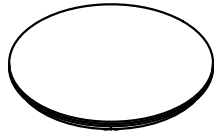
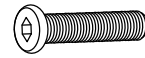

TABLE TOP (1 pc)

①



Ø1/4" x 30mm

BOLT (17 pcs)

Ⓑ

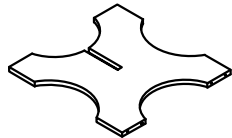

LEG (1 pc)

②

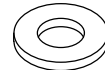

Ø1/4" x 19mm

FLAT WASHER (9 pcs)

Ⓒ

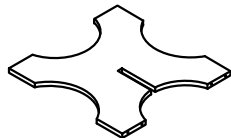

LEG (1 pc)

③



Ø1/4" x 13mm

LOCK WASHER (9 pcs)

Ⓓ

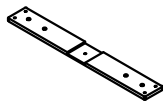

CONNECT RAIL (1 pc)

④



M4 x 60mm

ALLEN KEY (1 pc)

Ⓔ

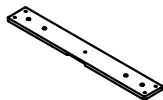

CONNECT RAIL (1 pc)

ASSEMBLY INSTRUCTION

ITEM: N715P206946

STEP 1:

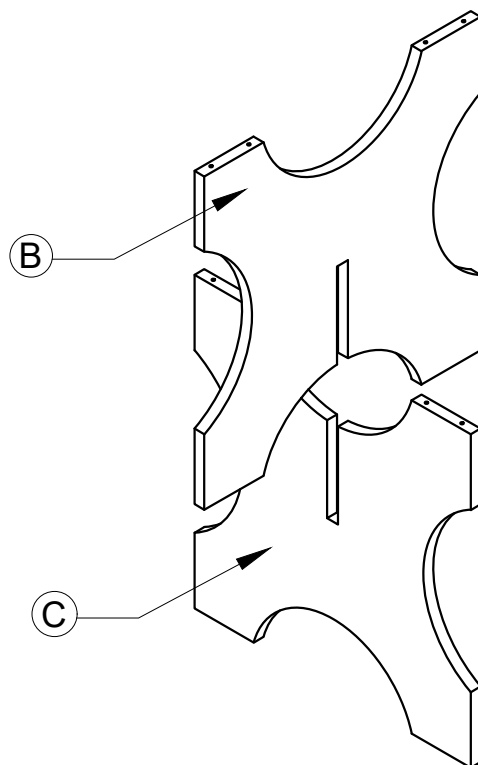

STEP 2:

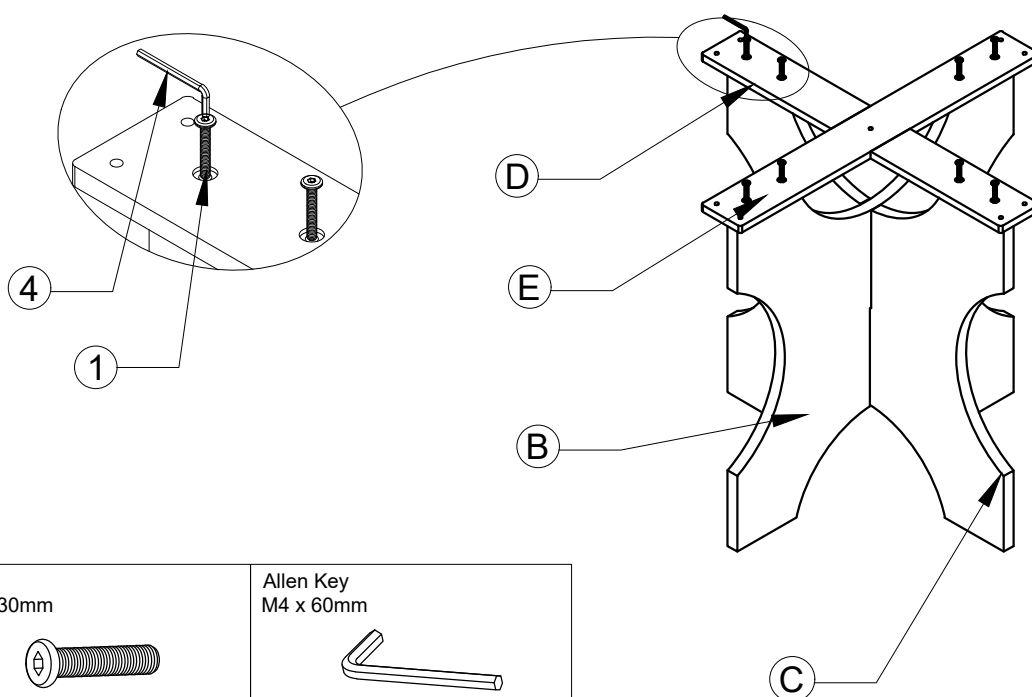

Bolts
1/4" x 30mm

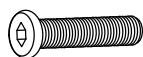

① x 8

Allen Key
M4 x 60mm



④ x 1

MADE IN VIETNAM

PAGE 4 OF 6

ASSEMBLY INSTRUCTION

ITEM: N715P206946

STEP 3:

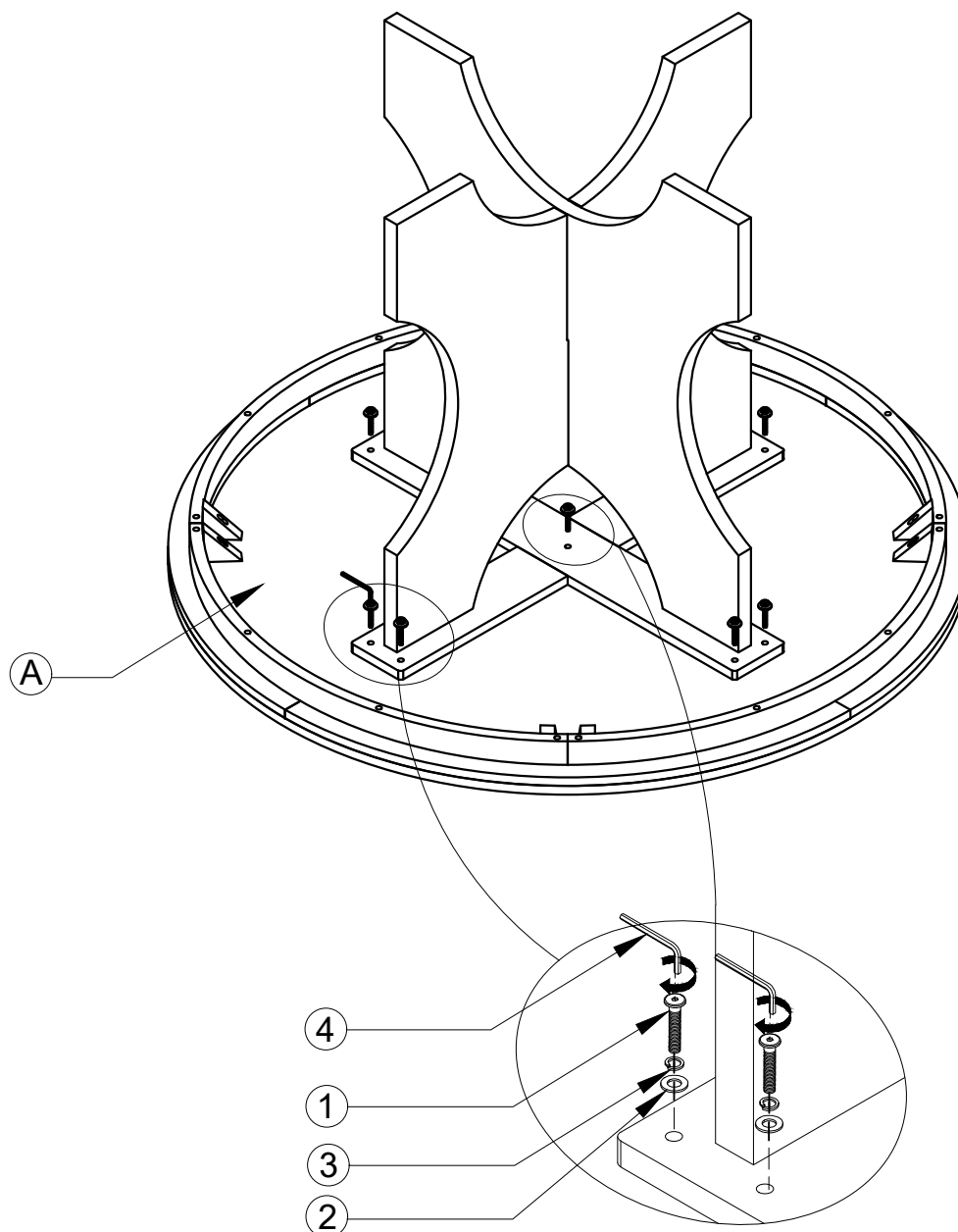

Bolts
1/4" x 30mm

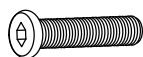

① x 9

Flat Washer
1/4" x 19mm



② x 9

Lock Washer
1/4" x 13mm



③ x 9

Allen Key
M4 x 60mm



④ x 1

MADE IN VIETNAM

PAGE 5 OF 6

ASSEMBLY INSTRUCTION

ITEM: N715P206946

COMPLETE

