

**Caution:** This instruction manual is intended for universal reference, slight variations in part dimensions are normal.

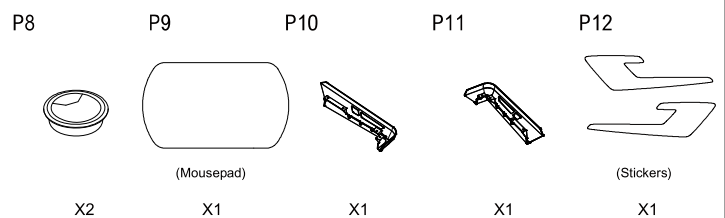

## COMPONENT

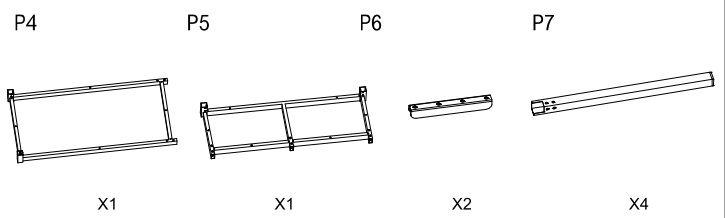
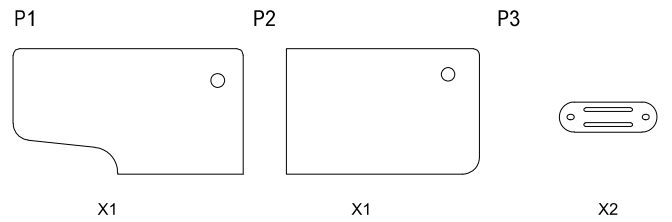
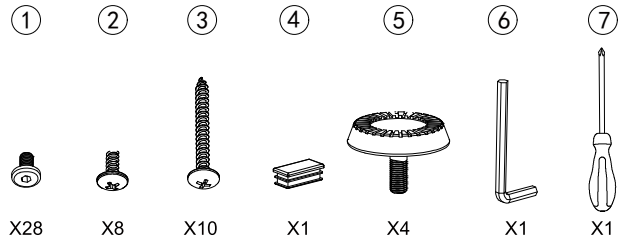

## 1-R

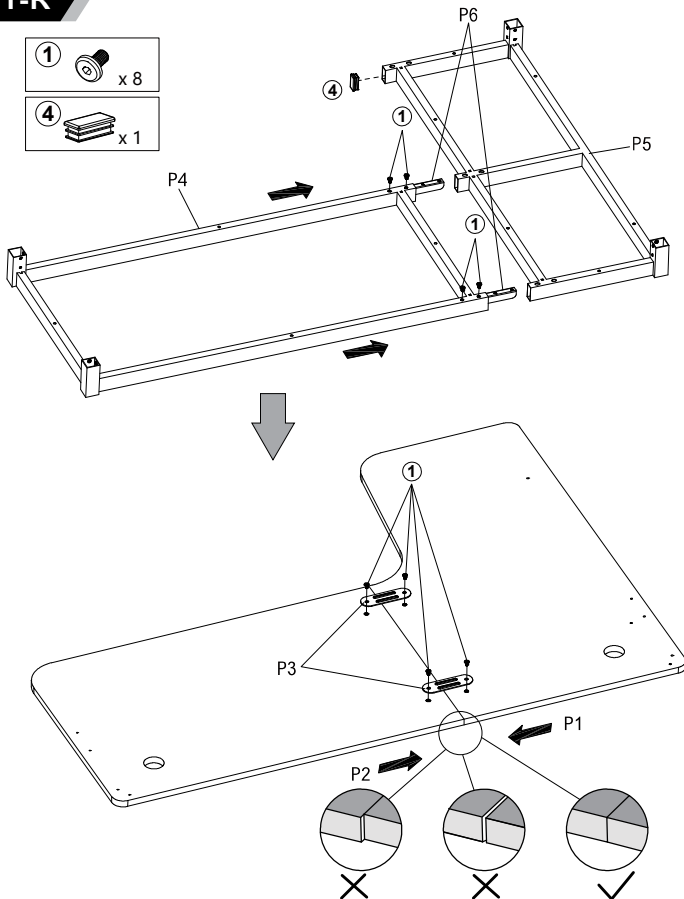

**!** Before tightening the screws, you must ensure that the two desktop pieces are aligned and flush against each other.

## 1-L

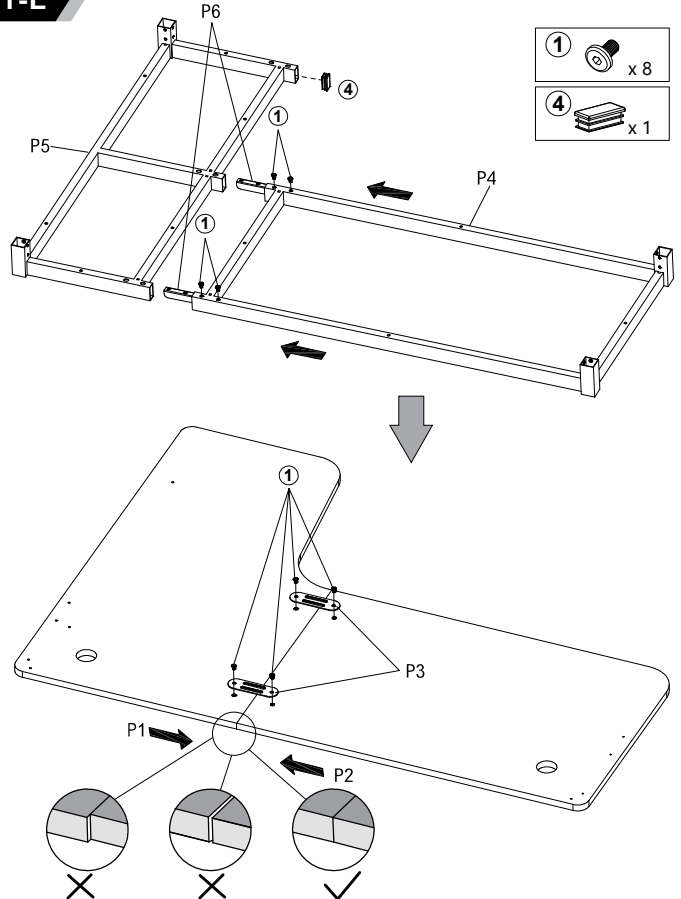

**!** Before tightening the screws, you must ensure that the two desktop pieces are aligned and flush against each other.

2

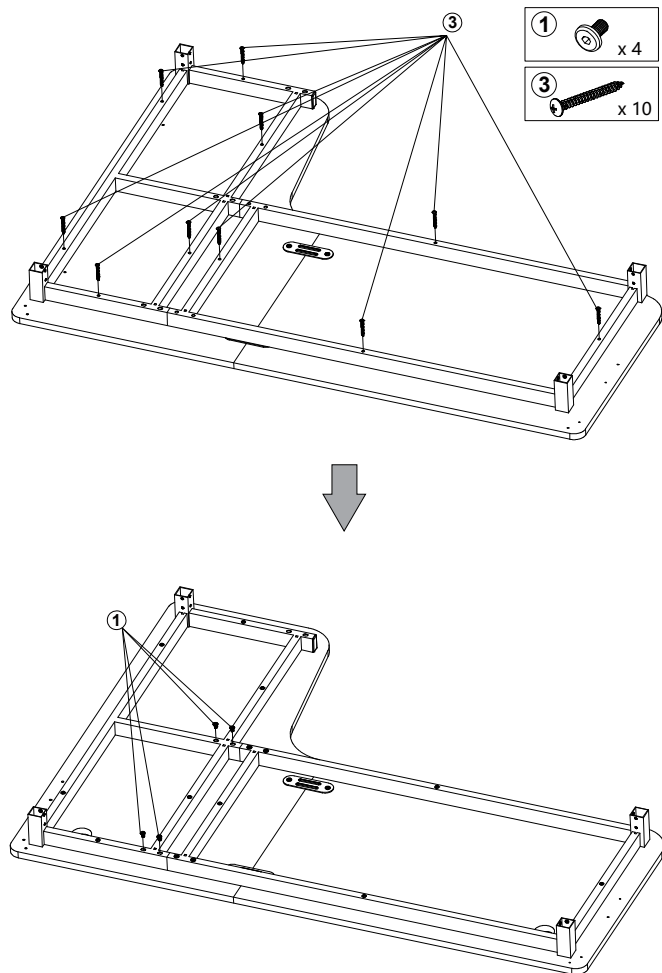

3

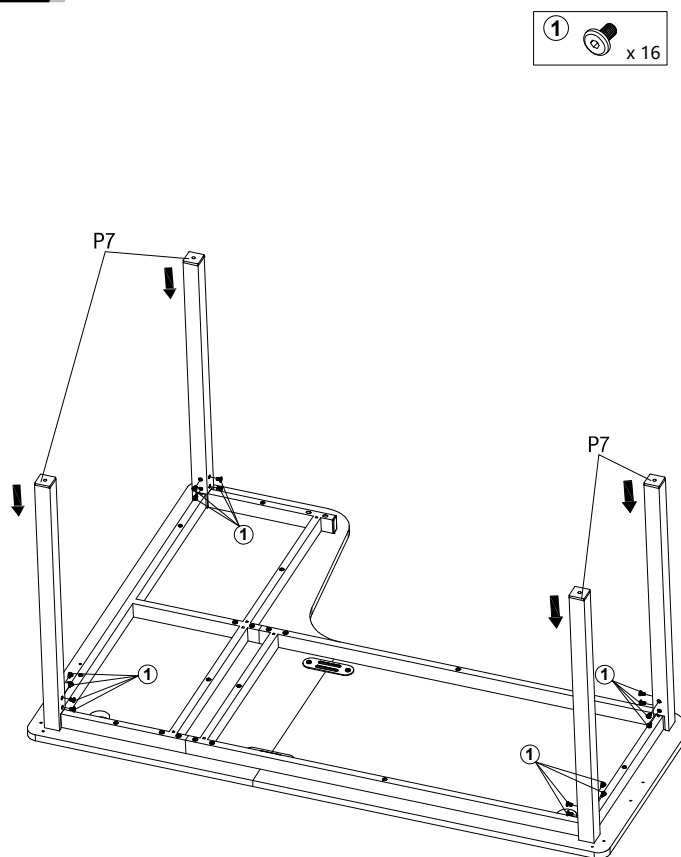

4

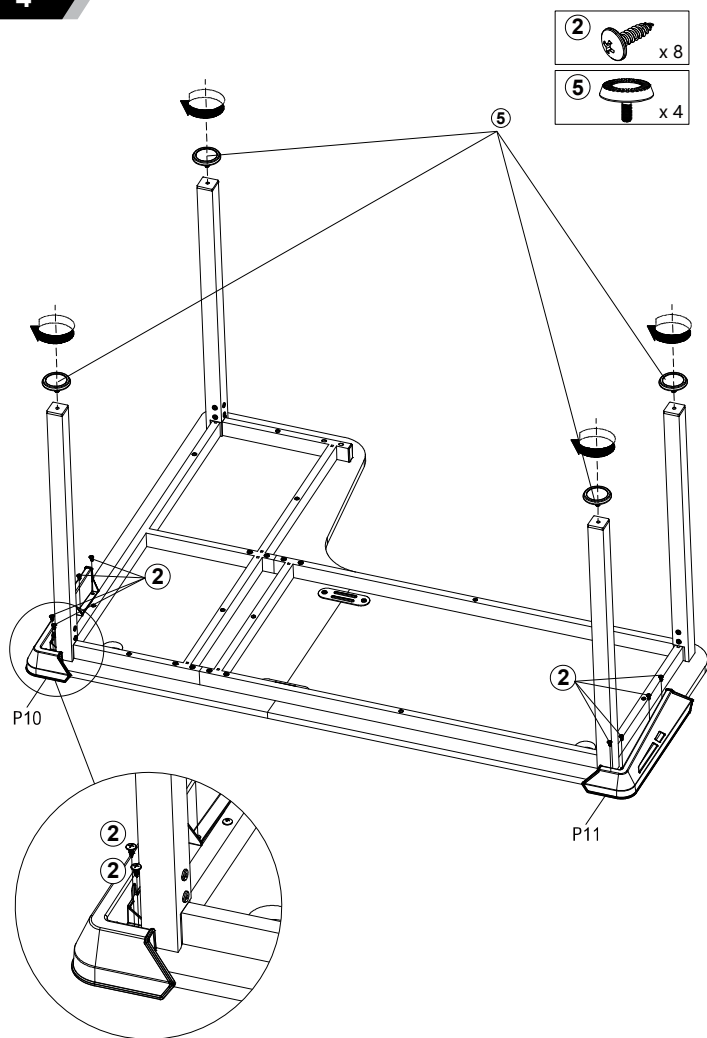

5

