

ASSEMBLY INSTRUCTIONS

Parts and Hardware

Please check and make sure you have all parts and hardware before starting assembly process. Attention: your headboard style may different with the AI.

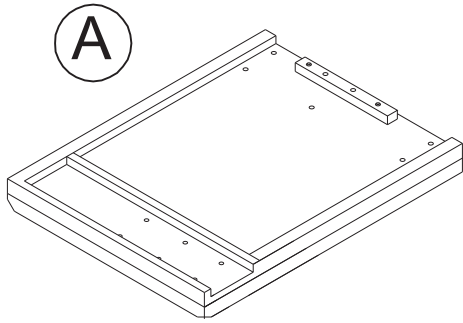

Half Headboard 2pcs

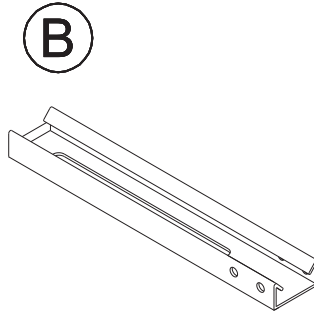

Upper Legs 2pcs

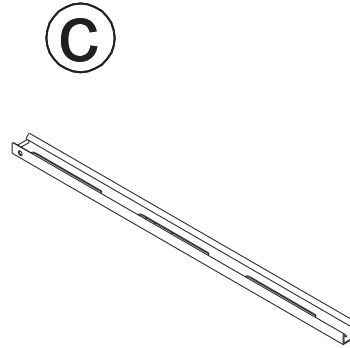

Under Legs 2pcs

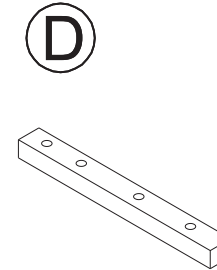

2 pcs were assembled on
the back of the headboard

Metal tube 3pcs

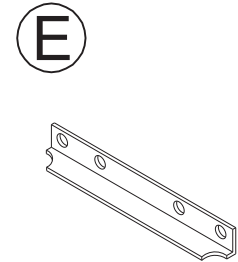

Connector 4pcs

①

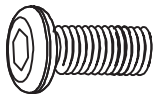

Bolts 16pcs

②



Bolts 12pcs

③

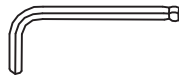

Wrench 1pc

④



Bolts 4pcs

⑤



Flat Washer 4pcs

⑥



Spring Washer 16pcs

STEP 1: Connect upper legs(B)& under legs(C)with bolts(1) .

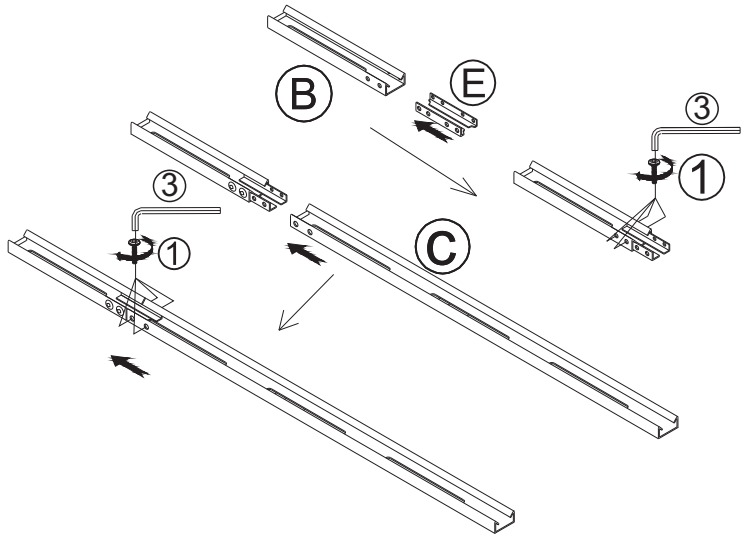

STEP 2: Remove 2 metal tube(D) from the back of the headboard with wrench

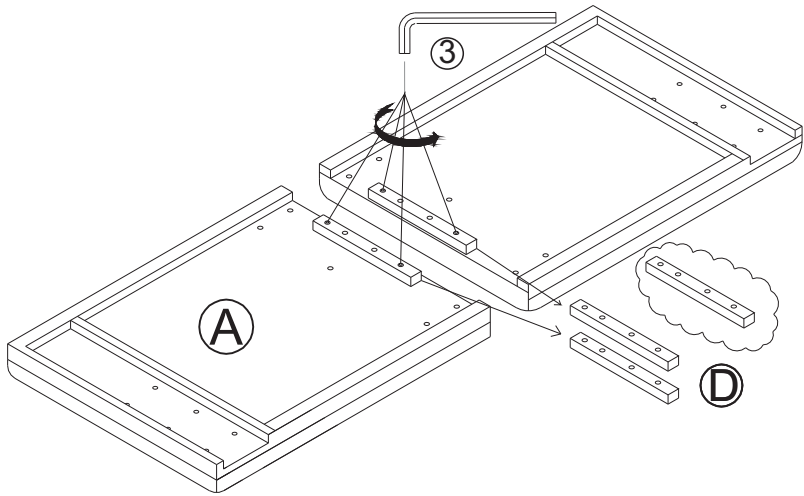

STEP 3: Connect 2 half headboards(A) with 3 pcs metal tube and use bolts(2)to tighten.

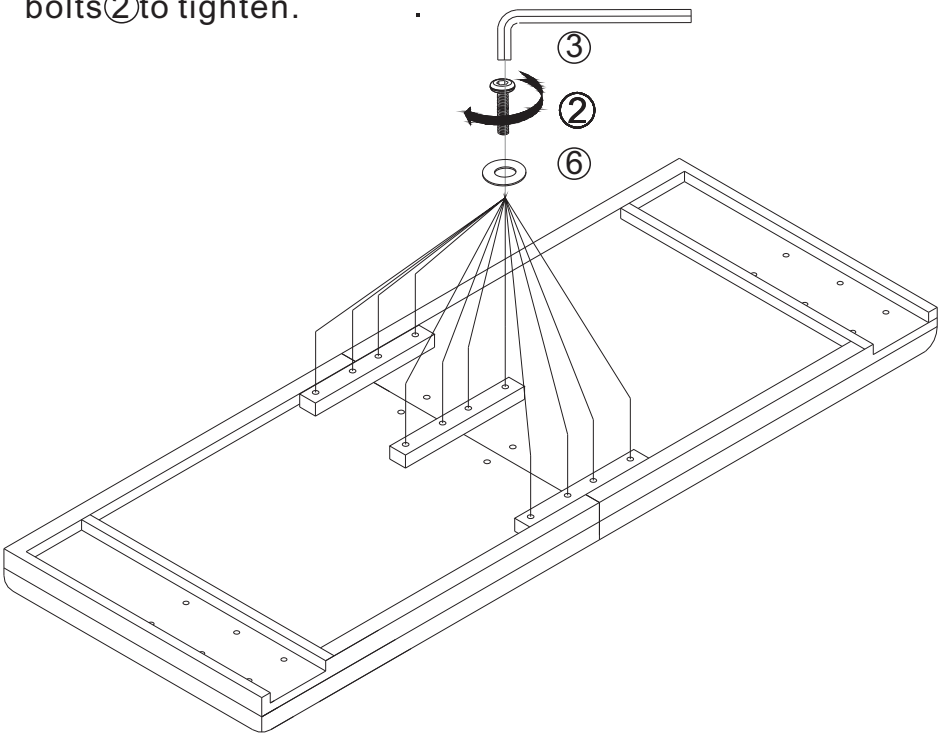

STEP 4: Attach the 2 pcs assembled legs to the headboard with bolts(4). Choose the suitable height for you.Both match with Eastern & California king size bed frame perfectly.

