



User Manual

BG-1447ZW

FINGERPRINT GUN CABINET OPERATING INSTRUCTION

⚠ Please Do Not Put The Emergency Key, The External Power Box In The Safe!

SCHEMATIC DIAGRAM

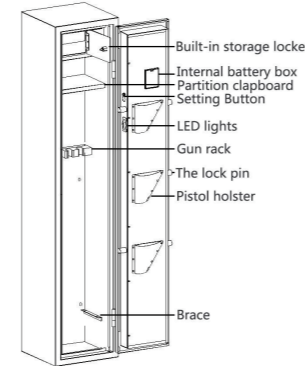
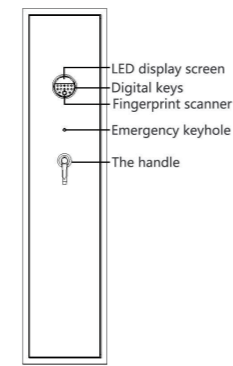

PARTS LIST

Built-in storage key *2	
Emergency key *2	
Expansion bolt *4	
External power box *1	



Tip Over Hazard

- A child or adult can tip the safe and be killed or seriously injured.
- Serious injury may occur to children and adults if not secured before installation.
- Children should not play with or around the safe at any time.

GETTING STARTED

1. Remove the emergency lock cover according to the instructions on the schematic diagram.
2. At this time, the emergency key channel is exposed.
3. Insert the emergency key into the keyhole and turn it 35° counterclockwise.
4. Turn Handle clockwise to open the safe.
5. Tip: Use the emergency key when opening the door for the first time. After installing the battery, set the fingerprint password and key password

INSTALL BATTERIES

1. Open the battery box cover plate.
 2. Insert 4 *AA batteries and close battery cover. ⚠ (Caution: Do not use Lithium Battery or different brand of recharging batteries.)
 3. Continue to the next step
- ⚠ The Original password is :1234#. No fingerprint recognition is set for the factory blank fingerprint.

-1-

PASSWORD SETTING METHOD (Two groups of password)

1. Enter the initial key "1234#" the prompt tone is "drip drip" The display displays OPEN, press the "*" button within 6 seconds When you hear "di", the nixie tube displays "-"
 2. Enter the 3-8-bit password within 10 seconds and press "# " to confirm. The nixie tube displays "IN" If you hear "di", the modification is successful. The new password is displayed. (Press the * key to delete one bit of password.)
- Tip: If the operation is wrong, the buzzer will sound "drip drip drip" three times At the same time digital tube display "ERROR". Please reset it. Note that the battery is weak and cannot be operated.

SET FINGERPRINT

- Tip: (If the fingerprint is not set successfully, any fingerprint can identify the door) (30 fingerprints are stored)
1. When the door is open, press the setting button,
 2. Press your finger on the fingerprint collector three times within 6 seconds. When the registration is successful, the fingerprint head is IN red light, and the digital tube shows "IN" IN the center position, and "di" is heard twice, indicating that the modification is successful.
- Failed to record fingerprint because:
1. Weak current situation, solution: change the battery.
 2. Finger peeling, solution: replace the finger.

OPEN THE SAFE

1. Enter the correct user password, the electromagnet pulls , then turn the handle clockwise to open the door successfully.
2. Press the correct fingerprint, the electromagnet pulls in , turn the handle clockwise and the door is opened successfully (blank fingerprint is not allowed to open the door)

ALARM FUNCTION

1. If you input the wrong password for three consecutive times or input the wrong fingerprint for five consecutive times, the electronic lock will be equipped with a built-in speaker to alarm for one minute
2. In the standby state, press "**", display "ALERT", when the motherboard vibration, display "ALERT", at this time alarm 1 minute, in the alarm process, you can enter the password or fingerprint to open the door, and the alarm automatically relieved.

NOISE ELIMINATION FUNCTION

1. The number "1" is the mute switch button. Method: In standby state, hold down "1" button for 3 seconds, and the green indicator blinks twice.
2. Power off the device and then power on the device again. The sound is normal.

-2-

HOW DO I RESTORE FACTORY SETTINGS

1. In the standby state, long press the setting button for 3 seconds, hear a long "drip" sound, while the nixie tube display "clear", showing off in one second. At this point, the system returns to the initial state (fingerprint cleared, password returned to 1234, management password blank).

UNDERVOLTAGE INDICATION

1. When the voltage is 4.8V (+/-0.2), "LO-BAT" will be displayed every time the system is awakened; After 2 seconds, ring "drop" and then display "-", you can enter the confirmation password to open the door.
- Note: It is recommended to use ordinary batteries, avoid lithium batteries or different brand of recharging batteries.

TECHNICAL PARAMETERS

1. Working power: 4 x AA Batteries
2. Working voltage range: 4V-7V
3. Working undervoltage point: 4.6V plus or minus 0.20V
4. Quiescent current is less than 5A

MOUNTING INSTRUCTIONS

- The safe could be mounted to a wall or floor.
- Drill the appropriate size holes for the anchors you are using.
 - Mount the safe by running screws from inside of the safe and securing to anchors; ensure the safe is mounted securely Floor Mounting.
 - Use proper drill tools depending on the type of floor you are mounting the safe (wood, tile, or concrete).

MOUNTING HOLES

~ In kind prevails

-3-

尺寸: 148x210mm
材质: 105g 单铜纸