

## HOW TO USE AND CLEAN

**In order to keep the LED mirror in perfect condition, we suggest a proper use and regular cleaning.**

### How to Use

- Please ensure that the product is used within the safe voltage range of 100V-120V.
- Please wrap electrical tape around the wires to prevent electrical leakage.
- Avoid using hard or pointed items to strike the mirror glass so as to prevent damage.

### How to Clean

When cleaning the mirror, please follow these steps:

- Use a soft, non-abrasive cloth to clean the mirror. Avoid using rough or abrasive materials that may damage the surface.
- Do not use any cleaning agents that may cause irritation or damage to the mirror's finish. Instead, use any of the recommended cleansers to remove dirt and grime.

☒ Gentle liquid detergent.    ☒ Colorless cleanser.

### ★ Warranty

A one-year warranty from the date of your purchase.

## INSTALLATION MANUAL

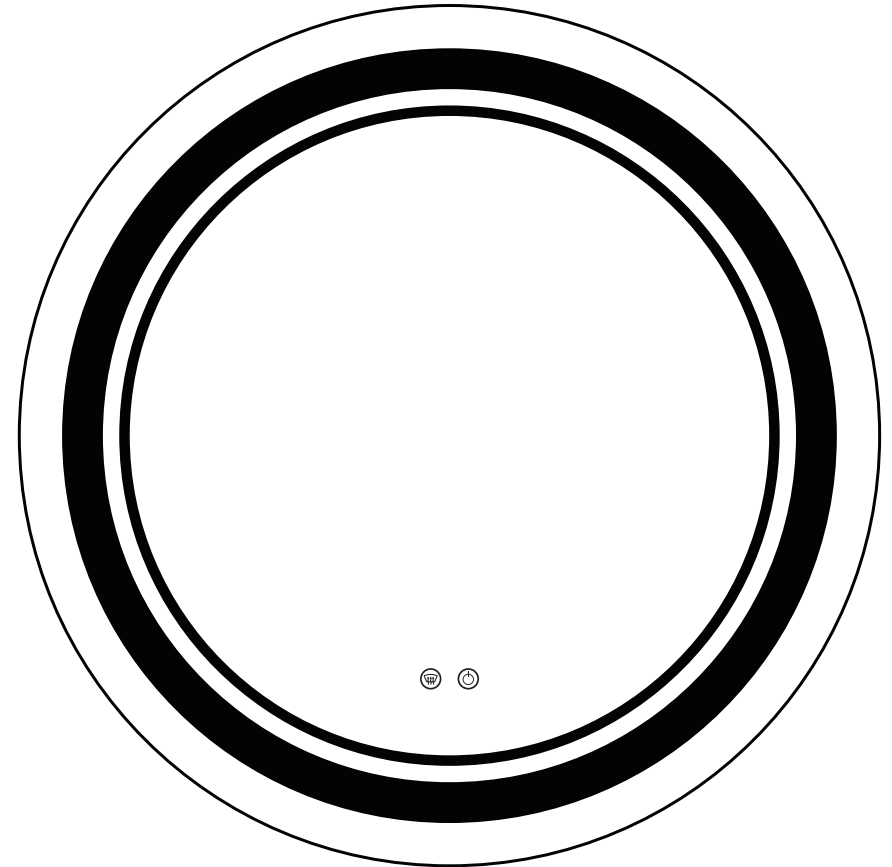

LED MIRROR

# BEFORE INSTALLATION

Thank you for choosing our products. To ensure the best possible experience, **please read carefully and follow the instructions provided below before assembling and installing the product.**

## 1. Important Safety Instructions:

- Assembly by two or more adults is highly recommended, so as to ensure proper installation.
- To connect the wires to the electrical junction box, a qualified technician or electrician is highly recommended.
- Disconnect power before installing, adding, or changing any components.
- Make sure that the fixing location can support the weight of the entire fixture (e.g. solid stone or brick walls).
- To prevent injury, the mirror must be installed as per the instructions provided.

## 2. Pre-assembly:

- Inspect the product immediately upon receipt for any transit damage or missing parts.
- The voltage for your product should be between 100V and 120V. If the voltage exceeds 120V, please use a transformer.
- You can connect the wires directly to your junction box or plug.

## 3. Before Installation

Please check and make sure that the mirror is functioning properly.

### ① Power Check

After connecting the power, the two buttons will turn white, indicating that the LED and anti-fog functions are turned on. If you don't need to use any of them, touch the corresponding button to turn it off, and the button will dim.

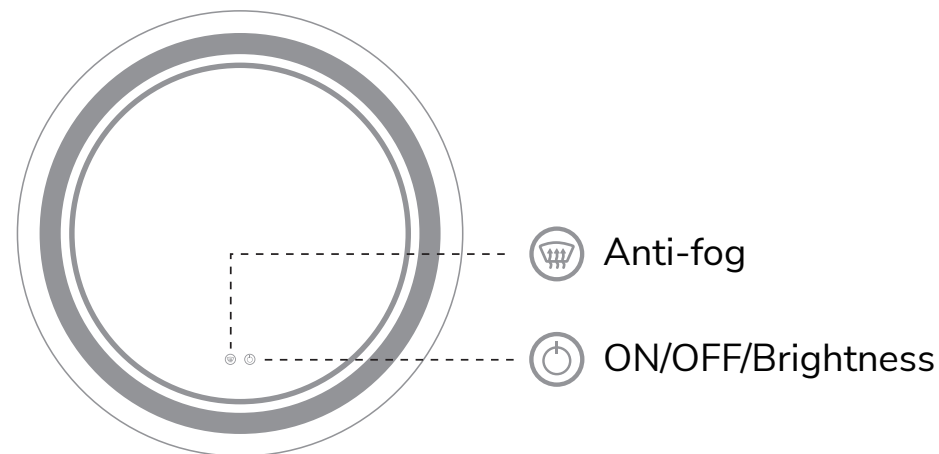

### ② Anti-fog

The anti-fog function helps resist the troubling fog and keep a clear reflection image. To save energy, it will automatically turn off after one hour.

### ③ ON/OFF/ Brightness

**Mirror with triple color temperatures:**

The button controls the light brightness and color temperature. Keep holding it and the brightness will change. You can adjust the color temperature as well: the first tap is white light, the second one is warm light, and the third one is natural light. If no button is pressed within 15 seconds, the next tap will turn off the light immediately. After turning off the mirror light, you can turn off the light of touch switch as well by long pressing the ON/OFF button.

**Mirror with single color temperature:**

Keep holding the button and the brightness will change.

### ④ Memory Function:

The current setting of the mirror will be saved. When you turn on the mirror next time, it will be in the same settings as it was.

By following these steps, you can ensure that your mirror is working properly before installation. If there're any problems, please contact us for support.

## ABOUT US

Thank you for shopping with us! We hope that our products have added a touch of brightness to your life. If you need any assistance, please don't hesitate to reach out. Our dedicated team is available 24/7 to ensure your satisfaction.

## PACKING LIST

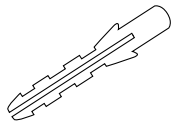

Wall Anchors - A

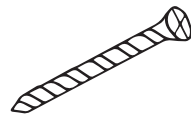

Screws



Wall Anchors - B

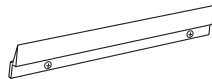

Bracket

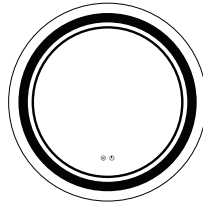

LED Mirror

## INSTALLATION

### Installation Tools

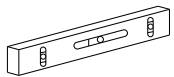

Level Ruler



Marker



Hammer



Tape Measure

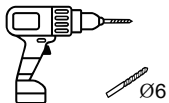

Electric Drill

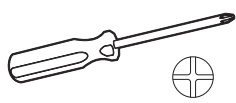

Phillips Screwdriver



Safety Goggles

## PRODUCT STYLE

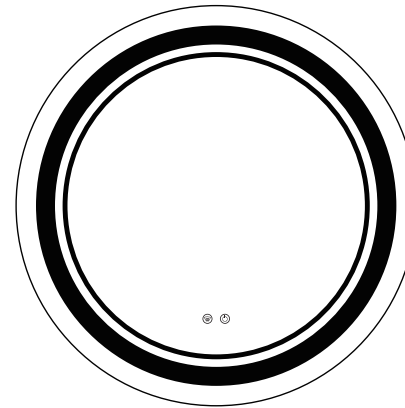

Front tricolor lights  
Front single color lights

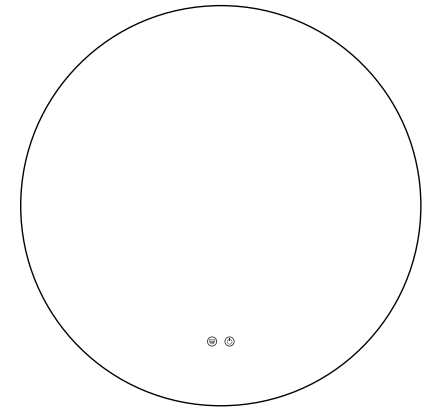

Back tricolor lights  
Back single color lights

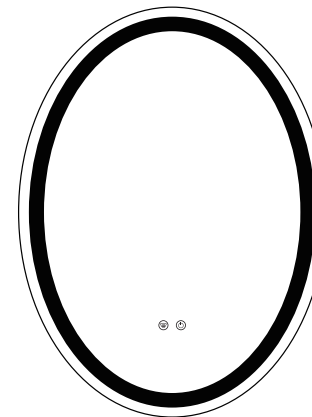

Front tricolor lights  
Front single color lights

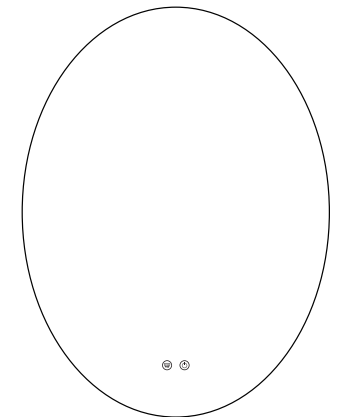

Back tricolor lights  
Back single color lights

## MOUNTING METHOD

## Round Mirror

Measure distance between frame and hook  
(A). Mark the position of the hanging board on the wall.

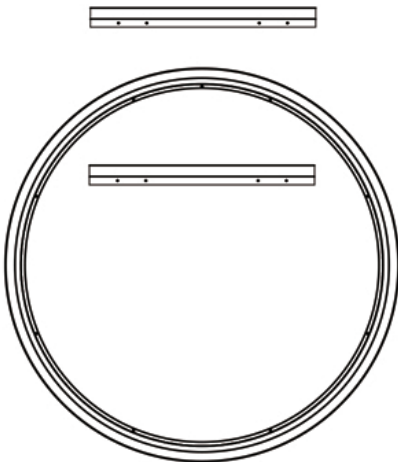

The diagram shows a large circle representing a round mirror. Inside the circle, there is a horizontal rectangle representing a hanging board. Above the hanging board, there is a horizontal line representing a hook. The distance between the top of the hanging board and the hook is marked with a vertical line and labeled 'A'.

## Oval Mirror

Measure distance between frame and hook (A). Mark the position of the hanging board on the wall.

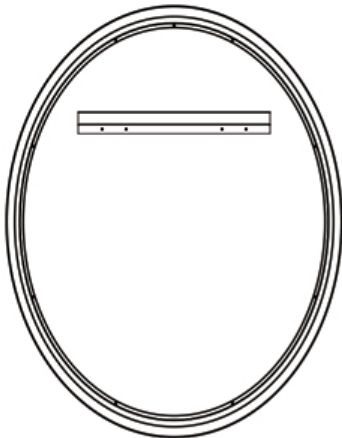

The diagram shows an oval mirror with a double-line frame. Above the mirror is a horizontal hanging board with four small circles representing screws. A hook is attached to the top center of the mirror frame. A vertical line connects the hook to the top center of the hanging board, with a small circle at the intersection point on the board.

Open the carton and make sure all the parts listed below are present.

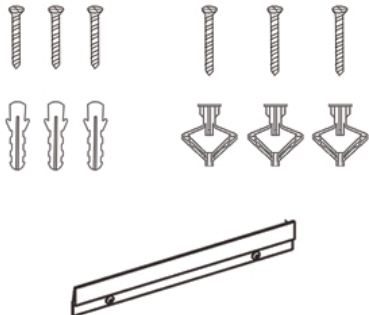

The illustration shows the following parts:

- Three screws (top row).
- Three spacers (middle row).
- Three brackets (bottom row).
- Three end caps (bottom row).
- One slat (bottom row).

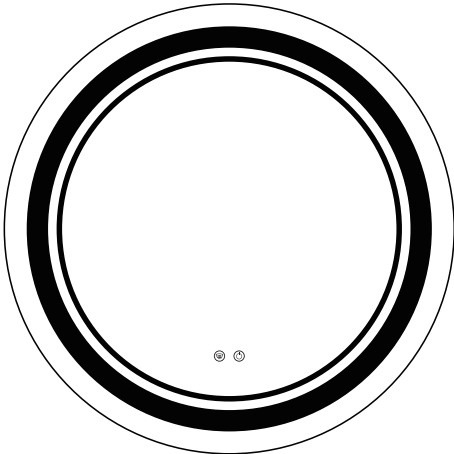

The illustration shows a circular window blind frame with a thick black ring and a white ring. At the bottom center, there are two small circles, one with a dot inside and one with a cross inside.

## Mounting point measurement

Mark the holes for the hanging boards on the wall. Then use a spirit level to make sure the hole is on a straight horizontal line.

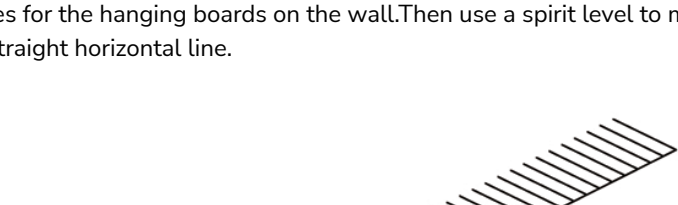

The diagram illustrates the process of marking mounting points for hanging boards. On the left, three tools are shown: a pencil, a spirit level, and a hanging board. On the right, the hanging board is shown being held against a wall. Red dashed lines and 'X' marks indicate the measurement and marking of the mounting points.



## Drill pilot holes on the marked spots

Use an electric drill to punch three 6mm holes at the marked spots, and then apply wall anchors with hammer. (6mm drill bit, drilling depth in 5mm)

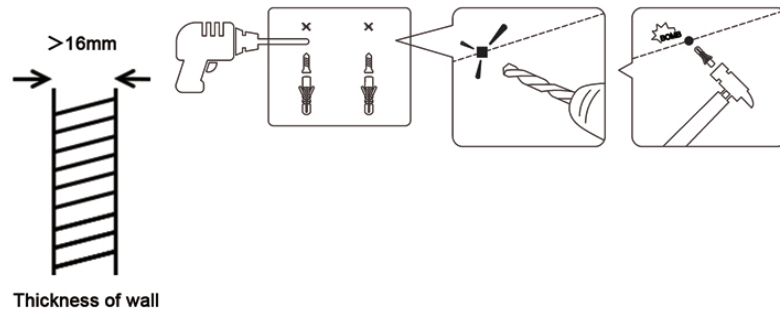

Use an electric drill to punch three 10mm holes at the marked spots, and then apply wall anchors with hammer. (10mm drill bit)

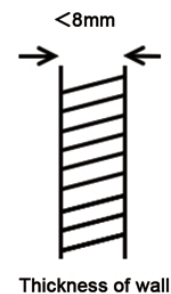
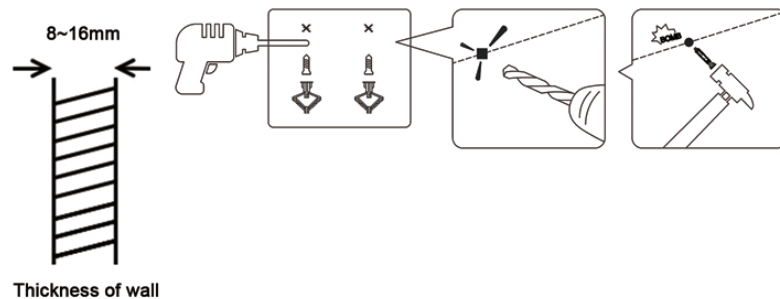

## Insert the screw

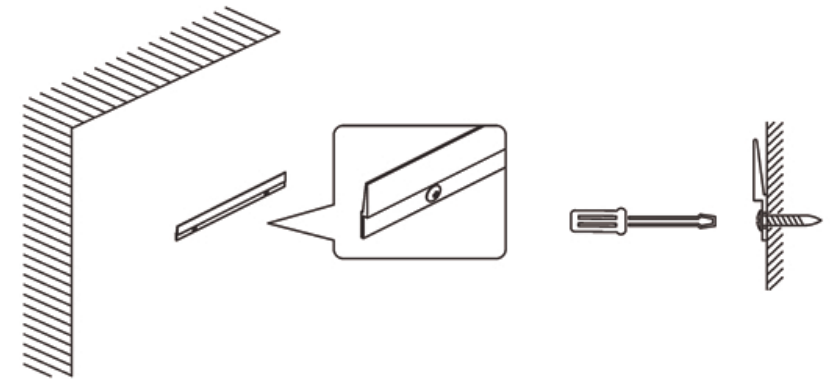

## Connect the power

Cut off the plug of the wire and peel off the outer layer. There are three power wires: A.live wire (Black) B.Neutral wire (White) C.Ground Wire (Green). You can connect the wires to standard switched lighting circuit.

## Mount the mirror on the wall and ensure it is sturdy

Hang the mirror on the hanging board, making sure the hanging board is in the middle.

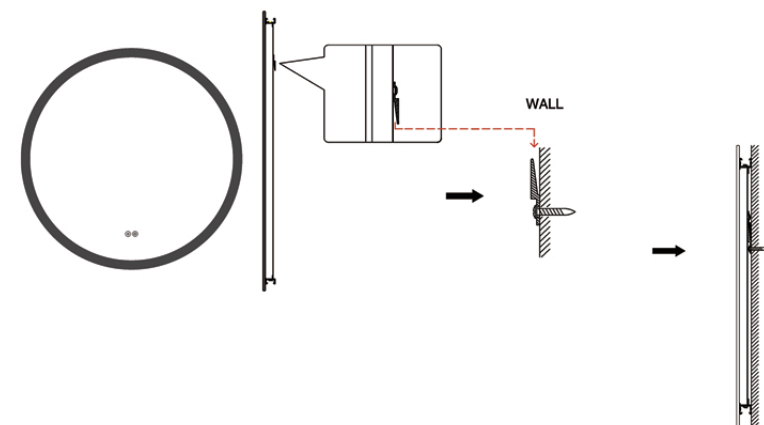

## PRODUCT SPECIFICATION

### Single color lights

Dimension	Watts	Lumens (front-lighted)	Lumens (backlit)
Round φ24"	36W	2080LM	2130LM
Round φ28"	36W	2490LM	2570LM
Round φ32"	48W	2900LM	2943LM
Round φ36"	48W	3347LM	3551LM
Round φ40"	48W	3714LM	3820LM
Oval 24"L x 32"W	48W	2750LM	2791LM
Oval 24"L x 36"W	48W	2894LM	2937LM
Oval 30"L x 40"W	60W	3238LM	3364LM

### Tricolor lights

Dimension	Watts	Lumens (front-lighted)	Lumens (backlit)
Round φ24"	36W	2261LM	2309LM
Round φ28"	36W	2977LM	2980LM
Round φ32"	48W	3160LM	3409LM
Round φ36"	48W	3530LM	3913LM
Round φ40"	48W	3898LM	4011LM
Oval 24"L x 32"W	48W	2970LM	3004LM
Oval 24"L x 36"W	48W	3020LM	3245LM
Oval 30"L x 40"W	60W	3399LM	3532LM

## PRODUCT SPECIFICATION

PARAMETER	SPECIFICATION
Color Temperature (Tricolor lights)	3000K-6000K
Color Temperature (Single color lights)	6000K
Input Voltage	AC100-120V
Output Voltage	12V DC
CRI	≥ 90 Ra
Working Temperature	-10~45 C
Life Span	25000 hours
Anti-fog	Yes
Safety Compliance	ETL
IP Rate	IP44
Mirror Glass	5 mm
Wiring Method	Hardwired / Plug In
Switch	Touch Sensor Switch
Mounting Method	Wall Mount