

Automatic Cat Litter Box Instruction

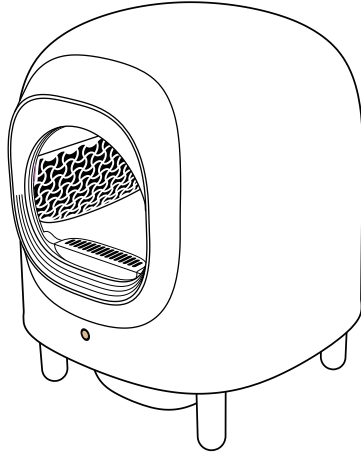

Please read the operation manual carefully and keep it properly before using the product.

There are appearance of color & shape differences in the series of products, please in kind prevail, the function has no difference.

Statement

Thank you for purchasing the Petree smart cat litter box. Beiqu Technology is committed to making your pet life better through the power of design.

This instruction will help you better understand and use this product.

User Notice

1. Please install and use this product according to the instructions
2. This device needs to be placed on a level ground
3. No items are allowed on the top of the device
4. Don't use in a high temperature and high humidity environment
5. Don't use non-clumping cat litter
6. Don't place foreign objects in the ball room
7. Don't force the cat into the ball room
8. The automatic mode of the device is not suitable for cats younger than 6 months
9. The base part is forbidden to wash

Product List

Please carefully check the product list quantity

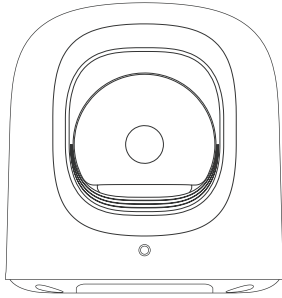

Main body

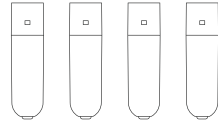

Support leg x 4



Cat feces container

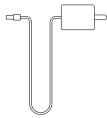

Power adapter



Trash bag



Instructions



Quick guide card



Product Introduction

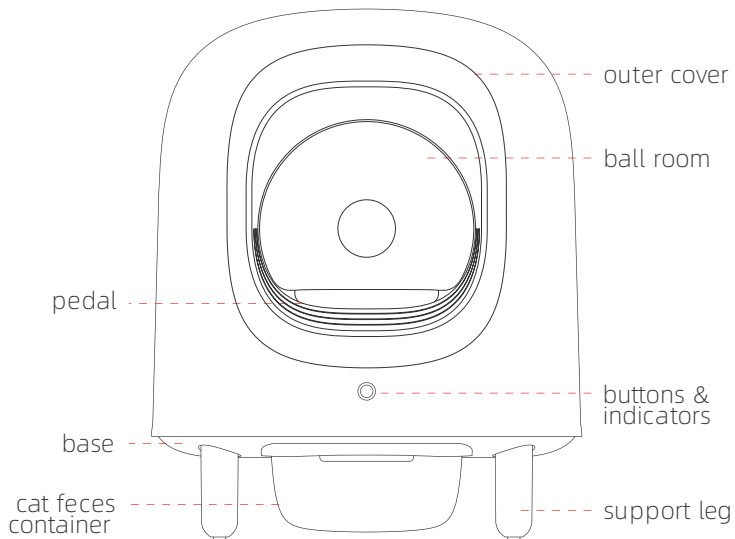

Installation Instructions

1. Take the outer cover, take the ball compartment

Take out the litter box from the package, lift up the external cover. Unlock the ball and release switch, remove the ball from the base.

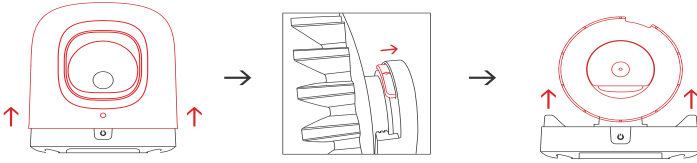

2. Put the base diagonally and install the support legs

Place the base of the main body on the side and install 4 support legs.

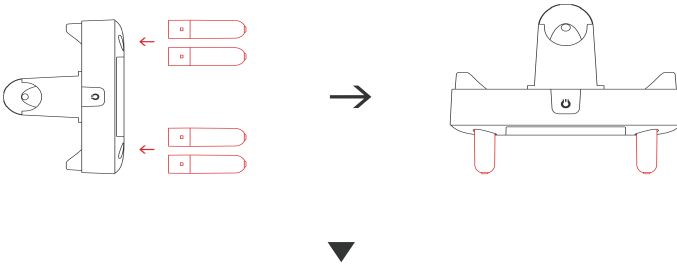

3. Install the ball compartment, install the outer cover

Align the ball with the base properly, lock up and put the external cover back on.

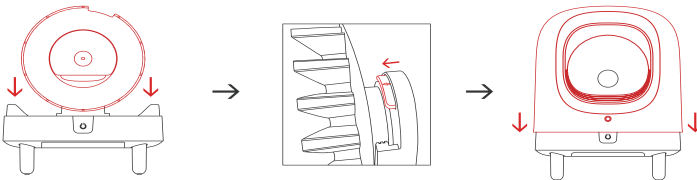

4. Install trash bag & deodorant box

Take out the inner hoop of the cat feces container, install the deodorizing box (purchased separately), and return it after putting the garbage bag in the cat feces container to ensure that the garbage bag is not excessively upturned, then put it back into the main body

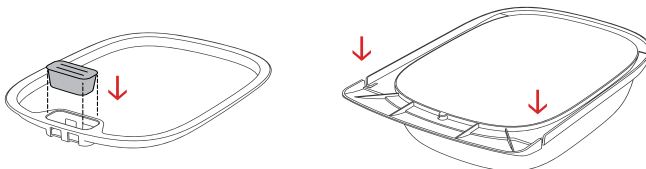

5. Power on and wait for device self-test

Turn on the power and wait for the completion of the self-check operation of the device (the white light is always on after the self-check is completed).

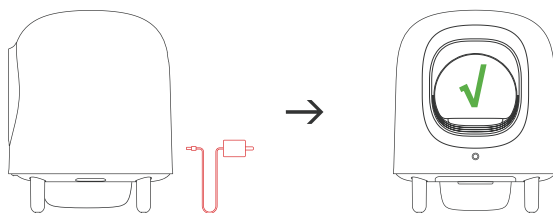

6. Add cat litter

Add clumping cat litter from the hole. Do not add more cat litter than the MAX cat litter line. After adding the litter, click the button on the main body and wait for the end of the run to be used normally

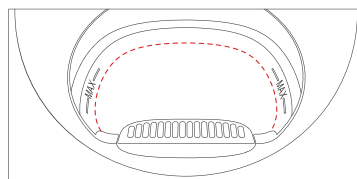

7. Distribution network

Download the APP, press and hold the host button, and enter the network configuration state after a long beep (please place the device in a WiFi coverage environment), open the APP, follow the APP instructions to add the device and connect to the network.

Distribution network precautions

1. The litter box only supports 2.4G WiFi, not 5G WiFi
2. The mobile phone needs to turn on Bluetooth when configuring the network
3. If the APP cannot find the device, please power off the device for 5 seconds and then restart it
4. Only one account can be added to a device, and the device can be shared with other users in the APP
5. If the power is interrupted during operation, it will automatically return to the horizontal position after power on

Button and light description

Main button	Single press	When standby	Start cleaning cycle
		When in operation	Pause / Resume
	Double press	When standby	Start dumping litter
	Long press	When standby	Ready to pair

Indicator	White light	Quick flashing	Pairing / Software upgrading
		Slow flashing	Cleaning / Litter dumping
		ON	Standby
	Red light	Slow flashing	Infrared anti pinch protection is triggered
		ON	Waste collection bin is full
		Quick flashing	Excessive current
	Yellow light	ON	Cats walks into the device

Function Description ▼

1. Automatic cleaning function

After the cat leaves the toilet, the machine starts cleaning 3 minutes later. If the cat is approaching during operation, the machine will stop and continue to operate after the cat left.

2. Device information push function

When the machine is connected to WiFi and added to the app the current status information of the machine will be pushed to the app in real time.

3. Dumping cat litter function

Double click the host button or click the sand dumping button on the app. If the cat is approaching during operation, the machine will stop and continue to operate after the cat left.

4. Do not disturb mode function

Click the "do not disturb mode" button in the app, and the equipment will enter the mode at the corresponding time every day without any operation.

Common problems and Solutions

1. How old cats can use the device?

The automatic function of this product is applicable to cats over 4 months old and weighing more than 1kg. If the cat's weight or age does not meet the standard, do not use the automatic excrement removal function. You can choose to turn on the device in the do not disturb mode for 24 hours and manually turn on the excrement removal function

2. What if the cat doesn't want to use the new litter box?

If the cat has strong vigilance, can place machine next to the old litter box for a period of time, and put some old litter with the smell of the cat into the new equipment. The familiar smell will also make the cat more easy to adapt

3. Is it dangerous for cats to enter when the ball rotates?

If a cat enters the ball bin when it rotates, the monitoring sensor will be triggered immediately, the ball room will stop rotating immediately, and the equipment will continue to operate after the cat leaves the ball room for a period of time. Therefore, there is no need to worry that the cat will enter the running ball room

4. What types of cat litter can I use?

This product supports most agglomerated cat litter (tofu sand, mixed sand, etc.)

Do not use non agglomerated or poorly agglomerated sand (crystal sand, wood-based sand, etc.)

5. How much cat litter should I add?

It's recommended to add about 4L cat litter for the first time. Do not exceed the max sand level line. Excess sand will be filtered into the cat feces container during operation

6. When should I replenish cat litter?

It can be determined according to the specific use situation. It's recommended to supplement cat litter when the remaining half of the cat litter is used

7. How often does it take to clean the cat feces container?

It can be determined according to the specific use situation

(factors such as the number of cats)

It's recommended to replace it once every 3~5 days in the case of one cat

(the frequency needs to be increased in hot weather)

8. How often does it take to clean the ball room?

It can be determined according to the specific use conditions (number of cats or defecation status of cats, etc.)

it's recommended to wash once every 1~3 months if it's possible

Cleaning Instruction

1. Remove residual litter

Double click the host button (or click the "sand dumping" button on the app) to start the sand dumping function (too much residual sand may trigger the prompt that the toilet bin is full. Shaking the toilet bin can reduce the risk of cat litter scattering)

2. Disassembly and Cleaning

Take down the cat feces container, take down the cover, release the switch, and take down the ball.

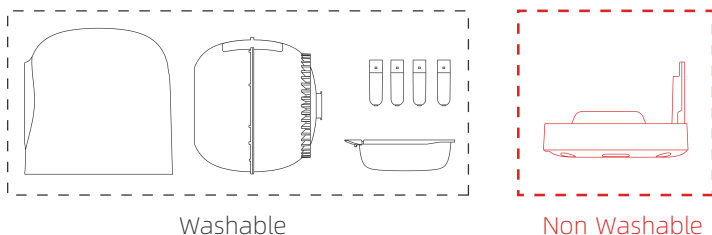

3. Dry and Assemble

After the cleaning is completed and the machine is dried, install the ball room, cover and cat feces container in turn.



TROUBLESHOOTING

1. Within a short period of time after power on, red light flashing

Infrared anti pinch protection is triggered, check if the inductor light above the waste collection bin is dirty, clean and wipe it.

2. Device stops when operating and yellow light on

Check if the device has touched the wall, leaving a 5cm gap around the device. Check if the bottom of the device is level, the device needs to be placed on a flat ground. (After the check is completed, power off and restart the device)

3. Red light on and the rotation not initiating

The waste collection bin is full of waste, please empty the bin and put it back on, the device resumes.

4. Device stops when dumping litter and red light on

There is too much litter dumped into the waste collection bin, the sensors detect the bin is full of waste. Shake the collection bin back and forth to level the litter in the bin, then take out to empty. Or you could dump half of the litter, empty it then repeat this process for the rest. (After stopping, it needs to be manually started, no need to worry, it will automatically dump the remaining litter)

Product Parameters

Name: Automatic Cat Litter Box

Type: ACC-21-02

N.W.: 10.25KG

Product Size: 520 x 520 x 640 (mm)

Standard: GB4706.1-2005

Rated voltage: 12V 1A

Wi-Fi frequency range: 2.400~2.4835GHz

Maximum Wi-Fi transmit power: 18dBm

ISED Statement

This device contains licence-exempt transmitter(s)/receiver(s) that comply with Innovation, Science and Economic Development Canada's licence-exempt RSS(s).

Operation is subject to the following two conditions:

(1) This device may not cause interference.

(2) This device must accept any interference,

including interference that may cause undesired operation of the device. ADVERTENCIA IC Cet appareil contient des émetteurs/récepteurs exemptés de licence conformes aux RSS (RSS) d'Innovation, Sciences et Développement économique Canada. Le fonctionnement est soumis aux deux conditions suivantes:

(1) Cet appareil ne doit pas causer d'interférences.

(2) Cet appareil doit accepter toutes les interférences, y compris celles susceptibles de provoquer un fonctionnement indésirable de l'appareil.

This device complies with ISED RF radiation exposure limits set forth for an uncontrolled environment.

CE

This product complies with the radio interference requirements of the

European Community Product name: Automatic Cat Litter Box

Product model: ACC-21-02/-04

Manufacturer: Hangzhou Beiqu Technology Co., Ltd

Address: 3-1602 Jinsha Lake Commercial Center, Qiantang New District,

Hangzhou, Zhejiang Contact Person: Yeqing Email: linyeqing@hzpctree.com

Tel. 86-18258174849

Frequency Range: BLE:2402MHz to 2480MHz; WiFi:2412MHz to 2472MHz

Max. output Power: BLE:7.93 dBm; WiFi:18.74 dBm

SIMPLIFIED EU DECLARATION OF CONFORMITY

The simplified EU declaration of conformity referred to in Article 10(9) shall be provided as follows:

Hereby, xxx co.,LTD declares that radio equipment type Bluetooth Speaker

(A18) is in compliance with Directive 2014/53/EU, and this product is allowed to be used in all EU member states.

The full text of the EU declaration of conformity is available at following

This product can be used across EU member states.

This equipment should be installed and operated with minimum distance

20cm between the radiator & your body.

FCC Statement

This equipment has been tested and found to comply with the limits for a Class B digital device, pursuant to Part 15 of the FCC Rules. These limits are designed to provide reasonable protection against harmful interference in a residential installation. This equipment generates uses and can radiate radio frequency energy and, if not installed and used in accordance with the instructions, may cause harmful interference to radio communications. However, there is no guarantee that interference will not occur in a particular installation. If this equipment does cause harmful interference to radio or television reception, which can be determined by turning the equipment off and on, the user is encouraged to try to correct the interference by one or more of the following measures:

--Reorient or relocate the receiving antenna.

--Increase the separation between the equipment and receiver.

--Connect the equipment into an outlet on a circuit different from that to which the receiver is connected.

--Consult the dealer or an experienced radio/TV technician for help.

This device complies with part 15 of the FCC Rules. Operation is subject to the following two conditions:

(1) This device may not cause harmful interference, and

(2) This device must accept any interference received, including interference that may cause undesired operation.

Changes or modifications not expressly approved by the party responsible for compliance could void the user's authority to operate the equipment.