

# ASSEMBLY INSTRUCTIONS

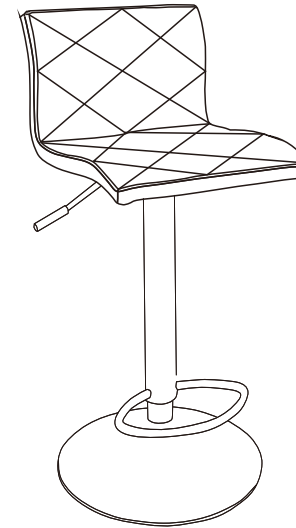

BARSTOOL

## ASSEMBLY INSTRUCTIONS

### ASSEMBLY TIPS:

1. Remove hardware from box and sort by size.
2. Please check to see that all hardware and parts are present prior to start of assembly.
3. Please follow attached instructions in the same sequence as numbered to assure fast & easy assembly.



#### Warning!

1. Don't attempt to repair or modify parts that are broken or defective. Please contact the store immediately.
2. This product is for home use only and not intended for commercial establishments.



ASSEMBLY TIME 5 MINUTES



Donot over tighten.  
Donot use power tools to assemble.

### PARTS IDENTIFICATION

	FIGURE	QTY
A		1 PC
B		1 PC
C		1 PC
D		1 PC

### HARDWARE IDENTIFICATION

	FIGURE	QTY
E		4 PCS
F		1 PC

## ASSEMBLY INSTRUCTION

### STEP1

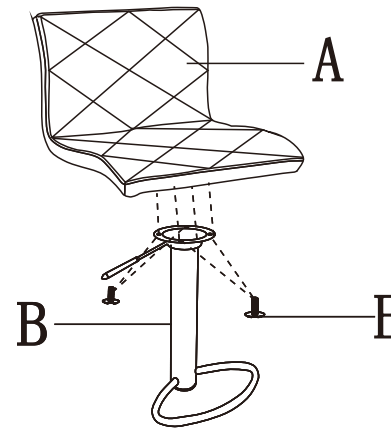

### STEP2

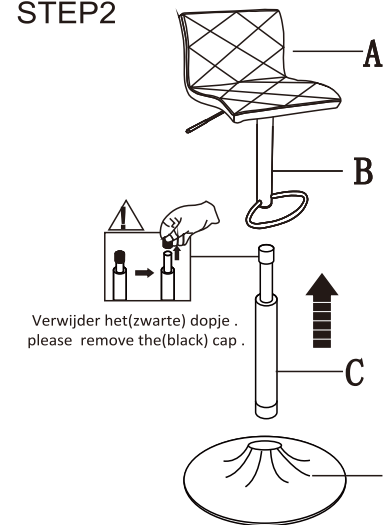

### STEP3

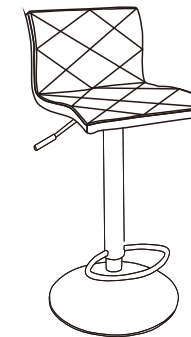

BARSTOOL

BARSTOOL