

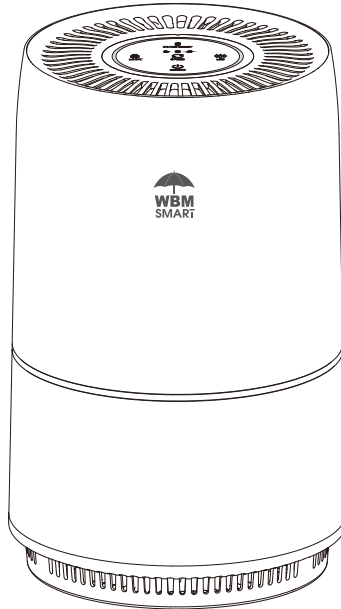

# Air Purifier



## User Manual

Model : AR-04

TABLE OF CONTENTS

SAFETY INSTRUCTIONS ----- 1

PARTS IDENTIFICATION ----- 5

OPERATING INSTRUCTIONS ----- 7

REPLACING THE FILTER ----- 8

CLEANING AND MAINTENANCE ----- 10

TROUBLESHOOTING GUIDE ----- 11

TECHNICAL INFORMATION ----- 12

DISPOSAL ----- 13

CONTACT ----- 13



**CAUTION: To reduce the risk of fire, injury or electrical shock along with extending the life of your electrical appliances, please read and follow all of the information in this manual before using and save it for future reference.**

## SAFETY INSTRUCTIONS

- Use this purifier only as described in this manual.
- Place the purifier on a dry, stable and level surface.
- Please ensure that the clearance between the product and surrounding objects is over 12 inches, and that the clearance from the top of the purifier is over 40 inches, so that the air will be better circulated and the air purifier will work more efficiently. Adequate airflow throughout the room will enhance the operational efficiency of the air purifier.
- Keep all air inlets and outlets free from blockages. Do not cover the purifier when in use.
- Do not place magnets, metal objects and glasses of water on top of the purifier. Metal objects and magnets may cause a malfunction of the inductive switch and the water in the glass may drip into the machine.
- When plugging or unplugging the purifier, please hold the rubber part of the plug by hand, instead of pulling the cord.
- This purifier operates only on a voltage of 120V 60Hz.
- Never unplug the purifier from the electrical outlet until it has been switched off.
- This purifier has a polarized plug (one blade is wider than the other). To reduce the risk of electric shock, this plug is intended to fit in a polarized outlet only one way. Do not attempt to defeat this safety feature.
- Unplug the purifier from the outlet while moving or cleaning.
- Do not touch the power plug with wet hands.
- Avoid placing the power cord in areas where it can become a tripping hazard.
- Do not use outdoors.
- Do not sit or lean on the purifier.
- Do not insert fingers or objects into the air inlet, air outlet and other gaps of the purifier. Any contact with the interior of the purifier may cause electric shock or injury.
- Never use the purifier without the Composite Filter installed correctly. Doing so will void your warranty.

- Do not cut, scratch, refit, warp, pull, reverse or twist the power cord as it may cause electric shock or fire.
  - Never operate the purifier if the cord, plug or purifier is damaged.
  - Children are not allowed to operate the air purifier without adult supervision.
  - Do not attempt to repair, adjust, disassemble or refit any electrical or mechanical elements in the purifier.
  - Only use the manufacturer's replacement Composite Filter for this purifier.
  - A loose outlet is a potential hazard that needs to be taken care of. Please ensure the plug is tightly connected to a working electrical outlet. If not, it may cause electric shock or even fire due to overheating.
  - If the purifier will not be used for a long time, unplug it from the electrical outlet and store it in a cool, dry place.
  - Do not use ethyl alcohol, chlorine or any diluents, solvents, or acid detergents to clean the air purifier. The chemical residue may accumulate in the purifier and release in the air through air outlet and thus do harm to your health.
  - When using together with a non-electric heater, please keep the area well-ventilated. This purifier cannot eliminate or remove Carbon Monoxide (CO) or Radon (Rn). It cannot be used as a safety device in case of accidents with combustion or hazardous chemicals.
  - This purifier is not a substitute for proper ventilation, like the use of an extractor or range hood.
  - To avoid the chance of tripping over or becoming entangled in the cord, a short power supply cord is provided. Extension cords may be used with caution and care. When using an extension cord, please note that the electrical rating for the extension cord should be at least as great as the electrical rating of the purifier. To avoid circuit overload, do not operate another electrical purifier on the same outlet or circuit.
- When filtering pollen or indoor dust and dander, please place the air purifier on the ground, since pollen and dust from the air at low altitude will be more easily captured due to the effect of gravity.

**In case of any of the following circumstances, please immediately turn off and unplug the purifier:**

- If any button does not work;
- If the circuit breaker trips or the fuse is blown;
- If a burnt smell or unusual sound or vibration is detected;
- If there is any other abnormal phenomenon or fault.

**Do not place the purifier on or in the following places:**

- Unstable surfaces.
- Places with high temperature, high humidity or anywhere that may wet the purifier, such as a bathroom.
- Kitchens and other places emitting cooking fumes.
- Places where oil or combustible gases are used. Fire may occur due to the ignition of oil or gas.
- Places with direct sunshine, or near a heat source. Deformation, deterioration, discoloration and malfunction of the purifier may occur.
- Places where curtains and other fabrics may shield the air outlet, thus influencing the accuracy of signal acquisition of the sensor.
- Places where electrical equipment with a high-intensity magnetic field or strong interaction are used.
- Please keep the purifier away from plants and animals.
- Do not use the air purifier in any room where incense or insecticide is used. Do not allow volatile substances or combustible materials, such as cigarette smoke or incense to enter the purifier. After using insecticide in a room, the air purifier may be used only after the room has been adequately ventilated.

**WARNING:**

To reduce the risk of fire or electric shock, do not use this purifier with any Solid-State Speed Control device.

**CAUTION:**

This appliance has a polarized plug, always make sure it is correctly plugged into a polarized electrical outlet to reduce the risk of electric shock.



**Always follow basic safety precautions when using any electrical products, especially when children are present.**

**FOR HOUSEHOLD USE ONLY  
SAVE THESE INSTRUCTIONS**

## PARTS IDENTIFICATION

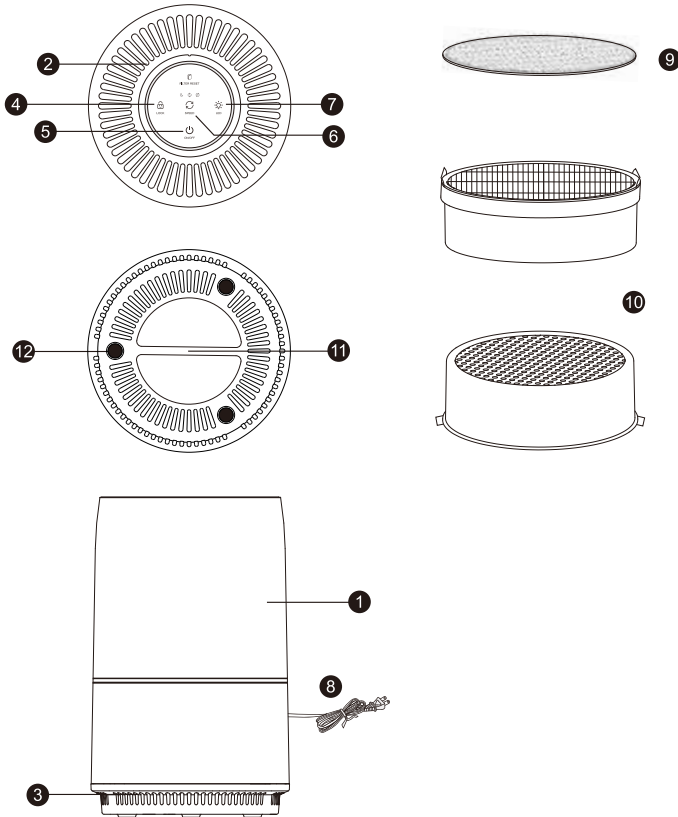

1. Housing

2. Air Outlet

3. Air Inlet

4. LOCK Button

5. ON/OFF Button

6. SPEED Button

7. LED Button

8. Power Cord

9. Pre-Filter

10. HEPA Filter & Activated Carbon Filter

11. Composite Filter Cover

12. Anti-Skid Pads

## Features

- Mini, portable, suitable for a variety of scenes.
- Elegant and graceful style.
- Gentle LED night light creates an atmosphere of calm and serenity, with OFF, DIM and BRIGHT options that never interrupts your sleep.
- Child safety lock keeps your children away from danger.
- Removes airborne pollutants such as dust, plant pollen, mold spores, fungi, pet dander, etc.
- Purifies the air with 3-in-1 Composite Filter — Pre-filter, TRUE HEPA Filter, & Activated Carbon Filter. Clean Air Delivery Rate (CADR) is 68m<sup>3</sup>/h (40CFM).
- Particulate matter above 0.3  $\mu\text{m}$  can be filtered out, with the once-through filtration efficiency greater than or equal to 99.5%.
- 3-Speed Settings provide options for various conditions. It is recommended to turn to the lowest speed at night, with 15w of minimum power consumption. Whisper-quiet operation good for a sound sleep.



## OPERATING INSTRUCTIONS

### BEFORE FIRST USE

- Remove all packaging materials and set aside. Turn the Composite Filter Cover clockwise, from LOCK to OPEN, to open the Composite Filter Cover and remove the packaging material of the new Composite Filter.
- Read through all printed materials and save for future reference.

Place the purifier on a dry, stable and level surface, and plug it into a 120V/60Hz outlet. Before plugging in, make sure your hands and the plug are completely dry.

### NOTE

When using the purifier, please close the windows and doors, and ensure that the clearance between the product and surrounding objects is over 12 inches, and the clearance from the top of purifier is over 40 inches.

Please do not put anything above or on top of the product, nor sit on the product.

### Control Buttons

- **ON/OFF** – Press the ON/OFF button to turn the air purifier on or off.
- **SPEED** – Press the SPEED button to cycle through the three fan speeds of the air purifier.
- **LOCK** – Press and hold the LOCK button for 3 seconds to lock the control panel. When the control panel is locked, the only button that functions is the LOCK button. Press and hold the button again for 3 seconds to unlock the control panel.
- **LED** – LED light has two brightness settings. Press the LED button to cycle through the two settings of off and bright.

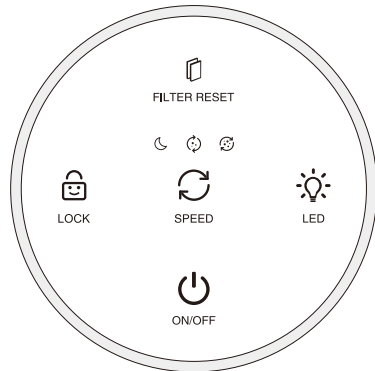

### FILTER RESET Indicator

The FILTER RESET light will turn on when the air filter needs to be checked or replaced. Press and hold the LED button for 3 seconds to reset the machine after checking or replacing the Composite Filter.

## REPLACING THE FILTER

It is recommended to change the Composite Filter (Pre-Filter, HEPA Filter & Activated Carbon Filter) every 3 to 6 months, depending on the ambient air quality. The service life of 3-6 months is not a rigid standard time, which needs to be judged according to the cumulative purification amount of the filter and the operating environment. The purifier will remind the user to replace the Composite Filter after using for 1500 hours. When the FILTER RESET light turns on, it is reminding the user to replace the Composite Filter.

- (1) Turn the Composite Filter Cover clockwise, from LOCK to OPEN, to open the Composite Filter Cover, and take out the old Composite Filter.

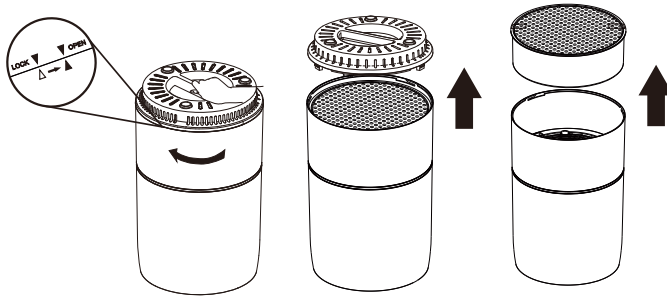

- (2) Remove the packaging material of the new Composite Filter. Please check that the new Composite Filter is in good condition.

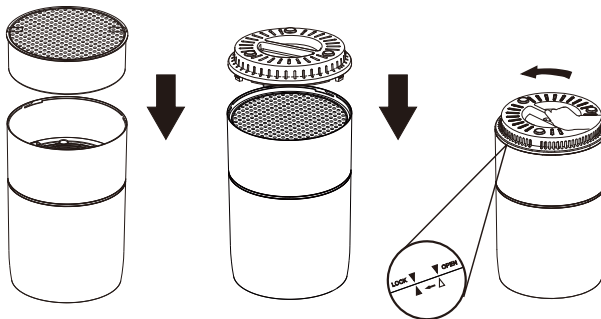

- (3) Place the new Composite Filter into the machine, replace the Composite Filter Cover and turn it counterclockwise, from OPEN to LOCK, to secure the Composite Filter Cover to the machine.

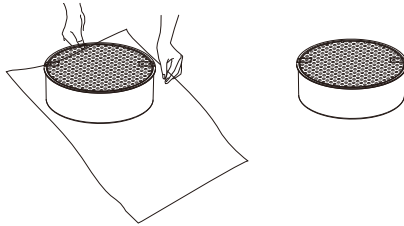

- (4) Please remember to reset the air purifier after replacement by pressing and holding the LED button for 3 seconds.

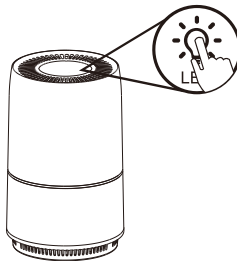

## CLEANING AND MAINTENANCE

- Please make sure to turn off the machine power and unplug it before cleaning.
- Wipe the machine outer housing with a damp soft cloth. Use mild detergent if necessary. Do not use cleaning powder, alkaline detergent, bleaching agent, alcohol or gasoline to clean the machine surfaces.
- The Composite Filter is not washable.

## TROUBLESHOOTING GUIDE

If after reviewing the troubleshooting guide, the problem is not resolved, do not attempt to repair or disassemble the unit yourself. Please contact the customer care.

Problem	Possible Cause	Solution
FILTER RESET light is still on after replacing the air filter.	The test program for Composite Filter lifetime reminder has been accidentally reset.	Press and hold LED button for 3 seconds to reset the machine, then the indicator light will turn off.
There is no change in air quality after the appliance has been operating for a long time.	The Composite Filter is not correctly installed.	Check whether the Composite Filter is installed correctly.
	The bottom cover has not been rotated in place correctly.	Check whether the bottom cover has been rotated to the LOCK position.
	Too high indoor humidity will affect the purifying effect.	Use air conditioner or dehumidifier to reduce indoor humidity
	The air outlet or air inlet is blocked.	Remove any dirt or dust from the air outlet or inlet.
	The room area is larger.	This product is suitable for an area of 7.5m <sup>2</sup> .
Sound is too loud.	The packaging materials for filter has not been removed.	Please ensure that all the packaging materials has been completely removed.
	The Composite Filter is dirty, and/or the air inlet or outlet is blocked.	Replace the Composite Filter and remove any dirt or dust from the air inlet or outlet.
The purified air has a bad smell.	The machine is or has been used in a strong strong-smelling environment, such as cigarette smoke or barbecue.	If the machine has already been used in a strong-smelling environment for a long period of time, you will need to replace the Composite Filter. Avoid using the machine in similar environments. If it happened just at that moment, open the windows without delay to ventilate the room adequately.

## TECHNICAL INFORMATION

<b>Product Name</b>	Air Purifier
<b>Model</b>	AR-04
<b>Voltage</b>	120V / 60Hz
<b>Rated Power/Current</b>	29W / 0.38A
<b>CADR</b>	65m³/h
<b>Net Weight</b>	2.4kg / 5.3lb
<b>Product Dimensions</b>	Φ20.0x32.5cm / 7.8x12.8in

### DISPOSAL



When this appliance has reached the end of its life, please dispose of the unit properly. This and other electrical appliances contain valuable materials that can be recycled. Electronic waste may be harmful to our environment if not disposed of properly. We ask that you follow your governing agency's rules and regulations when disposing of electronic appliances. Please find an authorized recycling facility near you.

### CONTACT

If you have any questions or concerns not addressed in this user manual, please call our customer service department at 1-866-802-9366 or email: [support@wbminternational.com](mailto:support@wbminternational.com).

Please read the operating instructions before using this product.

Please keep the original box, packing materials and all documentation in the event that service is required.