

Bathroom Vanity

ASSEMBLY INSTRUCTIONS

Notice:

1. Follow the installation instructions. Please confirm all accessories are present before installation.
2. Do not fully tighten the screws during initial assembly. Fully tighten screws only once all pieces which are correctly assembled.
3. If you encounter any problems during installation, please contact our customer service.
4. Please unbox the item from the side with an open-label and put a carpet on the floor to avoid scratching it.



Recommended installers : 2



Put a carpet on the floor before unpacking



Estimate installation time:
30 minutes

| Item no. | Reference Image | Qty |
|----------|-----------------|-----|
| A | | x1 |
| B | | x1 |
| 1 | | x2 |
| 2 | | x2 |
| 3 | | x2 |

| Item no. | Reference Image | Qty |
|----------|-----------------|---------|
| 4 | | x2 Sets |
| 5 | | x4 |
| 6 | | x4 |
| 7 | | x4 Sets |
| 8 | | x1 |

ASSEMBLY INSTRUCTIONS

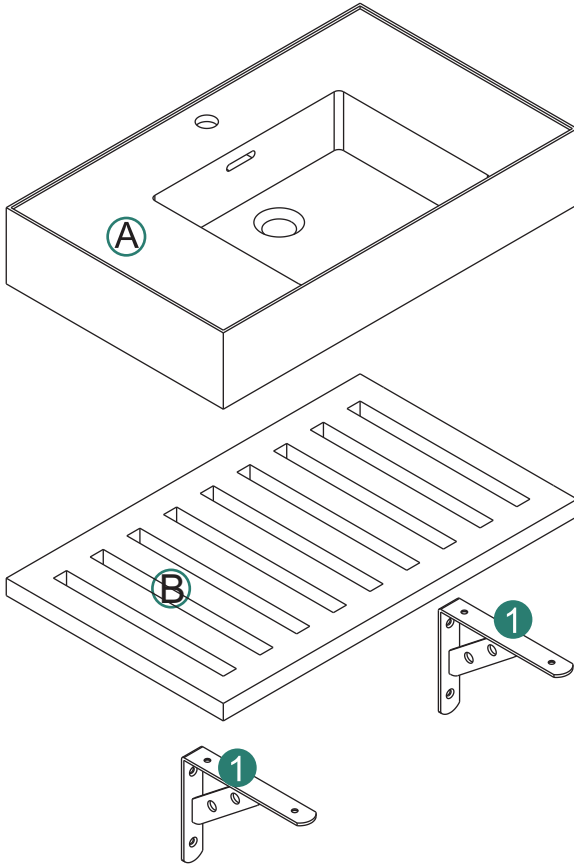

ASSEMBLY INSTRUCTIONS

TOOLS AND ACCESSORIES

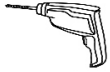

Drill



Measuring tape

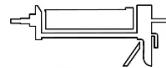

Silicone

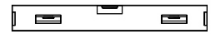

Level



Pencil

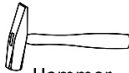

Hammer

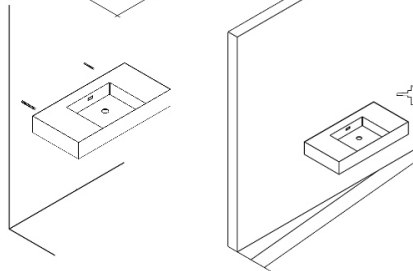
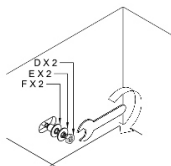
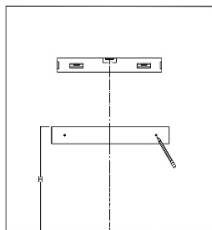
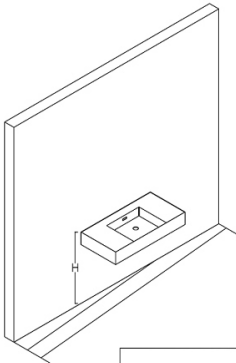
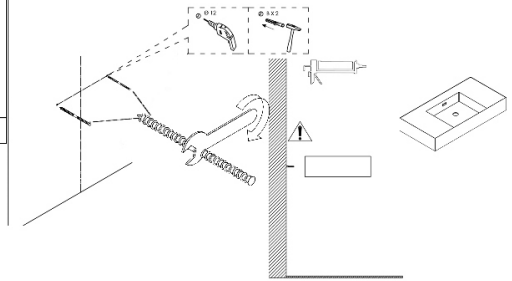
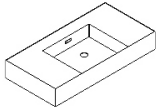

ASSEMBLY INSTRUCTIONS

1

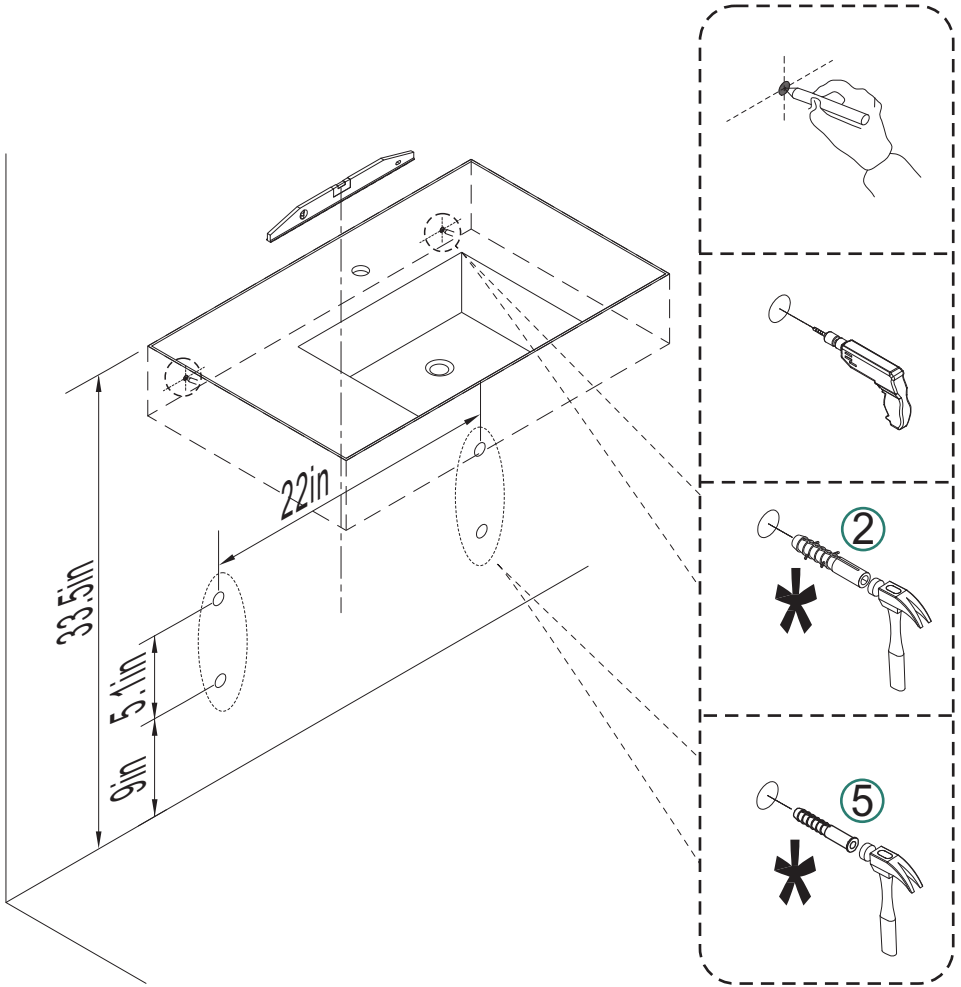
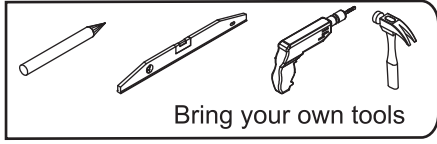
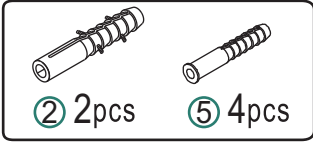

ASSEMBLY INSTRUCTIONS

2



① 2pc



③ 2pc



⑦ 4pc

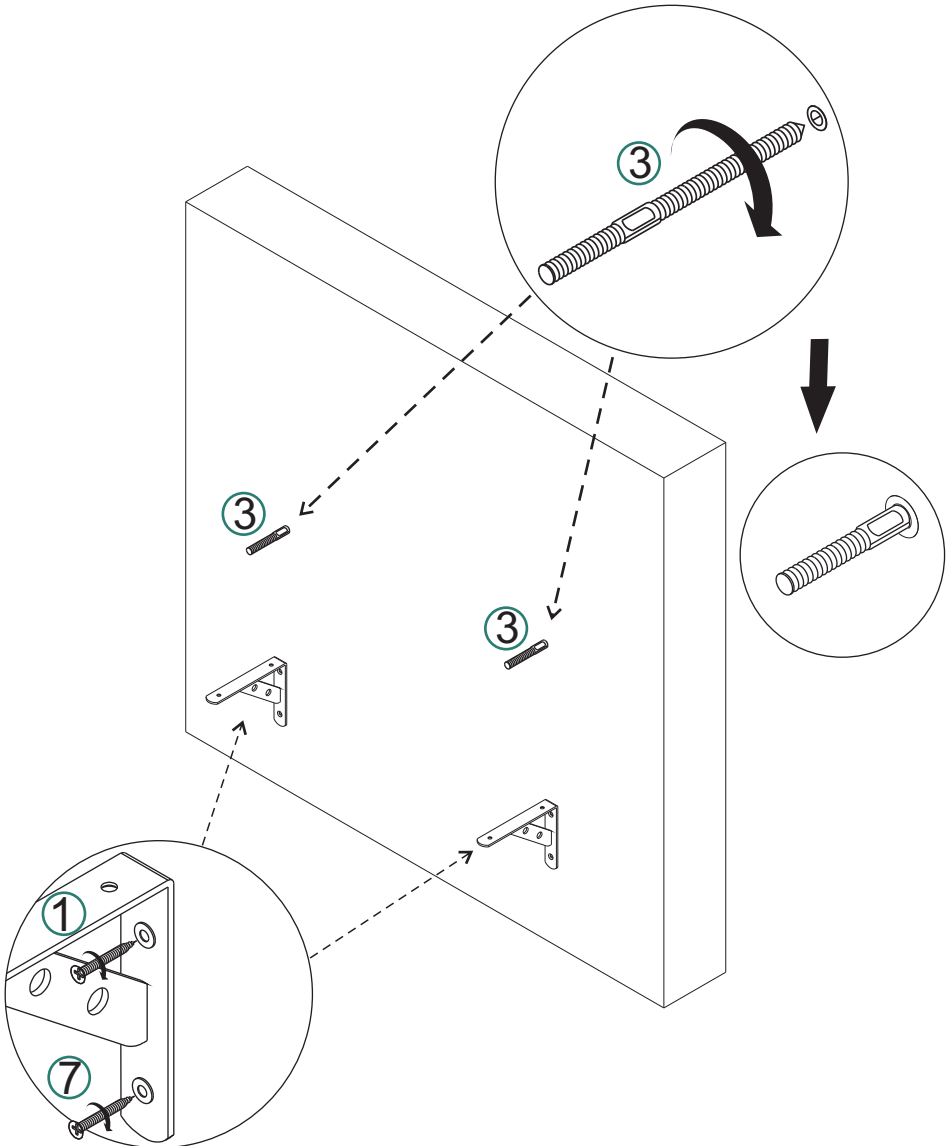

ASSEMBLY INSTRUCTIONS

3

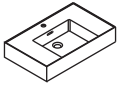

A 1pc



B 1pc



4 2pcs



6 4pcs

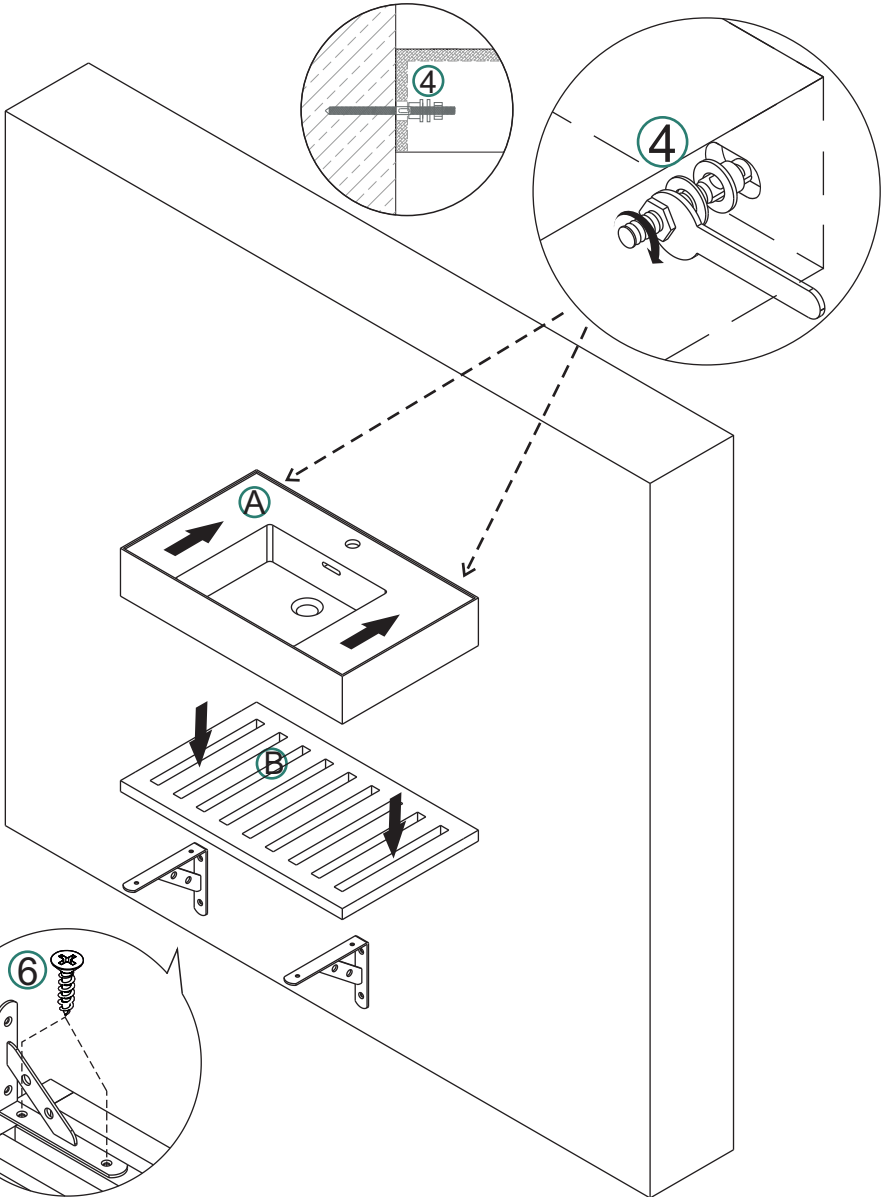

ASSEMBLY INSTRUCTIONS

4

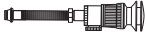

⑧ 1 pcs

