

<b>Product Name:</b>	Outdoor Polyresin Fountain with Lights
<b>SKU #:</b>	WHF2353

Thank you for purchasing this LuxenHöme product. This product has been manufactured with the highest standards of safety and quality.

**PLEASE READ ALL INSTRUCTIONS BEFORE ASSEMBLY.**

Please make sure to unpack all the components from the packaging inside the carton to ensure that there are no missing or damaged parts. Do not attempt to assemble or use the product if any parts are missing or damaged.

**CARTON CONTENTS:**

Description	Quantity
Fountain	1
Pump	1

**Compatible Pumps for this fountain:**

Pump Model No.
JR250/LED
AP333/LED
YH300-70/LED

**Tools required for assembly:** No tools required for assembly.

**Assembly Instructions:**

1. Select a flat, level surface for your fountain's assembly and final location.
2. Insert the water supply tube into the pump outlet from the opening at the back of the fountain. Insert the LED connector into the pump connector and twist it to tighten. Place the pump inside the back of the fountain and draw the pump power cord out of the fountain back.
3. Add clean water to the fountain. The water level should be approximately 30mm lower than the edge of the basin.
4. Connect the power cable to the outlet. If installed properly, the water flow in the fountain will begin shortly.
5. Please do not use the electrical plug in wet weather conditions. Please note: There may be air in the pump on first use. It may take several minutes until all the air escapes.
6. To eliminate the possibility of water damage around your fountain, check for leaks and excessive splashing after the initial setup of your fountain. It is highly recommended that this fountain be placed where it cannot be damaged.
7. Do not leave your fountain running for extended periods when no one is present to observe the performance.
8. Check the area around your fountain regularly to ensure no leakage.
9. Please refresh the fountain with water each week to ensure it is in good condition.
10. Do not add harmful chemicals to the water, as it may alter the finish.

<b>Product Name:</b>	Outdoor Polyresin Fountain with Lights
<b>SKU #:</b>	WHF2353

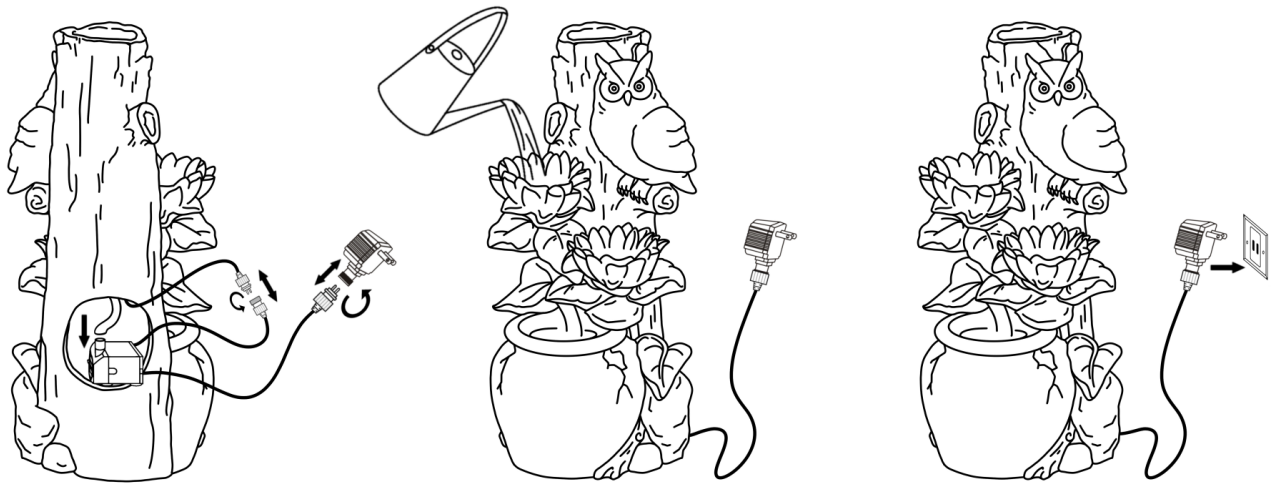

Note: The above diagram is for illustrative purposes only.

<b>Product Name:</b>	Outdoor Polyresin Fountain with Lights
<b>SKU #:</b>	WHF2353

### **MAINTENANCE OF YOUR PUMP:**

- Keep the water clean – clean water will prolong the life of your pump.
- Use a pre-filter on your pump if available.
- Regular cleaning of the pump will be necessary depending on the environment in which it is operated. Clean the pump when it is visibly soiled or when a noticeable drop in performance is detected. **Failure to clean the pump will result in overheating of the pump and the voiding of the warranty!**
- Before cleaning, always disconnect the pump from the power source.
- Disassemble the pump by removing the inlet screen & the impeller housing. Remove the impeller/rotor assembly by gently pulling on the impeller blades. Use a soft cloth or brush to clean the area inside the pump where the impeller/rotor assembly was. Clean the inlet screen, impeller housing & impeller in warm soapy water. Reassemble the pump and inspect it for proper operation.

### **MAINTENANCE OF YOUR FOUNTAIN:**

- Unplug the pump from electric power before servicing, cleaning, or moving.
- Keep water clean - using clean water will reduce mineral deposits and improve water clarity.
- Clean the fountain periodically to prevent mineral deposits and contamination. Use warm, soapy water and a stiff brush for heavily stained surfaces. **Do not use harsh chemicals, as this will damage the finished surface and void the warranty.**
- Add clean water periodically to ensure the pump is fully submerged.
- Disconnect the power and empty the basin if the fountain will not be used for an extended time.
- If installed outdoors and in a freeze area of the country, ensure that all water is removed and the unit is completely dry. **This product is NOT to be operated below 41°F (5°C). Freeze damage may occur.**



### **Special Warnings and Cautions:**

#### **CAUTION:**

- The pump has been evaluated for use with water only.
- Do not use the pump in water exceeding 35°C / 95°F.
- Do not use the pump in flammable liquids.
- Do not use the pump for industrial purposes.
- Do not use the pump in vehicles or on ships, aircraft, or swimming pools.
- Do not use the pump in a location where special conditions prevail, such as the presence of a corrosive or explosive atmosphere (dust, vapor, or gas).
- Do not let the pump run dry. The pump must be completely submerged for proper operation and cooling.
- Do not use the power cord to lift the pump.
- Keep the plug dry. Do not expose the plug to water or steam.



## Instruction Manual

**SAVE THESE INSTRUCTIONS**—This manual contains important safety and operating instructions for power units.

<b>Product Name:</b>	Outdoor Polyresin Fountain with Lights
<b>SKU #:</b>	WHF2353

- Before connecting to the power source, ensure the pump is assembled and completely submerged in water.
- Check the water level regularly to ensure the pump is completely submerged during operation. The pump should be fully submerged during operation. Do not add water while operating the product. Always disconnect the pump from the power source before adding water.

### **WARNINGS:**

- To reduce the risk of electric shock, connect only to a properly grounded, grounding-type receptacle.
- To reduce the risk of electric shock, use only on portable self-contained fountains no larger than 5 feet in any dimension.
- Do not exceed the voltage shown on the pump.
- Always disconnect the pump from the power source before beginning any maintenance or work on the pump or fountain.
- Inspect the power cord for damage before installation and/or maintenance. Replace the entire pump if damage is found.
- For pumps with a 3-prong, grounded type plug, do not remove the grounding pin from the plug on the power cord.

### **TIPS AND TROUBLESHOOTING:**

1. Ensure the pump's flow control switch is set to maximum (+) before operating. Once the flow is established, the pump can be adjusted downward to the desired level.
2. If the pump operates but there is no flow, check to ensure the pump is fully submerged.
3. If the pump operates, but there is no flow, check the supply tubing for kinks and correct it.
4. If the pump operates, but there is no flow, and if the pump is submerged and there are no kinks in the supply tubing, lift the pump from the water. Remove supply tubing at the pump outlet and clean tubing inside and out if necessary. Reset pump in water (outlet side up) and once water begins to flow, re-attach the supply tubing.