

Installation Instruction

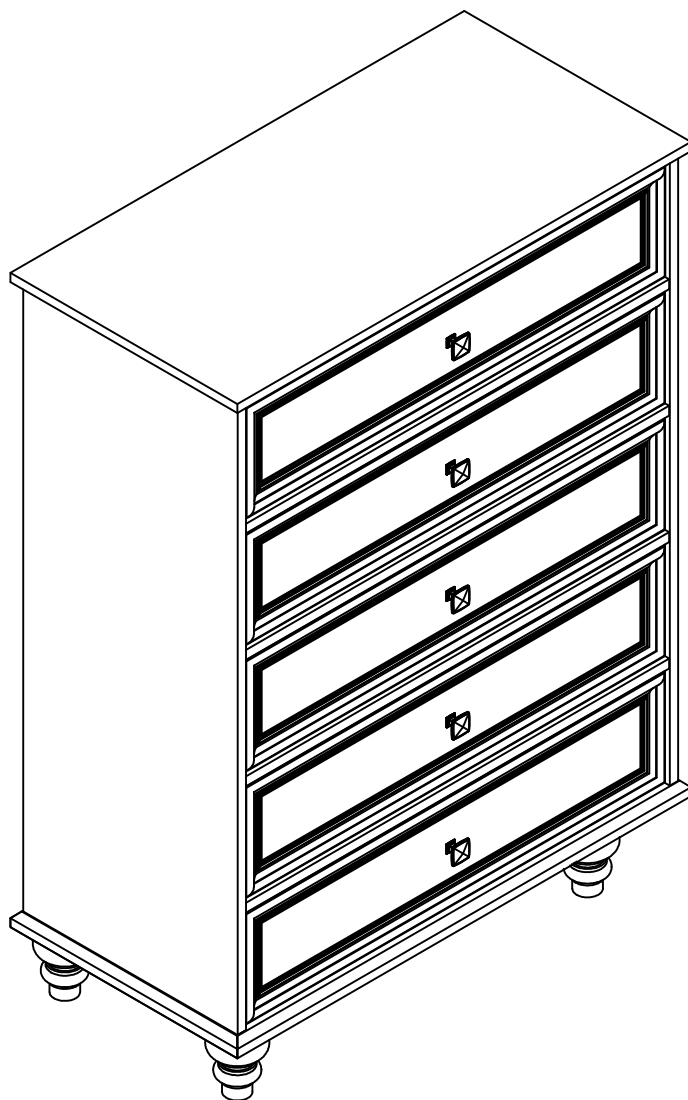

Assembling

Estimated time for assembly



45 : 00

What you need

- Use the packaging carton as a working surface to prevent product damage during assembly
- Phillips head screwdriver

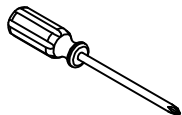

Weight Limitation



100 | **35**
lbs table top lbs per

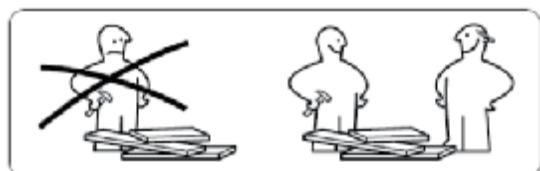

What' included

Code	Description	Qty
A	Cam Bolt M6X35MM	53
B	Cam Lock 15X10MM	53
C	Wooden Dowel M8X30MM	8
D	Screw M4X40MM	31
E	Screw M4X8MM	5
F	The metal plate	4
G	Nylon Strap	2
H	Screw M3.0X14MM	54
I	Metal shake handhandle	5
J	The back button	12
K	Anchor	2
L	MATS	4
M	Screw M3.5X14MM	16
N	Hole position sticker	53
CL	Left mother extended orbit	5
CR	Right mother extended orbit	5
DL	Left public extension track	5
DR	Right public extends track	5

The Hardware

(A)

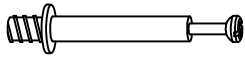

(B)

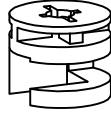

(C)

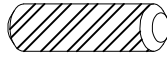

(D)

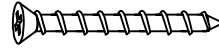

(E)



(F)

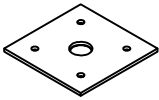

(G)

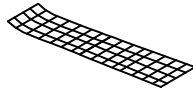

(H)



(I)

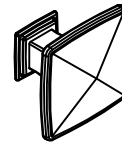

(J)

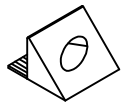

(K)

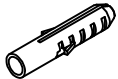

(L)



(M)



(N)

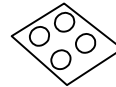

(CL)

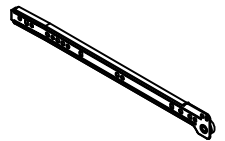

(CR)

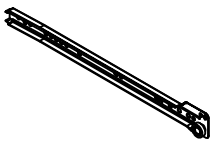

(DL)

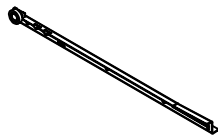

(DR)

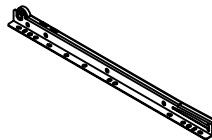

IMPORTANT:

1. Do not tighten bolts / screws completely until all bolts / screws are lined up and inserted into holes.
2. Do not over tighten screws and bolts to avoid stripping
3. Please use hand tools to assemble this product. Do not use power tools.

Included Accessories

Code	Description	Qty
1	Cabinet Top	1
2	Bottom Panel	1
3	Left Side Panel	1
4	Right Side Panel	1
5	Back Panel	3
6	Drawer left panel	5
7	Drawer right side panel	5
8	The drawer bottom	5
9	After the drawer board	5
10	Solid wood feet	4
11	Drawer panel	5
12	At the bottom of the drawer	5
13	Drawer face trim board	4
14	ack stiffener	2

The Accessoriess

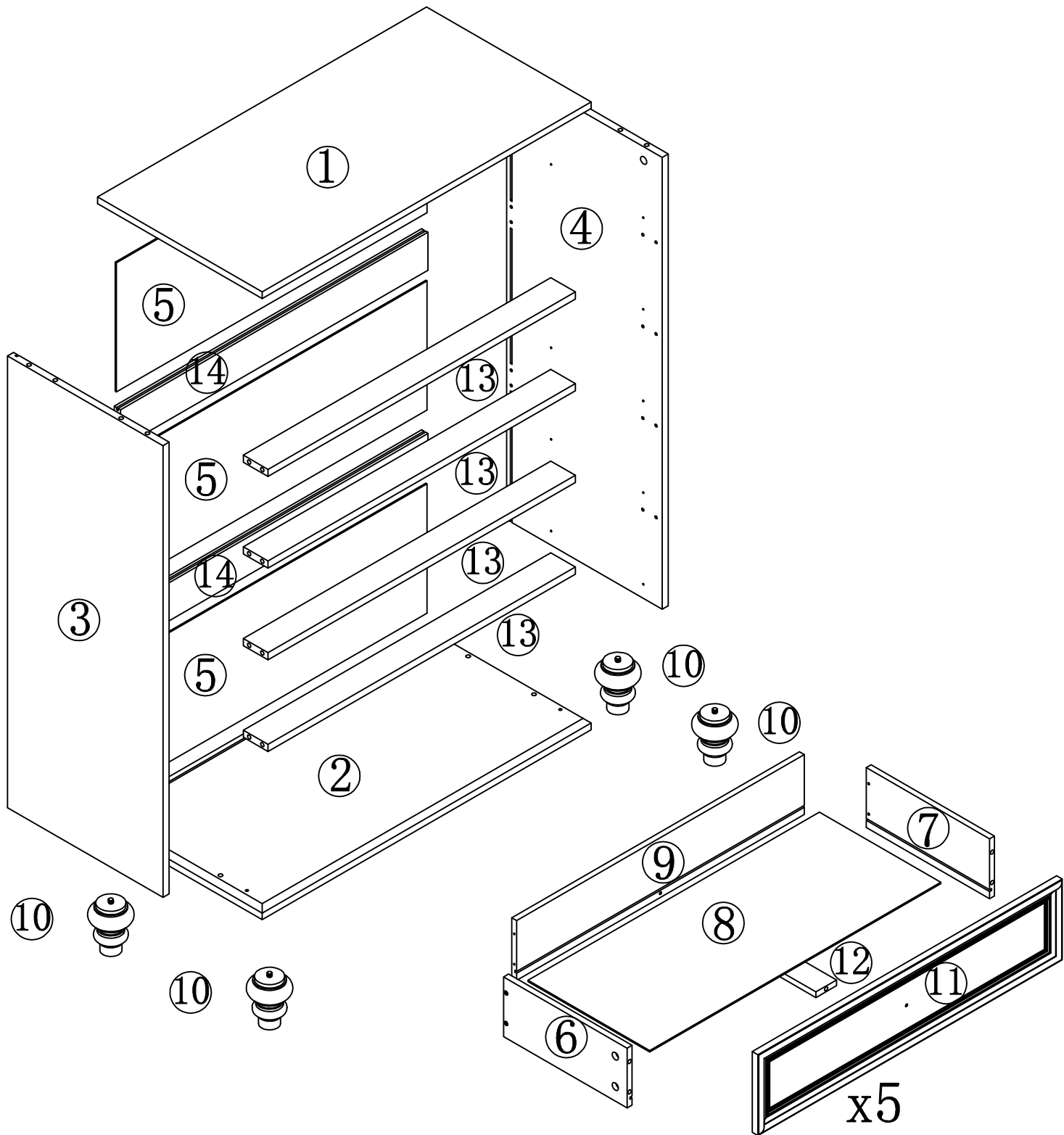

Step 1

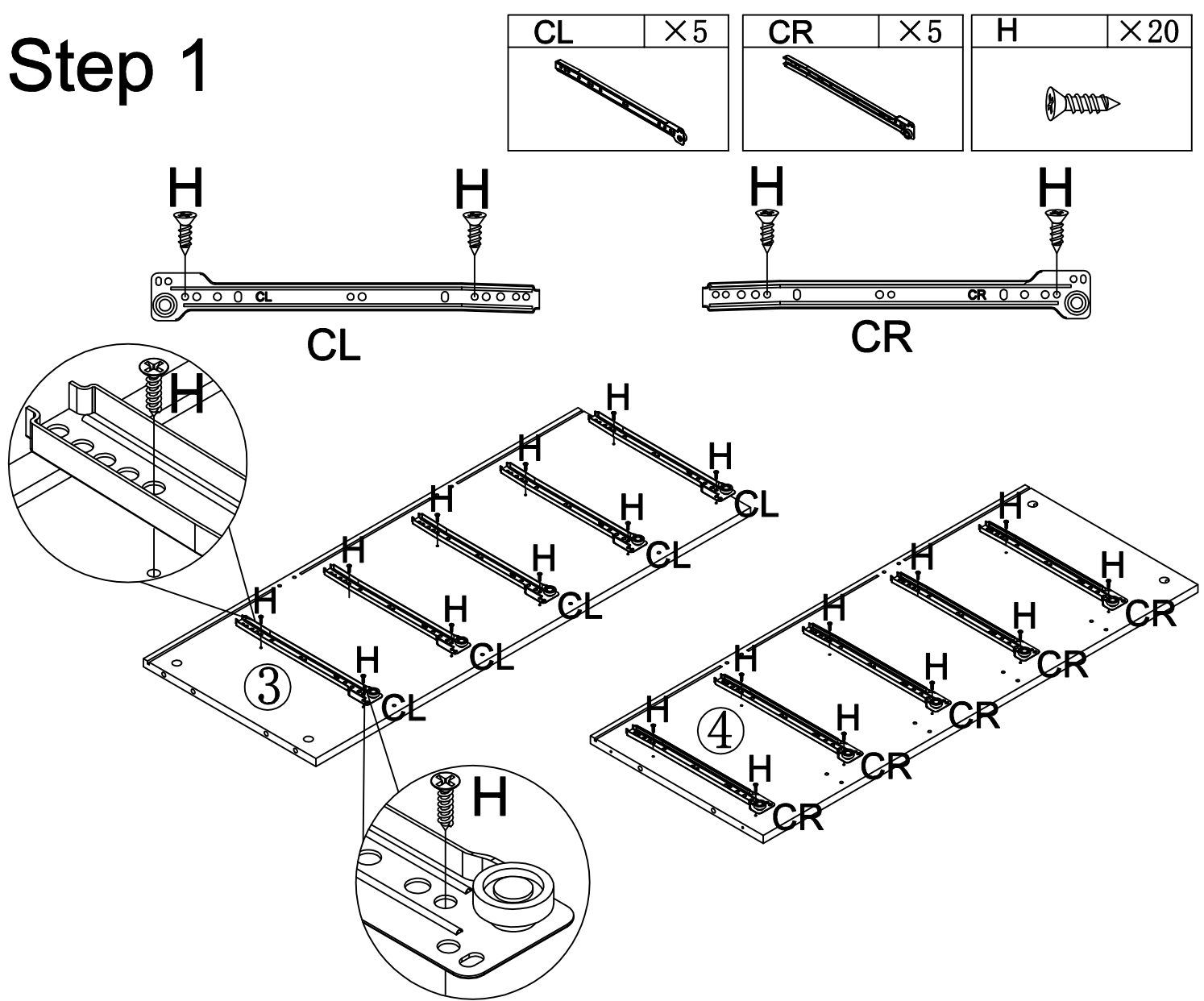

Step 2

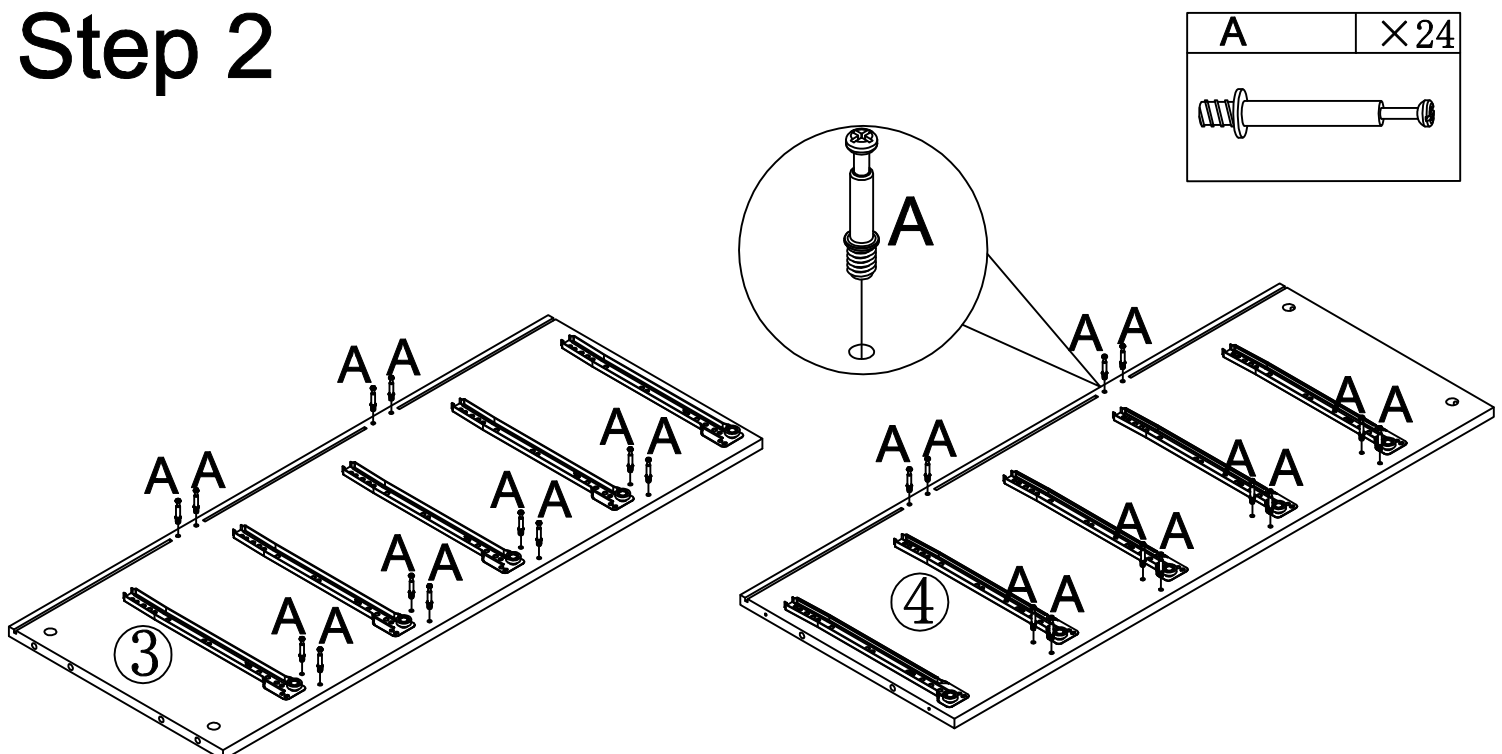

Step 3

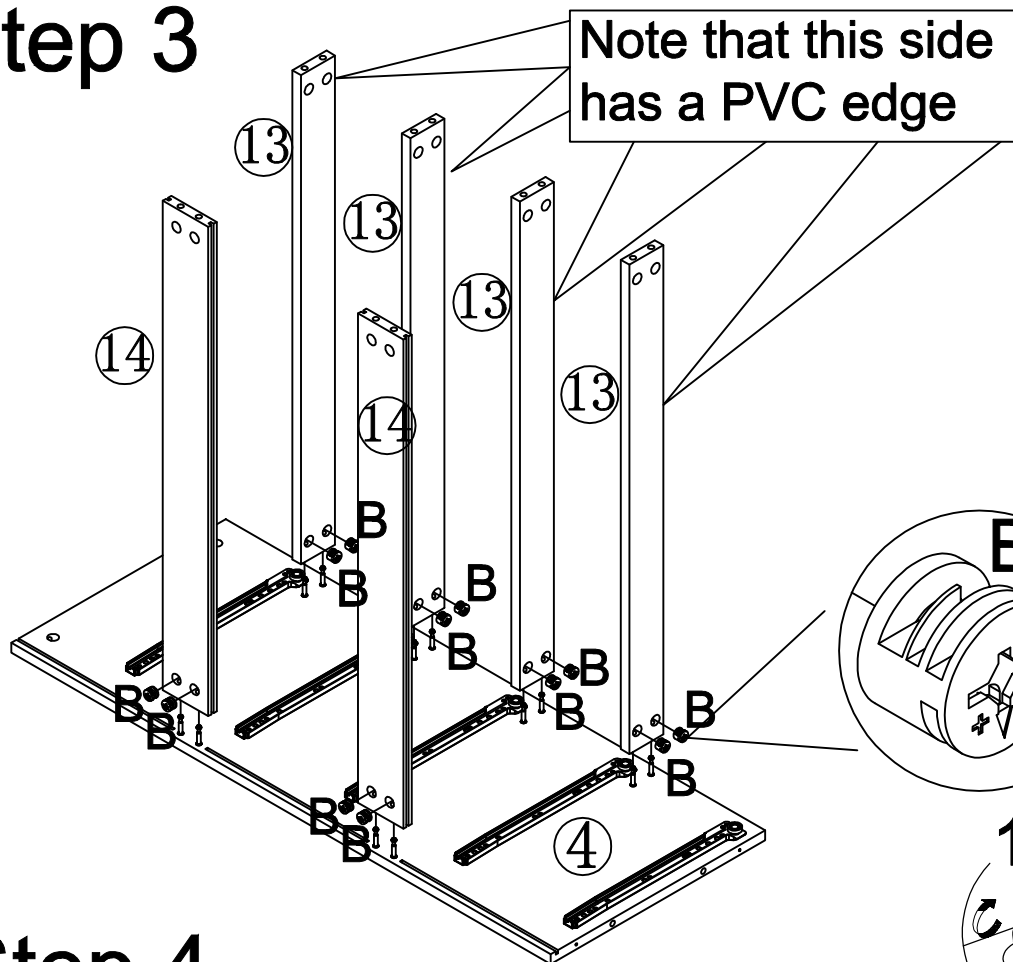

B	×12
N	×12

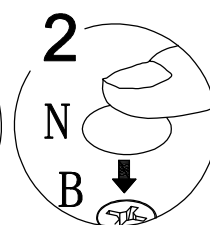
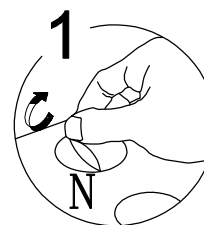
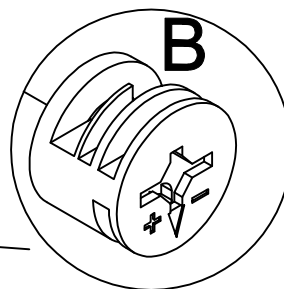

Step 4

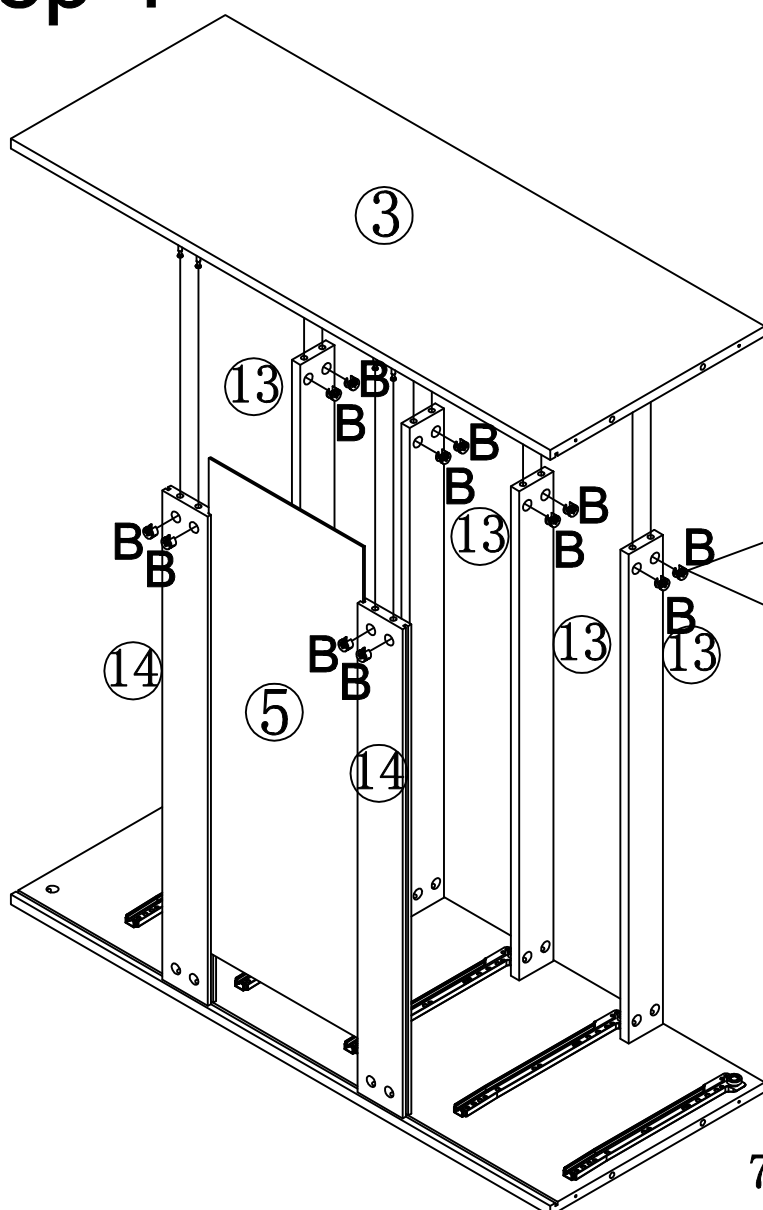

B	×12
N	×12

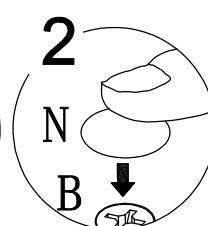
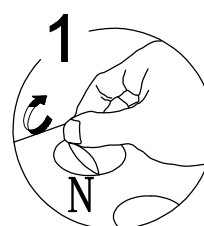
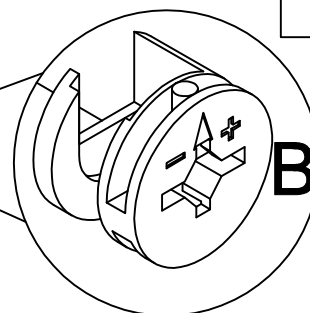

Step 5

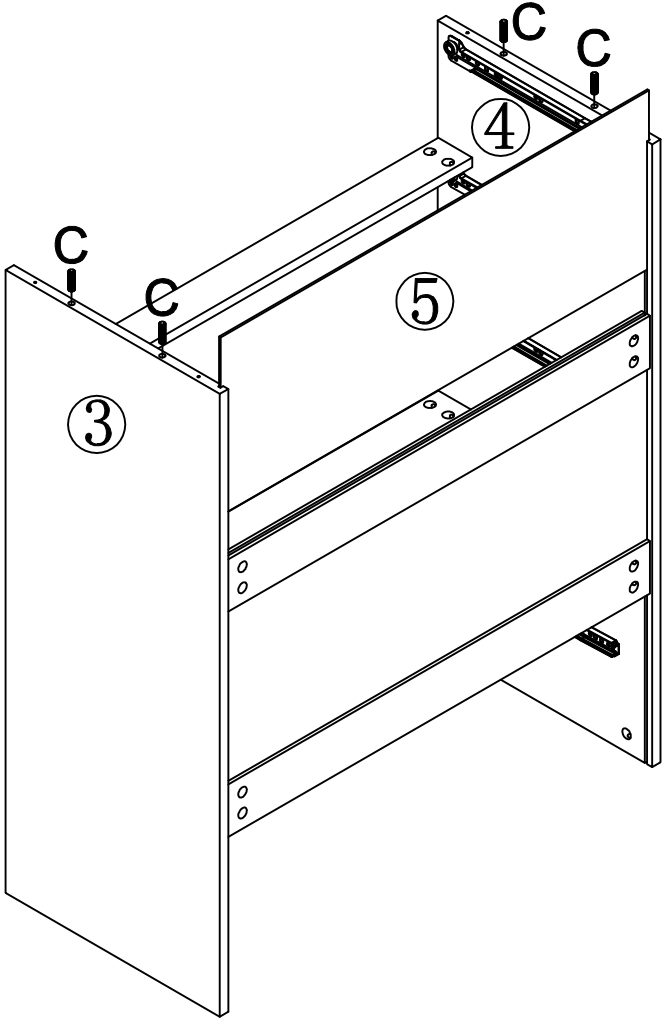
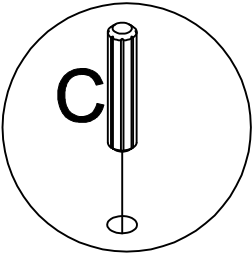

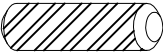
C	×4
	

Step 6

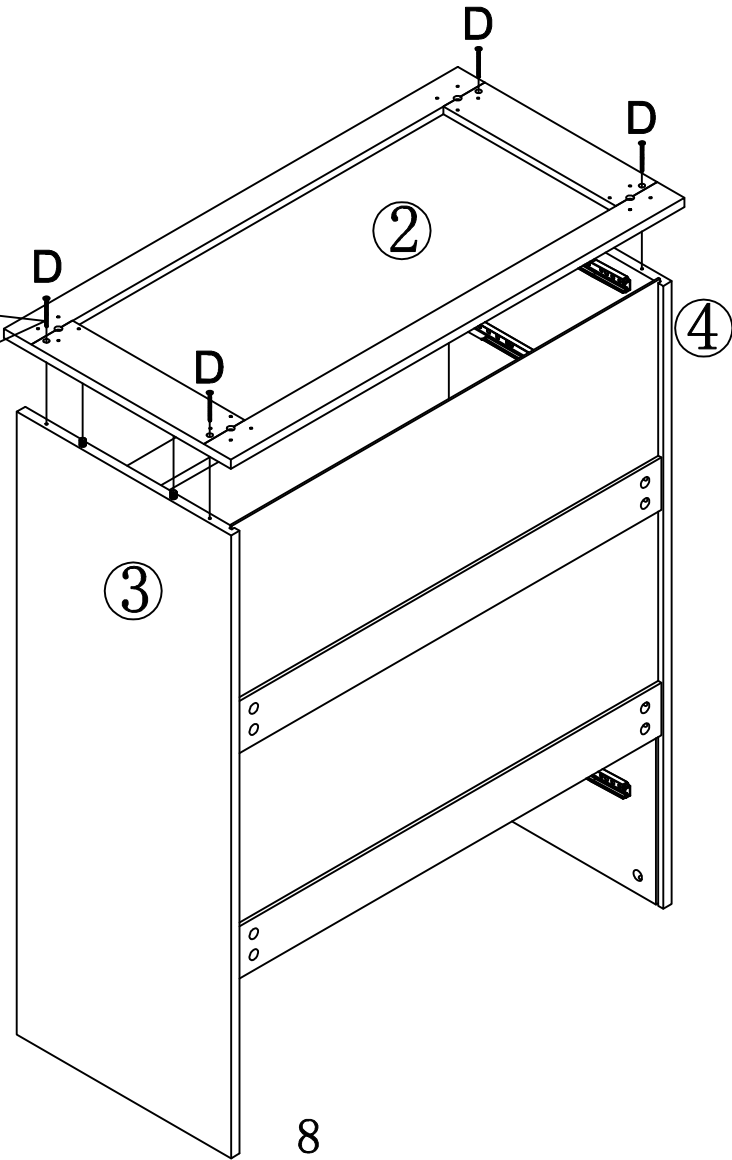
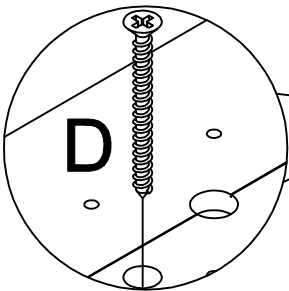

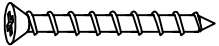
D	×4
	

Step 7

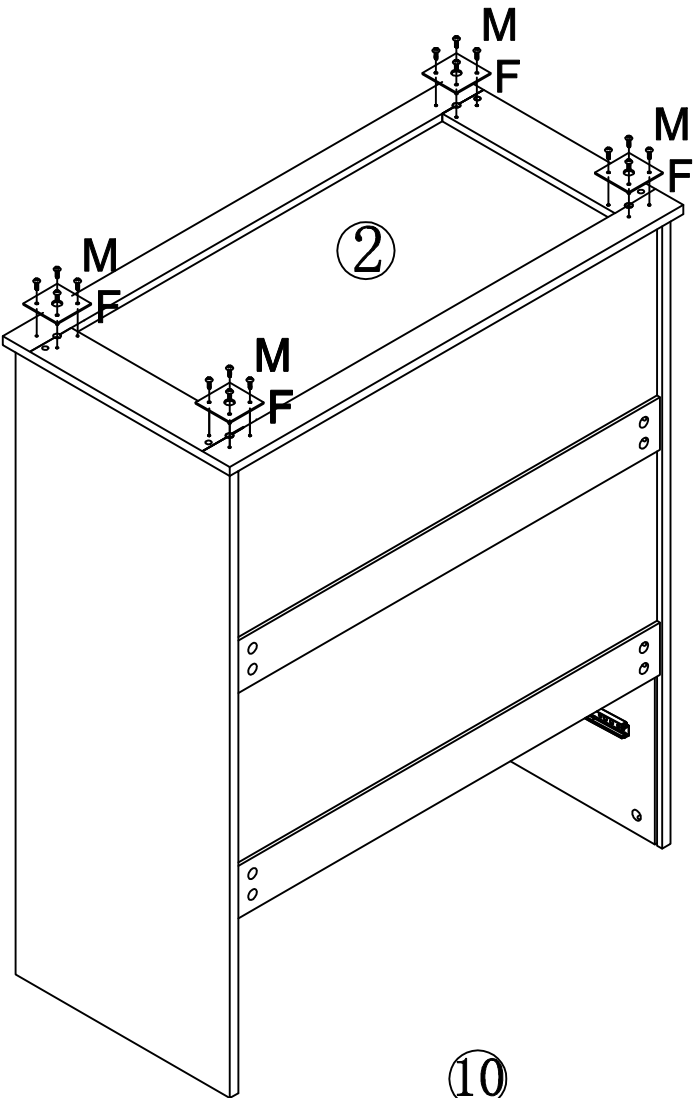

F	×4
M	×16

Step 8

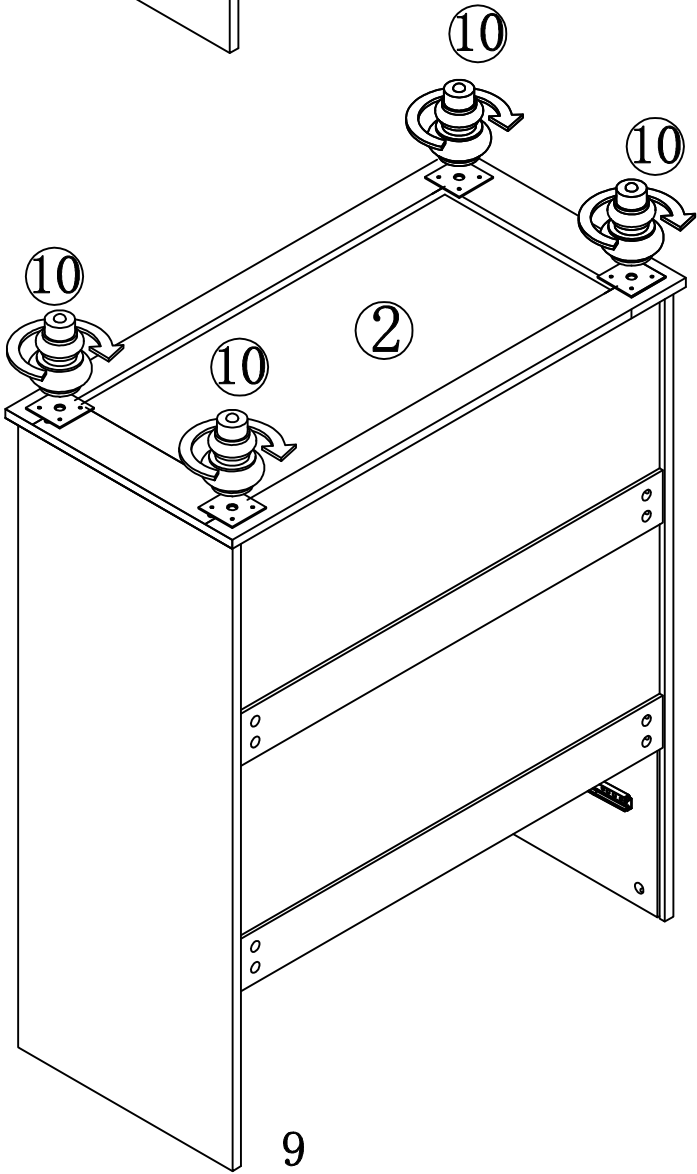

L	×4

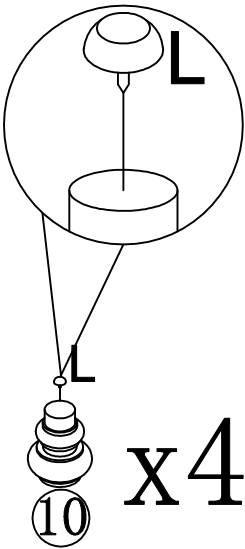

Step 9

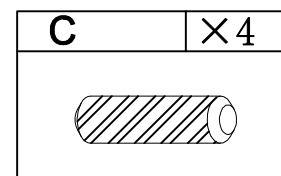
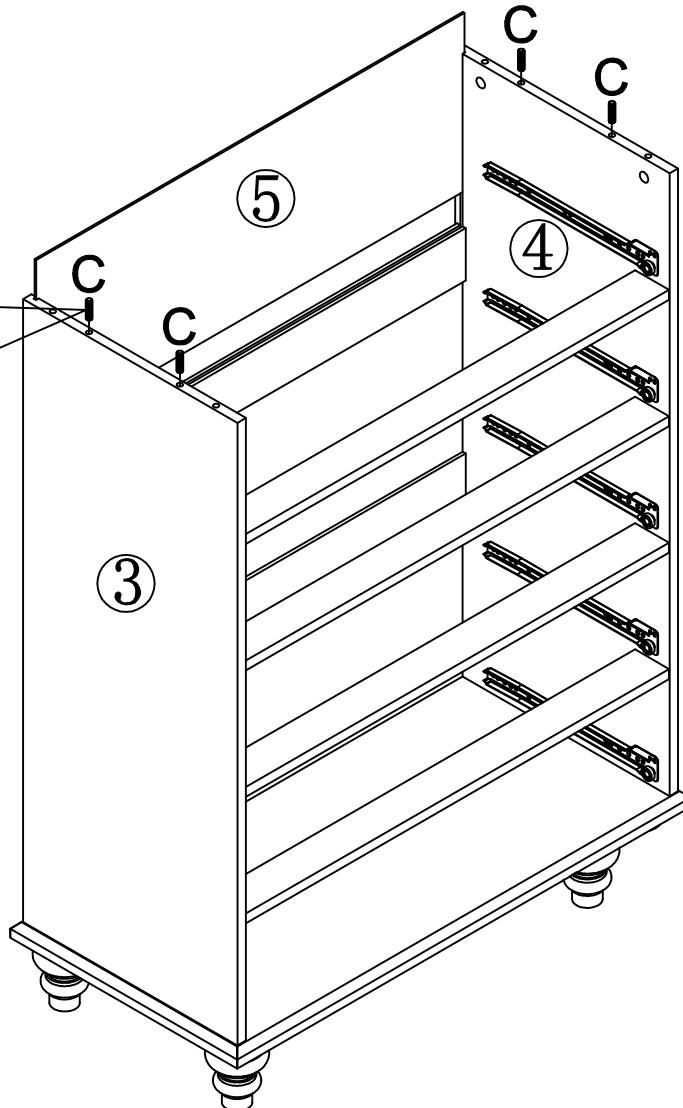
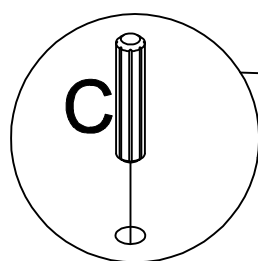

Step 10

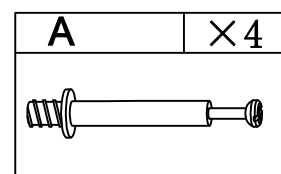
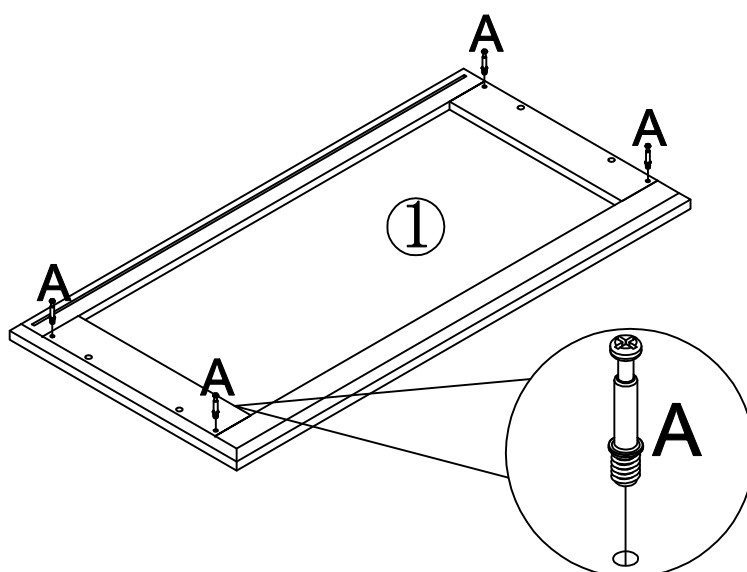

Step 11

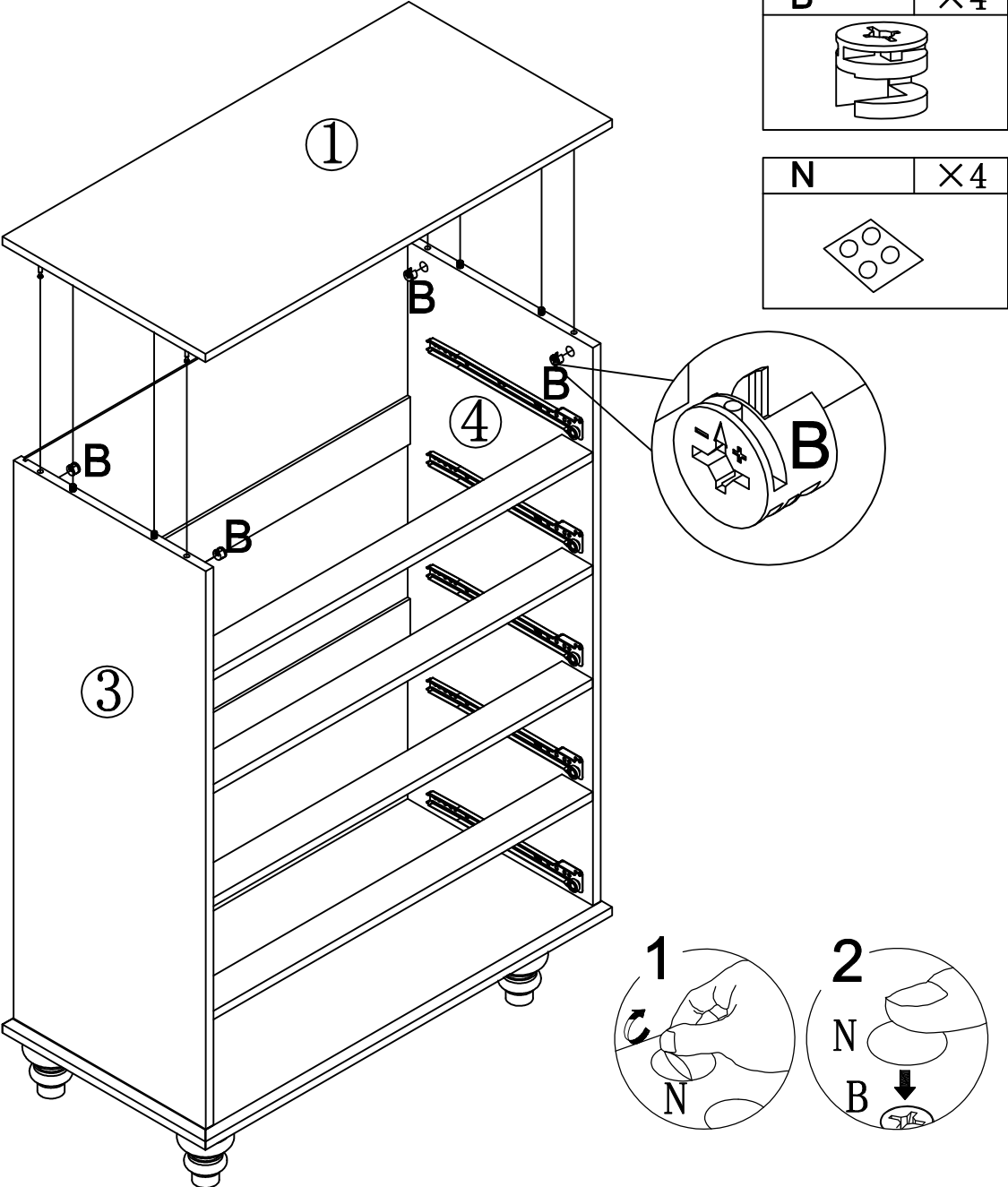

Step 12

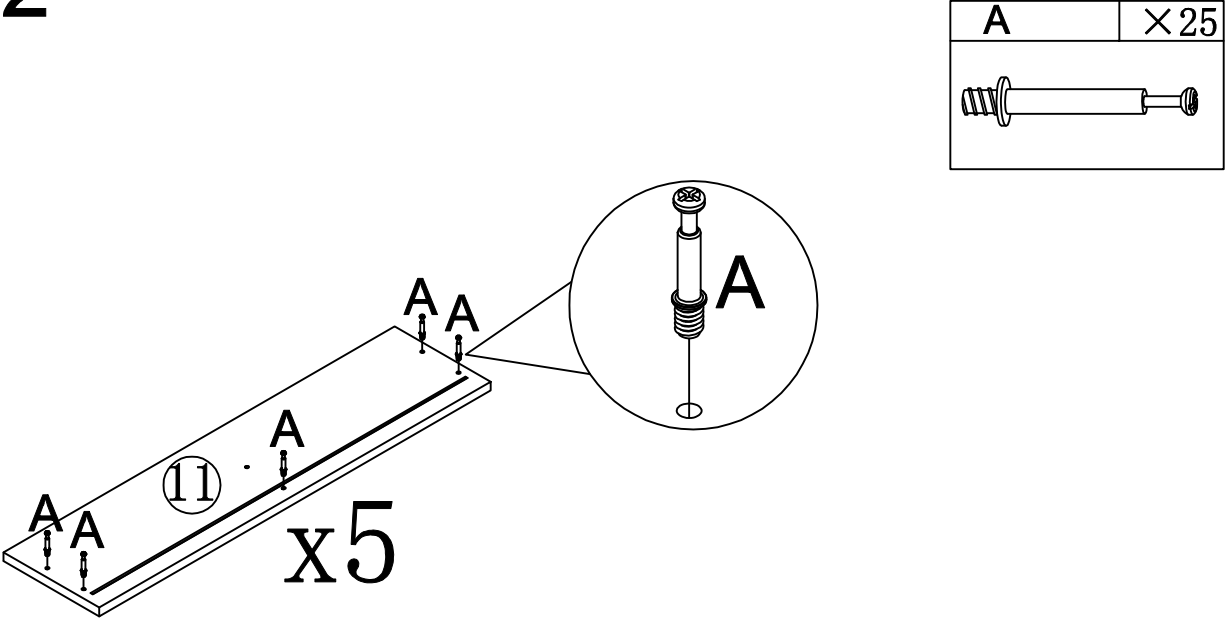

Step 13

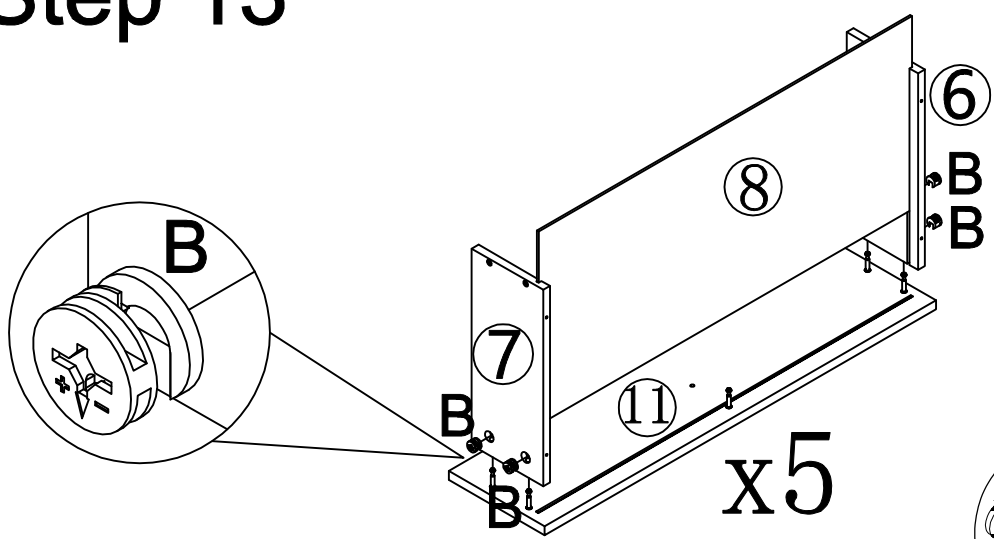

B	× 20
N	× 20

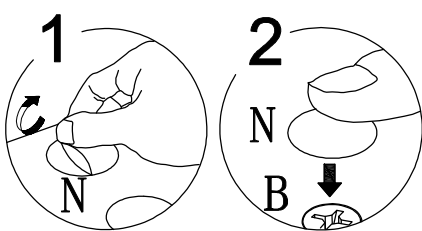

Step 14

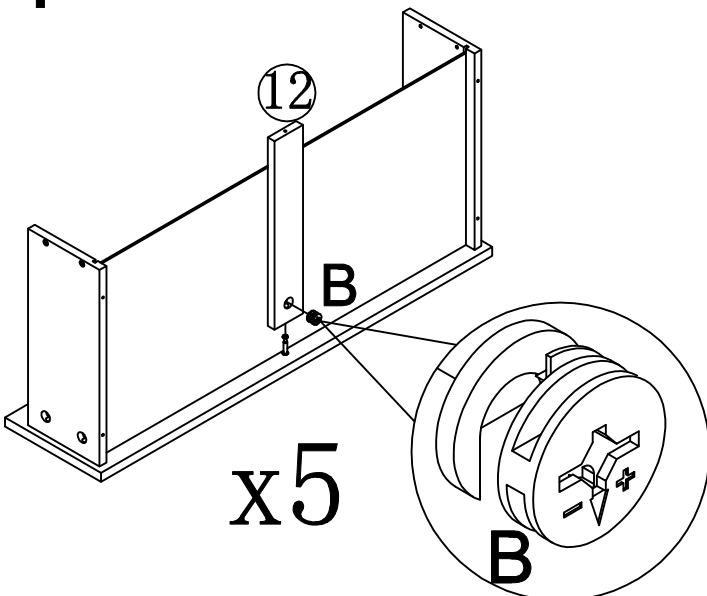

B	× 5
N	× 5

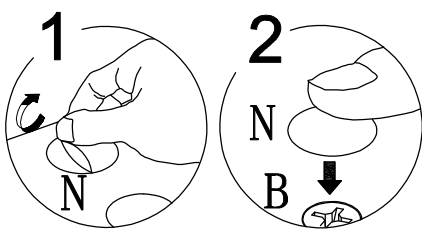

Step 15

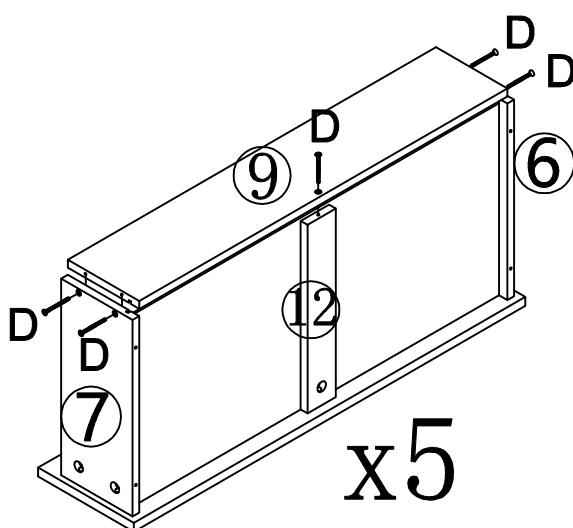

D	× 25

Step 16

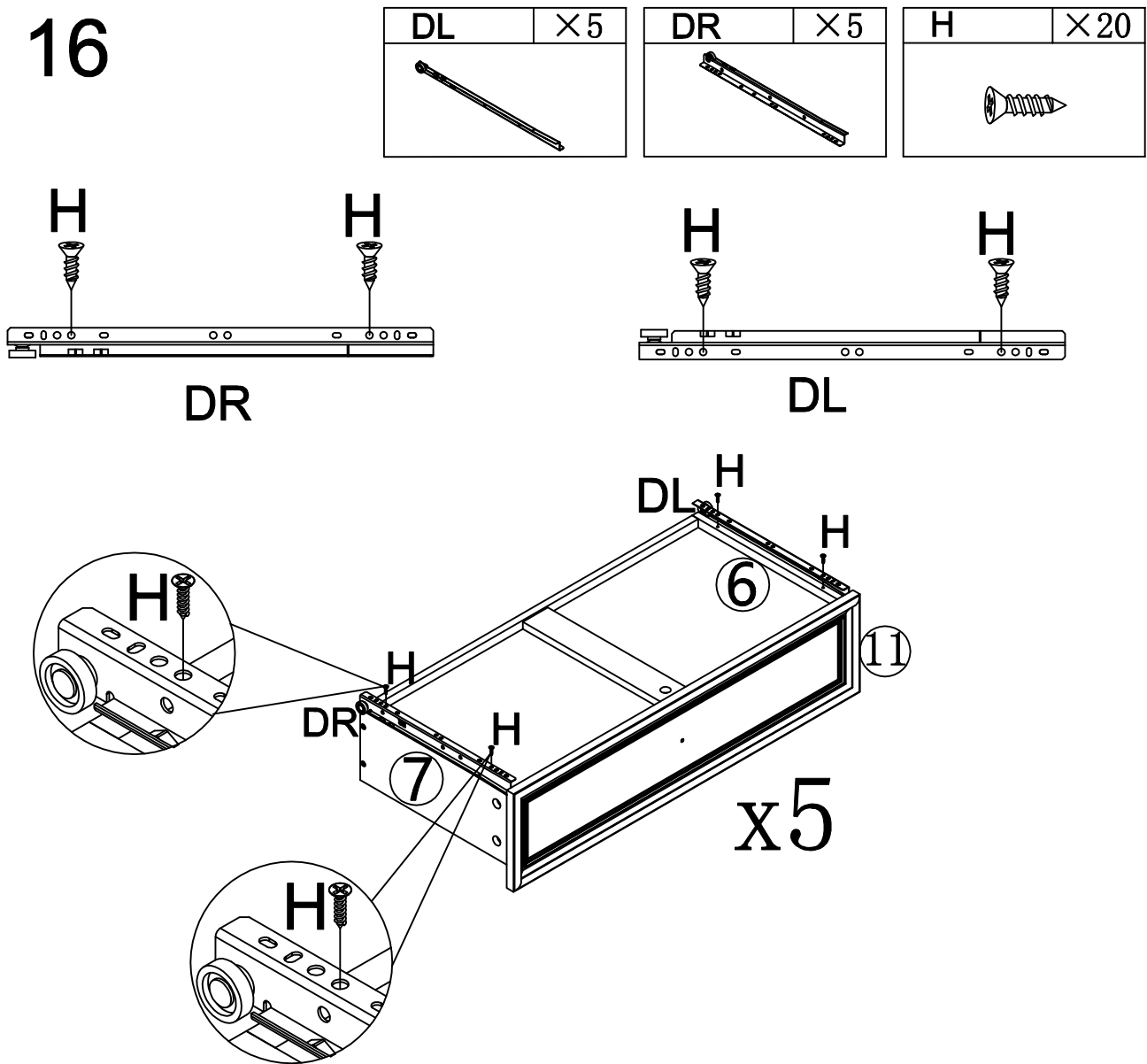

Step 17

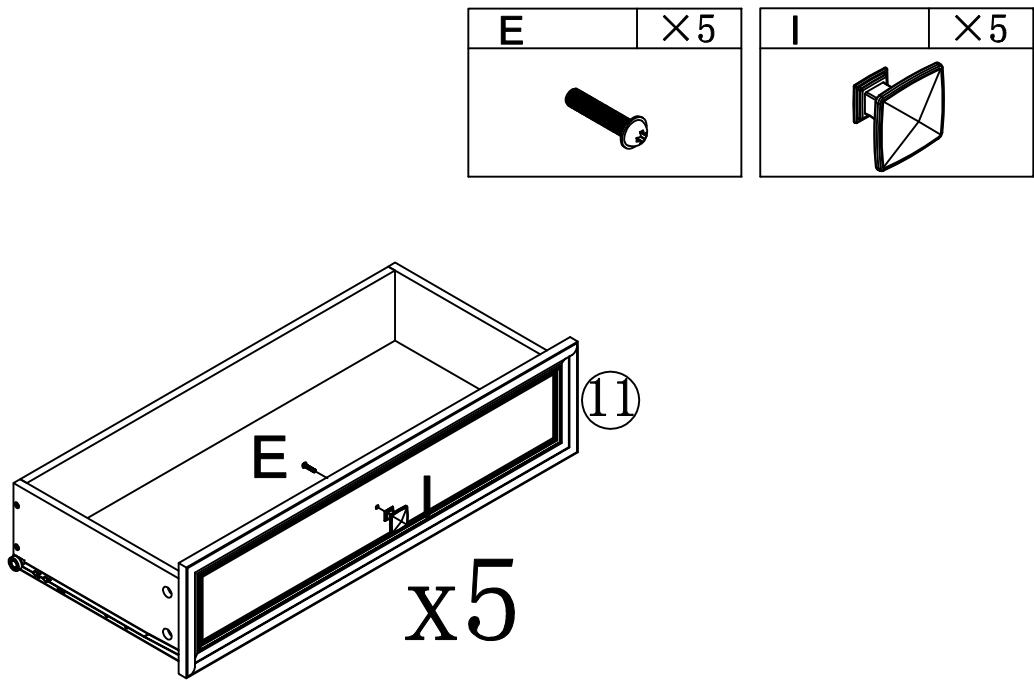

Step 18

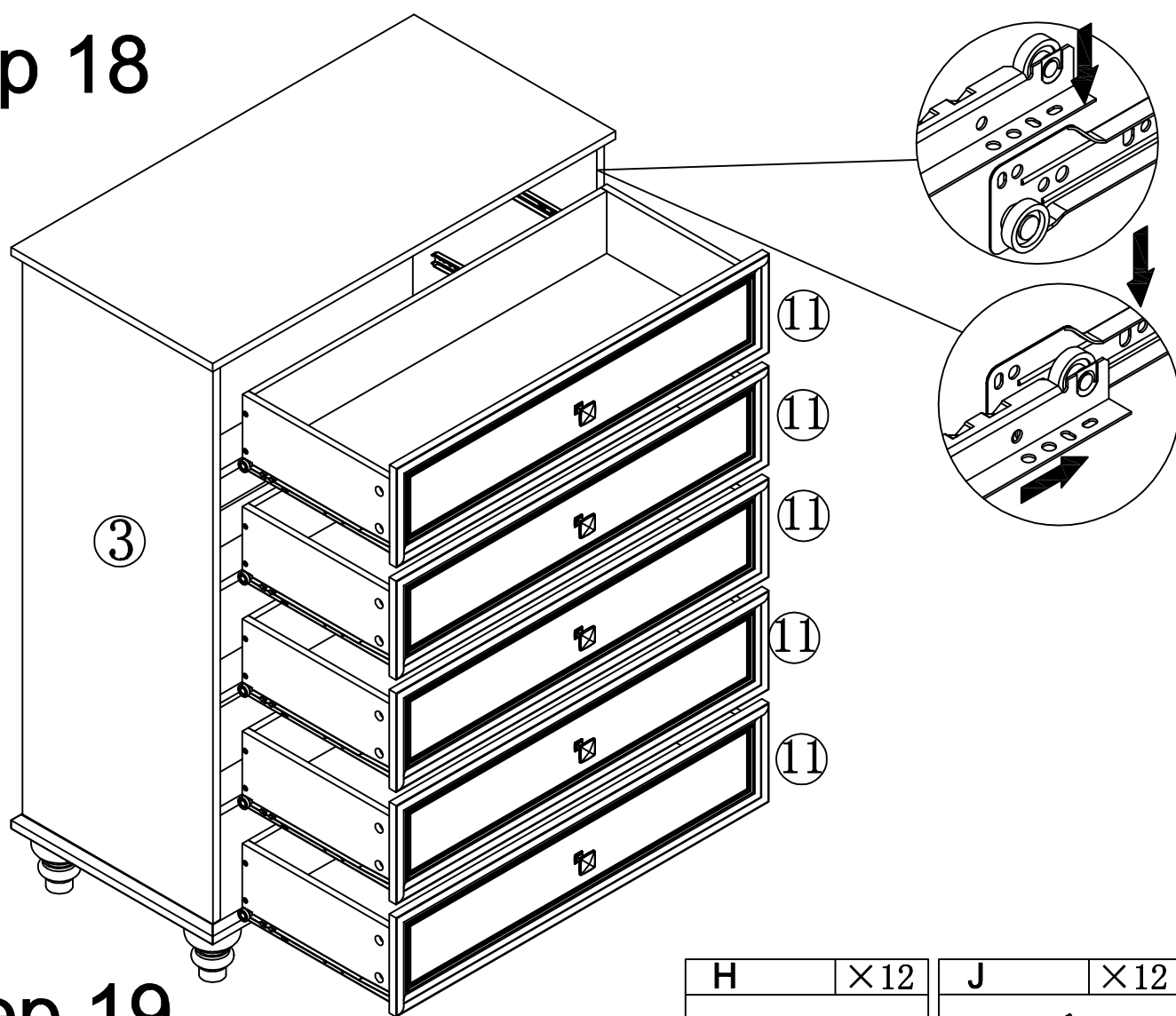

Step 19

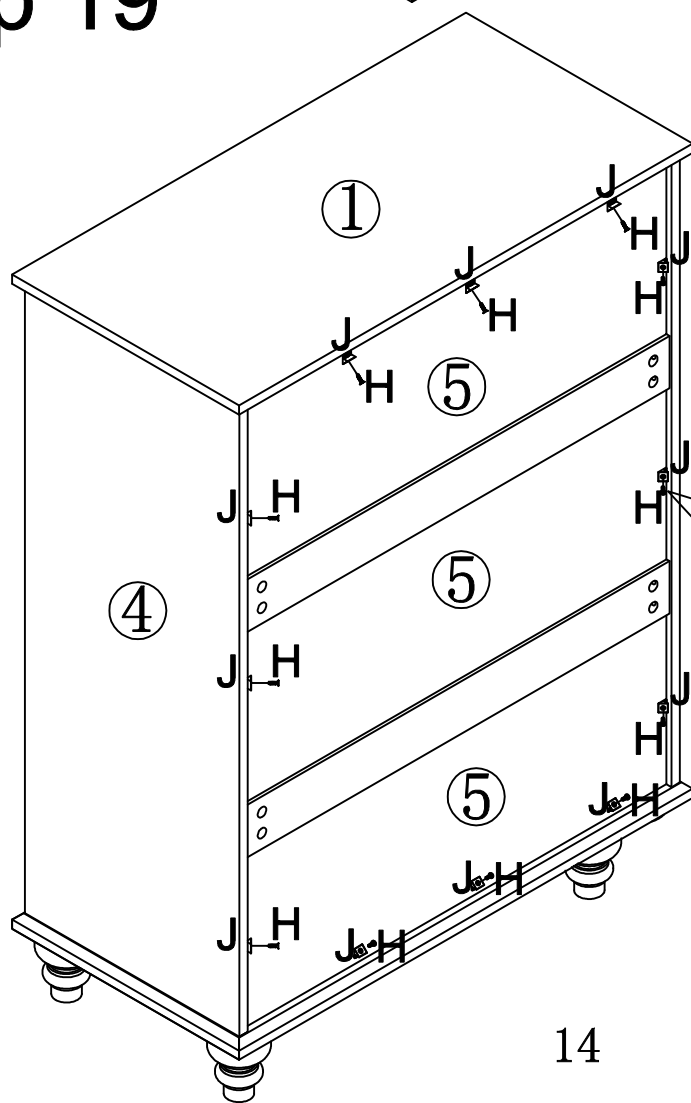

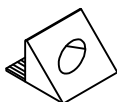
H	×12	J	×12
			

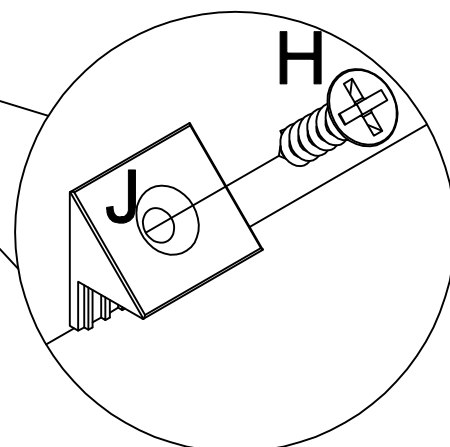

Step 20

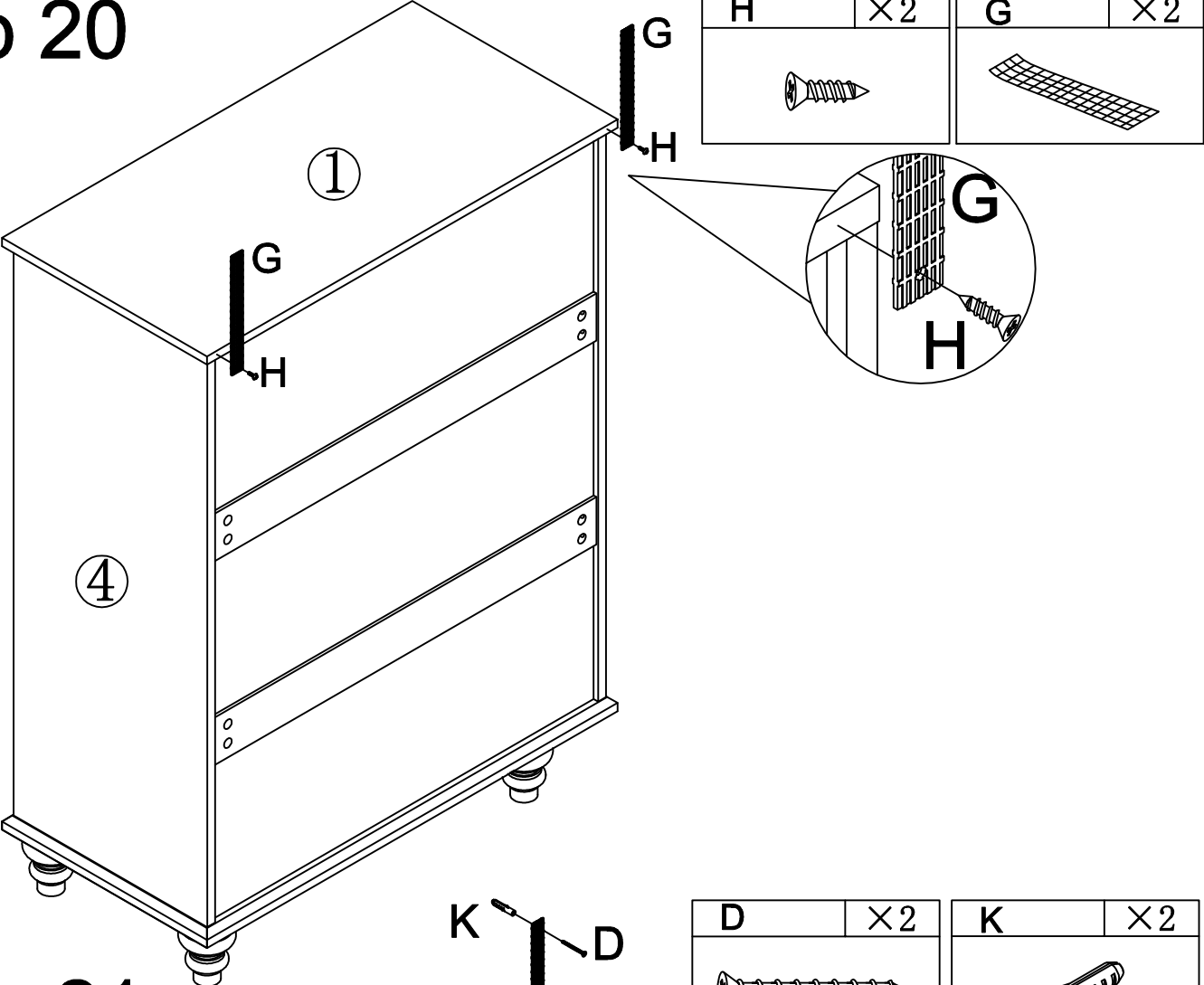

Step 21

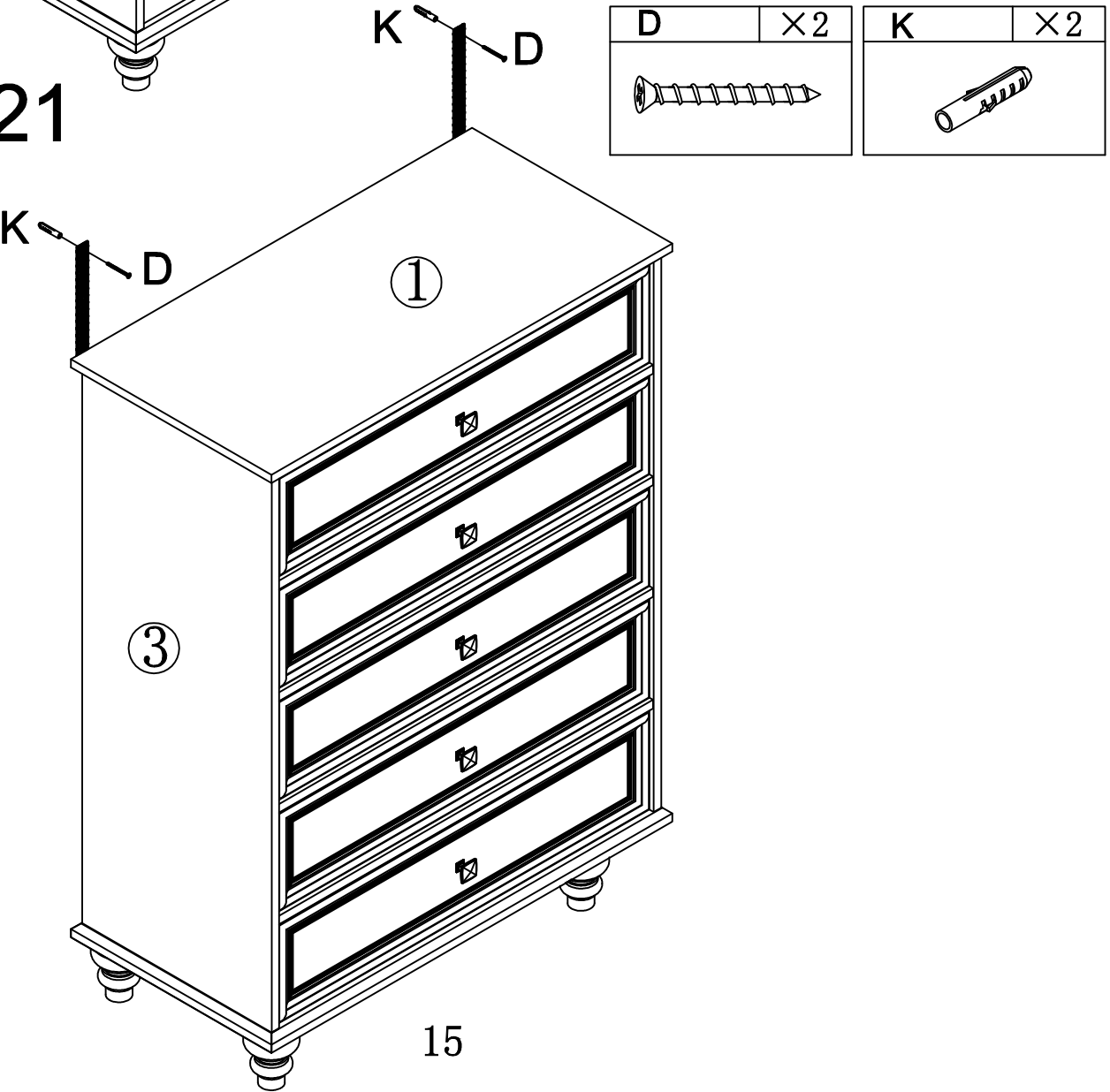

Step 22

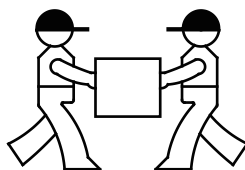
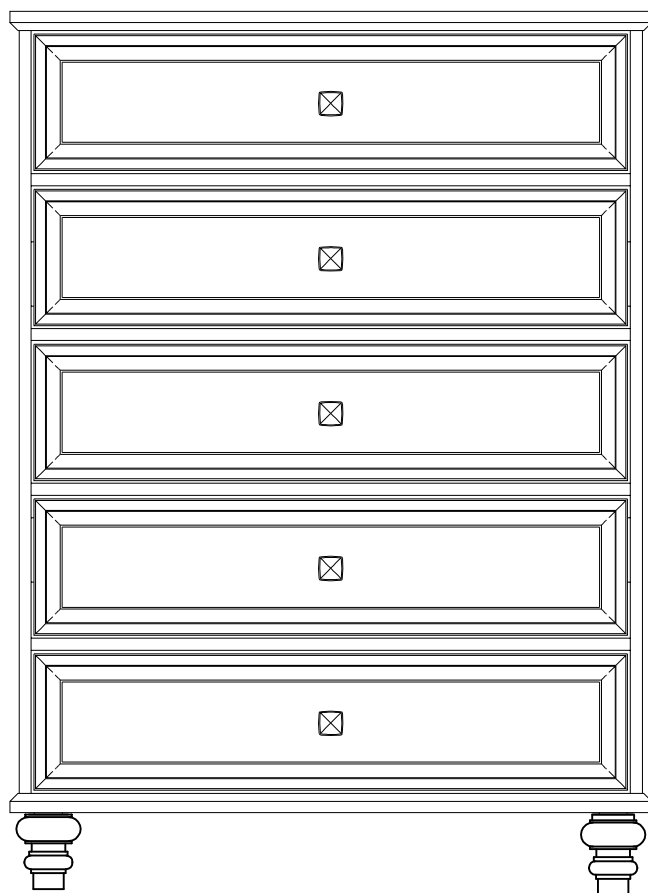

Two people work together to move the table.
Make sure you lift it off the ground.
Don't push and pull.