



## SAFETY INSTRUCTIONS

---

- ⚠ Please read the instruction carefully before using.
- ⚠ Before assembly compare the contents with list to make sure the package includes all the parts.
- ⚠ Make sure the wall can bear the weight of the mirror.
- ⚠ Do not use string or chain to hang the products.
- ⚠ Please keep your property away during the installation to avoid any damage.

# ILLUSTRATE

---

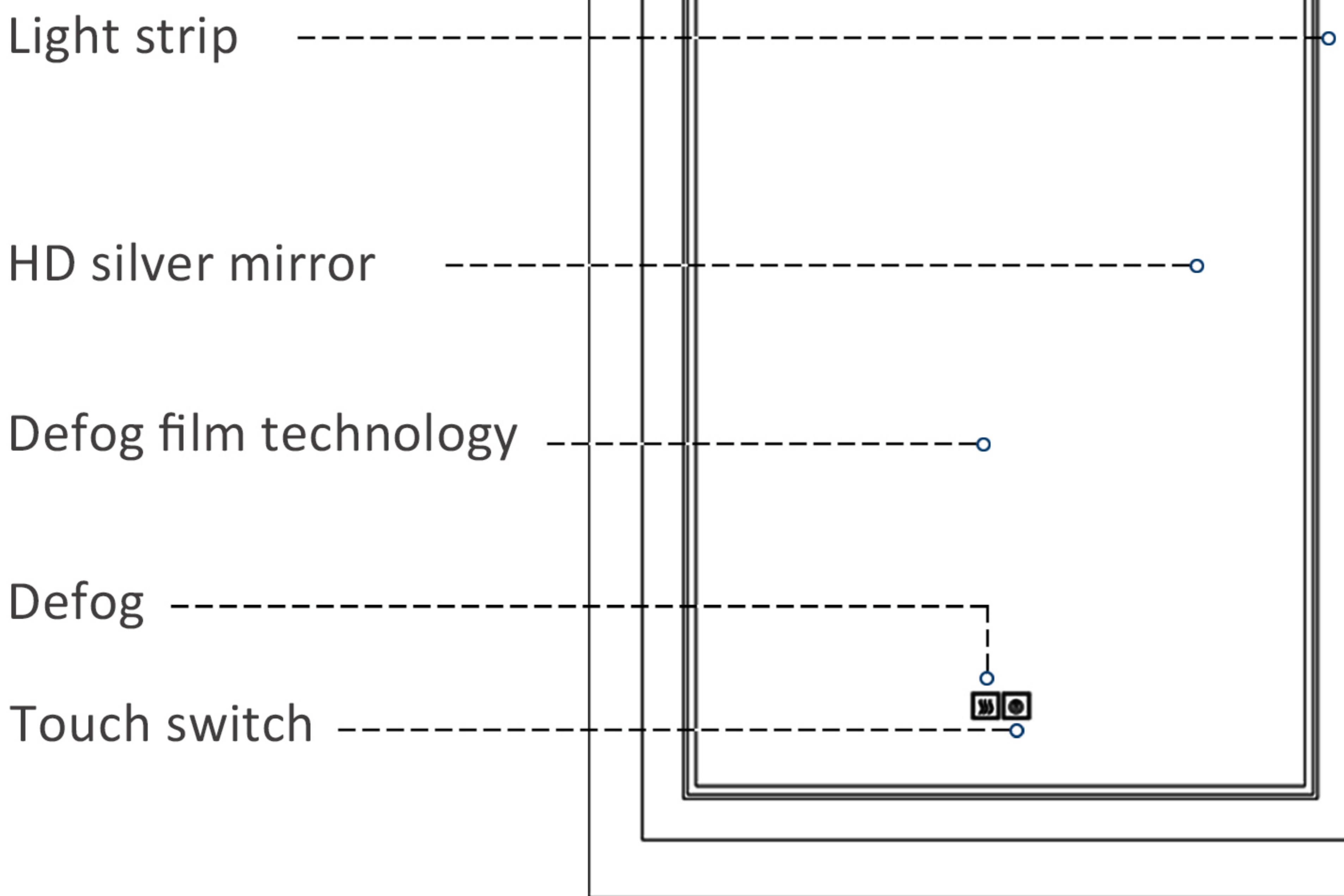

Energy saving



Touch screen switch

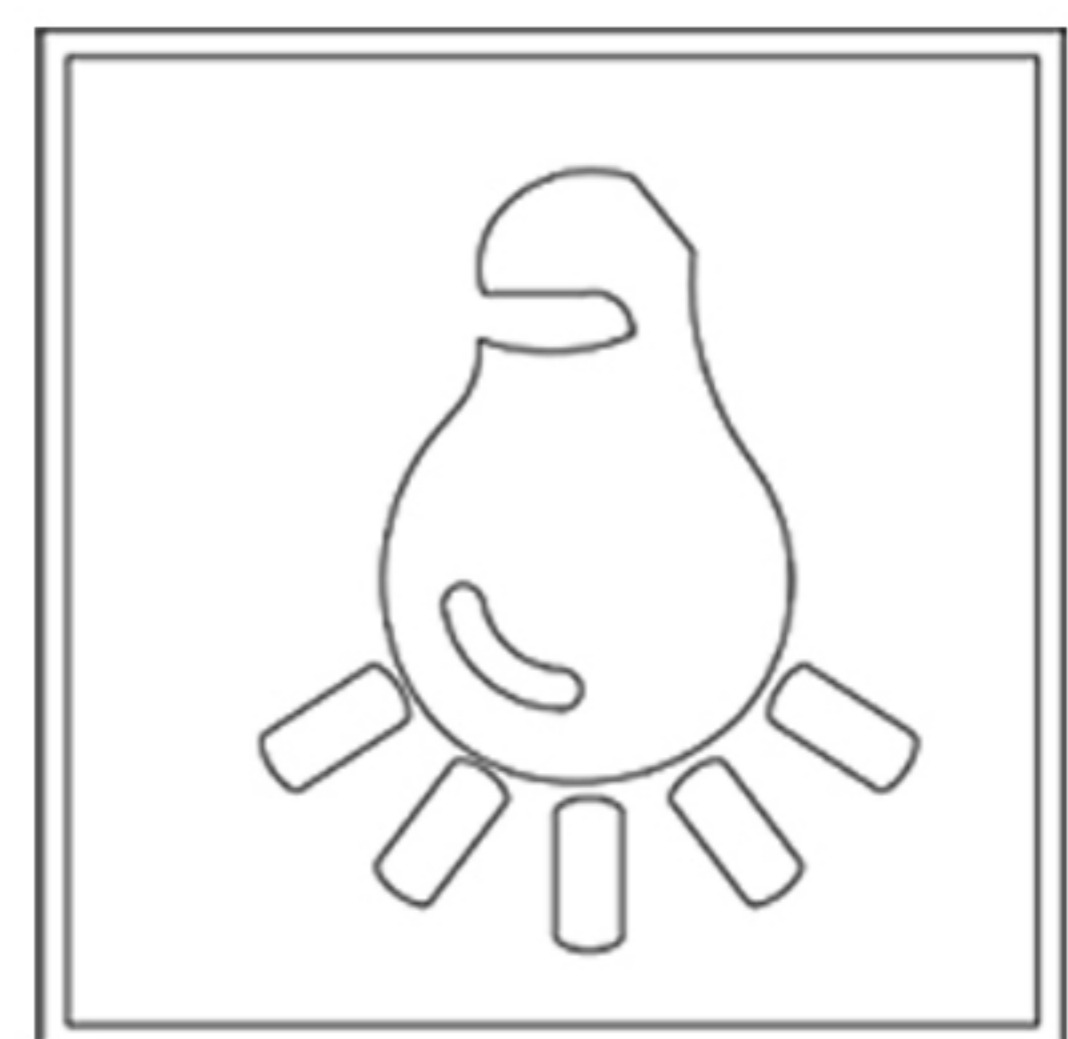

LED lighting

**First touch:** turn on the LED light-white light

**Second touch:** changes to warm light

**Third touch:** changes to natural light

**Fourth touch:** turn off the light

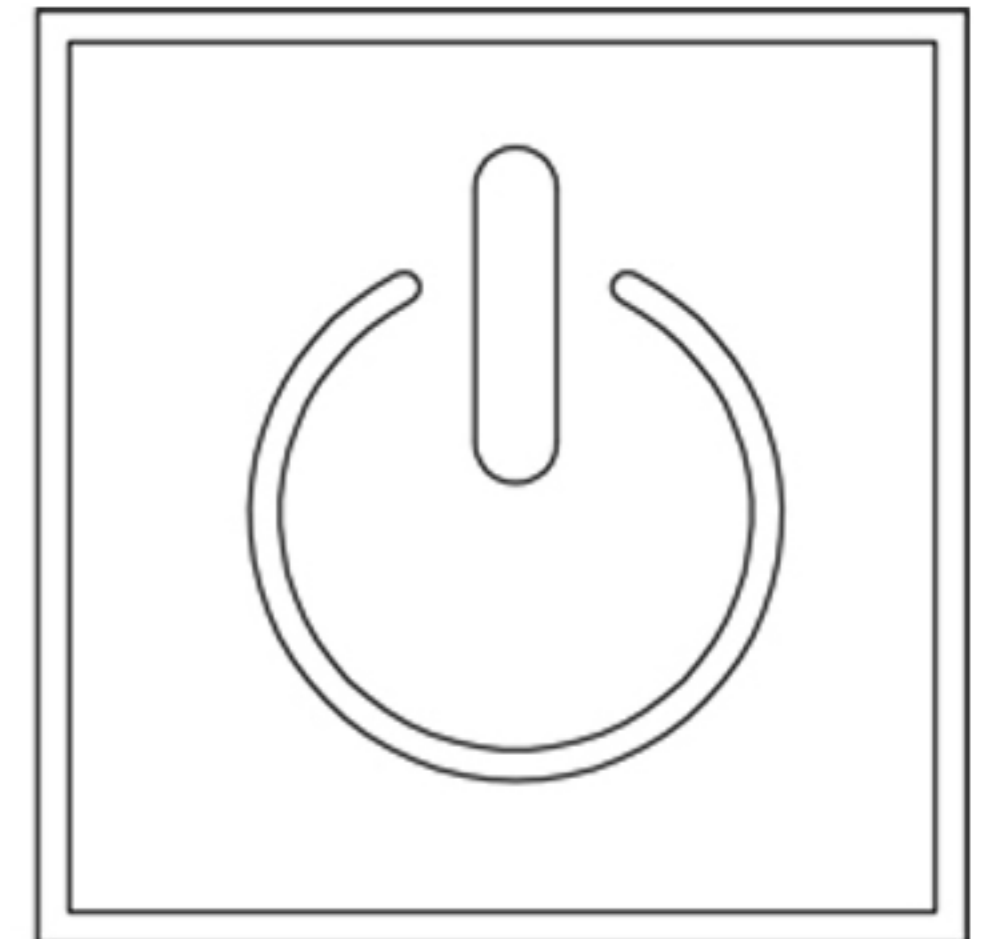

Long press the touch switch, changes to any color temperature you prefer, and can keep this memory for your next time operation.



Touch once, it will be on.

If you use this function for long time, pls do not touch it with your hands.

# SCHEMA ON THE BACK

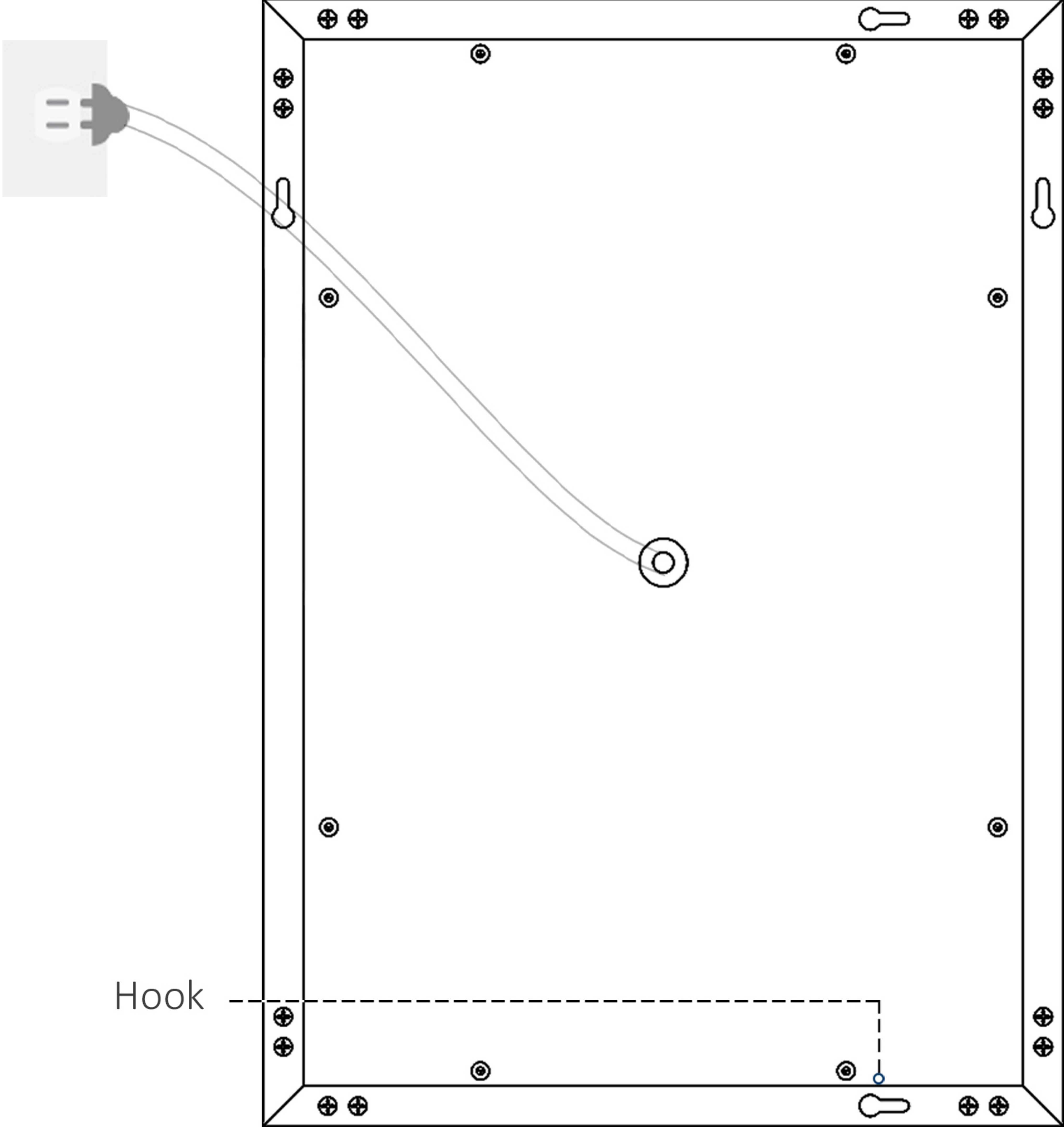

# SPECIFICATIONS

---

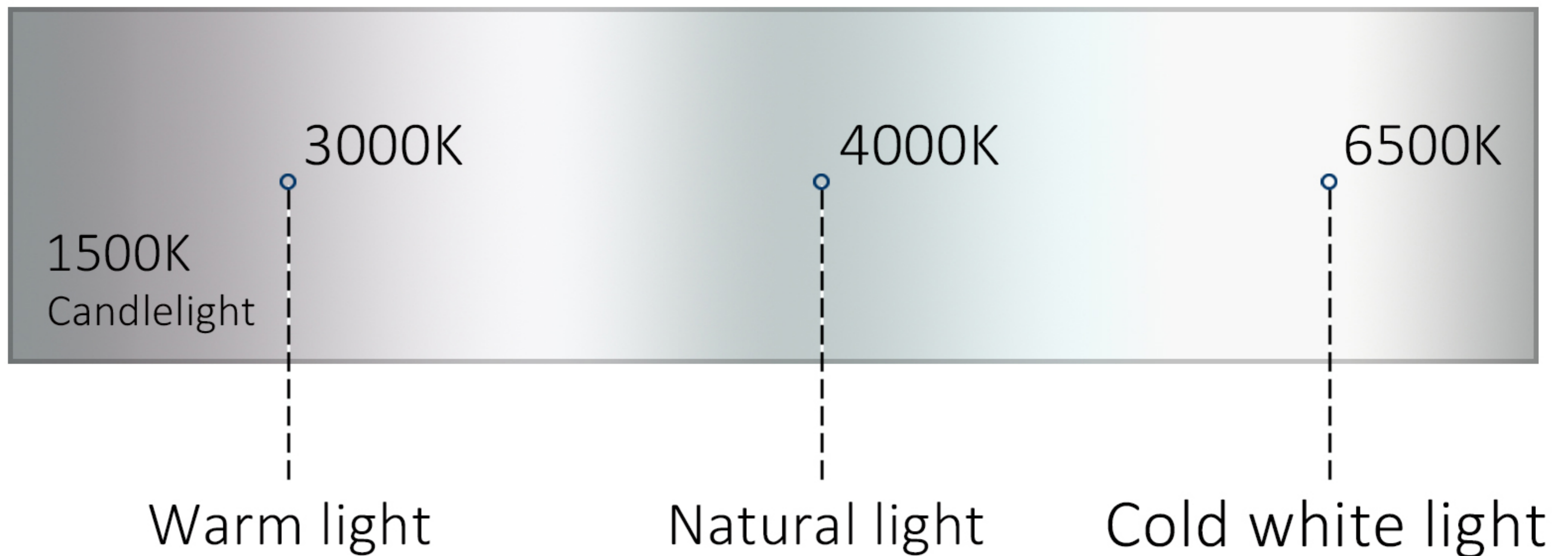

1. Material: Glass+aluminum
2. LED color temperature: 6500K/4000K/3000K
3. Power Supply: Power driver, AC100V
4. Certification: CE/UL/IP44
5. Function: Intelligent dimming, electronic anti-fog

# INSTALLATION METHODS

---

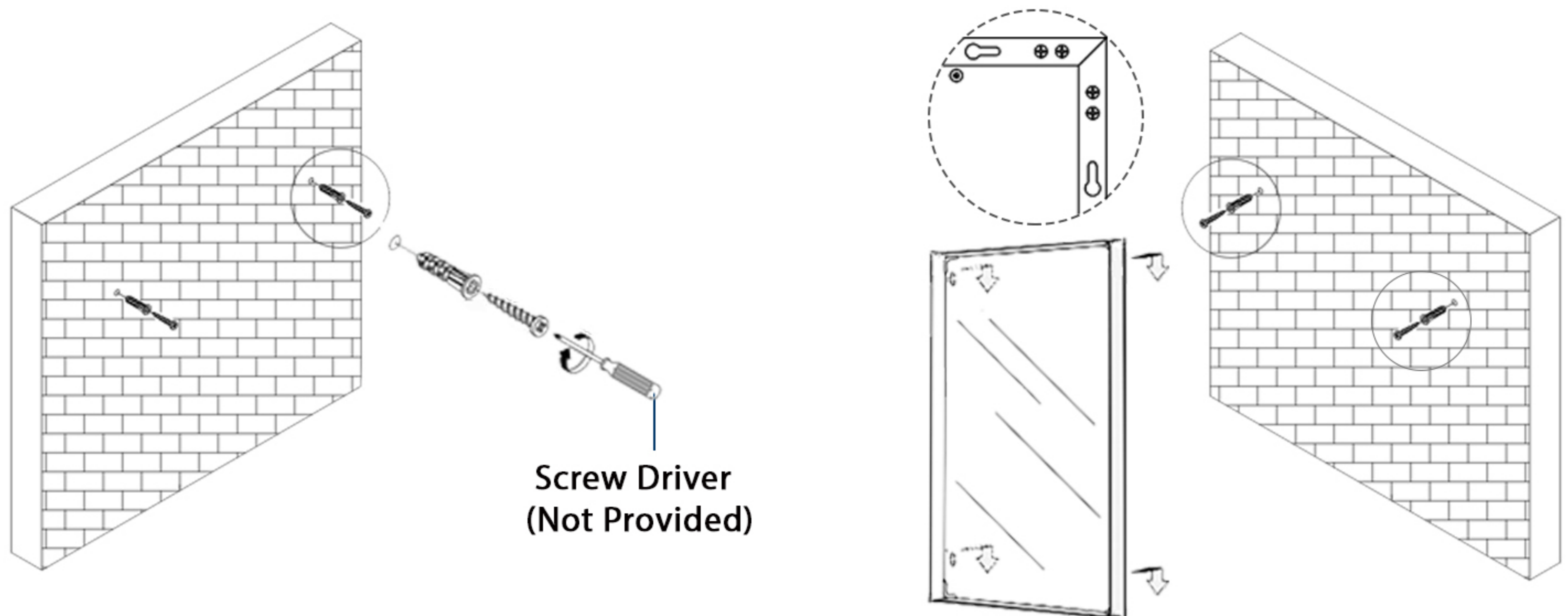

1. Measure the hole distance between two hanging clamps on the wall.
2. Mark the distance on the wall at a required height.
3. Drill holes on the wall as arranged position.
4. Put the plastic expansion screw into the holes.
5. Put the metal screws into the plastic expansion screws.
6. Hang the mirror onto the wall.