



# Swan *Retro*

designed for life



## Oil Filled Radiator

Model: SH60010 (all colours)

Help line: **0333 220 6050**

**This product is only suitable for well insulated spaces or  
occasional use**

v1.1





## IMPORTANT INFORMATION - RETAIN FOR FUTURE USE

- **Warning! The heater must not be switched on, only when the wheels are fully mounted.**
- Read the instructions before using the appliance for the first time.
- The appliance must be installed following national regulations for use.
- It is necessary to be vigilant and supervise the appliance while children are close by.
- This appliance is only designed for domestic and indoor use. Do not use outdoors. Use the heater only as indicated in the instructions. Any other use that does not conform to the supplier's instructions may cause material damage or personal injury
- Any other use not in accordance with manufacturer's instructions may result in property damage or personal injury. Do not use this appliance for other purposes than intended by the manufacturer.
- Use this appliance in a well aerated and ventilated room. Do not cover the appliance or air flow.
- Never try to open the fins filled with oil, or remove the control knobs
- Do not leave this appliance unsupervised while it is on. When not being used, always ensure that the product is securely in the 'Off' position (O) and unplugged from the socket.
- If the power cable is damaged, it must be replaced by the manufacturer, their after-sales service or a similarly qualified person to avoid any hazards.
- Do not place the cable under a carpet or any heavy object, and do not cover.
- To avoid accidents, keep away from areas where people may trip. Do not place on unstable surfaces
- To avoid any risk of fire or electric shock, it is essential that the appliance not be exposed to rain or moisture, and not be opened. The appliance contains electric parts that may electrocute or burn you.





## IMPORTANT INFORMATION - RETAIN FOR FUTURE USE

- Do not place this appliance close to flammable fabrics, surfaces or liquids in order to avoid any risk of fire. Keep it well away from any source at risk of causing hazards and maintain it at a safe distance (whether this is the front, rear or sides). Do not use this appliance in locations such as garages, warehouses etc. where dangerous or flammable products are stored (paint, fuel, alcohol etc.).
- The appliance must not be placed just underneath an electric socket.
- This product is hot when it is on. To avoid any injuries or burns, do not touch it directly and use gloves or other means.
- Do not use this heating appliance close to a bath, shower or swimming pool
- Check that the voltage corresponds to that of the power supply (230v mains socket) To avoid any risk of electric shock, plug the appliance in with the pins fitted correctly into the socket.
- In the event that you need an extension cable, ensure that it is suitable for the appliance's power level.
- While the appliance remains plugged into the socket (wall socket) it is not disconnected from the power supply, even if it is switched off. The appliance must be completely unplugged before cleaning, services, maintenance or even moving from one place to another.
- The power socket must always be equipped with an earth connection. If your domestic electrical installation is not earthed, you should not connect the appliance.
- **WARNING:** To avoid overheating, do not cover the heater.
- This heater is filled with a precise quantity of special oil. Repairs requiring opening of the oil tank should be done only by the manufacturer or its service who should be contacted in case of oil leakage. Regulations regarding the disposal of oil when the heater is discarded must be respected.





## IMPORTANT INFORMATION - RETAIN FOR FUTURE USE

- This appliance can be used by children aged from 8 years and above and persons with reduced physical, sensory or mental capabilities or lack of experience and knowledge if they have been given supervision or instruction concerning use of the appliance in a safe way and understand the hazards involved. Children shall not play with the appliance. Cleaning and user maintenance shall not be made by children without supervision.
- Appliances are not designed to be used in conjunction with a separate timer or with a control system used at a distance.
- This appliance is designed to be used for domestic and similar purposes such as: kitchens used by employees in shops, offices and other professionals; farms; use by guests in hotels, motels and other residential environments; other bed and breakfast type accommodation;
- Children under 3 years must be kept away unless constantly monitored.



**DO NOT COVER**



## TECHNICAL DATA

Description: Oil Filled Radiator

Model: SH60010 (all colours)

Input Voltage: 220-240V

Frequency: 50/60Hz

Power consumption: 2000 Watts





## HOW TO USE

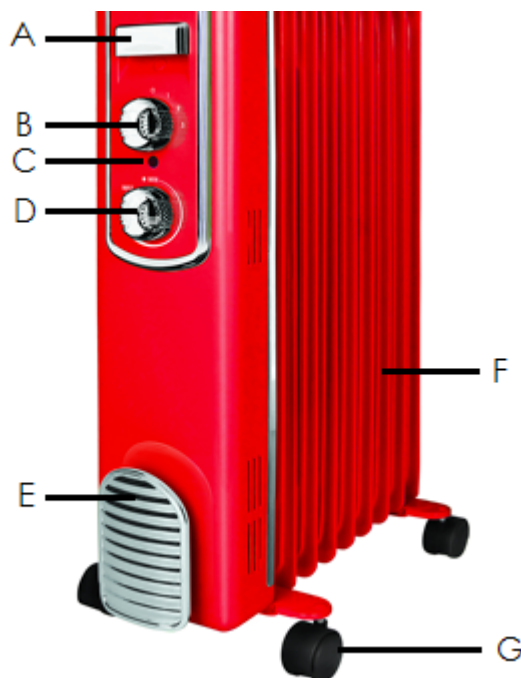

### PARTS DESCRIPTION

- A- Handle
- B- Off and power setting
- C- Indicator light
- D- Thermostat
- E- Cable storage
- F- Heating fins
- G- Wheels

### ASSEMBLY

Unpack the heater and the accessories.

- Turn the radiator upside-down.
- Fit the wheel assemblies onto the radiator by placing the U-shaped bolts between the outermost fins on each side of the radiator.
- Please fit the wheel bases as the picture. Other positions may affect the stability of the radiator.
- Securely fasten the wheels assemblies onto the radiator by screwing the wing nuts onto the bolts.
- Turn the radiator up right.
- Only operate the radiator in normal upright position with wheels assemblies attached to the bottom.
- Cable storage (refer to photo point E) must be at the lower part of the product





## HOW TO USE

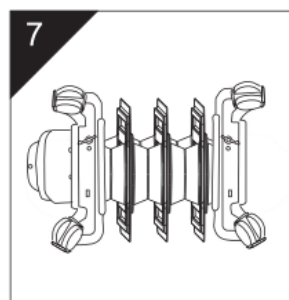
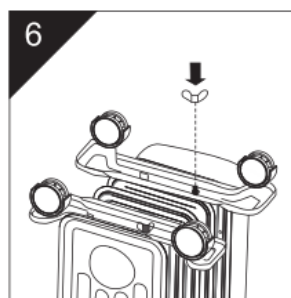
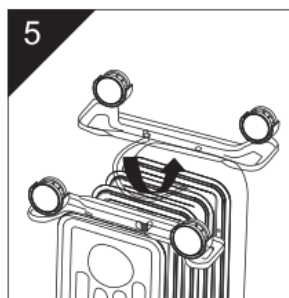
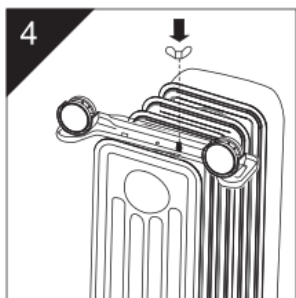
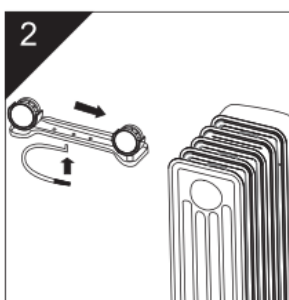
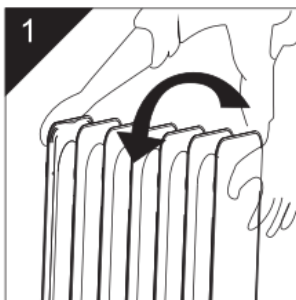

### OPERATING:

#### Precautions for use

1. Before using this appliance, ensure that it is placed on a flat, stable surface. This device is equipped with tip over switch that stops the heater if rolled over and if it is not placed on a stable surface
2. Place the heater at least 100cm from the wall, furniture or curtains.
3. Check that the voltage corresponds to that of the power supply (230v mains socket)
4. This heater contains oil, cools down slowly after being turned off.





## HOW TO USE

5. Leave the heater to cool and unplug it before moving it, and use the handle to move it.

### USING THE HEATER

1. The switches of thermostat control and selection of the power must be on the MIN and "O" position before plugging in the heater.
2. Switch on the heater to one of the following positions three positions: **1: 800W, 2: 1200W. 3: 2000W**
3. Turn the thermostat switch to MAX.
4. The operation indicator light illuminates when the heater is operating.
5. The ambient temperature can be controlled by the thermostat. Turn the thermostat knob clockwise to increase the temperature, or counterclockwise to decrease, until the desired temperature is achieved.
6. After reaching the desired temperature, to maintain the temperature: turn the thermostat knob counterclockwise until the indicator light turns off. The desired temperature will be kept constant by the thermostat function.
7. When not using this heater, switch the 2 buttons to their original position . "O " and " MIN . "And then unplug it.
8. The radiator has a protection system against overheating.
9. Never cover or place any object on the radiator during operation.



### FROST PROTECTION FEATURE

With the thermostat switch set to this position and one of the power levels selected, the appliance maintains room temperature at about 5°C preventing freezing.





## CLEANING & MAINTENANCE

- Always unplug the appliance and keep it away from any socket before cleaning.
- To clean the outer surface of the appliance, use a lightly damp cloth. Then, dry it thoroughly with a soft, dry cloth before using again.
- Do not use any cleaning or chemical products of any kind. Do not let water enter the openings on the heater.
- Do not use wax or products that create a shine as they can react to heat and cause discolouration.
- When the appliance is not being used for prolonged periods, ensure that it is fully unplugged from the socket and stored in its packaging
- For extended storage, clean your radiator as mentioned above and remove the wheels



## PARTS ORDERING

When ordering spare parts please use the following reference:

SH60010-01: Set of 2 castors with bracket



## ENERGY INFORMATION

Model Identifier[s]			SH60010BN / SH60010CN / SH60010GRN / SH60010RN	
<b>Heat Output</b>				
Nominal heat output	P <sub>nom</sub>	2.0	kW	
Minimum heat output (indicative)	P <sub>min</sub>	0.8	kW	
Maximum Continuous heat output	P <sub>max</sub> , C	2.0	kW	
<b>Auxiliary electricity consumption</b>				
At normal heat output	e <sub>lmax</sub>	0.0	kW	
At minimum heat output	e <sub>lmin</sub>	0.0	kW	
In Standby mode	e <sub>lSB</sub>	0.0	kW	
<b>Type of heat output/room temperature control</b>				
With mechanical thermostat room temperature control			Yes	
Contact Detail	Swan Products Ltd. PO Box 3117, Stoke on Trent, Staffordshire. ST4 9GD. UK			







## WARRANTY

This product is guaranteed for 2 years from the date of original purchase. If any defect arises due to faulty materials or workmanship the faulty products must be returned to the place of purchase. Refunds or replacement is at the discretion of the store.

### The following conditions apply:

- The product must be returned to the retailer with proof of purchase.
- The product must be installed and used in accordance with the instructions contained in this instruction guide.
- It must be used only for domestic purposes.
- It does not cover wear and tear, damage, misuse or consumable parts.
- Swan Products Ltd has limited liability for incidental or consequential loss or damage.
- This guarantee is valid in the UK and Eire Only.



## BS PLUG

The wires in the mains lead are coloured in accordance with the following code:

BLUE	NEUTRAL
BROWN	LIVE
GREEN/YELLOW	EARTH

As the colours of the wire in the mains lead of this appliance may not correspond with the colour markings identifying the terminals on your plug, proceed as follows:

The wire which is coloured BLUE must be connected to the terminal which is marked with the letter N or coloured black. The wire which is coloured BROWN must be connected to the terminal which is marked with the letter L or coloured red. The wire which is coloured GREEN/YELLOW must be connected to the terminal which is marked with the letter E or (earth symbol) and is coloured GREEN or GREEN/YELLOW.

WARNING: THIS APPLIANCE MUST BE EARTHED



## DISPOSAL OF UNIT



Appliances bearing the symbol shown here may not be disposed of in domestic rubbish. You are required to dispose of old electrical and electronic appliances like this separately. Please visit [www.recycle-more.co.uk](http://www.recycle-more.co.uk) or [www.recyclenow.co.uk](http://www.recyclenow.co.uk) for access to information about the recycling of electrical items. Please visit [www.weeeireland.ie](http://www.weeeireland.ie) for access to information about the recycling of electrical items purchased in Ireland. The WEEE directive, introduced in August 2006, states that all electrical items must be recycled, rather than taken to landfill. Please arrange to take this appliance to your local Civic Amenity site for recycling, once it has reached the end of its life.





## SWAN BRAND HERITAGE



In 1933 Swan were the first to develop an electric heating element that could be immersed in water. This led to the Swan kettle range that could boil up to six pints of water in just over nine minutes - pretty hot for the time! These days it takes about two minutes for a Swan kettle to boil.





[www.swan-brand.co.uk](http://www.swan-brand.co.uk)



Scan this QR code  
to hear about  
our story



We love  
what we do



we're proud  
of our quality



Find us on Facebook

\* on selected products

Copyright © Swan Products Ltd.  
PO Box 3117, Stoke-on-Trent ST4 9GD

