



Dr. Infrared Heater Elite Series

- 1500 Watts with Two Heat Settings
- Built-In Humidifier
- Rotatable Air Outlet
- Automatic Thermostat
- Tip-Over Switch
- Overheat Thermal Cut-Off Protection
- Room Temperature LED Display
- Precision Temperature Control
- Easy Push-Button Controls
- Remote Control



Model No.: DR-998

Owner's Manual
PLEASE READ AND
SAVE THESE INSTRUCTIONS

CONGRATULATIONS!

The Dr. Infrared Heater Elite Series you have just purchased is a safe and powerful heater, designed to heat a room after a few minutes of operation. The far-infrared Quartz-PTC heating system is an excellent system for safely heating whole rooms, while saving on heating costs.

Additionally, this heater includes an overheat protection system, and an inlet air overheat protection system designed to ensure your safety.

This heater does not reduce humidity or oxygen in your home or office, *promoting a healthier environment!*

Before using your heater, please take a few minutes to read these instructions, and review the product's limited warranty.

Thank you!

WARNING! To reduce the risk of fire, electric shock, or personal injury, read all the instructions before using this heater. This appliance is intended for household or personal use only as described in this manual. Any other use including but not limited to commercial, agricultural, or outdoor use, is not recommended by the manufacturer and may cause fire, electric shock, injury and/or damages. The use of any attachments and accessories or extension cords not recommended or sold by Dr. Infrared Heater Products may cause hazards and void the warranty.

WARNING: Risk of Fire – Keep combustible material such as furniture, papers, clothes, and curtains at least 3 feet (0.9 m) from the front of the heater and away from the sides and rear.

IMPORTANT INSTRUCTIONS

When using this appliance, basic precautions should always be followed to reduce the risk of fire, electric shock, injury to persons and hyperthermia, including the following.

1. Read all the instructions before using this heater.
2. This heater is hot when in use. To avoid burns, do not let bare skin touch hot surfaces. Keep combustible materials, such as furniture, pillows, bedding, papers, clothes and curtains at least 3 feet (0.9 m) from the front of the heater and away from the sides and rear. To Reduce the Risk of Hyperthermia – Use caution when operating the heater to avoid overheating that can occur in infants or individuals with reduced physical, sensory, or

mental capabilities.

3. Extreme caution is necessary when any heater is used by or near children or invalids and whenever the heater is left operating and unattended.
4. Do not operate the heater with a damaged cord or plug, or after the heater malfunctions, has been dropped, or damaged in any manner. Return the heater to an authorized service facility for examination, electrical or mechanical adjustment, or repair.
5. Do not use outdoors.
6. This heater is not intended for use in bathrooms, laundry areas, or similar locations. Never locate the heater where it may fall into a bathtub or other water container.
7. Do not run the cord under carpeting and do not cover the cord with throw rugs, runners or the like. Do not route cord under furniture or appliances. Arrange the cord away from traffic areas to avoid a tripping hazard.
8. To disconnect the heater, turn controls to OFF, then remove plug from outlet.
9. Do not insert or allow foreign objects to enter any ventilation or exhaust opening as this may cause an electric shock, fire, or damage to the heater.
10. Connect to properly grounded outlets only.
11. To prevent a possible fire, do not block air intakes or exhaust openings in any manner. Do not use on soft surfaces, like a bed, where openings may become blocked. Use the heater on flat, dry surfaces only.
12. A heater has hot and arcing or sparking parts inside. Do not use heater in areas where gasoline, paint or flammable liquids are used or stored.
13. Use this heater only as described in this manual. Any other use not recommended by the manufacturer may cause fire, electric shock, or injury to persons.
14. **Never** clean this heater while it is plugged in. Do not immerse in water. To disconnect, turn the control to OFF, then remove the plug from the outlet by grasping it and pulling it from the outlet. **Never yank on the cord.**
15. This heater includes an overheat protection system that shuts off the unit when parts are becoming excessively hot. If the heater shuts off, immediately turn it OFF and inspect for any objects on or adjacent to the heater which may cause high temperatures. **DO NOT OPERATE THE HEATER UNTIL IT IS RESET.** To reset the heater, turn it OFF, unplug it from the electrical outlet, and wait five to ten minutes for the unit to cool down before plugging it back in and turning the heater on.

16. Always unplug heater when not in use.
17. Always plug heater directly into a wall outlet/receptacle. Never use with an extension cord or relocatable power tap (outlet/power strip).
18. It is normal for the heater's plug and cord to feel warm to the touch. A plug or cord which becomes hot to the touch or becomes distorted in shape may be a result of a worn electrical outlet. Worn outlets or receptacles should be replaced prior to further use of the heater. Plugging this heater into a worn outlet may result in overheating of the power cord or fire.
19. Make sure the plug is fully inserted into an appropriate receptacle. Be mindful that receptacles also deteriorate due to aging and continuous use. Check periodically for signs of overheating or deformations of the plug. If any overheating or deformation occurs, immediately discontinue using the heater and contact Dr. Infrared Heater Authorized Service Center.
20. **CHECK YOUR HEATER CORD AND PLUG CONNECTIONS.** Faulty wall outlet connections or loose plugs can cause the outlets or plug to overheat. During use, please check frequently to determine if your plug outlet or faceplate is HOT! If it is hot, discontinue using the heater and/or make certain a qualified electrician checks and replaces the faulty outlet(s).
21. Hyperthermia can result in death. Symptoms of hyperthermia include high body temperature, headache, nausea, vomiting, tiredness, dizziness, fainting, and rapid pulse. If you begin to experience symptoms related to hyperthermia, turn off the heater and seek medical attention.
22. To avoid excessive room temperatures which can cause hyperthermia: DO NOT leave product running unattended in a confined space around infants, or individuals with reduced physical, sensory, or mental capabilities.

CAUTION: This appliance is not intended for use by persons (including children) with reduced physical, sensory or mental capabilities, or lack of experience and knowledge, unless they have been given supervision or instruction concerning use of the appliance by a person responsible for their safety.

SAVE THESE INSTRUCTIONS

Humidifier Installation:

1. Open the humidifier packing and remove the humidifier, as shown in Figure 1.



FIG 1

Water Tank Seal Installation Guide

- A. Install the rubber seal ring before use.



- B. Wrap the ring around the tube.



C. Make sure the rubber ring is in the concave area.



Water Bottle Adapter Seal Installation Guide

(Seal may come in black or white)

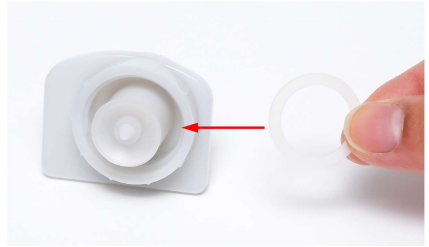
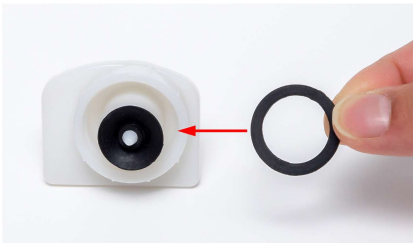

A. Install the rubber seal ring on the water bottle adapter before use.



B. Wrap the ring around the tube.

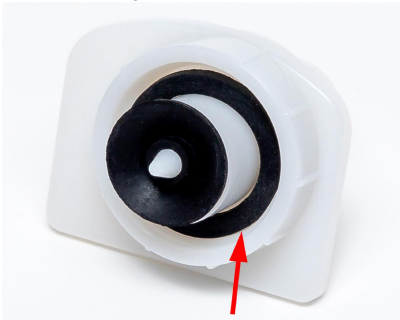

- C. Make sure the rubber ring is all the way inside.
2. Take out the water bottle (Max. 500 ml.) from the package and fill the water bottle with distilled water. Then tighten the connector on the water bottle as shown in Figure 2.



FIG 2

CAUTION: You must use distilled water to keep the humidifier working properly. Also, make sure the connector is tightened to the bottle to prevent water leakage.

3. Fully insert the humidifier into the two hooks located in the rear side of the wooden box as shown in Figure 3.

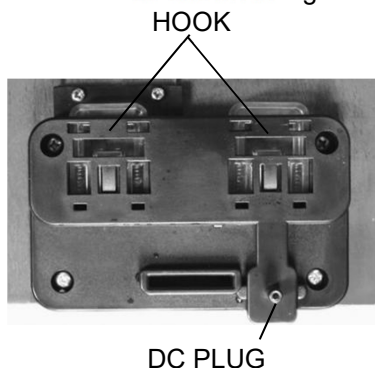

FIG 3

CAUTION: Make sure the two hooks are fully inserted and the DC PLUG is connected to the DC JACK.

4. Push down the moisture outlet cover in the top of the wooden box as shown in Figure 4.



CAUTION: Make sure the moisture outlet cover is slide open before using the humidifier.

FIG 4

5. Insert bottle, attached to connector, into the humidifier, as shown in Figure 5.



FIG 5

Special Features

LED Display – When the unit is plugged in, press the POWER button and then the MODE button, the heater will start in ECO mode, showing a default temperature of 68°F. You can set your desired temperature between 50°F and 85°F.

Overheat Cut-Off Protection System – This heater includes a protection system that cuts off the unit if it overheats for any reason.

Inlet Air Overheat Protection System – This heater will automatically cut off if the inlet air duct becomes obstructed and causes the unit to overheat.

Safety Tip-Over Switch – The Dr. Infrared Heater is designed to cut off automatically when tipped in any direction. Place the heater on a flat, smooth, stable surface to prevent the heater from tipping over again. When returned to a normal upright position, the heater is ready for use again. This is a safety feature to avoid the possibility of fire should the unit be tipped accidentally.

Advanced Dual Heating System (ADHS) - Dr. Heater is the first to feature a dual heating system for maximum heat transfer rate. It combines the energy efficiency of infrared heat with the comfort of convection heat to heat your room fast and comfortably—without hot spots and cold spots.

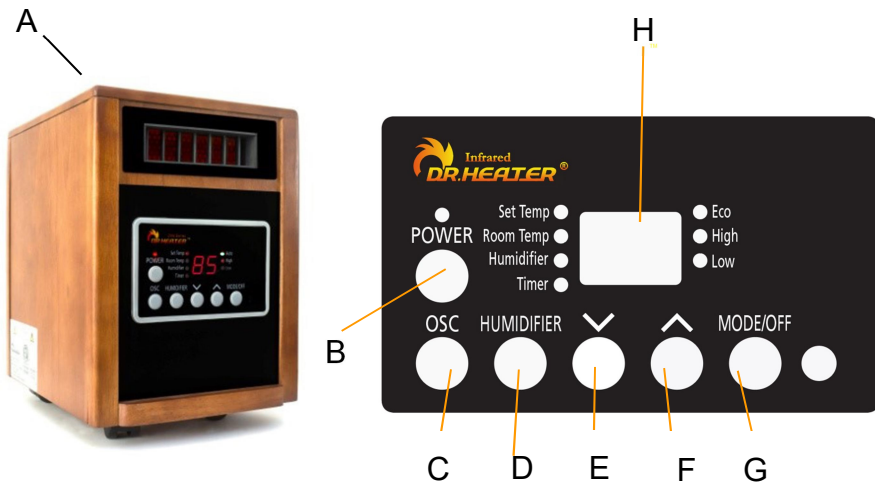

Features

- A.** “Cool-Touch” cabinet
- B.** POWER button
- C.** Rotatable air outlet button
- D.** Humidifier button
- E.** Decrease temperature button
- F.** Increase temperature button
- G.** MODE/OFF button
- H.** LED display

Steps 1, 2, 3 to turn on the heater

Step 1 – Plug in power cord to outlet.



Step 2 – Press power button on the unit.



Step 3 – Press Mode button on the unit.



The heater default setting is 68°F, if room temperature is above 68°F, the heater won't start if the room temperature is higher than the set temperature. Please check Room Temp, and increase Set Temp to start heater.

Note: Heater will not turn on if the room temperature is higher than 85°F.

Show Room Temp - Press Mode + V keys then let go



Increase Set Temp – Press up button "▲" until Set Temp is above Room Temp.



Operating Instructions

1. Plug the power supply cord into a grounded wall outlet (120VAC, 60Hz).

Important: This heater comes with a grounded (three-prong) plug. The grounded plug must be used with a grounded outlet. Do not use an adapter in a two-slot wall outlet unless the ground plug of the adapter properly connects to a building ground. Using the heater without a properly grounded outlet or adapter could result in an electric shock hazard.

The cord has a plug as shown at A in the figure that follows. An adapter, as shown at C, is available for connecting three-blade grounding-type plugs to two-slot receptacles. The green grounding lug extending from the adapter must be connected to a permanent ground such as a properly grounded outlet box. The adapter should not be used if a three-slot grounded receptacle is available.

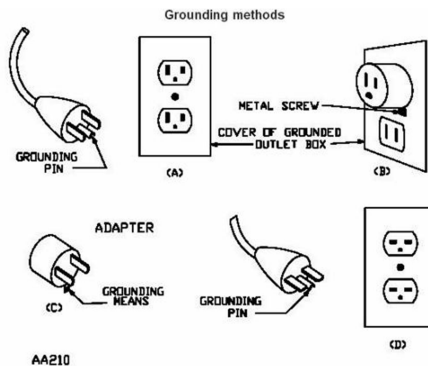

2. TURNING THE HEATER ON

To turn the heater ON, press the POWER button. The power LED will light up and display the default temperature of 68°F.

3. HEATING MODES

Press the MODE button to toggle between the different modes: ECO, HIGH, LOW.

4. ECO MODE – 1500W/1000W

ECO mode is a computerized mode to optimize energy efficiency. It will programmatically select between HIGH and LOW power mode to heat up the room to the desired temperature in the most effective way. Once the desired temperature is achieved, the heater will maintain the room to the set temperature. ECO mode is the environmentally friendly operating mode.

5. HIGH POWER MODE – 1500W

HIGH mode will control the heater to operate at high power until the room reached the set temperature. The heater will stop heating and initiate

component cooling process before turning off the fan. Once the desired temperature is achieved, the heater will maintain the room to the set temperature.

6. LOW POWER MODE – 1000W

LOW mode will control the heater to operate at low power until the room reached the set temperature. The heater will stop heating and initiate component cooling process before turning off the fan. Once the desired temperature is achieved, the heater will maintain the room to the set temperature.

7. SETTING THE TEMPERATURE

Choose the desire Mode: ECO, HIGH, or LOW. To set the desired temperature:

Press the ▲ button once until the numeric temperature starts flashing.

Press the ▲ button again to increase the temperature or the ▼ button to decrease the temperature.

Once the temperature is set, the heater will warm up the room using the selected Mode. Heater will sample the room temperature every 4 minutes after the desired temperature is reached.

8. Night Mode

Night mode is design for quiet operation in the night. You can press and hold MODE button and then press ▲ button to set the night mode. The display will show "ni". In this mode, when the heater reached the set temperature, it will sample the room temperature less frequently, 30 minutes per sample. Press and hold the Mode and then press ▲ button to cancel the night mode. Display will show set temperature again

9. Display the room temperature

The display shows the set temperature all the time, press and hold the MODE button and then press the ▼ button. The room temperature will display for 30 seconds. It will return to set temperature after 30 seconds.

10. SETTING THE HUMIDIFIER

Make sure the humidifier has been fully inserted into the two hooks in the rear side of the wooden box. Then press the Humidifier button to set to the Humidifier mode. The humidifier will shut off automatically when the water level is low. Refill the humidifier with distilled water, the humidifier will turn on again.

CAUTION: To prevent leakage, do not move the heater quickly when the humidifier is filled with water.

11. SETTING THE AIR OUTLET

Press the OSC button. The air outlet can be rotatable left and right.

For more efficient heating, try placing the heater a few feet above the floor in rooms with a large area. Ensure the heater is secure and won't fall.

Remote Controller

HOW TO INSERT BATTERIES

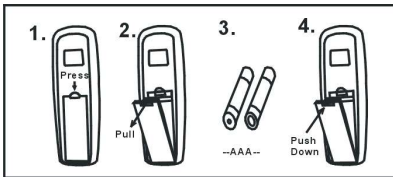

NOTE: Remove the batteries if the remote control is not to be used for a month or more. Batteries left in the unit may leak and cause damage.

DO NOT MIX OLD AND NEW BATTERIES!

DO NOT MIX ALKALINE, STANDARD (CARBON-ZINC) OR RECHARGEABLE (NICKEL-CADMIUM) BATTERIES!

Instructions for Use of IR Remote Control:

The buttons of the remote control will function in the same manner as those on the control panel on the front of the heater. Set the timer by using the remote control.

Setting the Timer

1. Press the TIMER button until the Set Time starts flashing. The default value is 3 hours.
2. Press the “+” button to increase the set time or the “-” button to decrease the set time.

The timer can be set from

1 to 12 hours. The timer will set and execute after the LED display stops flashing. The heater will shut OFF automatically when the set time is reached.

3. To turn the timer OFF, follow step 1, pressing the “-” button to set the time to 0. The timer feature will turn OFF when the LED stops flashing.

Maintenance

1. Always turn OFF the heater and disconnect the cord from the electrical outlet before cleaning the unit.
2. Light accumulation of dust may be removed from the heater with a soft cloth or vacuum cleaner.
3. Wipe the exterior surfaces of the heater occasionally with a damp cloth (not dripping wet), using a solution of mild detergent and water. Dry the case thoroughly before operating the heater.

Caution: Do not allow water to run into the interior of the heater as this could create a fire or electric shock hazard.

4. The fan motor is factory-lubricated for life and will require no further lubrication.
5. Store heater in a clean, dry place when not in use.

Cleaning the electrostatic filter

The heater has an electrostatic filter located at the rear. The filter should be cleaned once per month or as needed (when dust is visible on the filter) to ensure efficient operation of the heater.

1. Power the heater OFF by pressing the POWER button located on the left side of the Control Panel.
2. Unplug the heater's power cord.
- 3 Remove the screws from the filter bracket (Figure 7).
4. Remove the filter bracket by pulling down and out (Figure 8).
- 5 Clean the filter by vacuuming.

6. Replace the filter bracket by sliding the bottom down into the slot on the back of the heater (Figure 8). Then gently push the bottom of the filter into place (Figure 7).

Remove these screws.

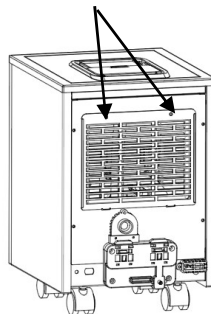

FIG 7

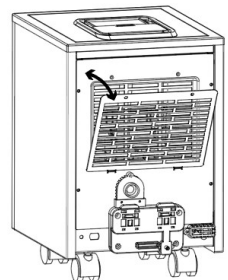

FIG 8

Cleaning the humidifier

The humidifier should be cleaned once per month or as needed to ensure efficient operation.

1. Power the heater OFF by pressing the POWER button located on the left side of the Control Panel.
2. Unplug the heater's power cord.
3. Press the two hooks in the rear of the wooden box and push out the humidifier.
4. Open the cover of the humidifier.
5. Clean the humidifier with water.

Warning! Any other servicing needed must be performed by an authorized service representative. Do not attempt to service the unit yourself.

Model No.: DR-998

Voltage: 120V, 60Hz

Current: Maximum continuous draw: 12.5 amps

Output: 5200 BTUs

Power: 1500 Watts

Blower: Multi-blade; Low Noise, High Pressure

In The Box

- DR Infrared Portable Space Heater with Humidifier
- Remote control (2 AAA batteries)
- User's Manual

Warranty Information

Register your product at our website:



Or visit [DrHeaterUSA.com/register-your-heater](https://www.drheaterusa.com/register-your-heater)

Feedback

Love it? Help us make the product more for you.



Let us know with a customer review.

Please visit: <https://www.amazon.com/review/review-your-purchases#>

At Dr. Heater USA, we are committed to bringing top quality alternative & supplemental heating products to our customers.

Note: There may be a trace of smoke or odor when the unit is first operated. Do not be alarmed. This indicates a drop of oil fell on the interior coils during the manufacturing process. It will quickly evaporate and should not recur.

How long is the warranty?

This heater comes with a THREE-YEAR LIMITED WARRANTY. If your unit does not appear to be working properly, please contact our service center by calling 1-800-317-1688. Prior to your call, we encourage you to visit our service related website www.DrHeaterUSA.com for troubleshooting tips and service instructions if needed.

Dr. Heater USA
860 Mahler Road
Burlingame, CA 94010
Tel: 1-800-317-1688

EMAIL: SERVICE@DRHEATERUSA.COM



Dr Heater USA



@Dr Heater USA



Dr. Heater USA



Dr. Heater USA

QUESTIONS AND ANSWERS

Why does the blower fan keep running after I have pressed the power off button?

The blower fan will continue to run until the heat chambers cool down. After a few minutes the fan will shut off automatically.

What if the heater's airflow seems to have diminished?

Please ensure the rear intake is not blocked and that the filter is clean. Please follow the filter maintenance procedure to clean the filter.

Once the heater is turned on, how long will it take to heat my room?

This heater can heat up a large room. Remember that with any type of heating process, there are many variables such as the size of the room, how well the room is insulated, how many doors and windows there are, the amount of bare concrete (which acts as a heat sink with any type of heating), the opening and closing of an exterior door, the outside temperature, etc. Please remember that this is a zone heater and is meant to be used as a *supplemental* heating source only.

Can I use the heater to heat multiple rooms at the same time?

Keep in mind that heating will vary based on how open your floor plan is and the size of the rooms involved. We have heard from customers that with the help of ceiling fans, they have been able to heat multiple rooms simultaneously by placing the unit in a central room. We suggest you give it a try and see what works best for you.

My home is not well insulated; will this heater help me?

Yes, but it may take a little longer to heat the room. The outside temperature will also have an impact on heating time. Once the room has reached the

desired temperature, it will cycle on and off accordingly.

Can the heater be used in a bathroom?

It is not recommended due to a bathroom's high level of moisture.

Can the heater be used in a basement or garage?

Yes, but keep in mind that rooms with little insulation will not retain the heat as efficiently. Bare concrete floors act as a heat sink with any type of heating and will absorb some of the heat. However, placing the heater a few feet above the floor will allow for more efficient heating.

Can I use more than one heater at a time?

Yes, but please make sure the heaters are not on the same circuit. Each heater and appliance should be on its own circuit.

Can I use the heater and another appliance at the same time?

Yes, as long as they are not on the same circuit. This heater is considered to be an appliance. You should not run more than one large appliance on a single circuit breaker. Your appliances, such as a freezer, refrigerator, microwave oven, washing machine, dryer and others, should not share a circuit breaker.

Can I use the heater on a job or construction site?

This heater is not designed to be used in a high dust construction environment. Using the heater for this purpose will void your warranty.

Can I move the heater around while it is operating?

It is not recommended to move any portable heater while it is operating. We recommend moving the heater only once the fan has completely turned off.

What is the life expectancy for the heater?

This heater uses one infrared tube (which is rated for 20,000 hours and up),

and one PTC element (which is rated for 80,000 hours and up).

What is zone heating?

Zone heating focuses heat where people spend the most time. After all, there is no point in heating multiple rooms to +68 degrees when not in use.

Can I use an extension cord, surge protector, or power strip with my heater?

No. The DR. INFRARED HEATER is designed to plug directly into a grounded 120V 15 Amp or higher circuit receptacle. Never use with an extension cord or relocatable power tap (outlet/power strip).

How many kilowatts per hour does the heater use?

The DR. INFRARED HEATER MODEL DR-998 uses approximately 1.26 kilowatts per hour.

What is the BTU Rating for the heater?

The DR. INFRARED HEATER MODEL DR-998 is approximately 5200 BTUs.

The power cord feels warm to the touch; should I be concerned?

It is normal for the heater's plug and cord to feel warm to the touch. A plug or cord which becomes hot to the touch or becomes distorted in shape may be a result of a worn electrical outlet. Worn outlets or receptacles should be replaced prior to further use of the heater. Plugging this heater into a worn outlet may result in overheating of the power cord or even a fire.

I don't have a grounded outlet; can I use a cord adapter or remove the grounding plug?

NO. If you don't have a grounded outlet, contact a licensed electrician in your area for advice. Removing or altering any part of the heater is unsafe and will also void your warranty.