

**QUEEN BED (13 PCS LVL SLATS)**

Read these instructions carefully. Refer to hardware and furniture parts list for guidance. Be sure all parts are complete, before assembling.  
Place all wooden furniture parts on a clean and flat soft surface to prevent scratches. Refer to steps provided as assembling guide.

**CAUTION:**

1. Do not FULLY-TIGHTEN the nuts or nut bolts until all are in place.
2. To prevent thread damage, ensure that nuts or nut bolts are not OVER-TIGHTEN.
3. Keep all hardware part out of reach of children.

**PART LIST**

NO	DESCRIPTION	QTY
1	HEADBOARD	1 PC
2	FOOTBOARD	1 PC
3	CENTER RAIL	1 PC
4	SIDE RAIL	2 PCS
5	SUPPORT LEG	3 PCS
6	SLAT	13 PCS
7	BED LEG	4 PCS
8	LEG SUPPORT BAR(PRE-FIXED)	2 PCS

**HARDWARE LIST**

NO	DESCRIPTION	QTY
A	JCBB M8 X 40MM	8PCS
B	JCBB M8 X 50MM	8PCS
C	JCBC M6 X 50MM	6PCS
D	SPRING WASHER 5/16"	22PCS
E	FLAT WASHER 5/16"	16PCS
F	FLAT WASHER 1/4"	6PCS
G	CSK M4 X 30MM	33PCS
H	ALLEN KEY M4	1 PC
I	ALLEN KEY M5	1 PC

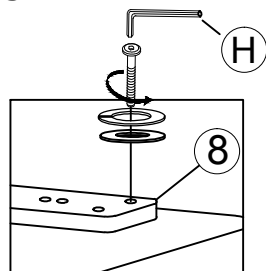
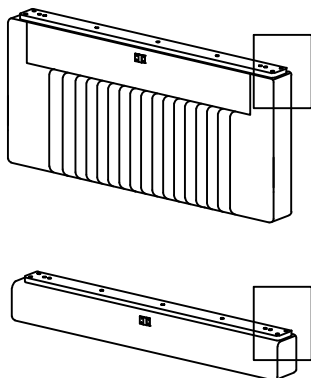
**STEP 1**

Remove Leg Support Bar before assembly Bed Leg by using ALLEN KEY M4(H). Please re-use the hardware at [Step3](#)

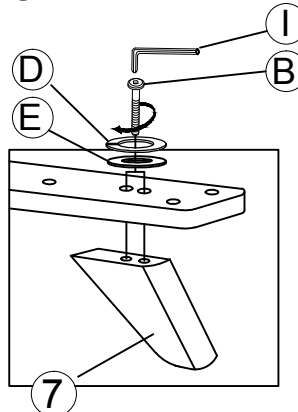
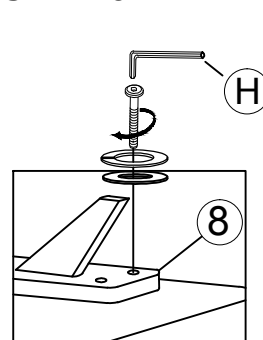
**STEP 2****STEP 3**

Re-use the hardware removed at [Step1](#).

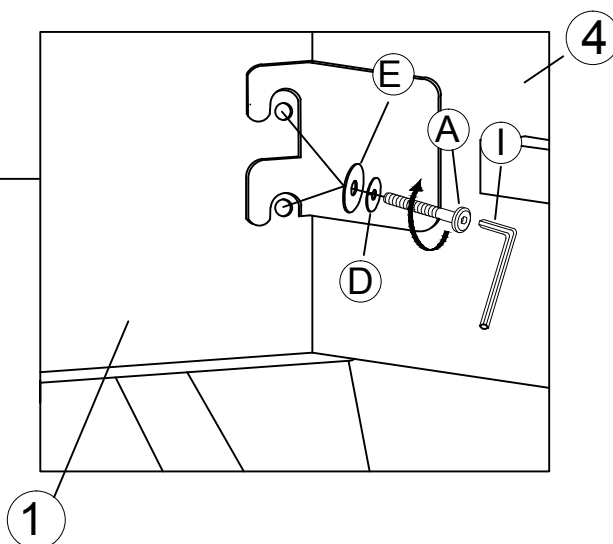
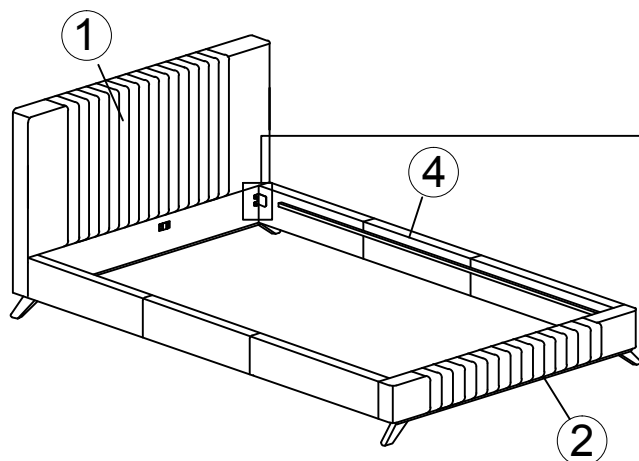
**STEP 4**

STEP 5

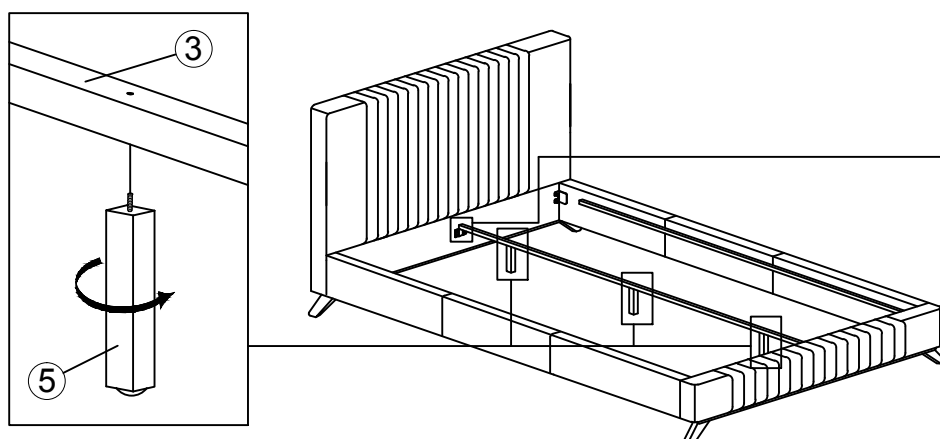

STEP 6

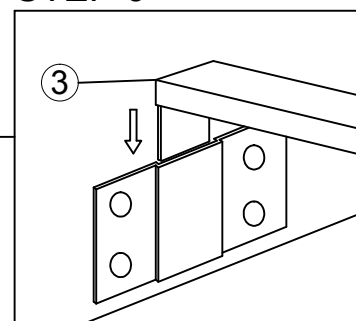

STEP 7

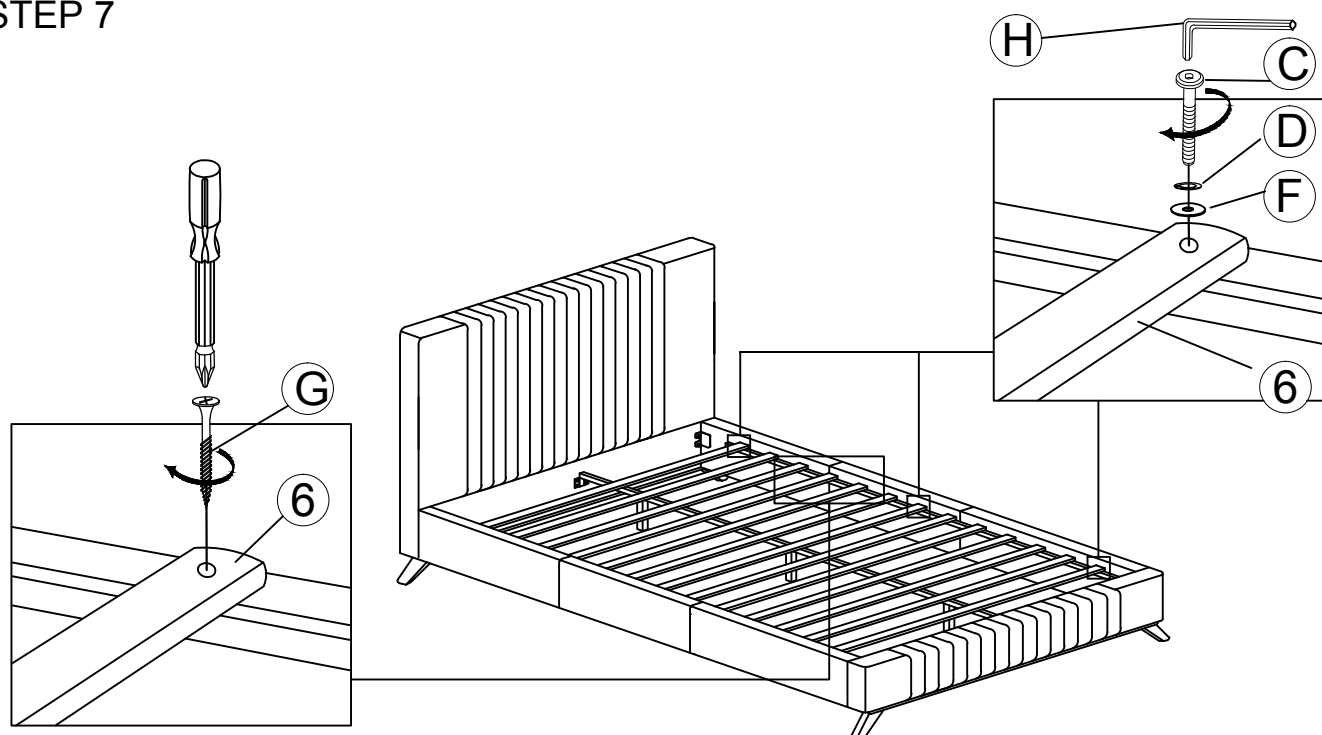

STEP 8

