

Inflatable Bounce House User Guide

Model: Arcade

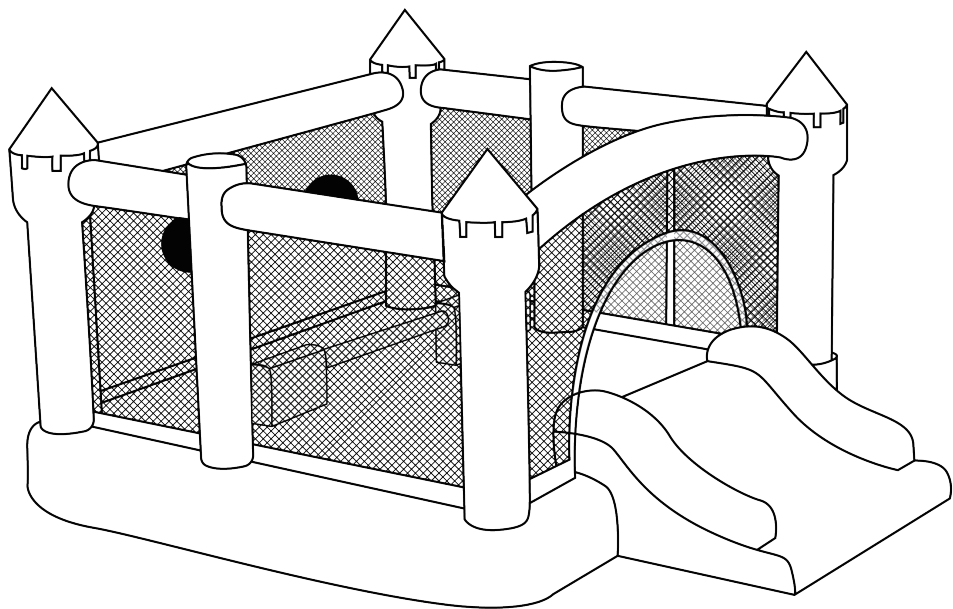

- Keep these instructions for further reference
- Please read all of the safety rules before setting up
- Safety first. Please follow all of the rules for your children's safety

CONTENTS

SAFETY INSTRUCTIONS	01
PACKAGE CONTENT	03
OPERATION INSTRUCTIONS	03
Set Up	03
Take Down	05
Storage	06
MAINTENANCE	07
TROUBLESHOOTING	08
WARRANTY	09

SAFETY INSTRUCTIONS

WARNING! ELECTRICALLY OPERATED PRODUCT

ADULT SUPERVISION REQUIRED. OPERATING BLOWER(AIR PUMP) NOT RECOMMENDED FOR CHILDREN UNDER 18 YEARS OF AGE. AS WITH ALL ELECTRIC PRODUCTS, PRECAUTIONS SHOULD BE OBSERVED DURING HANDLING AND USE TO PREVENT ELECTRIC SHOCK.

CAUTION: NOT SUITABLE FOR ADULT USE. WARNING! MAXIMUM AGE 10 YEARS. MINIMUM AGE 3 YEARS. NOT SUITABLE FOR RENTAL OR COMMERCIAL USE. TO BE USED ON SOFT GROUND ONLY.

WARNING!

Ensure active adult supervision at all times.
Empty and store safely after use.



WARNING!

- Product is heavy. Use with caution when lifting.
- Failure to follow the specified instructions may result in serious injury.
- Instruct children on proper use of this product. Do not use in a manner other than intended.
- Adult set-up and dismantling are required. Adult supervision is required at all times to ensure observation of all parts of the play area, all activity on the bouncer and keeping the entrance free from obstruction at all times. Never leave children unattended during play.
- The bouncer may not be used outside during raining and / or lightning conditions or if winds exceed 25 MPH (40km/h). Sudden gusts of wind may lift the product off the ground.
- The bouncer shall only be inflated with the provided electrical blower or with manufacturer specified replacement blower. GFCI (Ground Fault Circuit Interrupter) device needs to be used. Do not use extension cord and keep the blower and power cord away from water.
- Keep bouncer at a safe distance (at least 2M/6.56ft) from fire, walls and other obstructions.
- Ensure that there is 1.8 m (6 ft.) obstacle free zone around the product, including the slide and overhead. The maximum fall height for the inflatable products will be different from the size of the products, if for small size products, the height ranges from 35cm to 40 cm (13.78" to 15.75"), if for medium size of the products, the height ranges from 40cm to 45 cm (15.75" to 17.72"), if for large size products, the height ranges from 45cm to 55 cm (17.72" to 21.65"). The suitable fall height will be adopted for the products according to the different size of the products.
- Do not set-up, use, or expose the bouncer and Electric Blower to any adverse outdoor weather conditions, such as, but not limited to: rain, thunder, lightning, hail, snow, high winds, and tornadoes.
- Avoid setting up and operating bouncer and Electric Blower anywhere that these products could be potentially exposed to water.
- Do not set up the bouncer on a slope or incline.
- Warning: keep away from fire. Keep fabric clear from all flame and ignition sources.
- The bouncer should not be set up facing the sun as the glare may affect children sliding down.
- The bouncer must be fully inflated before any children are allowed inside. Failure to do so will result in the slide being unstable with the risk of serious injury. The bouncer must stay fully inflated until everyone is out.
- To prevent from overturning or otherwise becoming a hazard, check on the bouncer at regular intervals while in use.

- Check stakes regularly during play to ensure they remain securely in the ground when using outdoors.
- If the bouncer begins to deflate, remove all children and check for disconnection of power cord or for power outage.
- Keep children and pets away from the blower (air pump).
- To avoid injury, please ensure that the maximum occupancy is observed and controlled.
- It is recommended to separate larger children from smaller children when playing with the bouncer.
- Ages and sizes of children playing in the bouncer at the same time should be comparable. Not suitable for children under 3 years. Small parts may be swallowed.
- Individuals with head, neck, back or other muscular-skeletal injuries or disabilities, pregnant women, small infants and others who may be susceptible to injury from falls, bumps or sliding are not permitted in the bouncer.
- To prevent choking, children may not enter the bouncer while eating, drinking, or chewing anything in their mouth loose or baggy.
- Shoes, eyeglasses, jewelry and any hard or sharp objects that may cause injury must be removed before entering the bouncer. Clothing, or clothing containing long cords not be worn while playing on this product.
- Inappropriate activity is not permitted -No flipping, wrestling, running, or pushing allowed inside the bouncer.
- Do not bounce on the edges, steps or on the slide. Do not jump off the side. Climbing or hanging on the walls, netting or exterior of the bouncer is not allowed.
- In case of injury, contact a physician immediately.
- This is not an aquatic toy. Do not use in water.
- Do not drag on concrete or other rough surfaces.
- The carrying bag is for packaging use only and is not a toy.
- Unauthorized modifications to this product are not allowed.
- To reduce the risk of fire or electric shock, do not use the blower (air pump) with any solid-state speed control device.
- Product should be regularly checked for potentially unsafe conditions such as damaged cord, plug, housing, or parts. If such damage is found, the bouncer should not be used until properly repaired.
- Keep pets off and away from the bouncer and Blower.
- Do not attach items to the bouncer that are not specifically designed for use with the inflatable device, such as, but not limited to, jump ropes, clotheslines, pet leashes, cables, and chains as they have the potential to cause strangulation hazard.
- Changes to the original toy shall be carried out according to the instructions of the retailer of the original toy.
- Keep the area around the product clean, and clear of objects, to prevent slips and falls.
- Do not leave product inflated overnight.
- Do not jump off of the slide.
- Do not grab or hang on to the arch while sliding. Doing so may damage or tear the arch and could cause injury.
- Do not stand on the top of the slide, on the slide rails, or on the slide itself.
- To avoid possible serious injury, the sliding path and landing area must be clear of all obstacles and other users before sliding.
- Climb up the climbing wall of the slide and sit at the top of the slide with your feet pointing down the slide. Scoot forward and slide down the slide feet first.
- Only slide down feet first and never slide down head first to avoid the risk of a serious injury or death.
- Children are required to slide down with proper posture (refer to the following pictures) when playing on the product with slide.



Sit on the platform



Ready to slide



Sliding down



Sliding finish

PACKAGE CONTENT

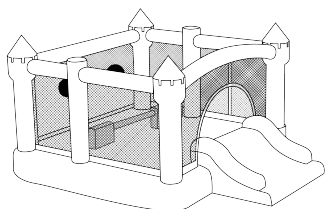

A

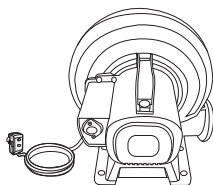

B

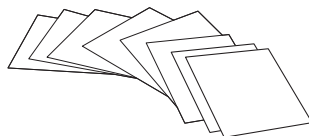

C



D



E

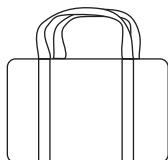

F



G



H



I

A	Bouncer	D	6 x Bouncer Ground Stakes	G	1 x Basketball
B	Air Blower with GFCI Plug	E	4 x Blower Stakes	H	1 x String
C	8 x Repair Patches	F	1 x Storage Bag	I	8 X hook-and-loop fastener ball

OPERATION INSTRUCTIONS

Set Up

- Note 1: Place the bouncer on a soft level ground surface at least 2M/6.56ft away from any structure or obstruction such as a fence, garage, house, overhanging branches, laundry lines or electrical wires.
- Note 2: Check the ground where the bouncer is to be inflated for any sharp objects. Do not install the bouncer over concrete, asphalt or any hard surface.
- Note 3: Set up away from any potential fire hazards.
- Note 4: Make sure the bouncer is inflated fully before children enter to play.

Bouncer Inflation

- 1** Remove the bouncer from the storage bag.

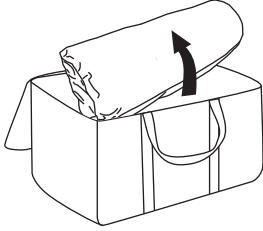

- 2** Spread out the bouncer.

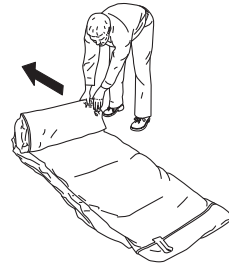

- 3** Wrap drawstring around the tube and end of blower once, and tie tightly in place.

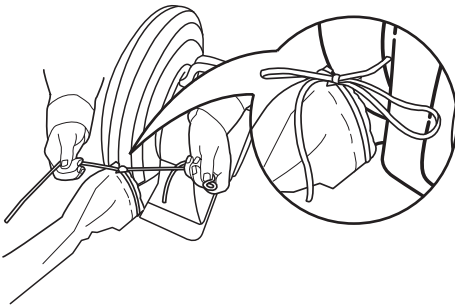

- 4** Plug the blower into an approved grounded outlet.

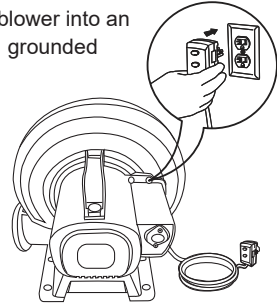

⚠ WARNING: ⚠

1. Plug into receptacle.
 2. Press RESET button: indicator should be ON.
 3. Press TEST button: indicator should be OFF.
 4. Press RESET button for use.
- DO NOT USE IF TEST FAILS.

- 5** Push blower ground stakes through blower base holes firmly to the lawn ground. (To avoid tripping, ensure the blower is free from debris and securely sited)

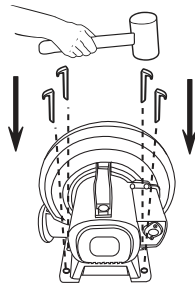

- 6** To inflate the bouncer, (press the reset button on GFCI), switch the blower on. The continual air-flow blower must be left on at all times while the bouncer is being used.

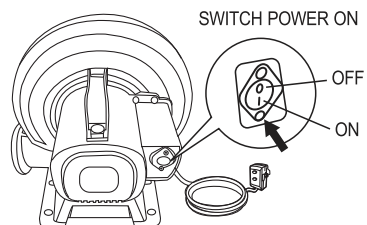

⚠ WARNING: ⚠

If the blower remains ON when the “test” button is pushed, the unit is NOT working properly. DO NOT USE THE UNIT. Take the unit to a certified electrician immediately.

- 7** To prevent overturn or lift during play, push stakes firmly into the ground. The stakes should be placed level with or under the ground in order to reduce tripping hazards.

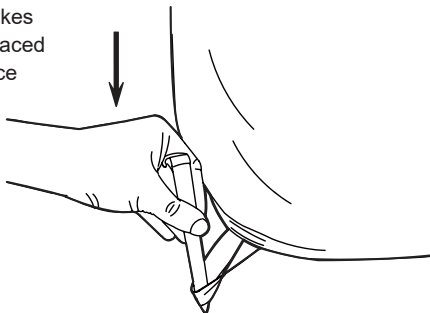

Basketball Inflation

- 1** Pull out and open the air valve, then hold the air valve with hands, blow up by mouth.

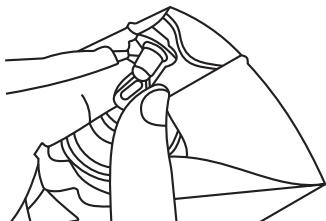

- 2** Quickly close the air valve and press it back under the surface of the ball.

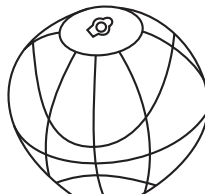

Take Down

Note1: Make sure all children exit the bouncer.

Note2: Make sure the bouncer is free from foreign objects.

Note3: Store the bouncer and the blower in a dry place for future use. Never leave either the bouncer or the blower outside in the rain when the product is not in use.

Bouncer Deflation

1

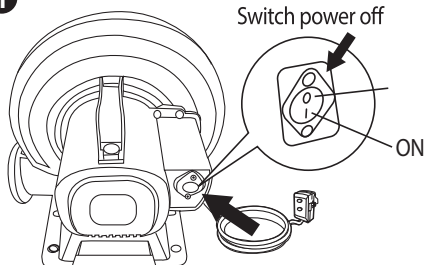

Turn off blower and unplug it from the outlet.

2

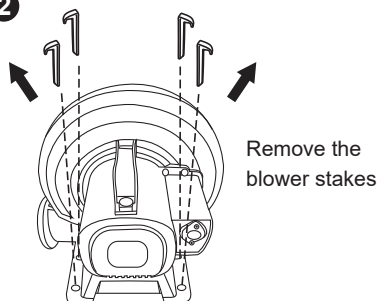

- 3** Untie drawstring from the intake tube and allow the bouncer to fully deflate.



- 4** Remove the bouncer stakes

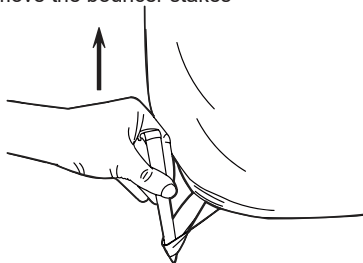

Storage

- 1** Fold it in half from one end.

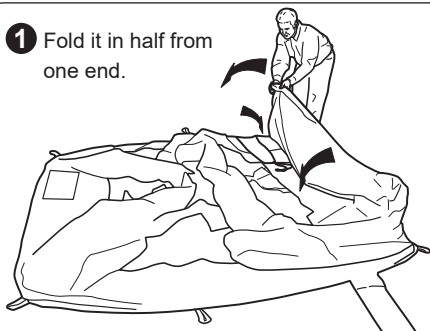

- 2** Fold it in half from the other end.

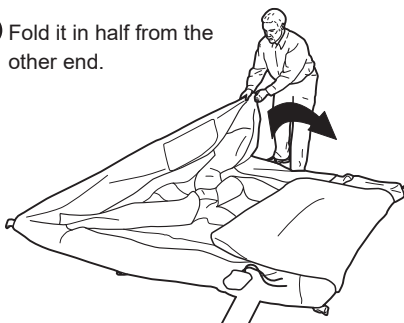

- 3** Fold it in half again from one end.



- 4** Roll it up tightly from the end opposite to the air fill tube.

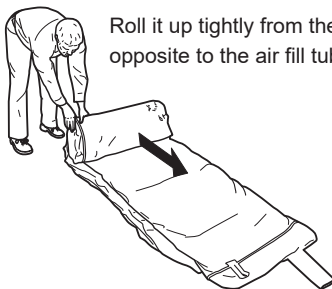

5

Compress air out as you are rolling up inflatable.

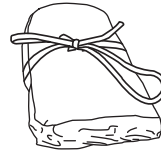
6

Wrap string around the folded bouncer, and tie tightly in place

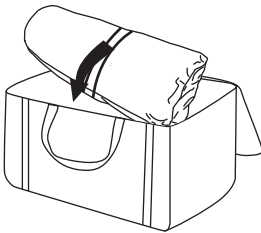
7

MAINTENANCE

- As this is an outdoor product, this inflatable is subject to wear and deterioration. Keep product properly maintained and watch for signs of fabric failure. Weak or torn surfaces must be repaired promptly.
- Seasonal inspection and maintenance should be conducted for any damage or leakage of the bouncer.
- The bouncer can be cleaned by wiping it down with a mild detergent. Keep water away from the blower at all times.
- Do not store the bouncer when wet. Store the product and the blower inside in dry conditions when not in use.
- Maximum weight limits must be obeyed at all times, or the unit may fail.
- Tears or punctures on the slide surface, steps or other areas can be repaired with the provided repair patches by hand with a needle and strong household thread(not included). The patch kit included is suitable for minor repairs. To repair, deflate the product thoroughly, and ensure the surface is dry. Cut patches to sizes suitable for repair.
- Your bouncer is designed with inner stitching to withstand constant air flow, so the unit is still functional with small holes. If outside stitching separates, stitches can be repaired using common thread.

TROUBLESHOOTING

Problem	Solution
How do I Prevent My Bouncer from Mold or Mildew Damage	<ol style="list-style-type: none"> 1. Bouncer MUST be COMPLETELY DRY before storage in order to avoid mold and mildew damage. DO NOT fold and store the bouncer if any moisture remains. Store it in dry conditions when not in use. 2. To keep the product clean: wipe the bouncer or blower using a dry cloth or a cloth dampened with a neutral, non-flammable, non- toxic cleaning and sanitizing solution or pure water.
The Unit Does Not Stay Inflated	Make sure the air blower is on, attached to air fill tube of the inflatable and running continuously while the inflatable is being used. Make sure the air fill tube is tied shut during use. Make sure the weight of users does not exceed manufactures specifications.
My Inflatable Does Not Fit In Its Case	Make sure that all the air is out of the inflatable. Fold the inflatable over every 24 inches, pressing extra air out. Once the inflatable is folded over multiple times to one long run of approximately 24" wide, roll the inflatable from one end to the other, into a "sleeping bag shape," continuing to push excess air out.
There Is A Puncture Hole In My Inflatable	Use strong thread or fishing line(not included) to sew the included patch(s) over the hole.
There Is Air Coming Out Of My Inflatable	This is normal. Air must escape from the inflatable to function properly
I Hear A Hissing Noise	This is normal. Air must escape from the inflatable to function properly, which may cause a hissing noise.
Can I Store My Inflatable Outside	No, you must store your inflatable every day. Weather conditions will destroy your inflatable if it is left out.
My Blower Is Not Working	Make sure you are using standard 110V power. Blowers do not function on 220V. If your Blower is equipped with a GFCI on the plug, make sure the GFCI is on, not in Test Mode. Check your outlet to make sure it is on.

WARRANTY

Inflatable Warranty

Inflatables are warranted to be free of defects in material and workmanship for One (1) Year from date of purchase. In order to establish eligibility, your original order number will be required. In the rare case of defect, products covered by this Limited Warranty will be repaired or replaced at no cost to you. Will, at its election, replace or make appropriate adjustment or repair to the product where inspection discloses any defects in material and workmanship occurring in normal usage within One (1) Year after purchase. Please note that in order to expedite processing, in some circumstances it may be necessary for you to send photographs of the product for evaluation, or to cut off and return your product's blower tube. If return shipping of a product covered under this Limited Warranty is required, we will pay the reasonable charges for such shipping at no cost to you. Products requiring replacement will be replaced with the same product, or a similar product of equal or greater value.

This Limited Warranty Shall Not Apply To Any Product:

- Subject to misuse, whether due to intentional acts, common negligence, or accident.
- That is not operated in accordance with the printed instructions that accompany the product.
- That has been operated beyond the rated capacity of the product or in extreme weather conditions.
- That has been repaired or altered by anyone other than manufacturer designated personnel.
- Material punctures.
- **That develops mold or mildew because it was stored wet. (IMPORTANT: It is crucial that all products and items should be STORED DRY. Mildew or mold may develop if stored wet and this Limited Warranty does not cover the presence of mild or mildew due to improper care or storage.)**

Contact Information

We want to hear your voice! Feel free to touch base if you encounter any issue when using our product(s) or want to know more about our brand.

We will be more than happy to provide top-notch pre-sales & after-sales service 24/7.