

JOY 39-3/4" DROP-IN 1 HOLE

Cat. No.
4-1931WH



Faucet Not Included

Width: 40"
Depth: 18-3/8"
Height: 6-5/8"

Features:

- ▶ For drop-in installation
- ▶ Made of Vitreous China
- ▶ Rak logo
- ▶ Available for 1-hole
- ▶ Pre-drilled overflow hole
- ▶ Compatible with #57080, #5600, or #5611

Colors:

WH White

Compliance Certification

Meets or exceeds the following specifications: ASME A112.19.2 2018 and CSA B45.1-18 for plumbing fixtures.

Interior Dimensions:

| | |
|------------------------------------|---------------|
| Basin Interior: | 21" x 10-1/2" |
| Basin Depth: | 5" |
| Water depth to overflow: | 3-1/4" |
| Back of basin to center of faucet: | 2-1/2" |
| Back of basin to center of drain: | 8-3/4" |
| Faucet: | 1-3/8" |

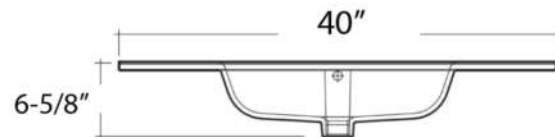
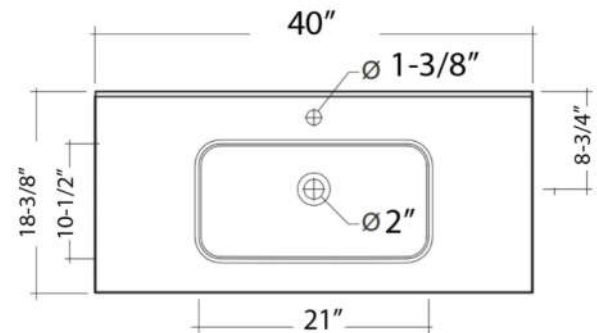

Dimensions of fixture are nominal and may vary within the range of tolerances established by ASME Standard A112.19.2-2018. Dimensions and specifications subject to change without notice.