

ASSEMBLY INSTRUCTIONS

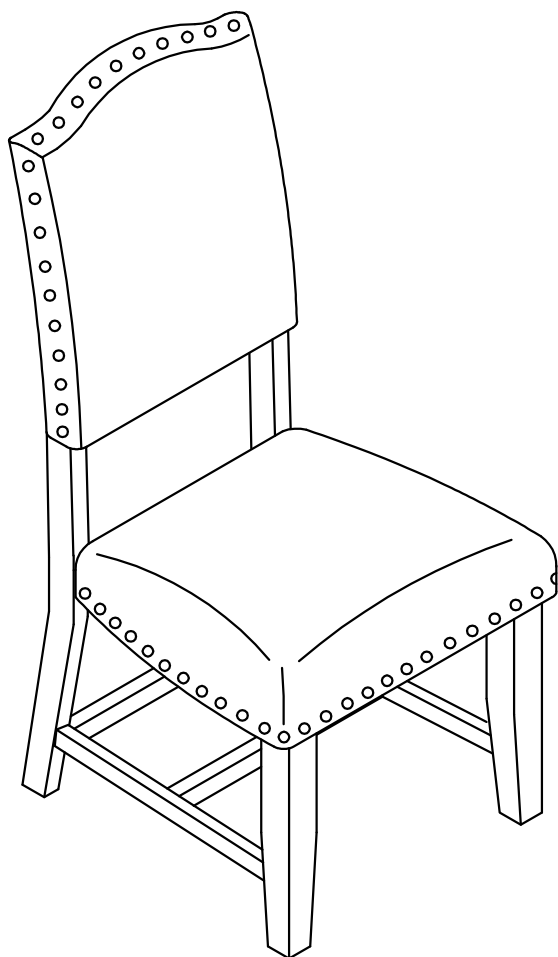

TOOLS REQUIRED

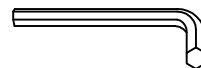

Allen Wrench

(Included)



Phillips
Screwdriver

(Not Included)



1 - People
Recommended

ASSEMBLY RATING

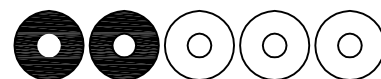

EASY —————> DIFFICULT

The Assembly Rating is a 5-point system showing the level of effort needed to assemble a specific product.

PRE ASSEMBLY INTRODUCTION

We understand building ready-to-assemble furniture can be a challenging experience for some. To help avoid confusion, we have provided some helpful tips that may speed up the process.



Teamwork

ALWAYS have at least two people to help with transporting and assembling the product to avoid potential injury and/or damage.



Suitable Location

Assembling near the area of the intended location is highly recommended.



Sufficient Space

Make sure you have enough space to move around during the assembly.

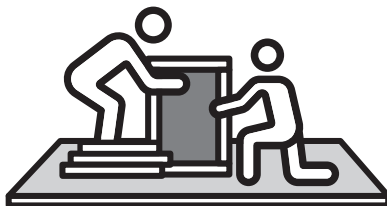

Avoid Scratches

Use cardboard, blankets or a carpeted area while assembling furniture to prevent scratches.



Flat Surface

Make sure the furniture rests on a flat and level surface with each leg evenly touching the floor.

ASSEMBLY AND CARE ADVICE



FAILURE TO FOLLOW THE GUIDELINES BELOW MAY RESULT IN INJURY AND/OR PROPERTY DAMAGE.



Position each part correctly and insert screws or bolts into their respective holes.



Turn clockwise to tighten and only tighten when step is completed or when instructed to do so.



Use the appropriate hand tools or power tools for assembly. Select steps, such as tightening screws and/or bolts, may require hand tools to avoid causing damage during assembly.



Save the instructions and store any supplied tools for later maintenance.



After two weeks, check and tighten any loose hardware and repeat again every six months thereafter.

IT IS THE USER'S RESPONSIBILITY TO MAINTAIN THE FURNITURE. THE HARDWARE MAY LOOSEN OVER TIME AND MAY CAUSE THE FURNITURE TO BE WOBBLY AND UNABLE TO SUPPORT ITS INTENDED WEIGHT CAPACITY. THIS MAY LEAD TO COLLAPSE AND MAY CAUSE SERIOUS INJURY.

SIDE CHAIR

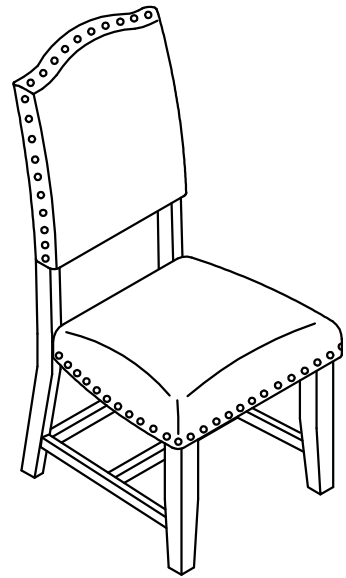

- Please keep instructions for future reference.
- Check the quantity and irregularity of parts and hardware before you start.

PARTS

#1 1pc x2

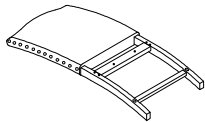

Chair Back

#2 1pc x2

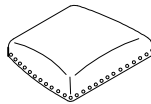

Seat Cushion

#3 2pcs x2

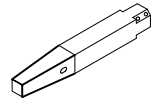

Front Leg (L&R)

#4 2pcs x2

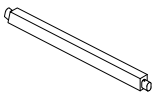

Stretcher (L&R)

#5 1pc x2

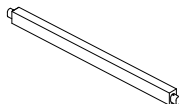

Mid Stretcher

HARDWARE

#A 4pcs x2



Bolt $\text{Ø}5/16'' \times 3''$

#B 4pcs x2



Bolt $\text{Ø}5/16'' \times 2-3/8''$

#C 2pcs x2



Bolt $\text{Ø}5/16'' \times 1-1/2''$

#D 10pcs x2

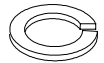

Lock Washer
 $\text{Ø}5/16'' \times 13\text{mm}$

#E 10pcs x2



Flat Washer
 $\text{Ø}5/16'' \times 19\text{mm}$

#F 1pc x2



Allen Wrench M4

#G 4pcs x2



Screw #8 x 1-3/4"

#H 2pcs x2



Screw #8 x 1-1/2"

Exploded View

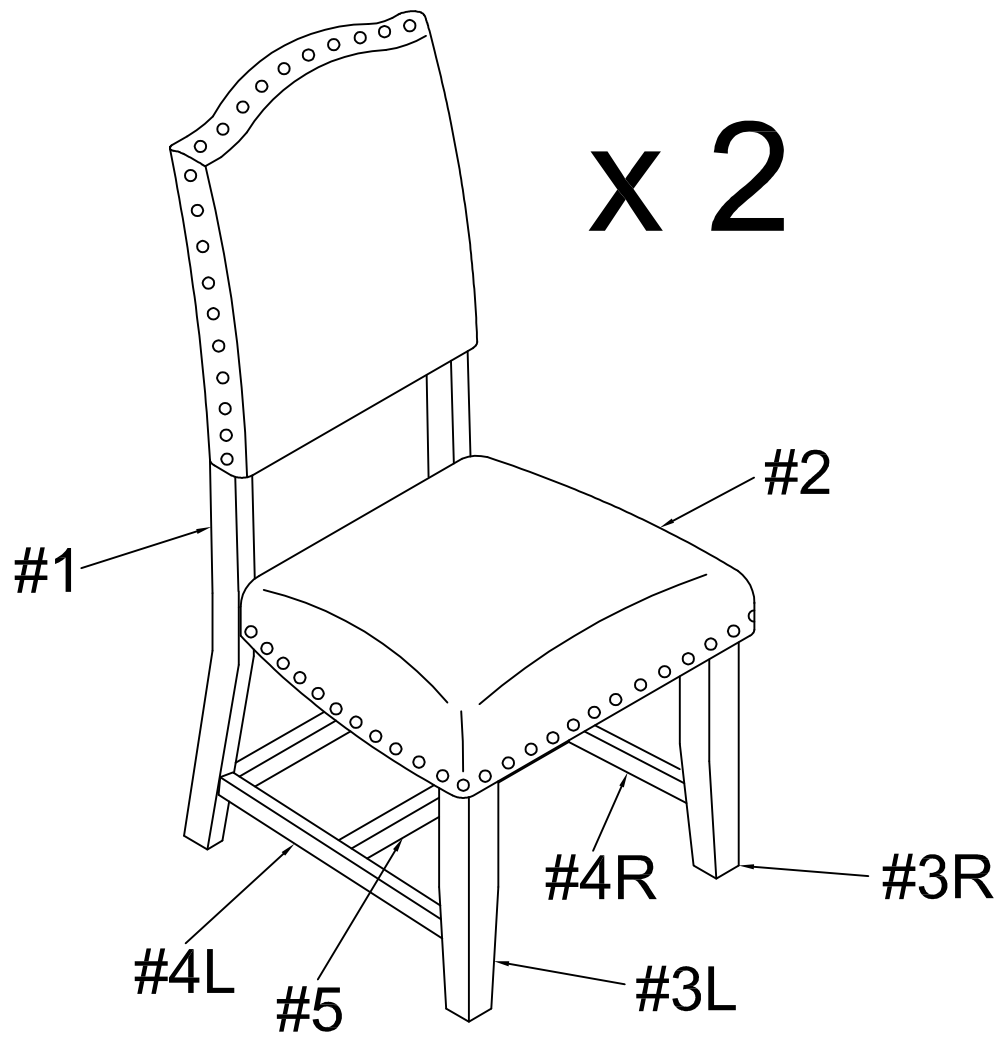

ASSEMBLY INSTRUCTIONS

1

Prepare 2 bolts assembly by inserting lock washer (#D), then flat washer (#E) onto bolts (#C). Align chair seat (#2) to the holes of the chair back (#1). Secure center 2 holes by using bolts (#C). Do not fully tighten bolts (#C).

- Part #1 x1pc
- Part #2 x1pc
- Hardware #C x2pcs
- Hardware #D x2pcs
- Hardware #E x2pcs

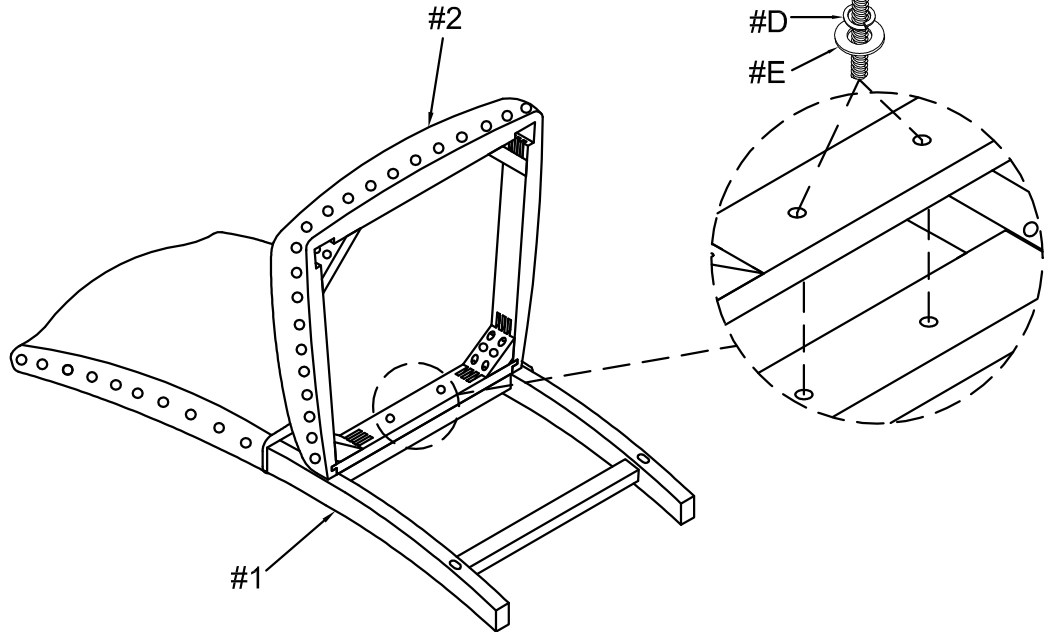

2

Prepare 4 bolts assembly by inserting lock washer (#D), then flat washer (#E) onto bolts (#A). Secure corner holes of the seat (#2) to chair back (#1) by using bolts (#A). Fully tighten all bolts (#A,C).

- Hardware #A x4pcs
- Hardware #D x4pcs
- Hardware #E x4pcs

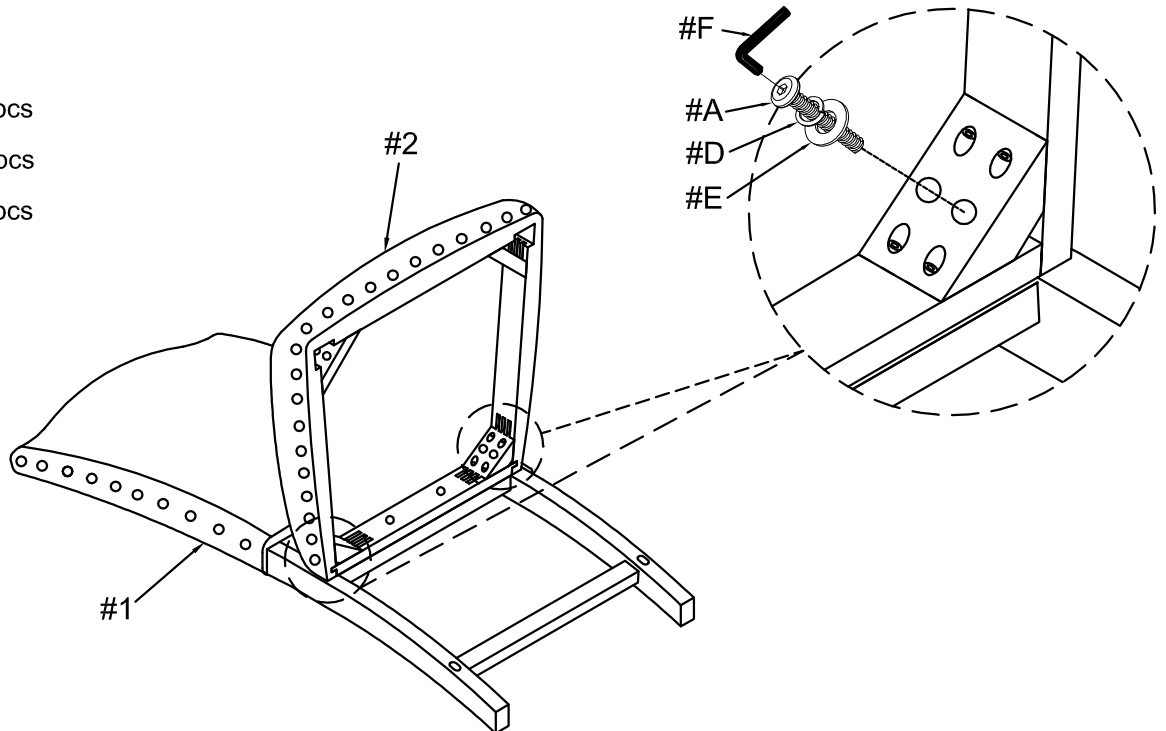

ASSEMBLY INSTRUCTIONS

3

- Part #3 x2pcs
- Part #4 x2pcs
- Part #5 x1pc
- Hardware #B x4pcs
- Hardware #D x4pcs
- Hardware #E x4pcs

1) Prepare 4 bolts assembly by inserting lock washer (#D), then flat washer (#E) onto bolts (#B). Align front legs (#3R/L) to the holes of the chair seat (#2). Secure by using bolts (#B), but do not fully tighten.

2) Align side stretchers (#4R/L) to the gaps of the legs. Align middle stretcher (#5) to the gap of the side stretchers (#4R/L). Fully tighten bolts (#B) on front legs.

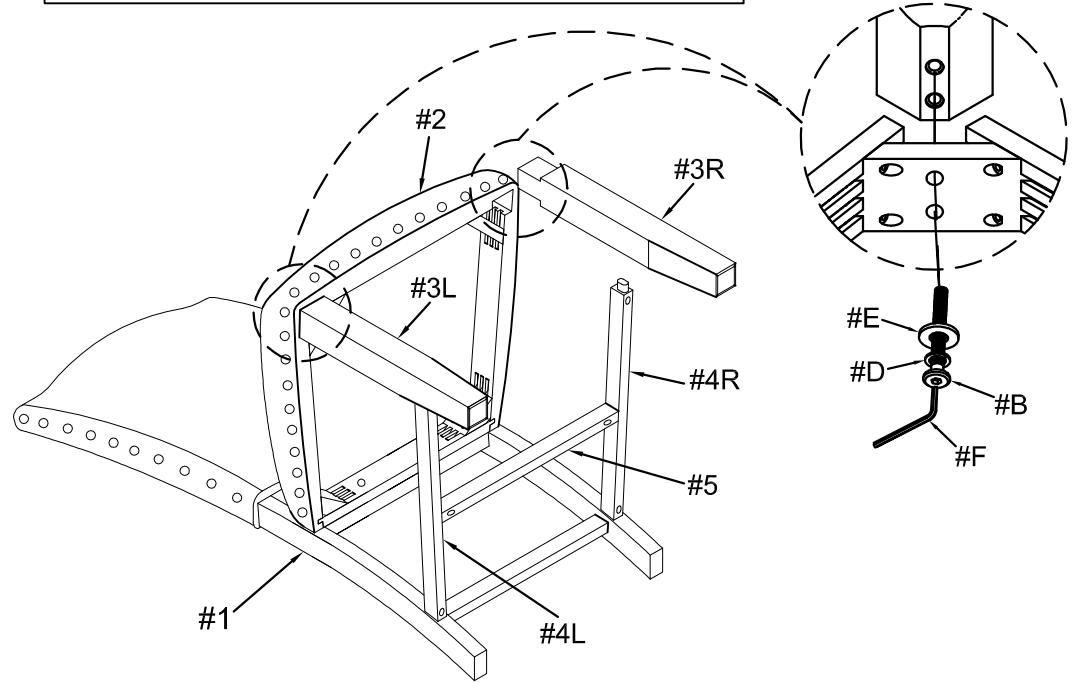

4

- Hardware #H x2pcs
- Hardware #G x4pcs

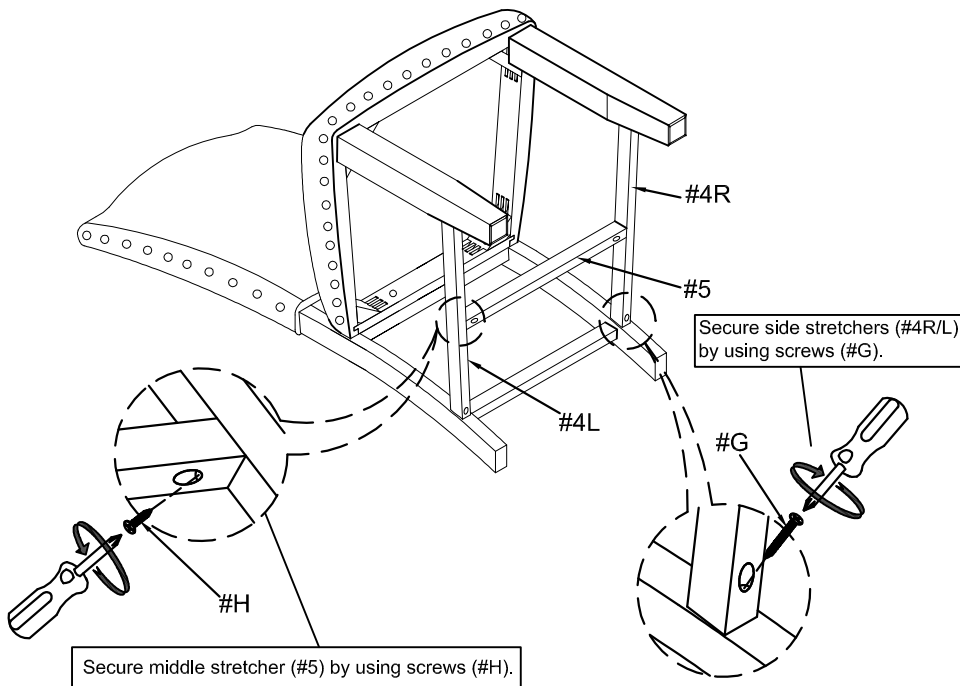

ASSEMBLY COMPLETED



Please ensure the furniture rests on an even and flat surface. If the product wobbles or feels loose, double-check all bolts and/or screws are properly tightened and secured.



Keep this handy!

Please retain this instruction manual and any order-related information for future reference.



Lift, don't drag!

To avoid damage to product please always LIFT the product when transporting or adjusting the placement.