

Instruction for Reference

Note: The product in this instruction is NOT same one of this link.

Installation Steps

Step 1: Mounting sink leg

The first step is to put the pool on the ground; the second step is to insert the 4pcs short legs into the hole at the bottom of the pool in turn; the third step is to insert the long legs into the short legs in turn (note that the direction of the hole in the long legs of the pool faces outward).



Step 2: Installation of pool beam

Align the beam with the long leg hole of the pool, secure it with a long screw, and finally tighten it with a wrench.





Step 3: Install drainage device.

Remove the plastic nut and black plastic rubber ring from the drainer, make sure that the white rubber ring is on the drainer, and put it into the water inlet slot. After inserting it, put the black rubber ring on the drainer, and then rotate and tighten the plastic nut.



Step 4: Drain pipe installation

Place the black rubber ring in the drain pipe, thread the yellow fitting to the drain pipe, and then assemble the drain pipe to the drainer

assembly and tighten. (Make sure that there is a black plastic washer in the drain pipe) See if you need to install an anti-odor gasket, tear off the film on the blue decorative sheet, plug it in from the bottom of the drain, and then install the black anti-odor gasket to the bottom of the drain, and adjust the position as needed.

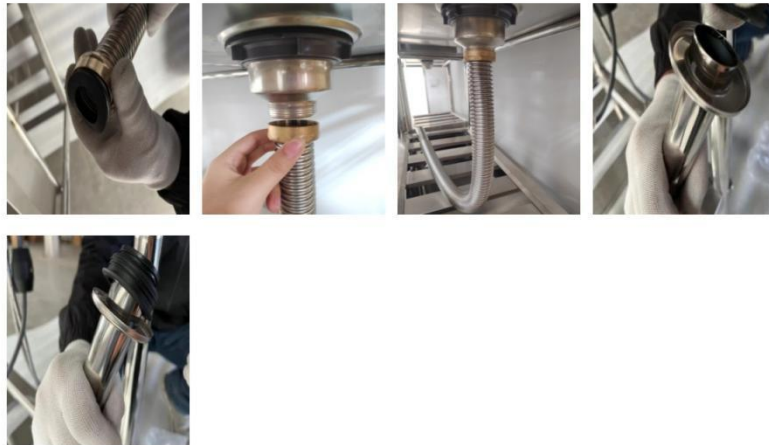

Step5: Sink installation completed



Thank you for choosing our company's products,please read this instruction manual carefully