

ASSEMBLY INSTRUCTIONS

GATHERING CHAIR WITH "X"INSERT

Thank you for purchasing this quality product. Be sure to check all packing material carefully for small parts that may have come loose inside the carton during shipment.

Read instructions carefully. Remove all wrapping material, staples and packing straps from the carton. See Hardware and Furniture Part List for guidance. Be sure you have all parts before you start assembling. Place all wooden furniture parts on clean and flat soft surface, such as carpet or rug to prevent from being scratched.

CAUTION : (1) **DO NOT FULLY-TIGHTEN THE NUTS OR BOLTS INITIALLY UNTIL ALL THE NUTS AND BOLTS ARE IN PLACE.**
(TO AVOID CAUSING DAMAGES TO THE THREAD, DO NOT OVER-TIGHTEN THE NUTS OR BOLTS.)

(2) **KEEP ALL HARDWARE PARTS OUT OF REACH OF CHILDREN.**

NOTE: MUST TIGHTEN SCREWS PERIODICALLY, WITH USED SCREWS WILL BECOME LOOSE CHECK TIGHTNESS OF ALL SCREWS EVERY 6-8 WEEKS.

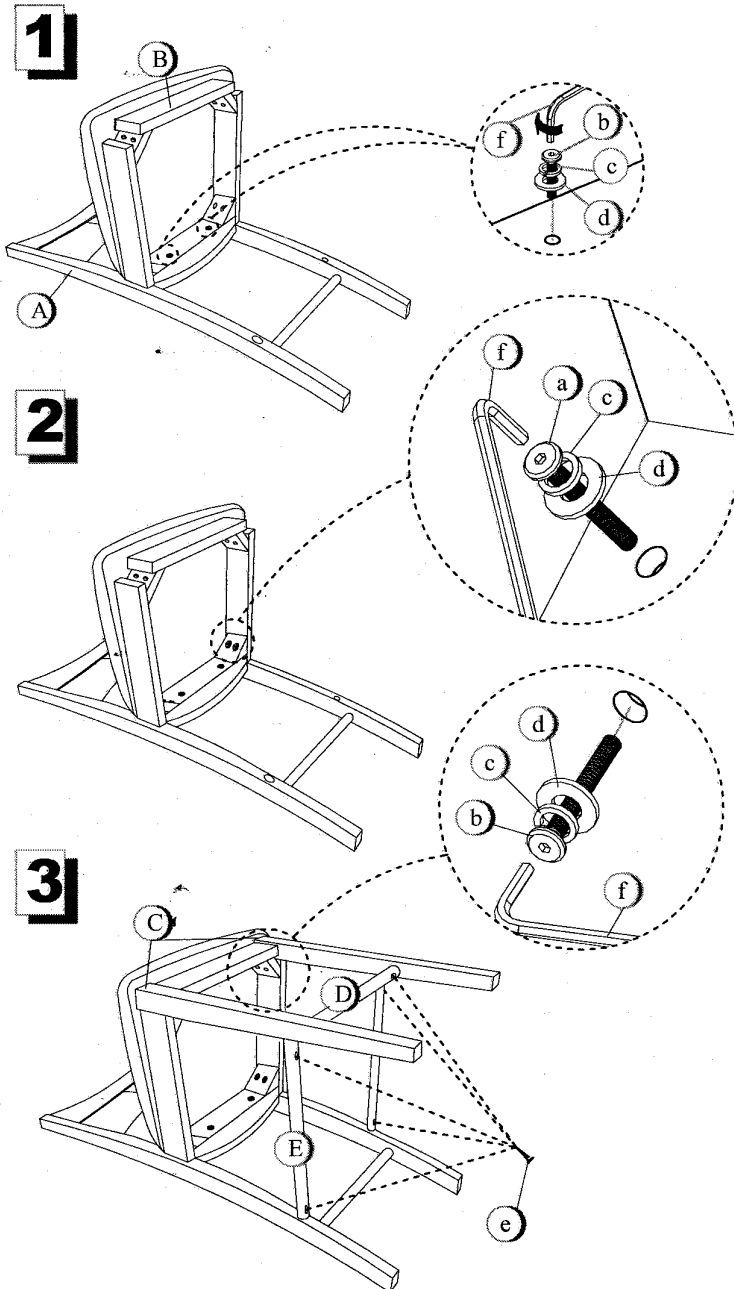

TOOLS REQUIRED (NOT PROVIDED)

PHILLIPS SCREWDRIVER



PARTS LIST :

CODE	COMPONENT	QTY
A	CHAIRBACK	2pcs
B	CUSHION WITH SEAT FRAME	2pcs
C	LEG	4pcs
D	STRETCHER-SHORT	2pcs
E	STRETCHER-LONG	4pcs

HARDWARE LIST :

CODE	COMPONENT	QTY
a	JCBC BOLT 90mm	8 pcs
b	JCBC BOLT 60mm	8 pcs
c	SPRING WASHER Ø12mm	16 pcs
d	FLAT WASHER Ø18mm	16 pcs
e	WOOD SCREW	12 pcs
f	ALLEN KEY	1 pc

NOTE : ALL ABOVE LISTED ARE FOR 2 PCS OF CHAIR

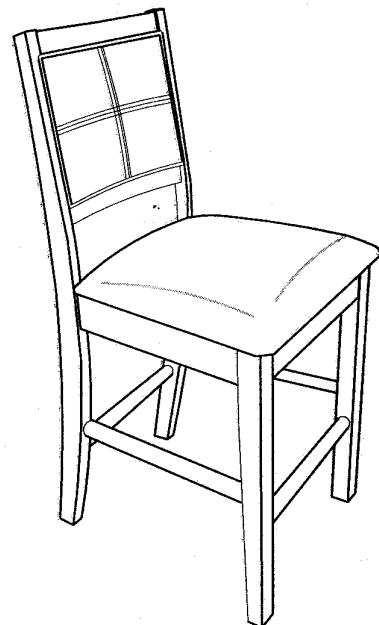

MADE IN MALAYSIA