

USER MANUAL

FLOOR & WALL MIRRORS



THE BATHROOM MIRROR



01 / Explan Ation

- Please read this instruction carefully before using.
- Before the installation, please check the parts list to make sure the package includes all parts.
- Make sure the wall can bear the weight of the mirror.
- Do not use strings or chains to hang the products.
- Please keep your important things away during the installation to avoid any damage.

Care Advice

- a. Before using, wipe with a dry and clean cloth.
- b. Check if all the screws & bolts are tight or not, every three months or as needed.
- c. Clean with glass cleaner or detergent.

02 / Parts List

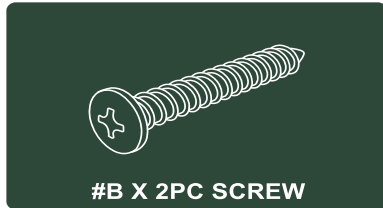
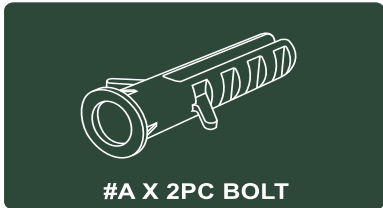
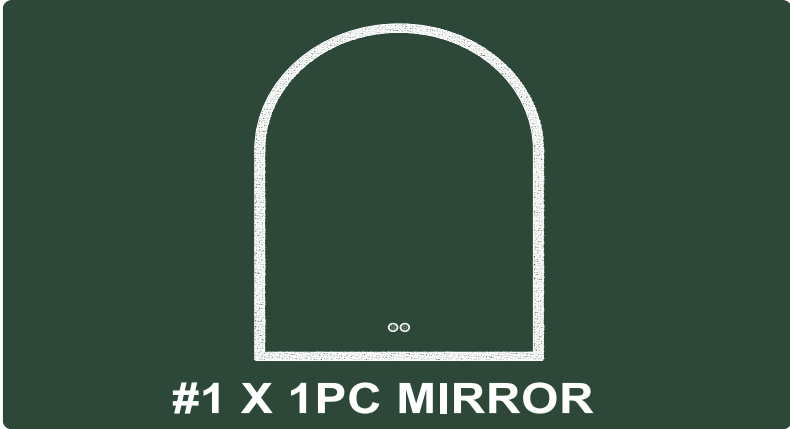

Tools Required (Not Include)



03 / Installation Steps

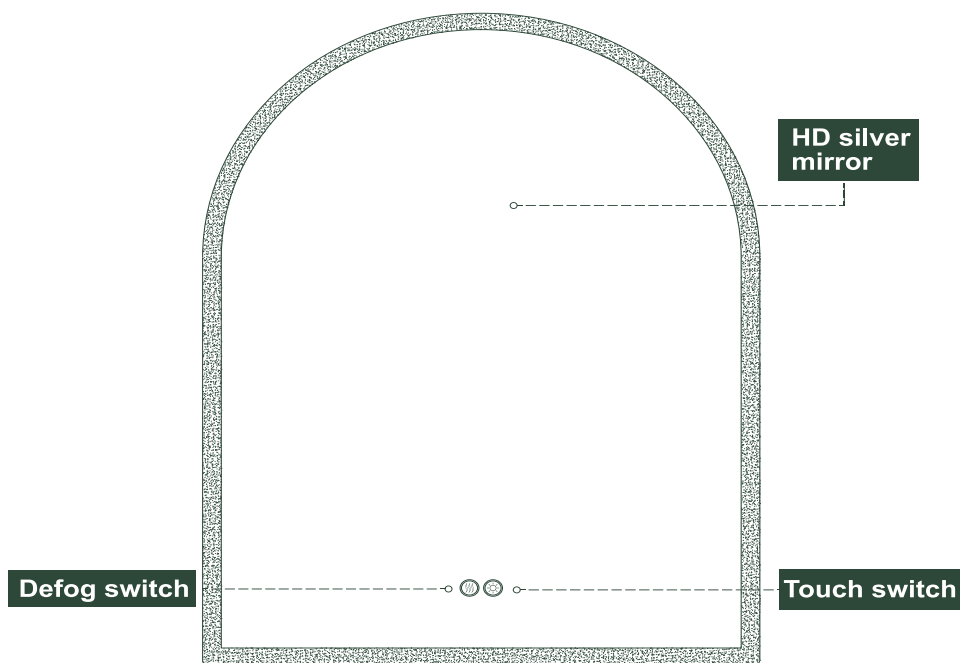

ILLUSTRATION

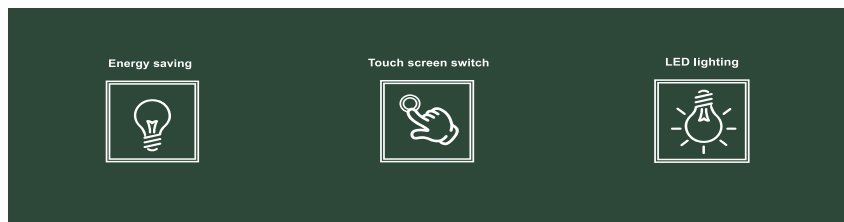

04 / Installation Steps

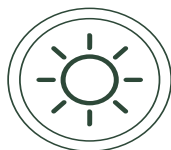

First touch:

turn on the light

Second touch:

turn off the light

Brightness adjustable:

long press to adjust brightness

LONG PRESS THE TOUCH SWITCH,CHANGES TO ANY COLOR TEMPERATURE YOU PREFER,AND CAN KEEP THIS MEMORY FOR YOUR NEXT TIME OPERATION.

05 / Installation Steps

1. Material: Glass+aluminum
2. Power Supply: Power driven, AC110V
3. Certification: CE/UL/IP44
4. Function: Intelligent dimming, electronic anti-fog

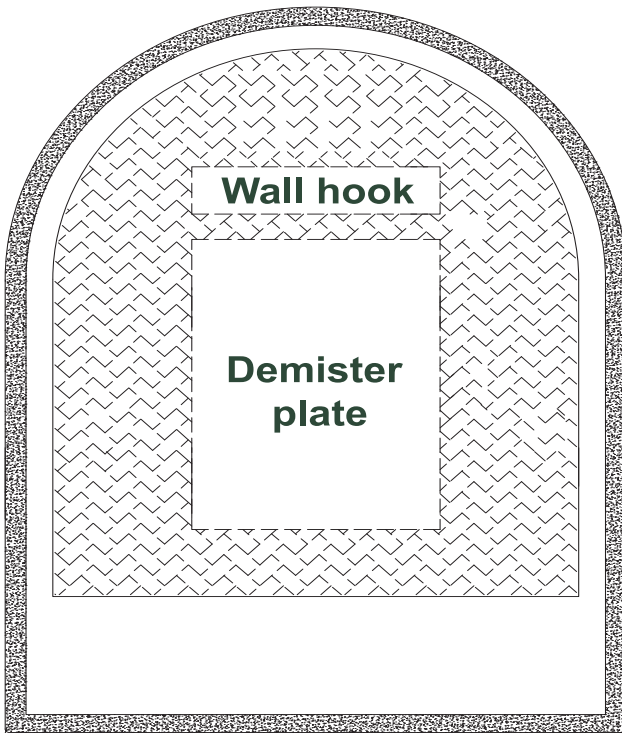

06 / Installation Steps

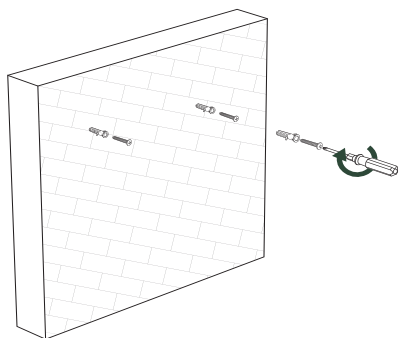

①

Measure the hole distance between two hanging clamps on the wall.

②

Mark the distance on the wall at a required height.

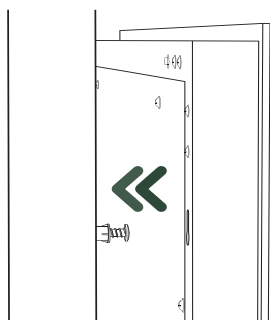

③

Drill holes on the wall as arranged positions.

④

Put the plastic expansion screws into the holes.

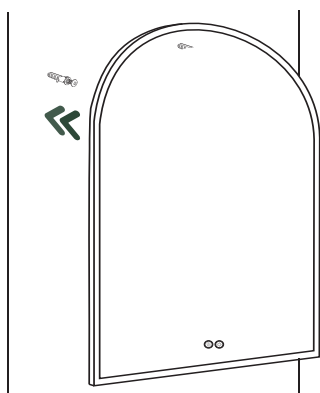

⑤

Put the metal screws into the plastic expansion screws.

⑥

Hang the mirror onto the wall.