

ASSEMBLY INSTRUCTION

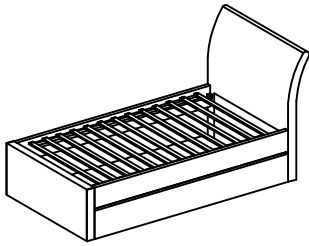

+ Do Not Use Power Tools



+ Suggested Adults

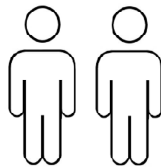

NOTE:

- 1 Read instructions cover to cover.
- 2 Save all packaging until assembly is completed.

1 IMPORTANT SAFETY INFORMATION

Do not assemble the product if any of the following parts arrived damaged:

- Part # - Side Rails
- Part # - Center Support Bar
- Part # - Support Legs
- Part # - Slats

2 IMPORTANT ASSEMBLY INFORMATION

Assembly Step Ensure the side rail bracket is fully hooked onto bolt loosely threaded with both washers on the **OUTSIDE** of the bracket first, then proceed to fully tightening all 4 corners.

+ Parts Included

- ① Headboard
(1 of pc)



- ② Footboard
(1 of pc)



- ③ Slat
(1 of pc)



- ④ Trundle Slat
(1 of pc)



- ⑤ Side Rail
(2 of pcs)



- ⑥ Trundle Front Panel (PU)
(2 of pcs)



- ⑦ Trundle Side Panel
(2 of pcs)



- ⑧ Wooden Block
(4 of pcs)



+ Hardware Included

- A Allen Key
M5 x 70mm
(1 of pc)



- B JCBB
M8x20mm
(16 of pcs)



- C CSK
M3.5 x 16mm
(24 of pcs)



- D CSK
M4 x 32mm
(64 of pcs)



- E Roller
(6 of pcs)



ASSEMBLY INSTRUCTION

①

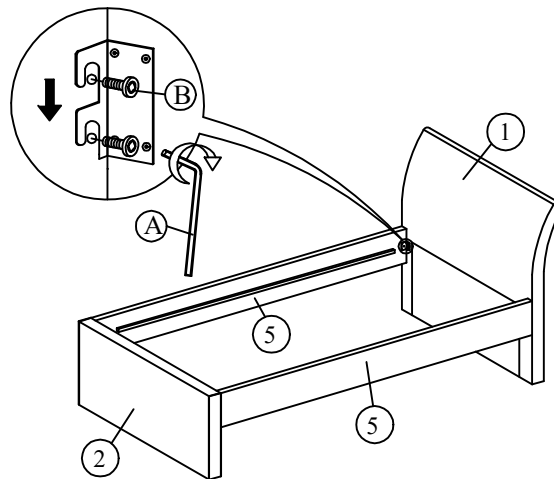

②

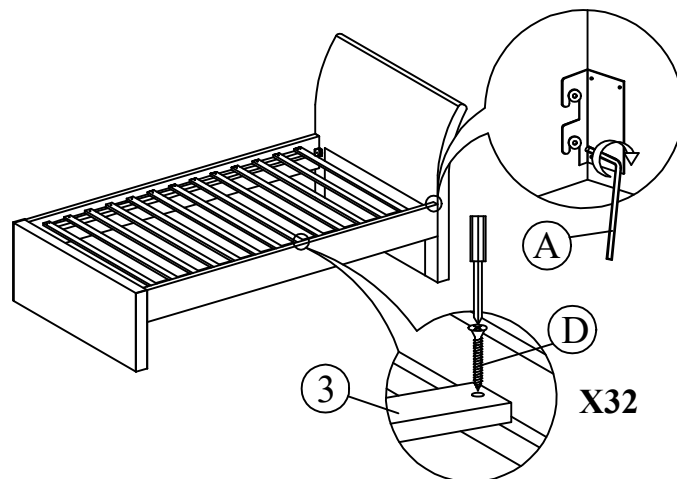

③

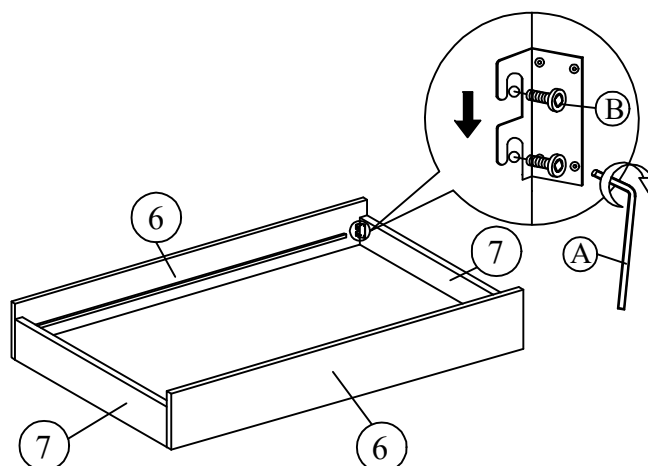

ASSEMBLY INSTRUCTION

④

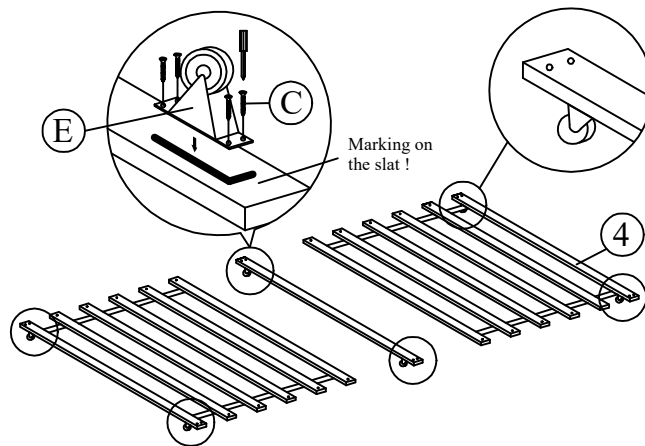

⑤

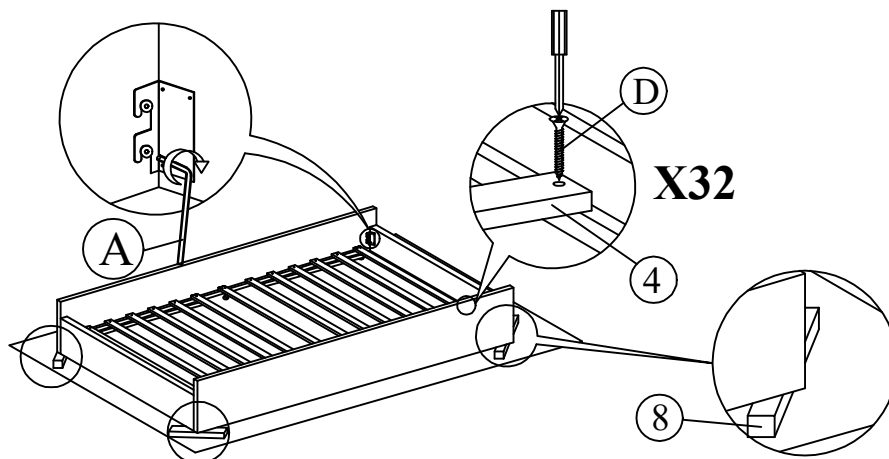

⑥

