



# SDHR1534PNR



33.75" x 14.75" x 18" (H x W x D)

15" wide shallow depth built-in undercounter all-refrigerator with panel-ready door, stainless steel interior, black cabinet, lock, and digital controls

### Highlights:

Uniquely shallow depth under 18" for an easy fit in kitchen islands

Flexible design allows for built-in or freestanding use in 15 inch wide spaces

Stainless steel interior cabinet for lasting durability and easier cleanup

### Product Features:

15" Wide All-Refrigerator	1.7 cu.ft. interior for residential cold storage
Less than 18" deep	Unique 17.75" shallow depth is ideal for wet bars, island kitchens, and other undercounter areas with limited footprint space
Built-In capable	Front-breathing design lets you make the best use of space by installing your appliance under the counter
Versatile design	Innovative panel-ready bracket kit allows easy custom panel installation, but can also be removed cleanly if you redesign your space and prefer the look of a fully finished stainless steel door
Panel-ready door	European style articulating door hinge and bracket kit allow easy installation of custom door trim panels to match adjacent cabinetry; recommended panel dimensions: 3/4" thickness at 30" H x 14 5/8" W
Fully articulating European style hinge	Smoother opening and a better fit with an integrated European hinge
Stainless steel interior	Walls and floor are constructed from stainless steel for added strength and easy cleanup
Factory installed lock	Keyed lock for a secure interior (2 keys included)
Frost-free operation	No-frost operation for minimal user maintenance



## SDHR1534PNR Specifications:

Overview	
Nominal Height	34.0" (86 cm)
Height of Cabinet	33.75" (86 cm)
Nominal Width	15.0" (38 cm)
Width	14.75" (37 cm)
Nominal Depth	18.0" (46 cm)
Depth	18.0" (46 cm)
Depth with door at 90°	32.5" (83 cm)
Capacity	1.72 cu.ft. (49 L)
Defrost Type	Frost-Free
Door	Stainless Steel/Panel-Ready
Cabinet	Black
US Electrical Safety	ETL
Canadian Electrical Safety	ETL-C
Energy Usage/Year	270.0kWh/year
Amps	1.0
Voltage/Frequency	115 V AC/60 Hz
Weight	77.0 lbs. (35 kg)
Parts & Labor Warranty	1 Year
Compressor Warranty	5 Years
UPC	761101145693
Refrigerator Features	
Sabbath Mode	Yes
Door Swing	RHD
Reversible	Yes
Shelf Type	Glass
Shelf Qty	3
Adjustable Shelves	Yes
Thermostat Type	Digital
Fan Type	Interior and Exterior
Refrigerant Type	R600a
Refrigerant Amount	0.64oz.
High Side PSI	270.0
Low Side PSI	105.0
Level Legs Qty	4
Interior Light	Yes

Temperature Range	36°F to 43°F
Sound Level	33.6 dB
Dimensions	
Interior Height	26.0" (66 cm)
Interior Width	10.63" (27 cm)
Interior Depth	12.25" (31 cm)
Compressor Step Height	3.75" (10 cm)
Compressor Step Width	10.63" (27 cm)
Compressor Step Depth	5.0" (13 cm)

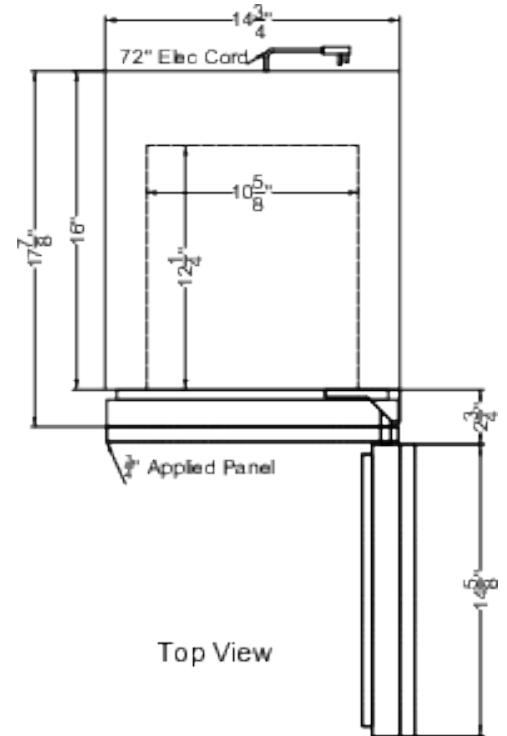

Top View

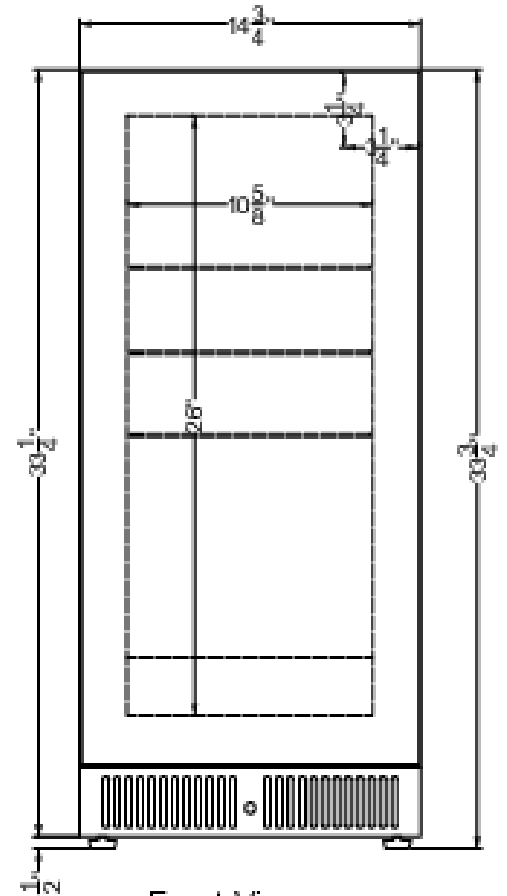

Front View