

48" Single Vanity

All Dims Measured to the Nearest 0.1"

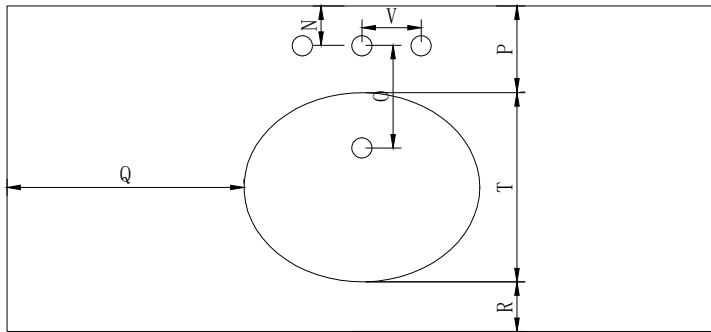

- A : Overall Width = 48" / 121.9cm.
- B : Overall Depth = 22" / 55.9 cm.
- C : Counter Height = 36.8" / 93.6 cm.
- D : Cabinet Width = 46.7" / 118.8 cm.
- E : Plumbing Cutout Height = 12" / 30.5 cm.
- F : Plumbing Cutout Width = 12" / 30.5 cm.
- G : Edge of Cabinet to Edge of Cutout = 17.4" / 44.1cm.
- H : Floor to Bottom of Cutout = 16.5" / 42 cm.
- I : Drawer Height:
I1 = 7" / 17.8 cm.
- J : Drawer Width:
J1 = 10.6" / 27.1 cm.
- K : Door Height = 22.7" / 57.7cm.
- L : Door Width = 9.8" / 25.1 cm.
- M : Toe Kick Height = 3.25" / 8.2 cm.
- N : Rear Edge of Counter to Rear Edge of Faucet Hole = 2.6" / 6.8 cm.
- O : Centerline of Faucet Hole to Drain Hole = 7" / 17.7 cm.
- P : Rear Edge of Counter to Rear Edge of Sink = 5.8" / 14.9 cm.
- Q : Edge of Counter to Edge of Sink = 16" / 40.7 cm.
- R : Front Edge of Counter to Front Edge of Sink = 3.3" / 8.5 cm.
- S : Sink Width = 16" / 40.5 cm.
- T : Sink Depth Front/Back = 12.7" / 32.5 cm
- U : Distance between Sinks = w/o
- V : Rear Middle of Counter to Rear Middle of Faucet Hole = 4" / 10.2 cm.

