

Floor-mounted bathtub faucet

When you open the package, please check the accessories listed in the Standard Parts List, and check whether the parts are complete. Please contact the distributor if there is any defect.

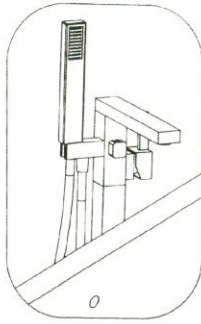

Standard Parts List

No.	Part Name	Quantity
1	main body assembly	1
2	straight pipe	1
3	allen key	1
4	screw	2
5	decorative covers	1
6	water hose	2
7	three-jaw	1
8	expansion screws	3
9	handheld shower	1
10	shower hose	1

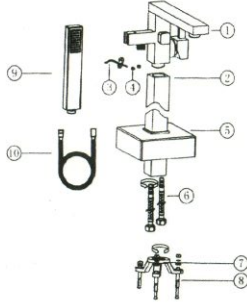

2. Please make sure the size is the same to this size drawing.

1. String the straight pipe, decorative cover and three claws on the hose as shown in the diagram,

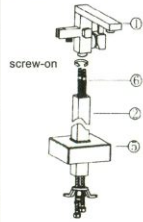

2. Connect the main body to the straight pipe through twisting the hexagon socket screw with the allen key

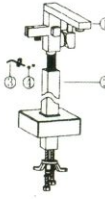

3. Work on the inlet pipe as shown below

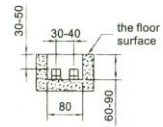

4. Connect the hoses and inlet pipes

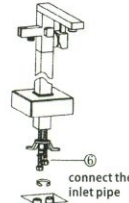

5. Screw the fixed seat on the main assembly



6. Drill holes as shown in the diagram

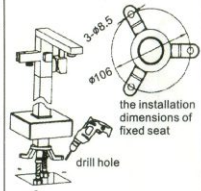

7. Fix the faucet assembly with the expansion screw



8. Twist the shower hose on the main body and handheld shower



assembly diagram



Floor-mounted bathtub faucet

When you open the package, please check the accessories listed in the Standard Parts List, and check whether the parts are complete. Please contact the distributor if there is any defect.

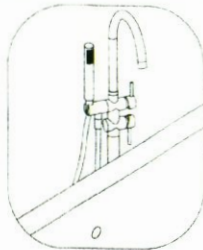

Standard Parts List

No.	Part Name	Quantity
1	main body assembly	1
2	straight pipe	1
3	ornament cover	1
4	screw	2
5	decorative covers	1
6	expansion screws	3
7	handheld shower	1
8	shower hose	1

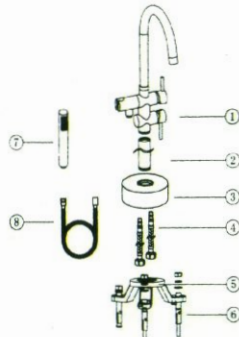

2. Please make sure the size is the same to this size drawing.

1. String the straight pipe, decorative cover and three claws on the hose as shown in the diagram,

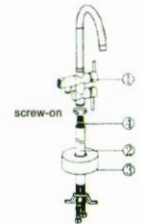

2. Connect the straight pipes with the main body

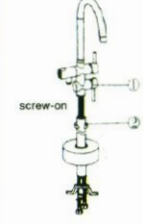

3. Work on the inlet pipe as shown below

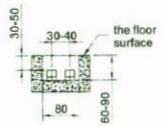

4. Connect the hoses and inlet pipes



5. screw the long three-jaw on the main body

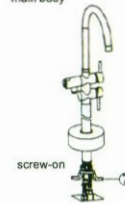

6. Drill holes as shown in the diagram

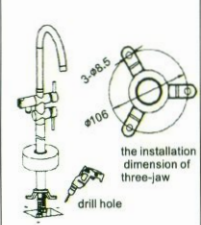

7. Fix the faucet assembly with the expansion screw



8. Twist the shower hose on the main body and handheld shower

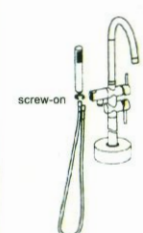

assembly diagram

