

# ASSEMBLY INSTRUCTIONS

## Corner Wall Cab

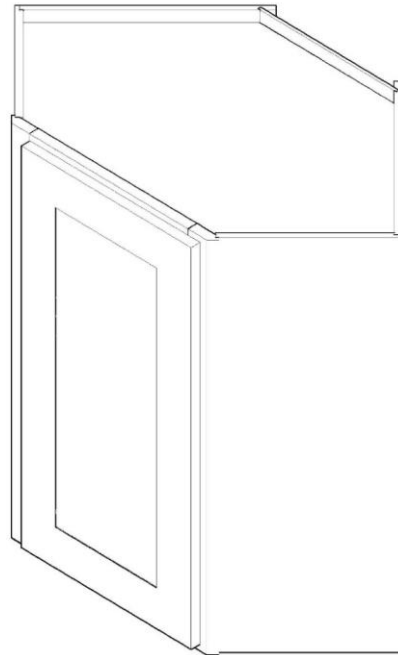

ASSEMBLY INSTRUCTIONS

**Unpacking Precautions**

If using a sharp object to unpack the cabinet components and the packing materials, be careful to avoid scratching or damaging the cabinet components. The various packing materials may be used to protect the cabinet components during assembly. During the unpacking process, place the various components away from and to the side of the work area so that they will not be inadvertently knocked over or otherwise damaged.

**Hardware Considerations/Screw Size Clarification**

(I) (Small 1/2")

(J) (Medium 1 ")

(K)(Large 1 1/8")

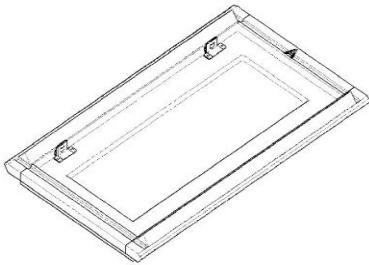

**Step 1:**

Lay the face frame with doors (A) on a soft surface, doors facing down.

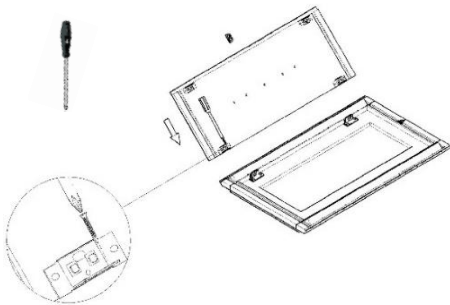

**Step 2:**

Using the wood glue, squeeze a small bead of glue in all grooves before assembling the cabinet sides, bottom, top and back panels. Be careful not to use too much glue, this could cause excess glue to squeeze out and onto the panels. If this should happen, be sure to remove quickly.

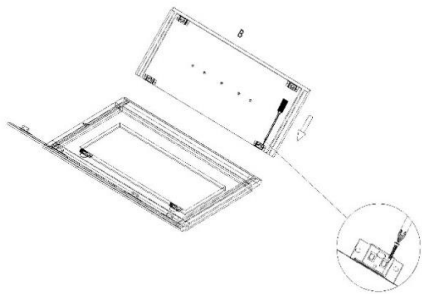

Slide the right side (R) & left side (L) panels into the grooves of the face frame, and mount the male clip to the face frame with the screw driver. Each male clip will need 2 small screws(I). fig 1

fig1

**-2-**

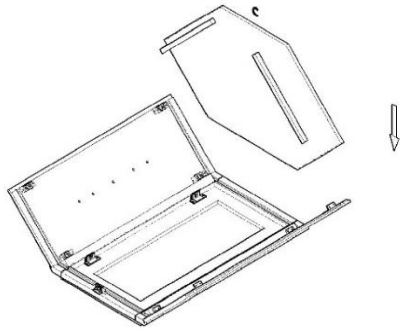

**Step 3:**

Slide the top and bottom panel into the grooves of the right and left side panels, and then into the groove in the frame below until it is fully seated.

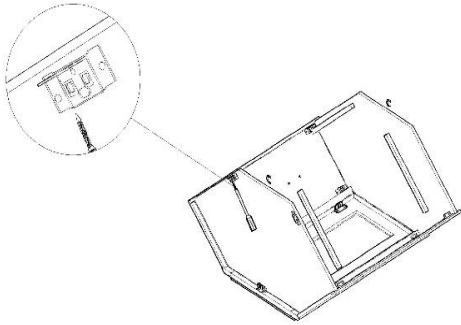

**Step 4:**

There are three clips on the bottom panels and three clips on the top panels. Secure each clip with 2 small screws(l).

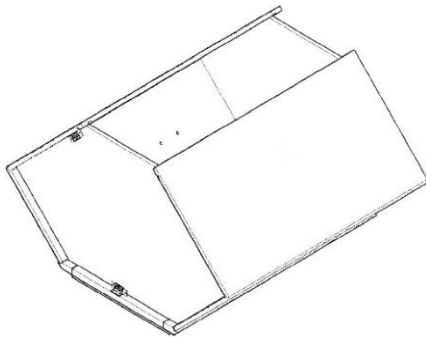

**Step 5:**

Attach the two side panels, connecting the bottom and top panels with metal clips(two on the top & two on the bottom) secure with two small screws per clip.

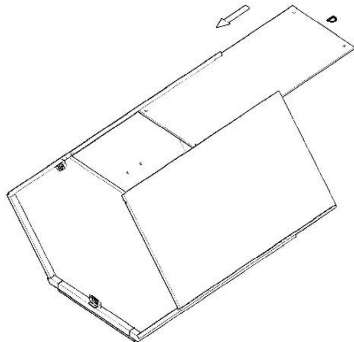

**Step 6:**

Insert the back panel (D) between the two side panels.

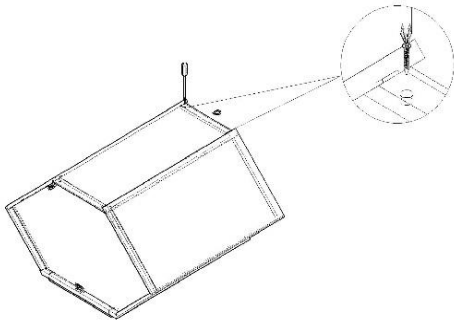

**Step 7:**

Use the long screws (K) and the pre-drilled holes to attach the back panel to the edges of the top & bottom panels.

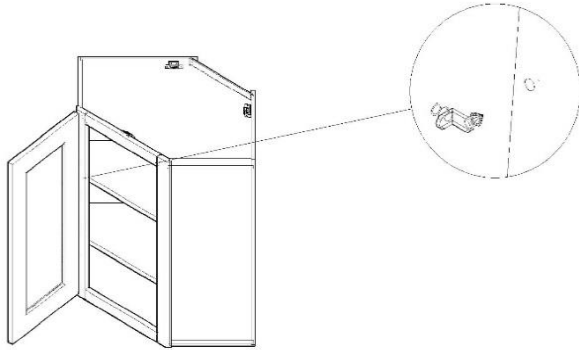

**Step 8:**

1. Put the shelf pins on the left and right side panels using the holes provided. Be sure pins on the right & left are in the same position on each side to insure a level fit.