

Selecting the Correct Light Bulb

- Maximum Wattage: 60W
- Light Bulb Type: E27 (Edison Screw) GLS Bulb
- Do not exceed the maximum wattage of the light bulb. This may cause your light fitting to overheat



If the supply cord is damaged, it cannot be replaced, and the lamp must be scrapped.

Do not exceed the maximum wattage or use a different shape of light bulb. This may cause permanent damage to your light fitting. Always switch off and allow to cool before changing bulbs. Use a soft cloth to handle bulbs, avoid directly touching the bulbs as this will shorten their life.

Cleaning Care:

Finish – We recommend cleaning with a soft dry cloth. Do not use abrasive materials as these will rub away the protective coating.

Always switch off and allow the bulb to cool before replacing the bulb.

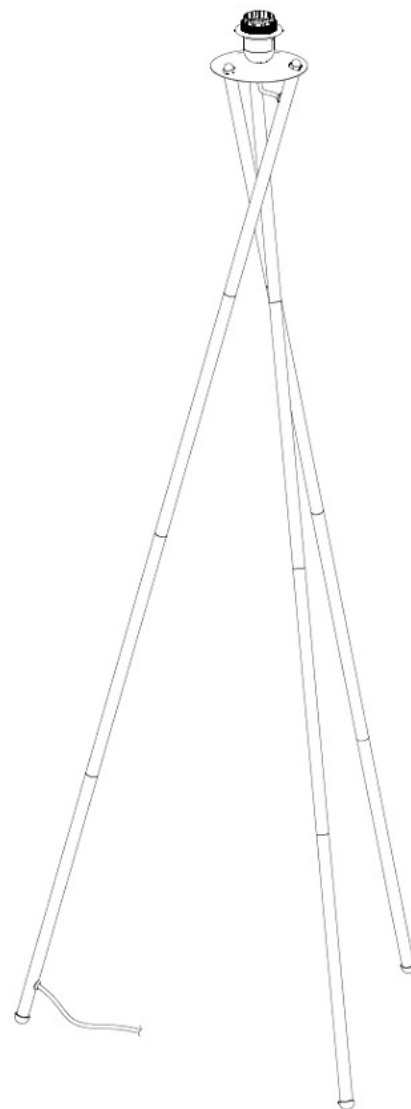

Thank you for purchasing this floor lamp. Please read through the instructions and warnings carefully before use to ensure safe and satisfactory operation of this product.

Please keep these instructions for future use.

Contents:

1x Floor Lamp comprising of:
3 x Pre-wired Legs
6 x Un-wired Legs
1x Circular Plate with Lampholder

Before Starting:

Please read through these instructions before commencing work and keep them for future reference.

Fixing Instructions:

Step1:

Remove any additional packaging (end protectors etc.)

Step 2:

Screw the top sections of the legs into the circular body of the floor lamp, taking care not to cross the threads. Screw the lower sections of the legs into the top sections of the legs, taking care not to cross the threads.

Step 3:

Pull any excess cable through the bottom of the pre-wired leg.

Step 4:

Secure the shade (not supplied) with the retaining skirt. Insert the bulb (not supplied), do not exceed the wattage stated on the lampholder or shade (whichever is the lower wattage), also suitable for use with energy saving bulbs and LED bulbs.

Step 5:

Insert the plug into the wall outlet and switch on at the wall socket.

1

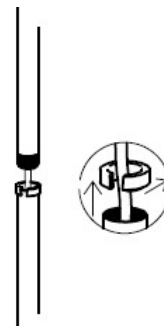

3

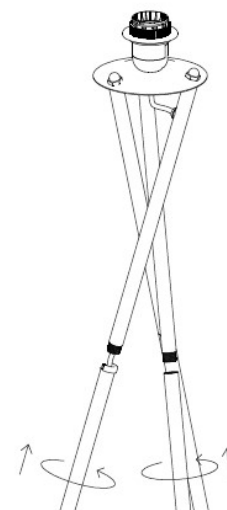
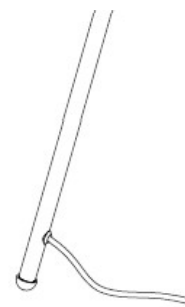

4

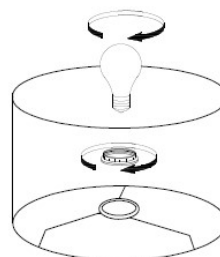

5

