

woodline

shade solutions

ASSEMBLY INSTRUCTIONS: PAVONE UMBRELLA

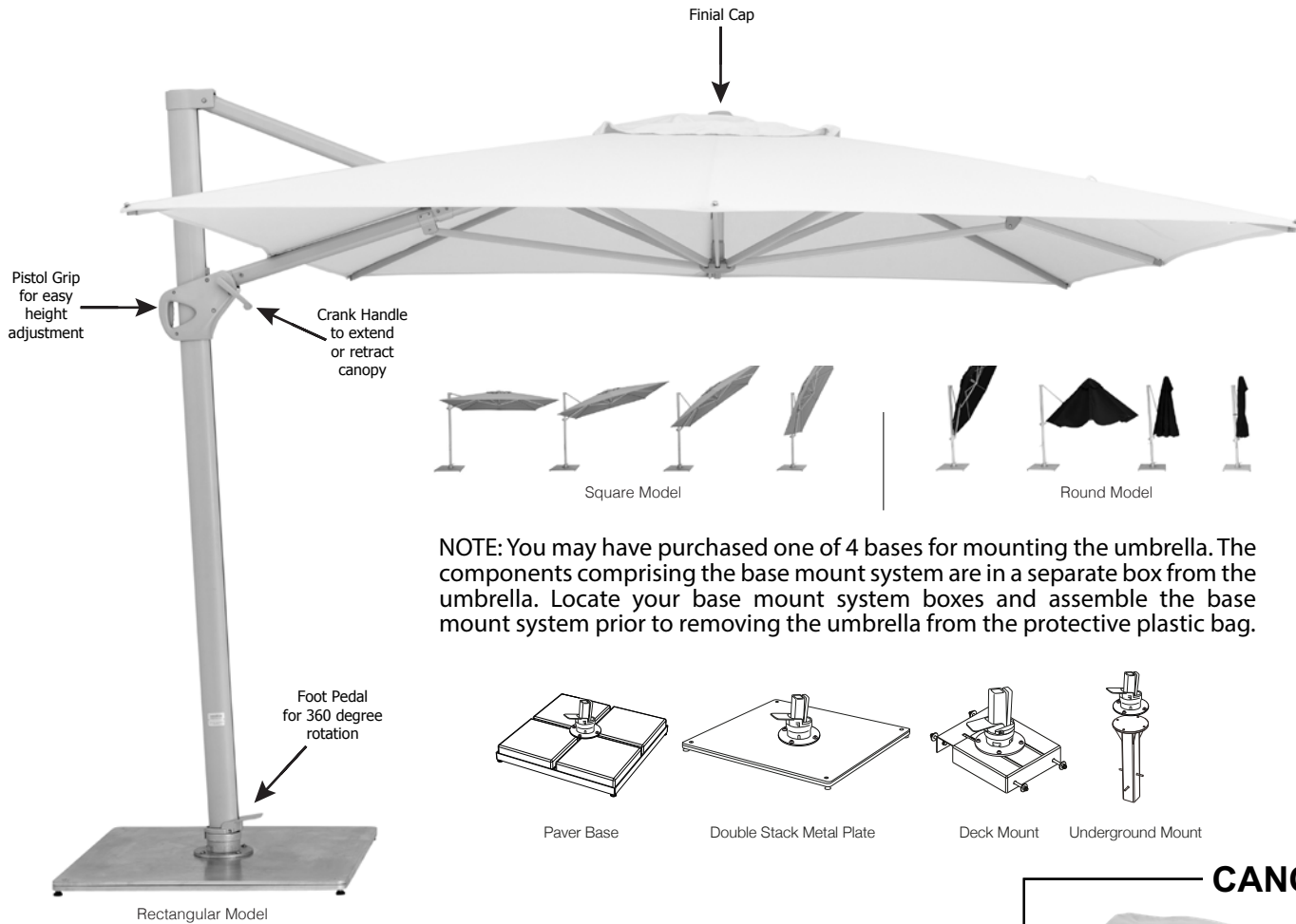

NOTE: You may have purchased one of 4 bases for mounting the umbrella. The components comprising the base mount system are in a separate box from the umbrella. Locate your base mount system boxes and assemble the base mount system prior to removing the umbrella from the protective plastic bag.

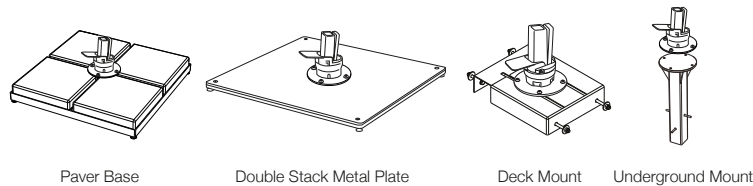

SUPPLIED PARTS

| | |
|--|--|
| <p>1 X UMBRELLA POST AND CANOPY STRUCTURE UNIT</p> <p>PACKED</p> | <p>1 X COVER BAG AND STICK</p> <p>PACKED</p> |
| <p>1 x ADAPTOR PLATE</p> <p>PACKED</p> | <p>1 x FOOT PEDAL</p> <p>PACKED</p> |
| <p>4 X M8x25mm COUNTERSUNK SCREWS + 5mm ALLEN KEY</p> <p>PACKED</p> | <p>1 x CRANK HANDLE + 2.5mm ALLEN KEY</p> <p>PACKED</p> |
| <h3>CANOPY BAG</h3> <p>1 X UMBRELLA CANVAS</p> <p>PACKED</p> <p>LOXX KEY</p> <p>PACKED</p> | <p>2 x M8x25mm PAN HEAD SCREWS + WASHERS + 6mm ALLEN KEY</p> <p>PACKED</p> |

PACKED BY: _____ DATE: _____

CHECKED BY: _____ DATE: _____

ASSEMBLING UMBRELLA STRUCTURE TO THE BASE:

1) Remove the individual parts from the packaging and locate the adaptor plate and foot pedal. Using the supplied 5mm allen key, attach the adaptor plate to the underside of the foot pedal with the 4 x M8x25mm screws, hand tightening to ensure a solid fit. Connect the foot pedal and adaptor plate to the base (supplied separately) using the 4 x M10x35mm dome head screws (supplied with the base) and tighten using the 6mm allen key. Raise the umbrella structure and slide it over the top of the umbrella mast, ensuring the canopy side of the structure is pointing in the same direction as the foot pedal.

2) Join the umbrella pole and foot pedal mast together using the 2 x M8x25mm pan head screws and tighten using the 6mm allen key until they are securely connected to each other.

3) Attach the crank handle to the umbrella pole using the supplied 2.5mm allen key.

4) First proceed to next page and fit the canopy as instructed. **Once canopy is in place** on structure turn the crank clockwise to fully extend the fitted canopy. Adjust your canopy to the preferred angle by manually squeezing the pistol grip and pushing the sliding arm mechanism up or down.

5) By pressing on the foot pedal the umbrella can be effortlessly rotated through 360 degrees to the required position.

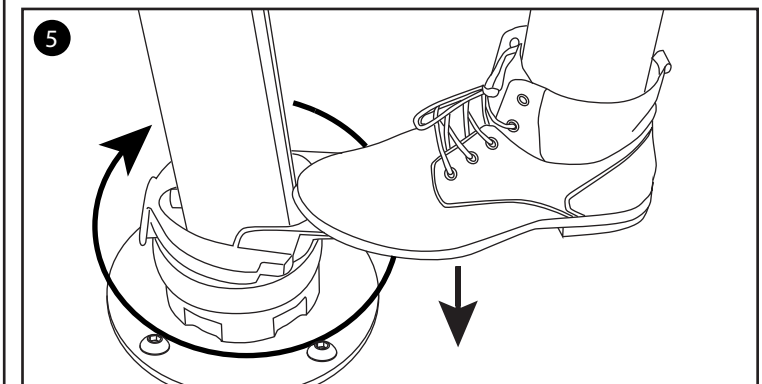
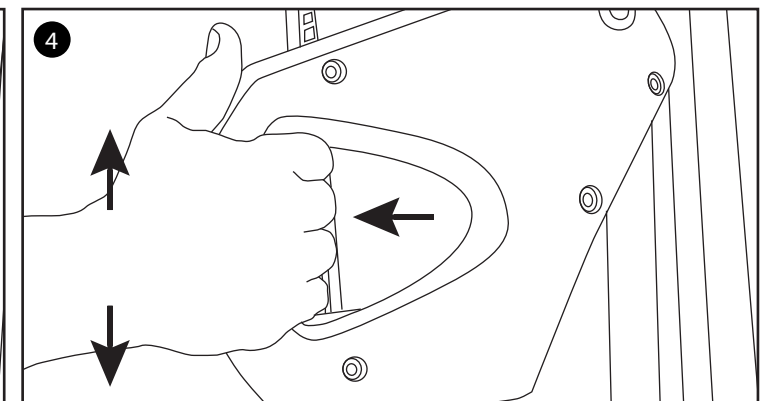
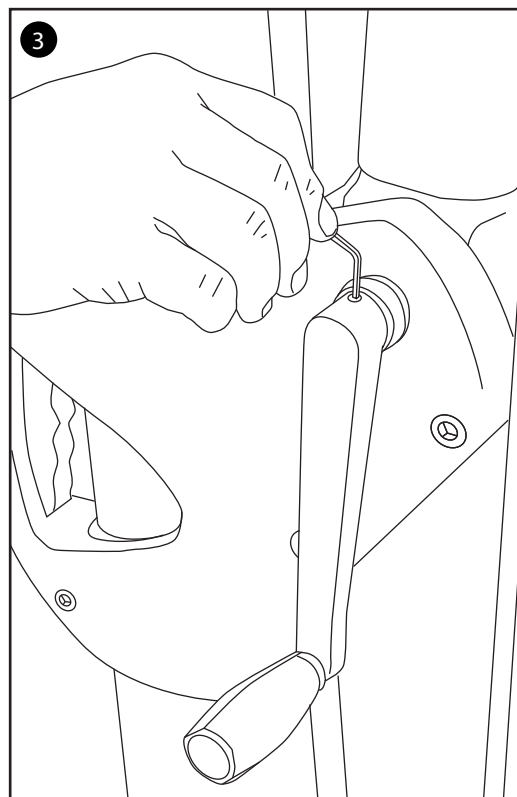
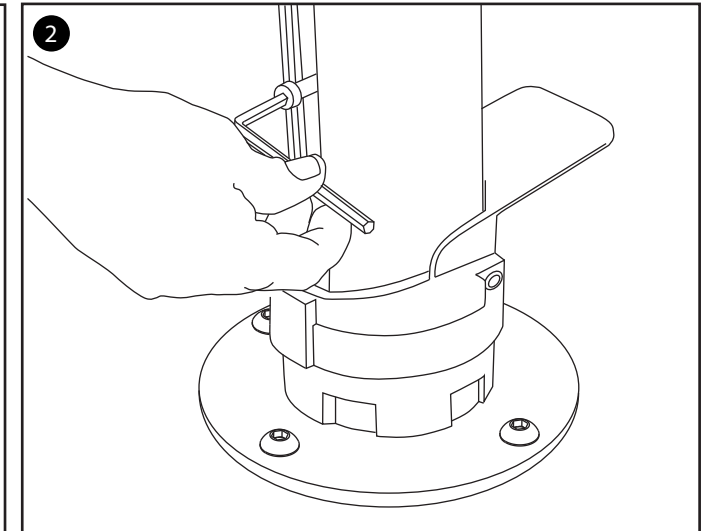
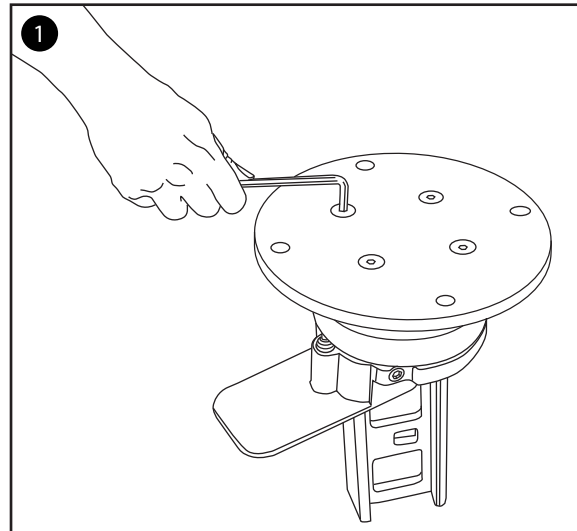

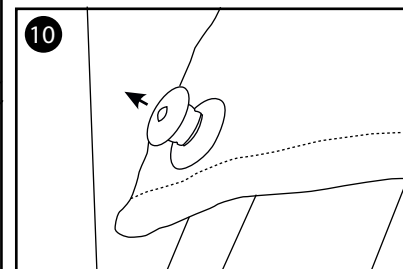
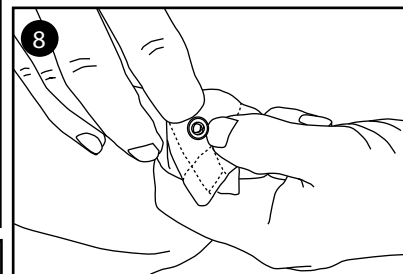
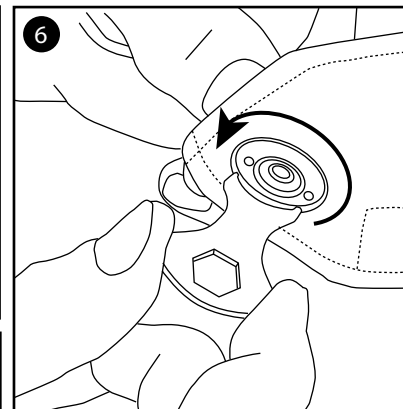
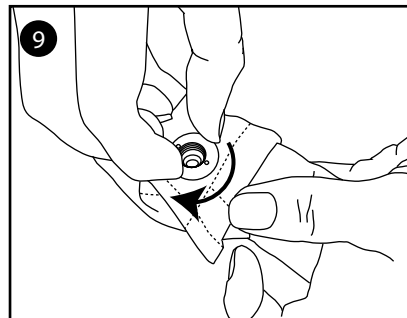
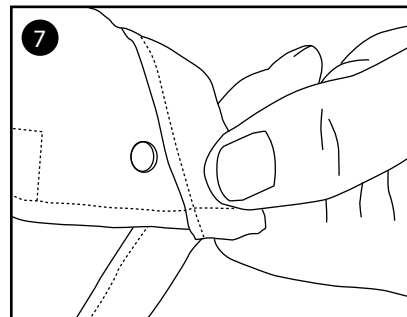
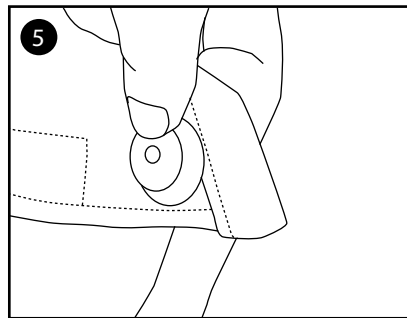
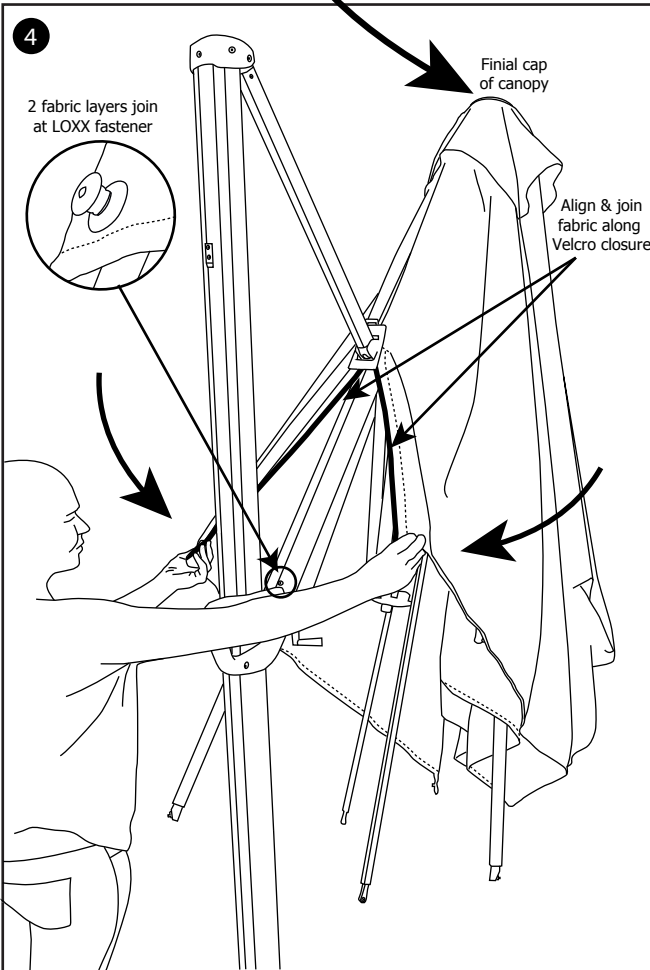
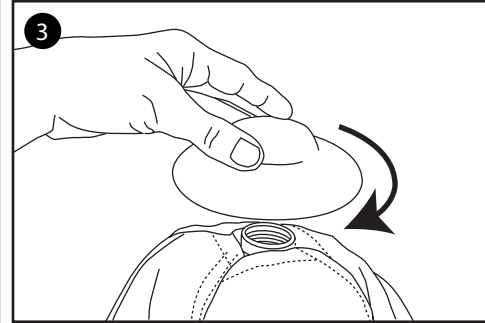
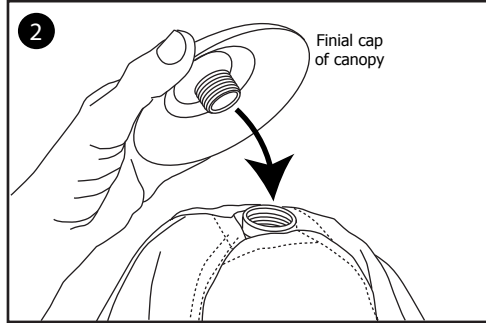
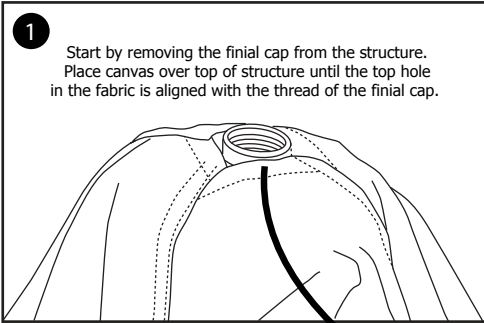

ATTACHING THE UMBRELLA CANOPY:

- 1) Using a step ladder, first remove the finial cap and then lift the fabric of the canopy up and over the canopy structure.
 - 2) Align the top hole with the finial cap thread and then place the finial cap down in position.
 - 3) Screw the finial cap firmly in place to secure the top of the canopy to the structure. Do not overtighten.
 - 4) Slide the canopy down over the structure as shown. Secure the two velcro surfaces all the way down to close the fabric over the sliding arm.
 - 5) Go to the top piece of fabric with the LOXX fastener.
 - 6) Using the LOXX key remove the washer from underneath the top layer of fabric's LOXX fastener.
 - 7) Align the two holes in the fabric at the base of where the two velcro surfaces meet.
 - 8) Push the LOXX fastener through both layers of fabric ensuring fabric won't interfere with the fastener.
 - 9) Apply washer to the underside joining both fabric layers together and then tighten with the LOXX key.
 - 10) To attach the canopy to the umbrella structure pull the top half of the newly fitted LOXX fastener up then place it onto the ball stud that is fitted to the base of the sliding arm, release to attach. You can then attach the canopy ends to the rib ends using the same process until all 8 corners are attached.
- Turn the crank clockwise to open the canopy. Adjust to preferred angle by squeezing the pistol grip and pushing the sliding arm mechanism up or down. Press down on foot pedal to freely rotate the umbrella 360°.

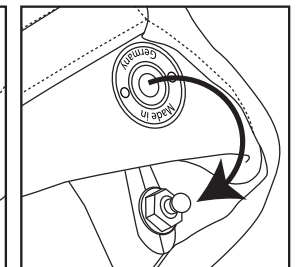
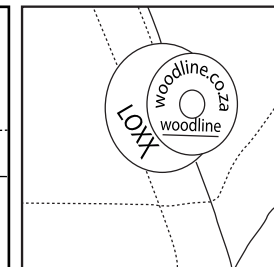

CANOPY FOLDING INSTRUCTIONS

1) In order to avoid the canopy fabric from being jammed between the frame components, it is important to pull the fabric out from the umbrella structure by putting a finger under the edge of the canopy and pulling the fabric outwards. Do this for all the panels and fold the panels over each other like you would do with a hand-held umbrella.

2) Tie the canopy strap tightly around the canopy as well as the mast in windy conditions to minimize any movement.

3) Using the supplied cover bag stick, place the cover bag over frame to protect the umbrella while it is not in use.

4) Always ensure your umbrella is in a totally dry condition before you close it and apply the cover bag.

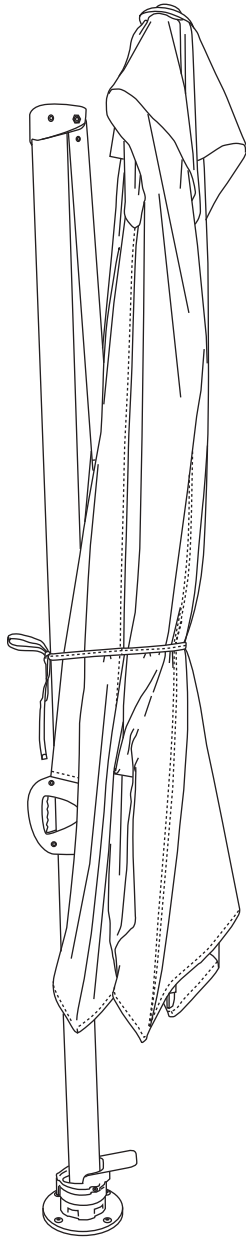

HOW TO FIT YOUR COVER BAG CORRECTLY

Cover Bag Stick

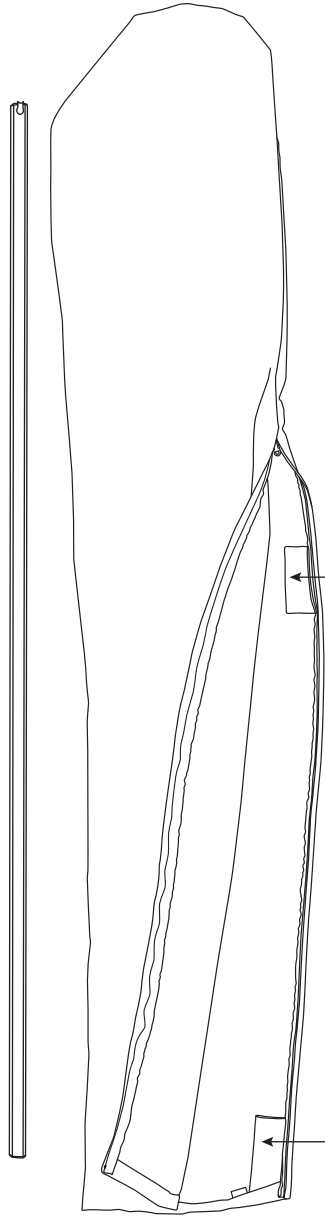

Lay out the cover bag flat on a table with the zip totally opened.

Stick Pouch 2

Stick Pouch 1

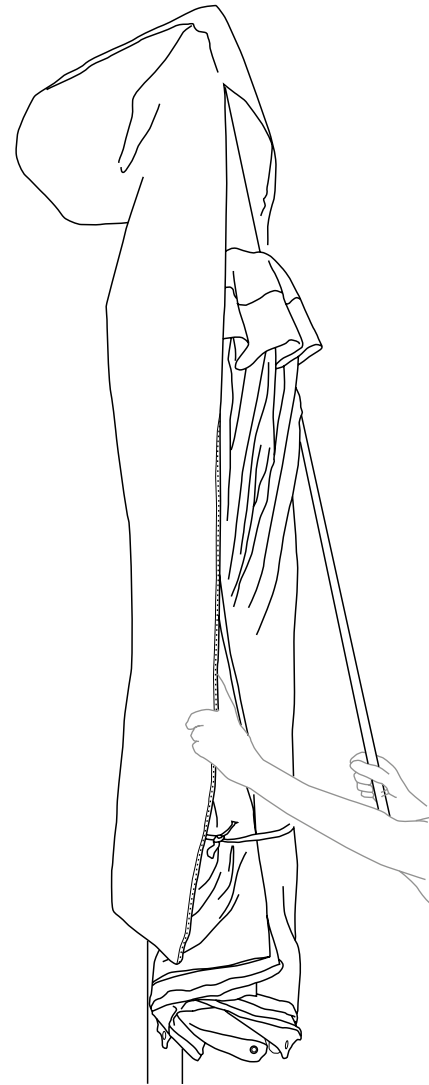

Insert the cover bag stick into the bag all the way to the top, lift up the cover bag vertically and place it gently up and over the top of your closed umbrella so that it covers both pole and umbrella.

Cover Bag Stick

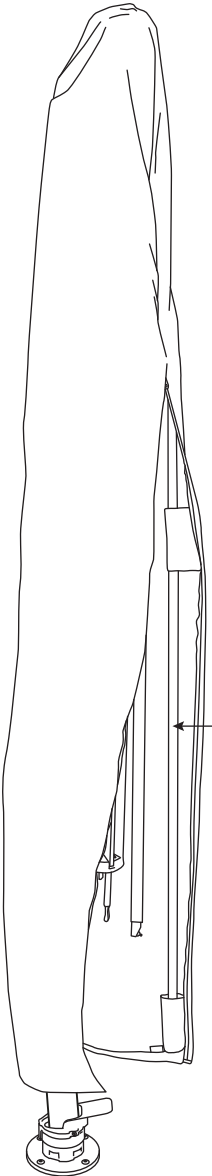

Lower it into position, the cover bag stick can now be placed into its two holder pouches for safekeeping. Then zip the bag closed completely.

woodline

shade solutions

PAVONE SIDE POST

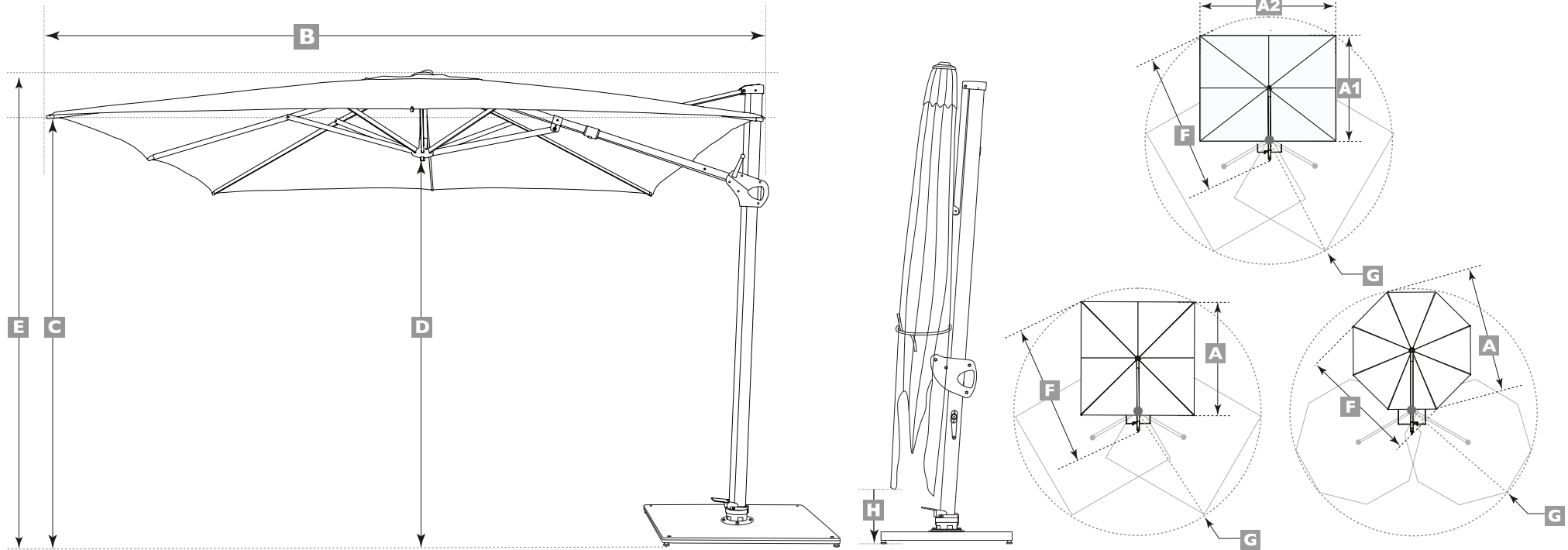

A Canopy size:

Round - size is measured from tip to tip through the center

Square - size is measured from tip to tip on one side

B Back of pulley to front of canopy

C Head clearance from arm tip

D Head clearance below hub

E Overall height

F Maximum distance between ends

G Rotation point to farthest arm tip

H Floor clearance from arm tip

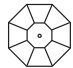
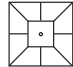
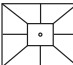
| model | shape | | A | B | C | D | E | F | G | H |
|--------|-----------------------|---|---------------------------|----------------|----------------|---------------|----------------|-----------------|----------------|----------------|
| R35 | Octagonal 8 ribs |  | 11'5" 3.5m | 11'7" 3.57m | 7'1" 2.17m | 6'6" 1.97m | 8'10" 2.70m | 11' 3.35m | 9'3" 2.81m | 3'1" 0.94m |
| S30 | Square 8 ribs |  | 10'0" 3.0m | 11' 3.35m | 6'11" 2.10m | 6'6" 1.97m | 8'10" 2.70m | 11' 3.63m | 9'3" 3.12m | 1'11" 0.60m |
| REC3X4 | Rectangular 8 ribs |  | 10' x 13'1" 3.0 x 4.0m | 12'5" 3.77m | 7'7" 2.31m | 6'5" 1.96m | 8'3" 2.5m | 13'11" 4.25m | 12'6" 3.80m | 10.2" 0.26m |

* This distance is measured from the pivot point to the farthest distance from this point on the umbrella. The distance defines the radius of the circle created as the umbrella rotates 360 degrees. * Vertical measurements taken from ground level, including base. All imperial measurements converted from metric and are rounded off to the nearest inch. For exact dimension refer to metric measurements.

CARE AND MAINTENANCE

Every **Woodline** umbrella is meticulously engineered to maximize not just their forms and functions, but also to make sure that they outlast even the harshest conditions. Each item is crafted from the finest marine grade weather-resistant materials, specifically selected for their ability to endure. Even though our umbrellas are built to last, the relentless and extreme nature of the outdoors dictates that proper care and maintenance will always extend the lifespan of any item.

FRAMES

Constructed from the finest quality aluminum, high grade stainless steel and durable and sustainable eucalyptus timber. Our frames have been tested in some of the world's most inhospitable environments and have only ever benefited from the appropriate application of caution and common sense in excessive wind conditions.

We advocate the use of our cover bags to prolong the life of the canopy frames and their covering fabrics. We recommend the closure and safe storage of any collapsible and removable components when the parasol is not in use or when excessive wind conditions are expected.

WOODEN COMPONENTS

We only use sustainable eucalyptus timber hand-picked for its strength, weather-resistance, and replenishment efficiency from the world's finest plantations and timber mills. Our wooden components are treated with marine varnish to fortify them for outdoor living. We recommend the periodic care of wooden components with a light sanding and reapplication of the varnish coating once a year to maintain the natural beauty of the wood.

FITTINGS

All fittings, nuts, bolts, pulleys and cleat components are made with high grade stainless steel and weatherproof nylon. Maintaining these fittings and components is imperative to the longevity and the proper operation of the shade system. A simple occasional fresh water rinsing will help keep them working well and looking good.

BASES

It is essential to pick the right base for your parasol, talk to our sales team to ensure that the parasol you choose has the appropriate base to keep it anchored properly.

sunbrella™ FABRICS

Our canopies and fabric covers are made from the most durable, colorfast, and dirt-repellent fabrics in the world. That said, proper care such as storage when not in use and cleaning from time to time will undoubtedly extend their lifespan.



UV RESISTANT



WATER/STAIN RESISTANT



BREATHABLE



MOLD RESISTANT



EASY CARE



PROTECTS FROM UV

WIND GUIDELINES

*The umbrella should always be closed during very windy conditions. As with all umbrellas, common sense wind guidelines prevail: if it is too windy to enjoy sitting outside under the umbrella, the umbrella structure should be lowered, folded and secured with the strap.

*When unattended, the umbrella structure should always be left in the closed position with the canopy folded properly, securely strapped with the cover bag placed over the umbrella.

*The umbrella structure must always be lowered, properly folded and strapped during heavy rains, thunderstorms, hail or any other severe weather conditions. Always anticipate to give time to properly fold the canopy, as during severe conditions if not folded properly, the fabric may become damaged.

*If very extreme weather conditions are anticipated, the umbrella structure should first be lowered, folded properly, strapped and placed in the cover bag. Then the entire umbrella structure should be removed from the base and stored in a clean, dry location.

www.woodlineshade.com | +1 848 266 0800