

42" Round Dining Table

IMPORTANT NOTE

Carefully remove all the parts from the carton and put them individually on a soft cloth to prevent scratches or other damages occurring to the wood parts.

We have taken great care in the design of this product and request that you carefully and strictly follow our assembly instructions to ensure a completed product as it was designed.

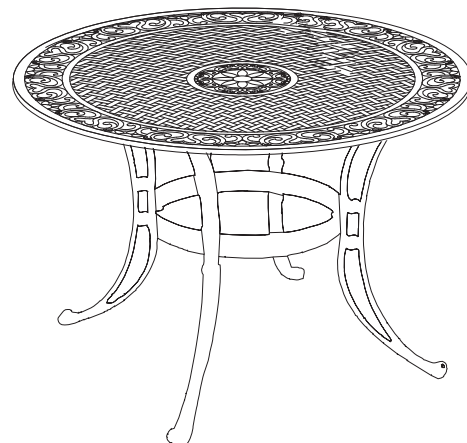

Part List

**A.
Top**
1 pc.

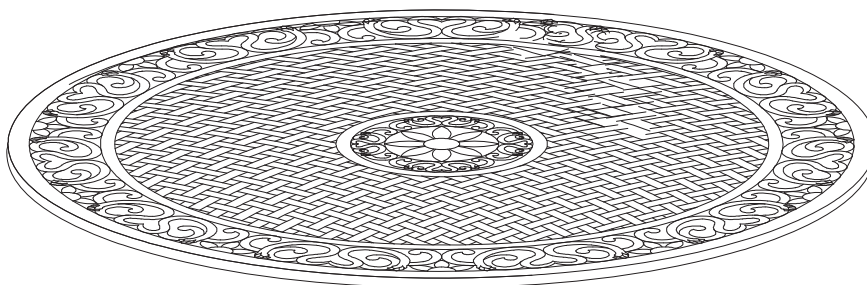

**B.
Leg**
4 pcs.

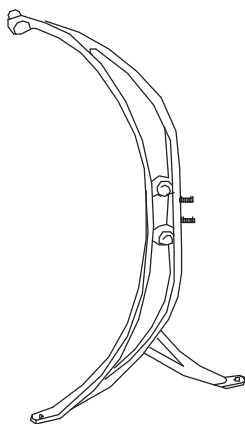

**C.
Stretcher**
1 pc.

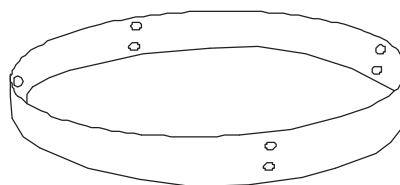

Hardware List



Key Wrench
1 pc.



Spring Washer
16 pcs.(+1 extra)



Nut
16 pcs.(+1 extra)



Bolt
8 pcs.(+1 extra)



Flat Washer
16 pcs.(+1 extra)

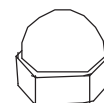

Nut Cap
16 pcs.(+1 extra)

Tools required for assembly : **Slotted** screwdriver

Tools recommended for assembly : Level

Assembly Instructions

IMPORTANT

- * Do not tighten up all the screws until each part is properly assembled.
- * You should keep Key Wrench in a safe place as you may need to tighten up the Head Cap Bolts in the future.
- * After assembly, item must be level to work properly. Use the included adjustable levelers to level.

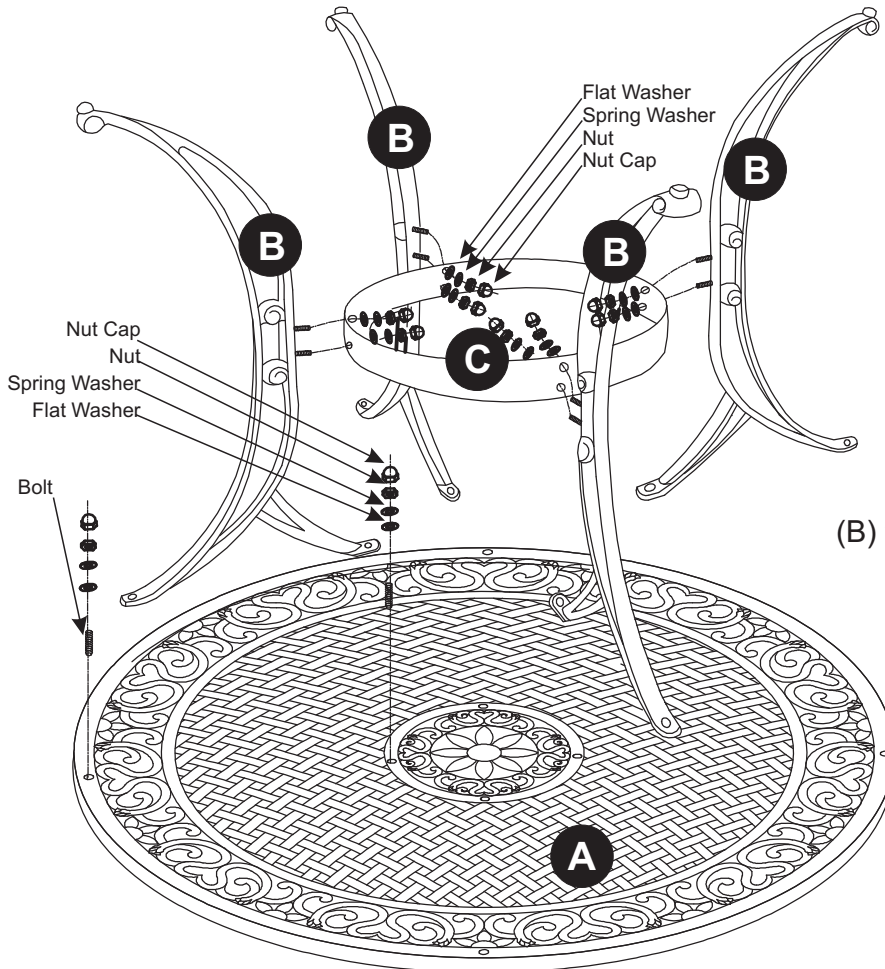

STEP 1

Place Top (A) upside down on a soft cloth.

Insert all Bolts into the pre-drilled holes of Top (A).

STEP 2

Attach 2 adjacent Legs (B) to Top (A) with Bolts, Flat Washers, Spring Washers, and Nuts. (See figure 1)

Tighten all Nuts, only half way, with Key Wrench.

STEP 3

Attach Stretcher (C) to unit with Flat Washers, Spring Washers and Nuts, tighten half way.

Attach 2X Legs (B) to unit with Flat Washers, Spring Washers and Nuts.

Tighten all Nuts completely with Key Wrench.

STEP 4

Cover all Nuts with Nut Caps.

Turn the table to its' upright position.

To level the table, adjust the adjustable levelers on the bottom of legs. (See figure 2)

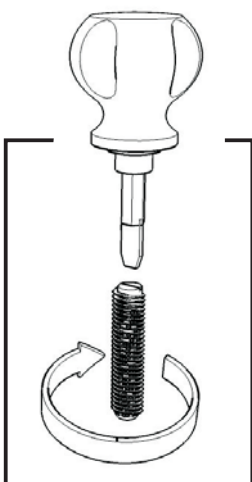

Figure 1

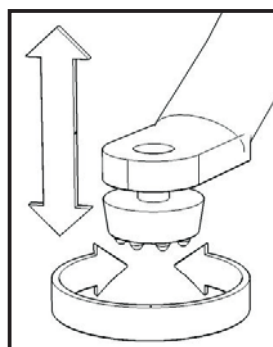

Figure 2