

# ASSEMBLY & INSTRUCTION MANUAL

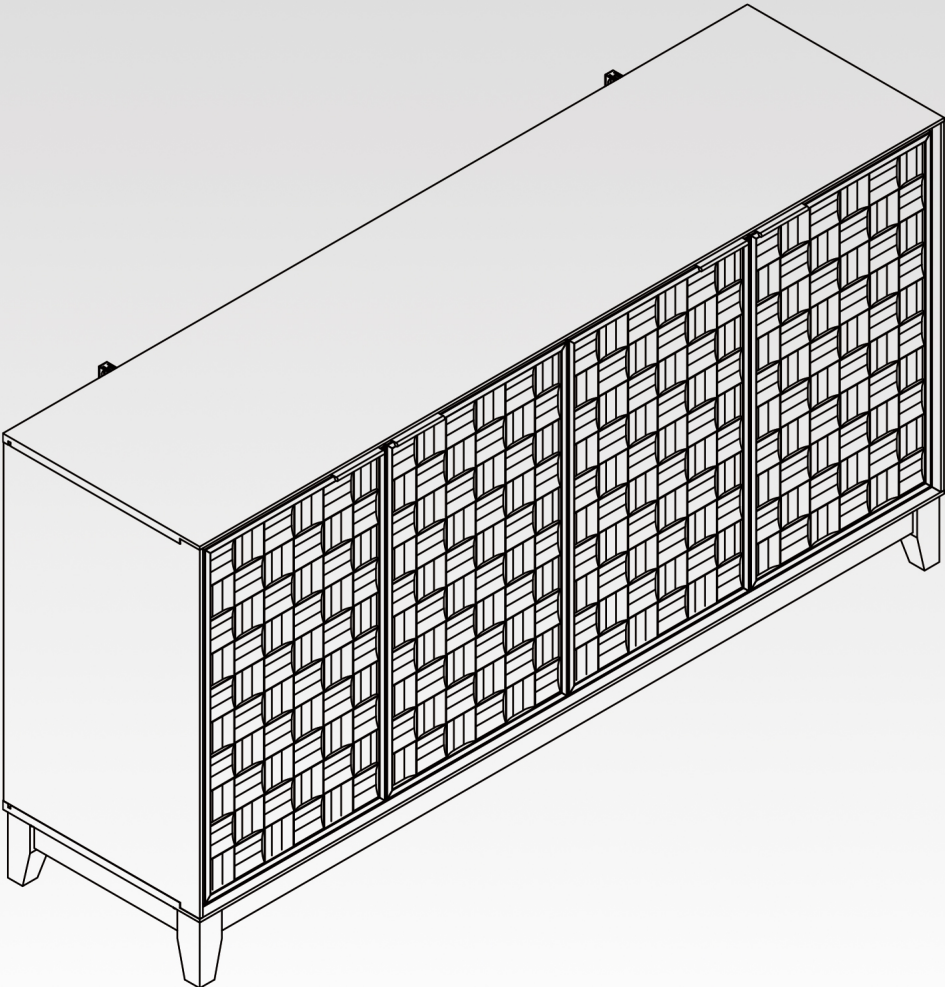

**STORAGE CABINET**

**TECHNICAL EXPLODED VIEW DIAGRAM**

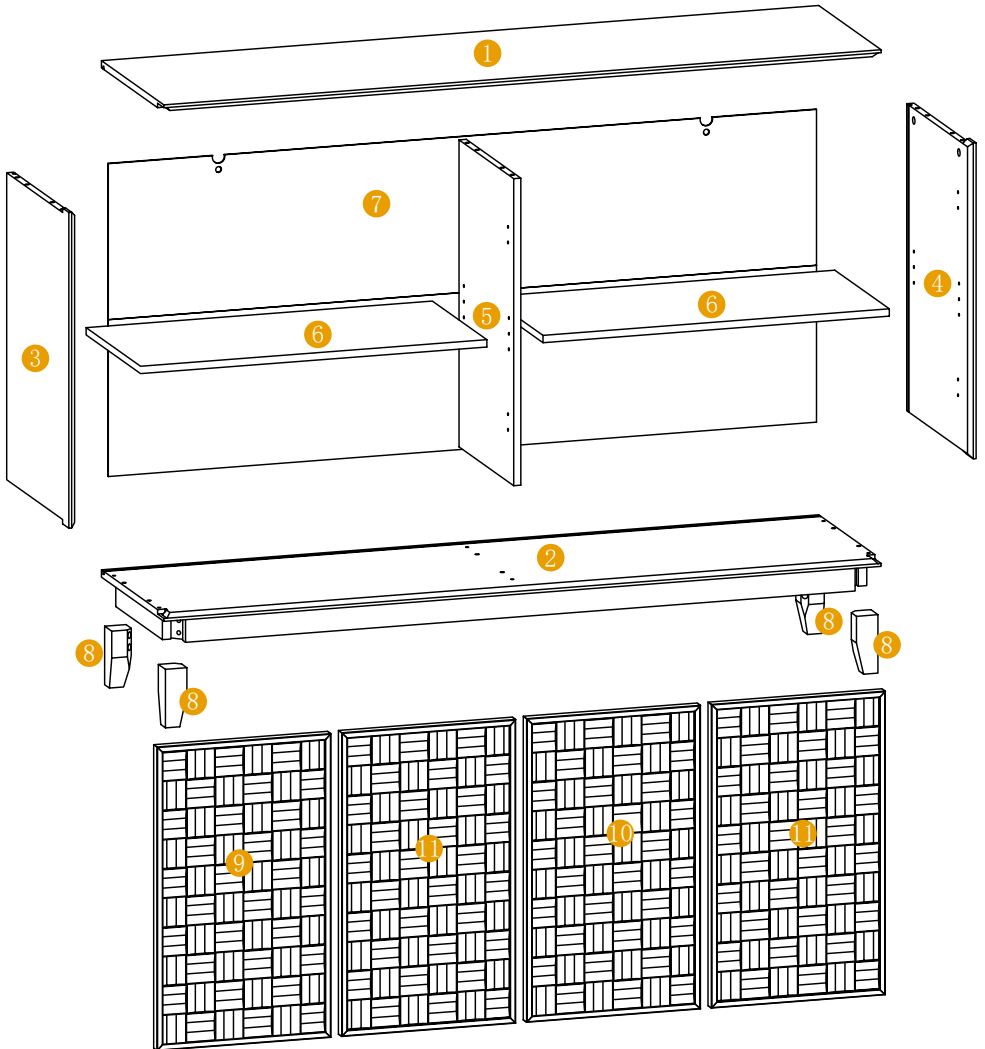

## PANEL COMPONENTS INVENTORY

PLEASE MAKE SURE ALL THE PARTS ARE INCLUDED.

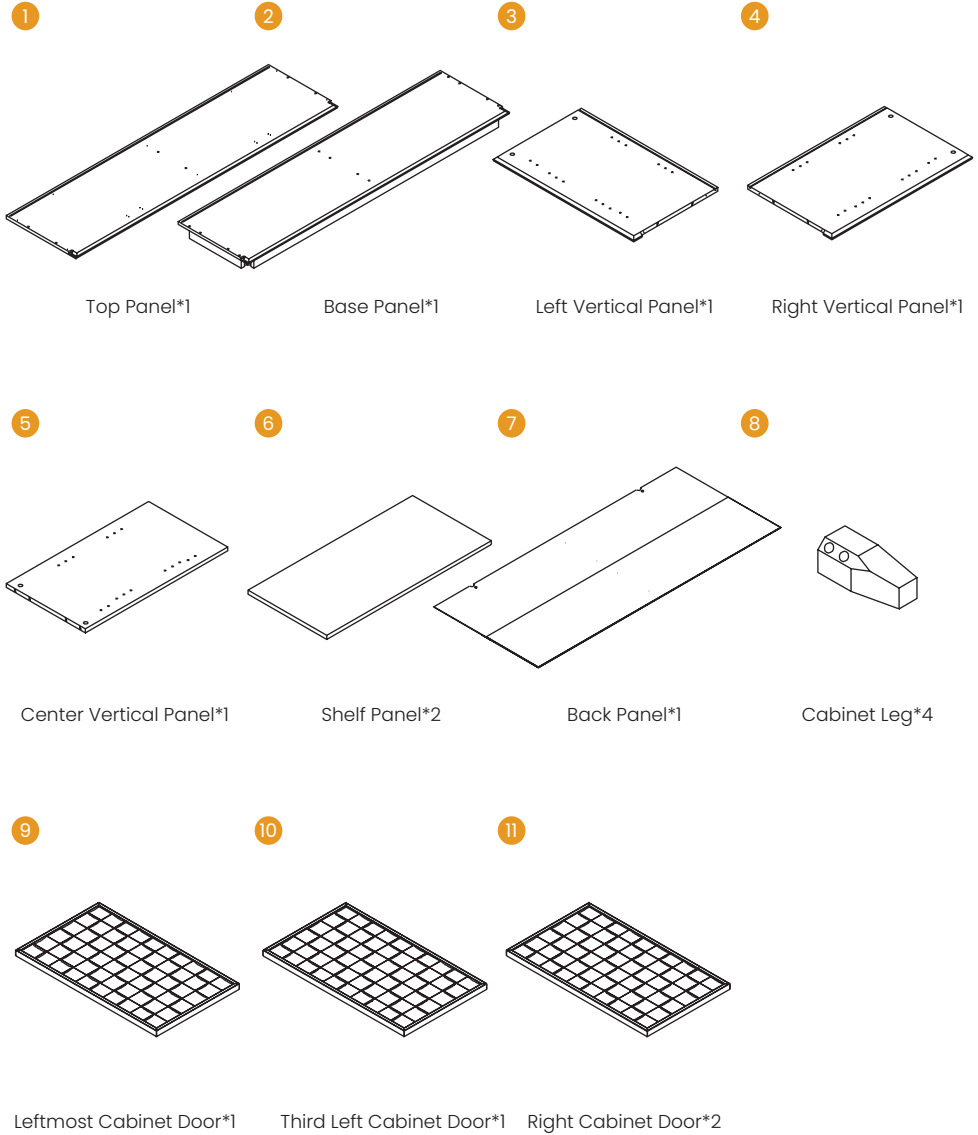

**HARDWARE COMPONENTS INVENTORY**

PLEASE MAKE SURE ALL THE PARTS ARE INCLUDED.

A

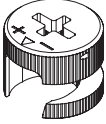

Large Hidden Cam\*6(+2)

B



Cam Screw \*6(+2)

C

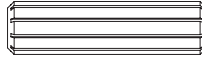

Wood Dowel  
ø8X30mm\*12(+2)

D



Flat Head Screw  
#6.5X1/2" \*8(+2)

E



Pan Head Screw  
#6\*1/2" \*8(+2)

F

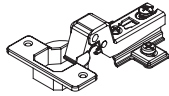

Large Bend Door Hinge\*4

G

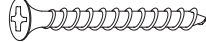

Flat Head Screw  
#10x1-1/2" \*6(+2)

H

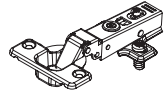

Mid Bend Door Hinge\*4

I

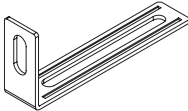

Wall Brackets\*2

J

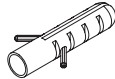

Expansion Wall Plug\*2

K

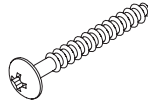

Pan Head Screw  
#10x1-1/2" \*2

L

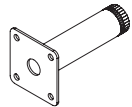

Support Foot\*1

M

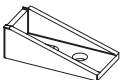

Bracket\*4

N



Hex Head Screw  
M6x55mm \*8(+2)

O



Flat Washers\*8(+2)

P



Spring Washers\*8(+2)

## HARDWARE COMPONENTS INVENTORY

PLEASE MAKE SURE ALL THE PARTS ARE INCLUDED.

Q

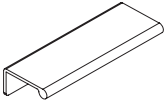

Pull\*4

R

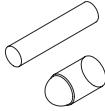

Rubber Sleeve Metal  
Pin\*8(+2)

S

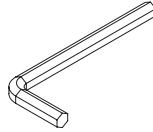

L-Wrench \*1

T

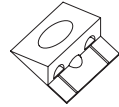

Back Connector\*8(+2)

U

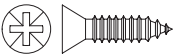

Back Flat Head Screw  
#6\*5/8" \*8(+2)

V



Pan Head Screw  
#10\*1/2" \*10(+2)

W

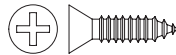

Flat Head Screw  
#8\*5/8" \*16(+3)

X

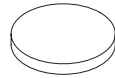

Felt Disc\*4

BEFORE YOU GET STARTED, A FEW POINTERS:



Having a friend to help makes  
assembly extra-easy



Mind the important safety information

**ASSEMBLY INSTRUCTIONS**

**Important:**

- 1. Before assembly, arrange all panel components and hardware fittings in sequential order and verify quantity counts.
- 2. If WOOD DOWEL joints exhibit loose fit, apply wood adhesive (customer-supplied) to enhance fastener bond strength.
- 3. Please install HIDDEN CAM and CAM SCREW according to the installation method shown in the diagram below.

Torsionally tighten CAM SCREW until threads are no longer visible

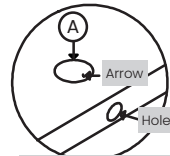
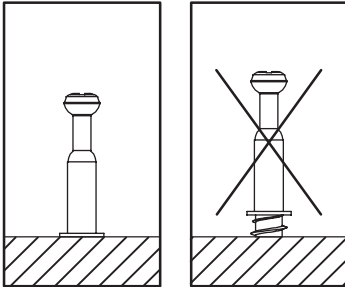

The arrow in the HIDDEN CAM must point toward the hole in the edge of the board.

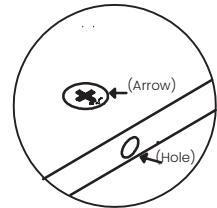
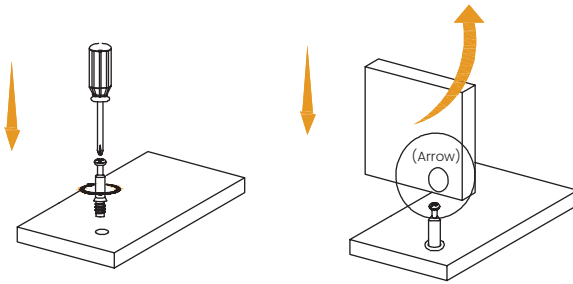

The arrow in the HIDDEN CAM must point toward the hole in the edge of the board

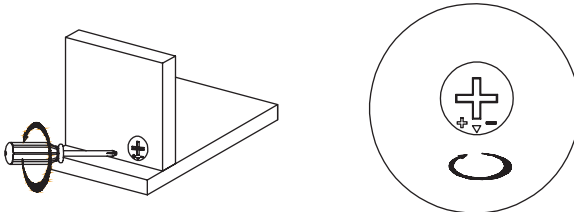

## ASSEMBLY INSTRUCTIONS

**STEP 1** Install Brackets (M) and Wall Brackets (I) on the Top Panel ①, then secure with Cam Screws (B).

Notes:

1. Align Bracket (M)'s long right-angle side with ①, with the short side facing the non-grooved end.
2. Orient Wall Bracket (I)'s short side toward the grooved end of Panel ①, with right-angle vertices flush with the panel edges.
3. Ensure Cam Screws (B) are not inserted into the Wood Dowel holes shown in the illustration.

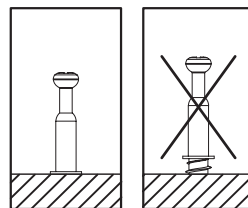
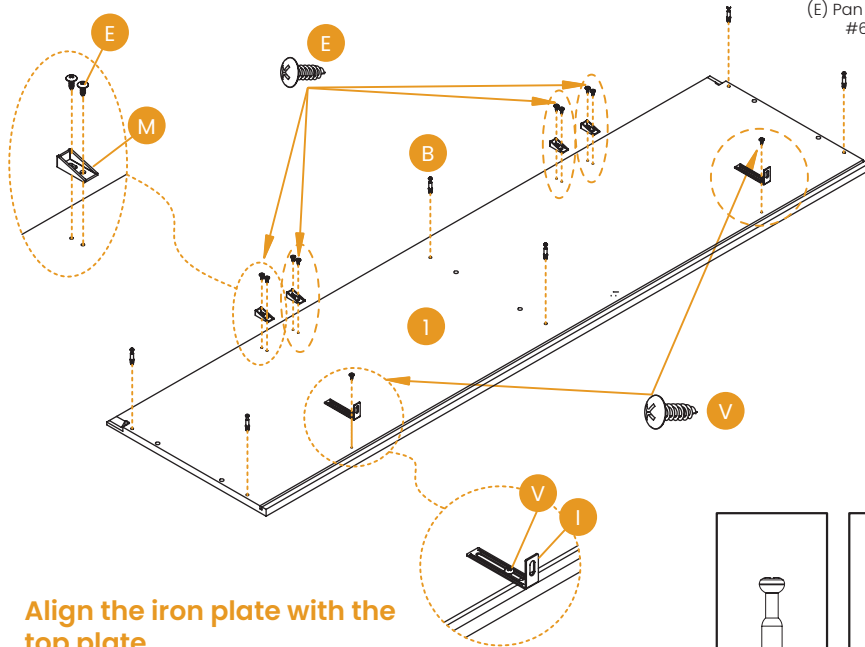
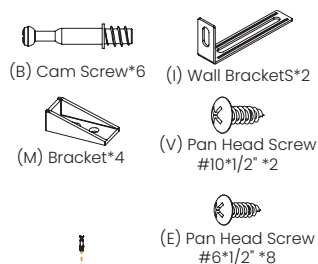

## ASSEMBLY INSTRUCTIONS

**STEP 2** Insert Wood Dowels (C) into both ends of the left Vertical Panel ③ and right Vertical Panel ④.

*Note: Avoid inserting Wood Dowels into cam adjustment holes.*



(C) Wood Dowel  
ø8X30mm\*8

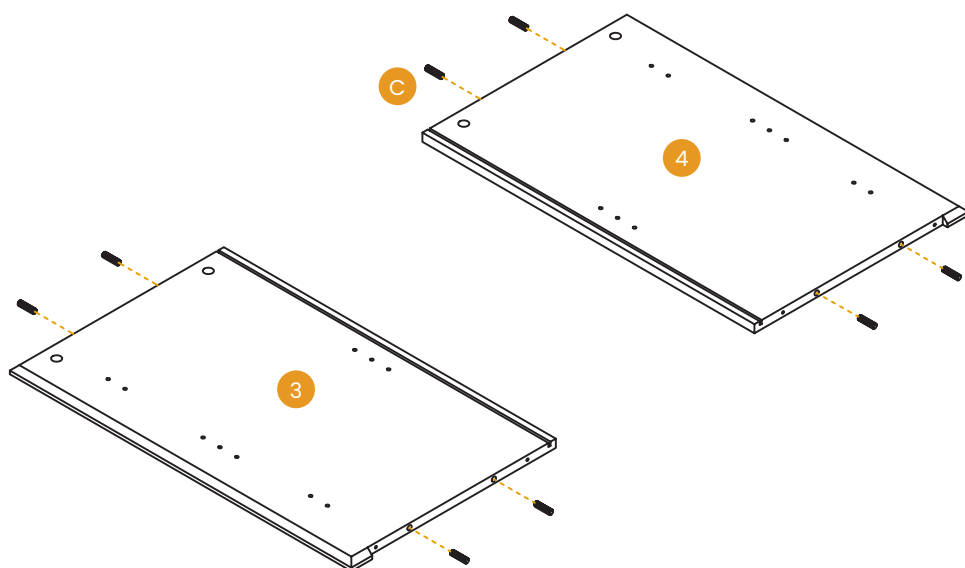

**ASSEMBLY INSTRUCTIONS**

**STEP 3** Install Wood Dowels into both ends of the middle Vertical Panel ⑤. Adhere Felt Discs (X) to ⑧ using the backing adhesive.

Note: Keep Wood Dowels clear of cam holes.



(C) Wood Dowel  
ø8X30mm\*4



(X) Felt Disc\*4

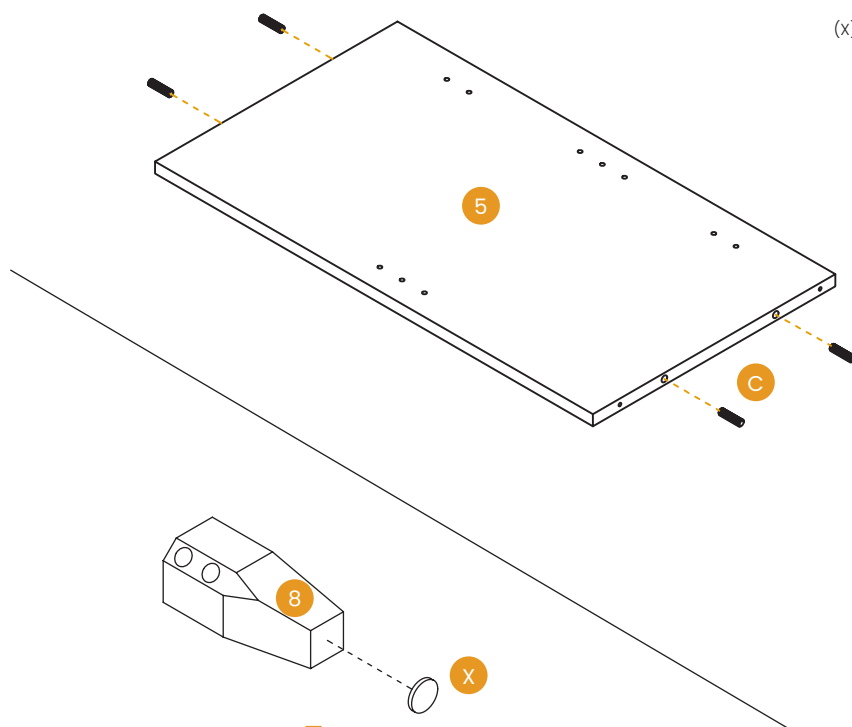

**X4**

**ASSEMBLY INSTRUCTIONS**

**STEP 4** Secure Panels ③ , ④ , and ⑤ to the ① using Large Hidden Cams (A) as illustrated.

Notes:

- 1.Align the grooves of Panels ③ and ④ with the grooves of Panel ① .
- 2.Orient the non-edge-banded side of Panel ⑤ toward the grooves of Panel ① .



(A) Large Hidden Cam\*6

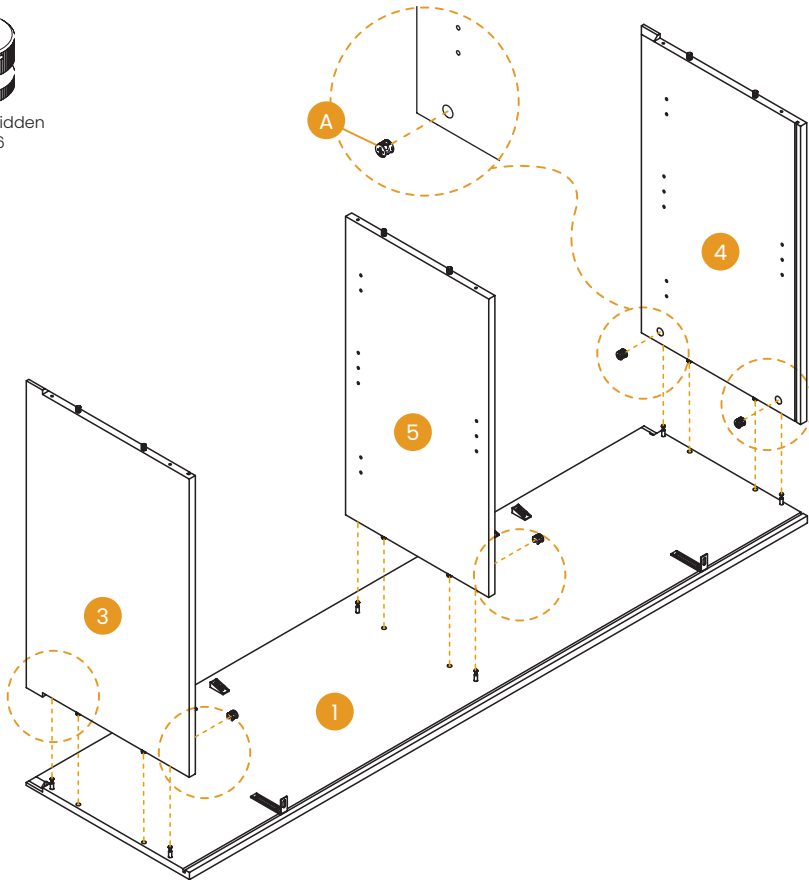

**ASSEMBLY INSTRUCTIONS**

**STEP 5** Unfold the ⑦ and insert it into the grooves.

Note: Install with the adhesive-taped side facing outward and the notched edge facing downward.

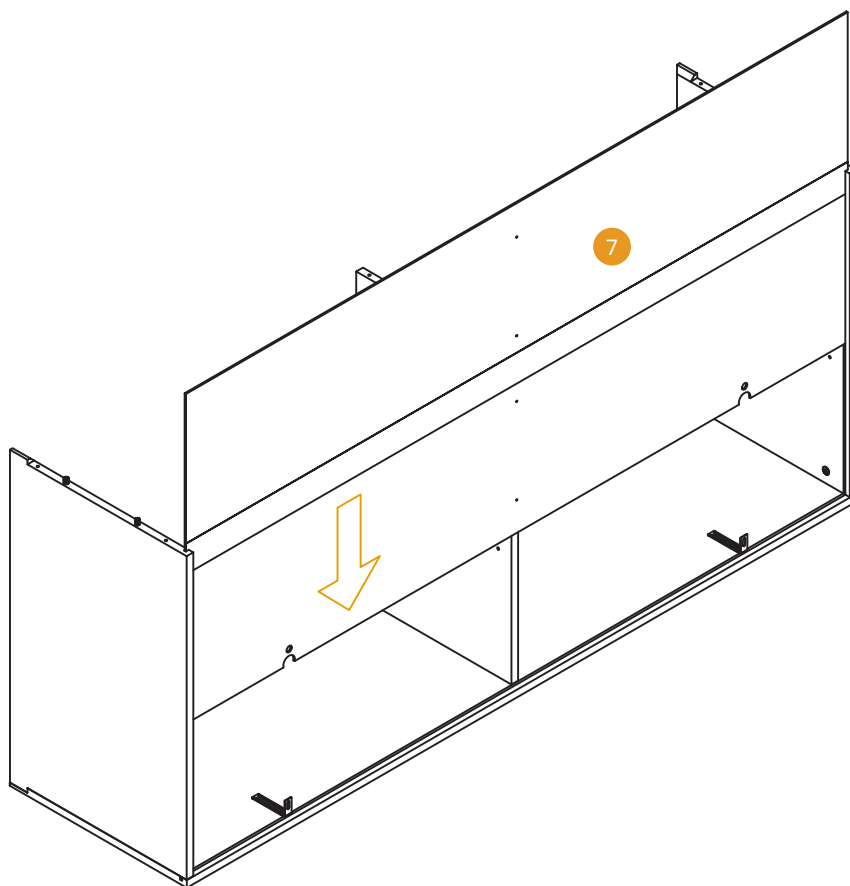

**ASSEMBLY INSTRUCTIONS**

**STEP 6** Position ② onto the assembled unit.

Note: Ensure the grooves of Panel ② engage with the Back Panel ⑦.

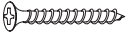
  
(G) Flat Head Screw  
#10x1-1/2" #6

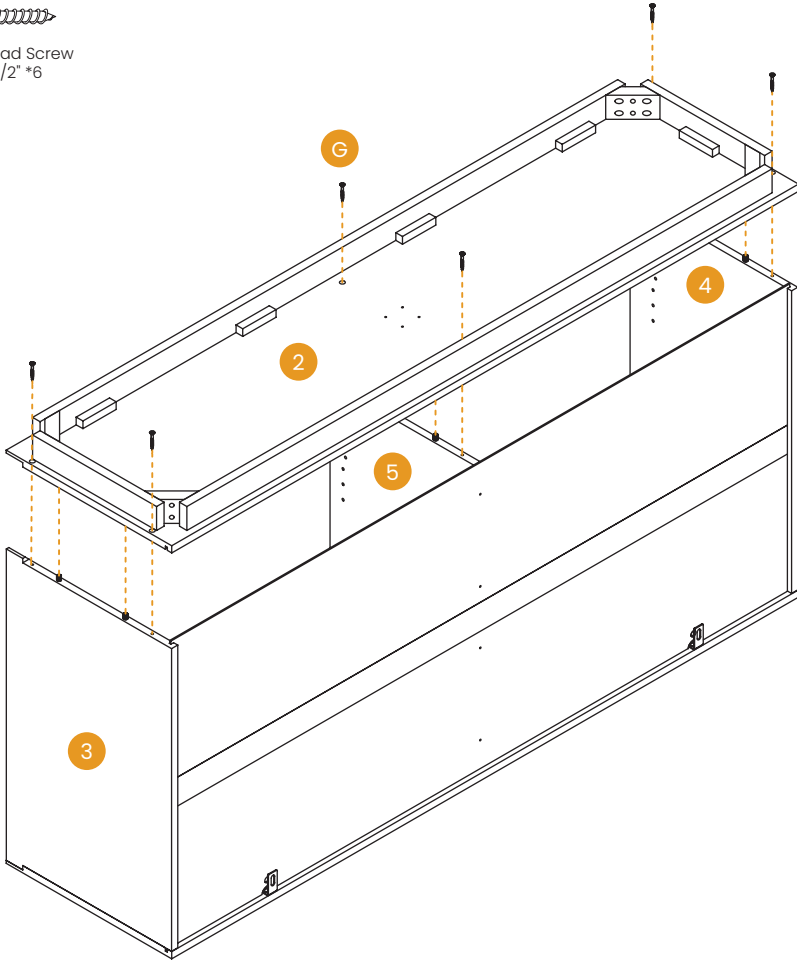

**ASSEMBLY INSTRUCTIONS**

**STEP 7** Install the Support Foot (L), then attach the four ⑧.

Note: Adjust the height using the Support Foot's threaded screws.

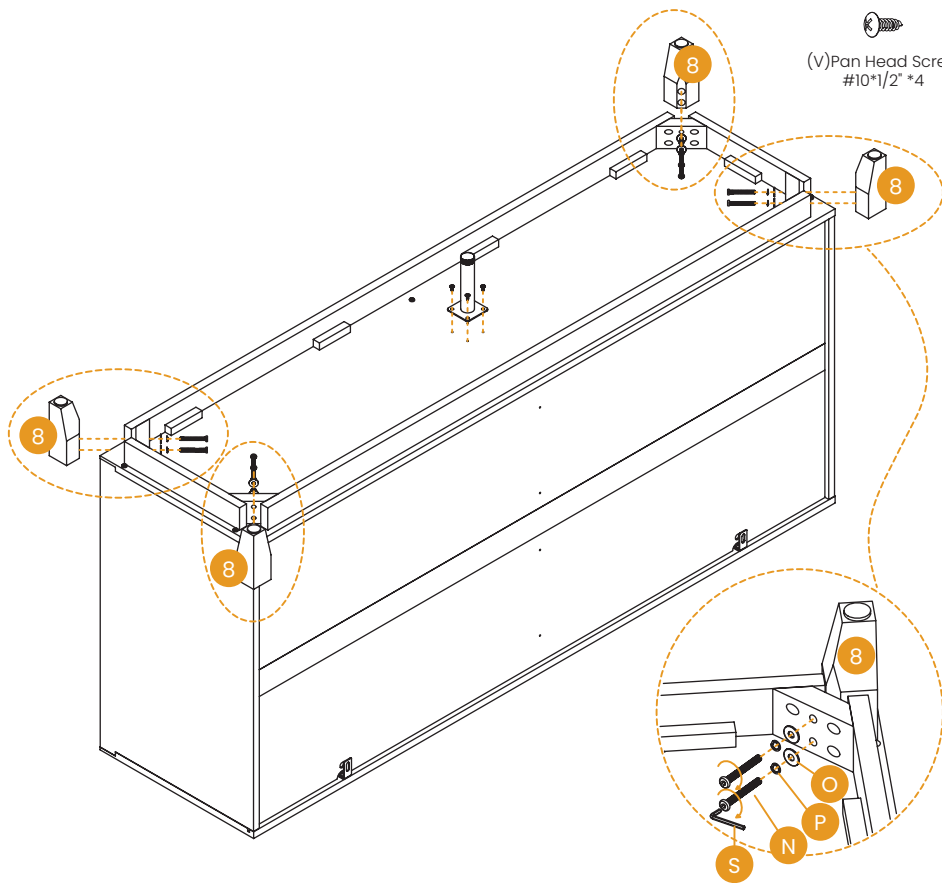
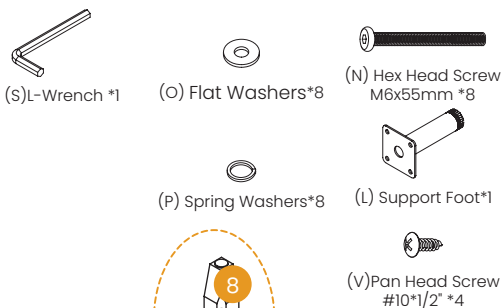

**ASSEMBLY INSTRUCTIONS**

**STEP 8** Insert Rubber-Sleeved Metal Pins (R) into the vertical panels, then position ⑥.

Notes:

- 1. Use four co-planar pins per shelf.
- 2. Avoid hinge mounting holes.
- 3. Orient the edge-banded side outward.

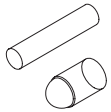

(R) Rubber Sleeve  
Metal Pin\*8

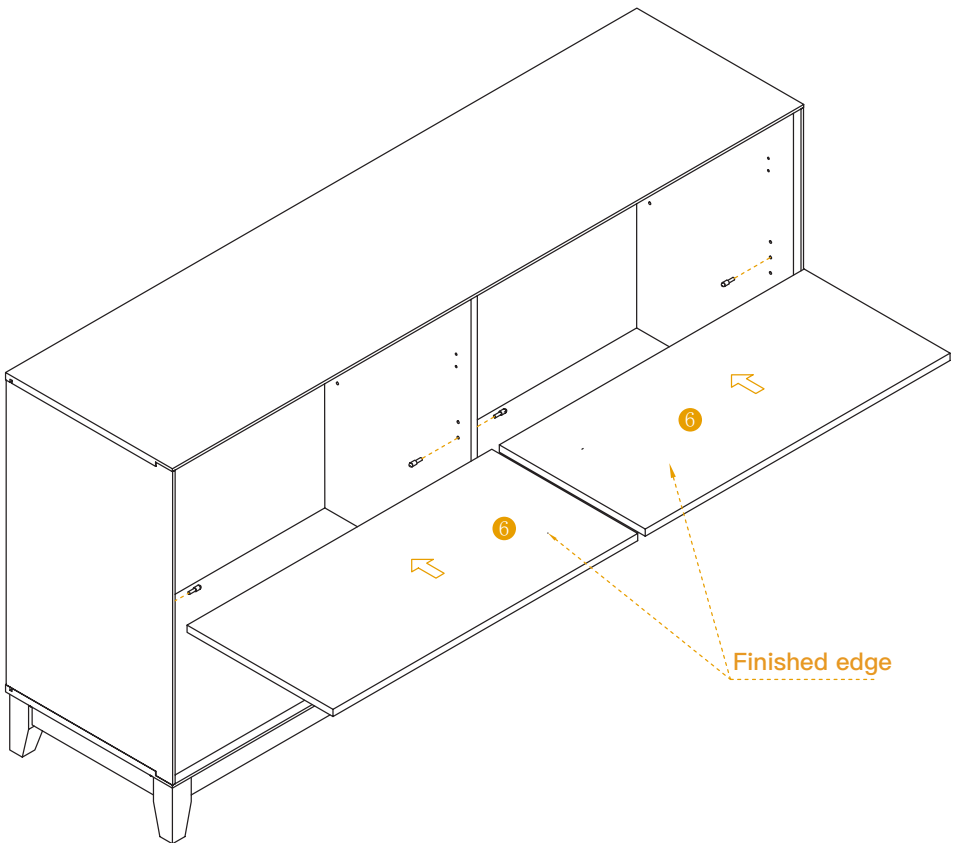
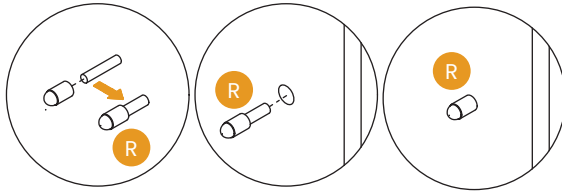

**DIAGRAMM ZUR POSITION DER SCHARNIER-TÜR**

Installation reminder:

Door positions, quantities, and hinge types must match. Please follow the diagram for correct assembly.

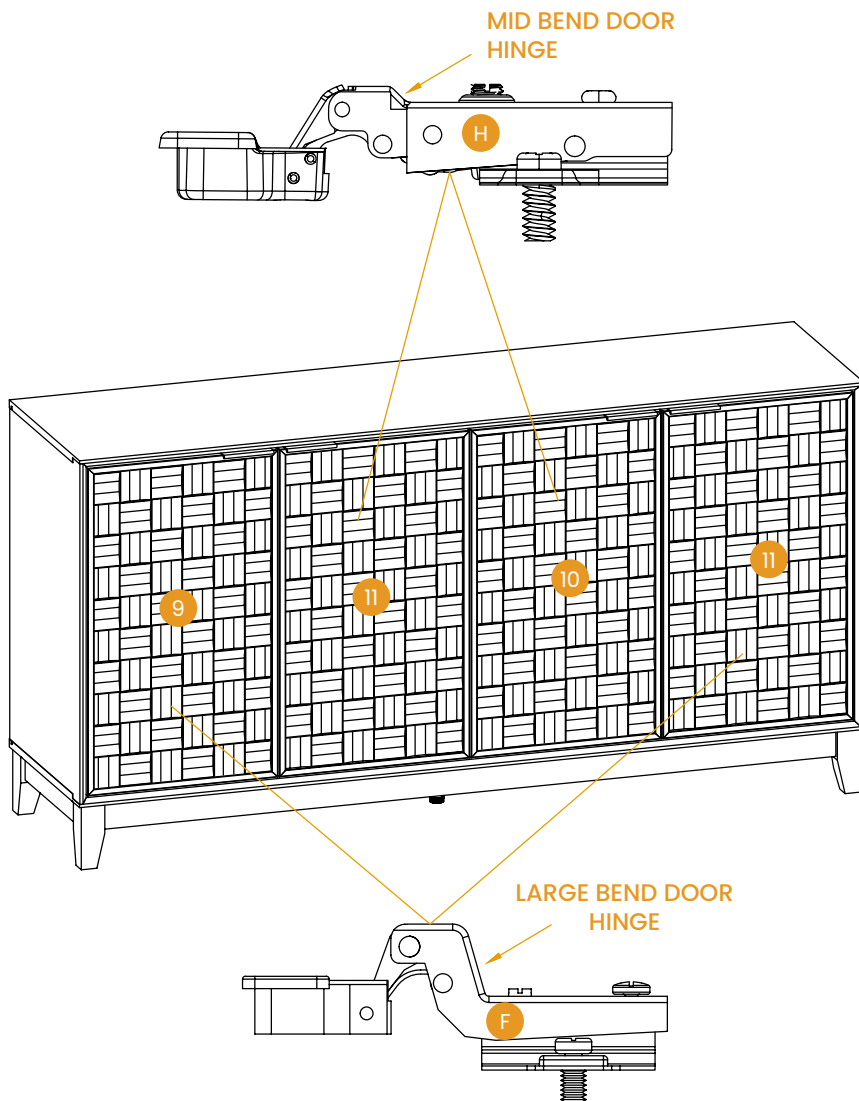

# ASSEMBLY INSTRUCTIONS

## STEP 9 Match hinges and doors according to the specification:

- (1) Leftmost door: Panel ⑨ with F-Type Hinge.
- (2) Second left door: Panel ⑪ with H-Type Hinge.
- (3) Third left door: Panel ⑩ with H-Type Hinge.
- (4) Rightmost door: Panel ⑪ with F-Type Hinge.

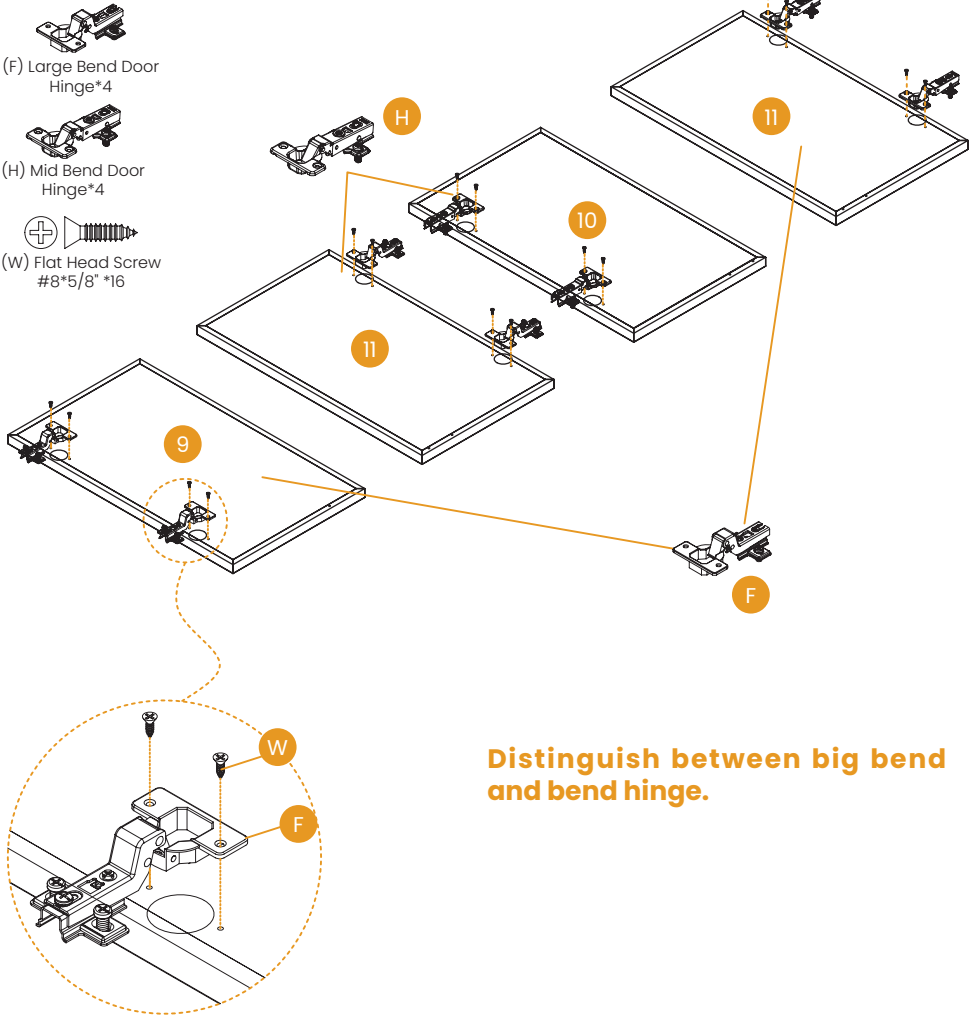

**Distinguish between big bend and bend hinge.**

## ASSEMBLY INSTRUCTIONS

**STEP 10** Install the leftmost door (Panel ⑨ with F-Type Hinge) and the rightmost door (Panel ⑪ with F-Type Hinge), then attach the Handles (Q).

Notes:

1. Tighten each screw to approximately 30% engagement.

2. Progress sequentially to 50%, then 80%, and finally full tightening.

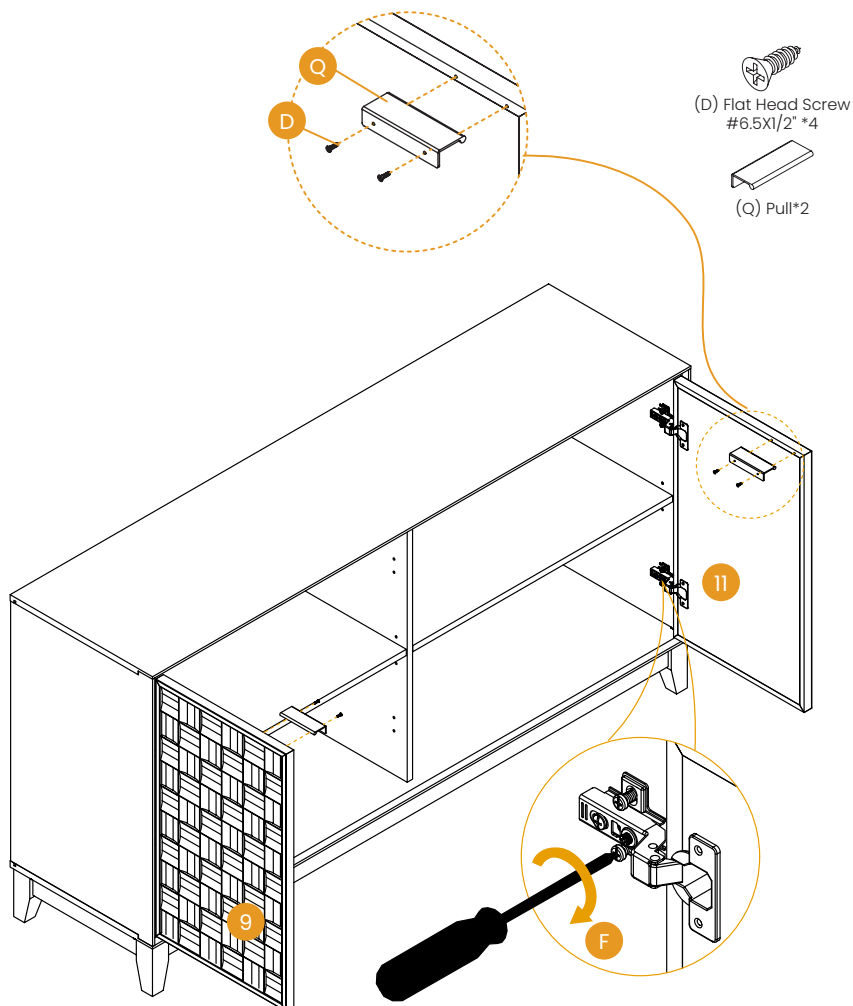

## ASSEMBLY INSTRUCTIONS

**STEP 11** Install the leftmost door (Panel ⑨ with F-Type Hinge) and the rightmost door (Panel ⑪ with F-Type Hinge), then attach the Handles (Q).

Notes:

1. Tighten each screw to approximately 30% engagement.
2. Progress sequentially to 50%, then 80%, and finally full tightening.

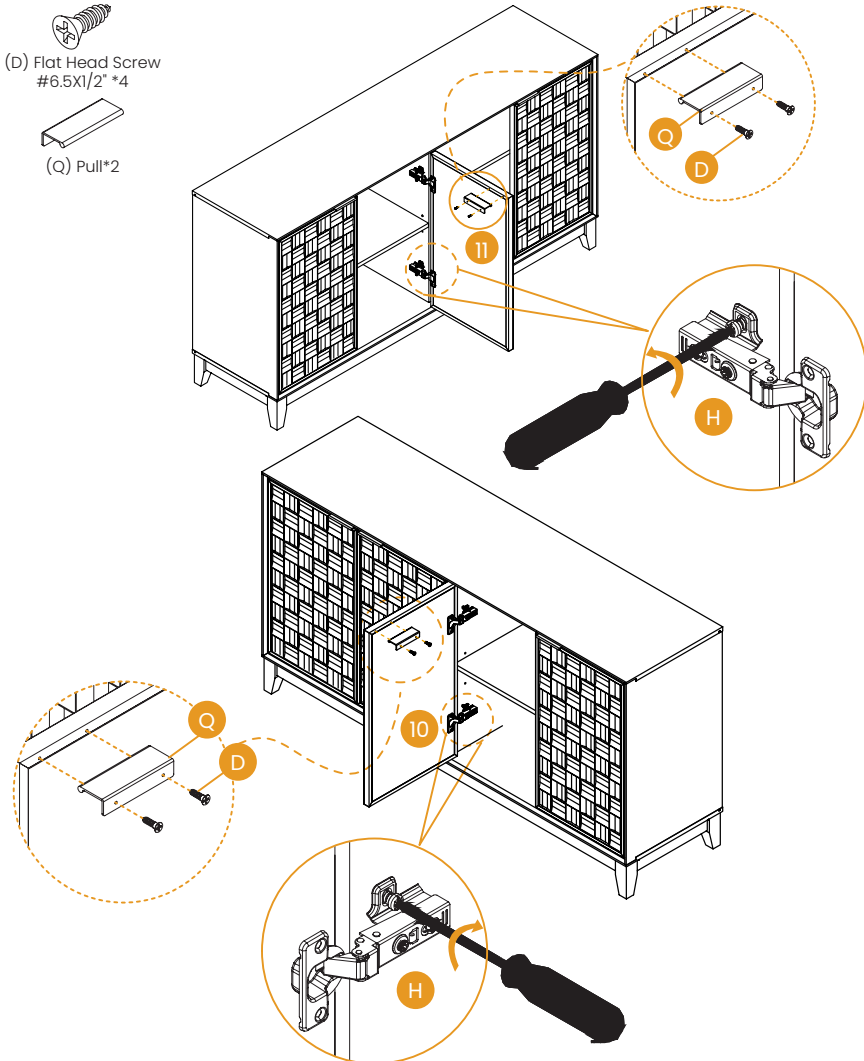

## ASSEMBLY INSTRUCTIONS(HOW TO ADJUST THE HINGE)

### TO ADJUST YOUR DOORS TO MAKE THE GAPS MORE EVEN (OPTIONAL).

#### STEP 1

Open the door.

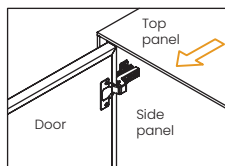

#### STEP 2

Adjust the door panel to be flush with side panel and top panel edge.

Loosen the screw indicated a little, adjust the hinge to right position (see step 2a & 2b), then tighten the screw.

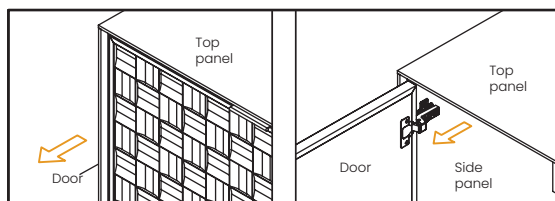
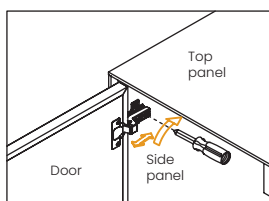

**STEP 2a** MOVE DOOR OUT

Pull the hinge forward a little.

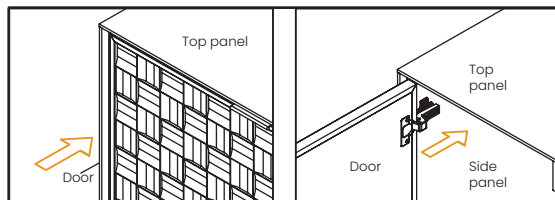

**STEP 2b** MOVE DOOR IN

Push the hinge back a little.

#### STEP 3

Adjust the gap between door panel and side panel.

Loosen or tighten the screw indicated a little to adjust the gap between the door panels, adjust the hinge to right position (see step 3a & 3b).

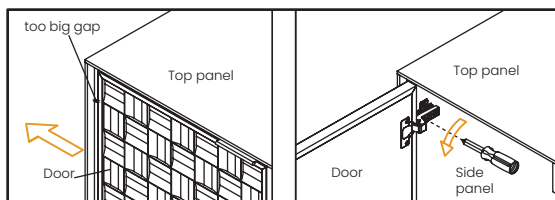
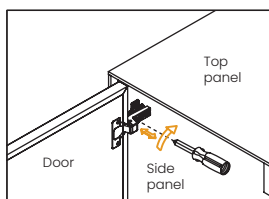

**STEP 3a** MOVE DOOR LEFT

Turn the screw clockwise a little as shown to make the gap small.

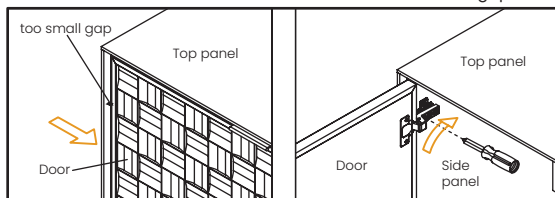

**STEP 3b** MOVE DOOR RIGHT

Turn the screw counterclockwise a little as shown to make the gap big.

**ASSEMBLY INSTRUCTIONS**

**STEP 12** Secure with four Pan Head Screws (V) and install eight Back Connectors (T).  
*Note: Engage the Back Connectors into the slots of the Back Panel.*



(T) Back Connector\*8

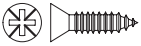

(U) Back Flat Head Screw #6\*5/8" \*8



(V) Pan Head Screw #10\*1/2" \*4

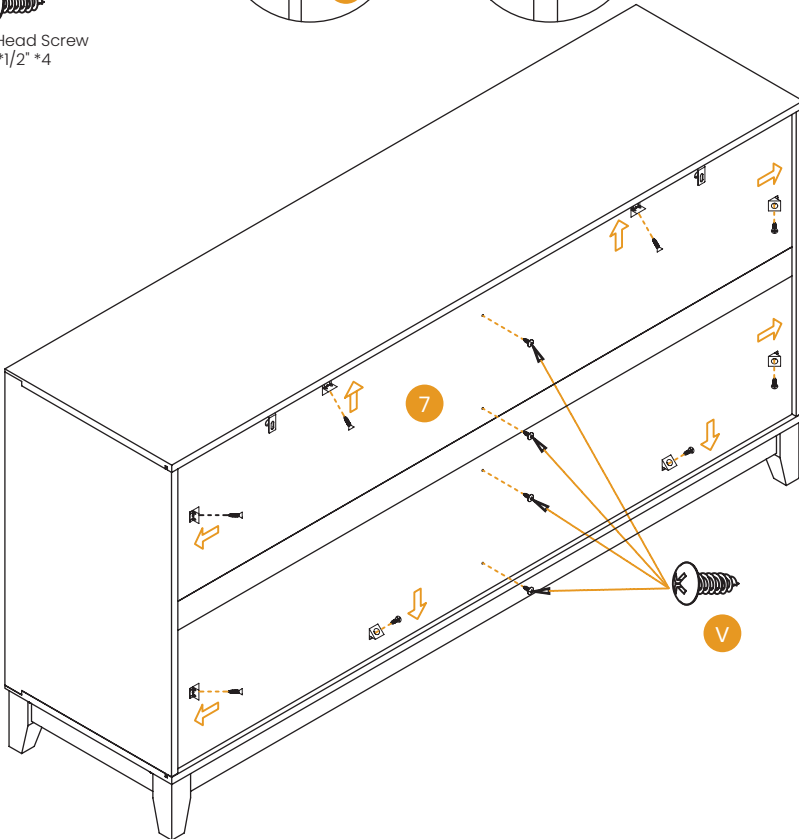
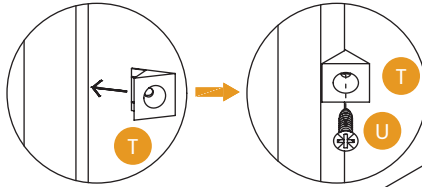

**ASSEMBLY INSTRUCTIONS****STEP 13** Wall-mounting procedure:

1. Open all doors.
2. Remove the Rubber-Sleeved Metal Pins (R).
3. Extract the shelves.
4. Secure the cabinet to the wall anchors.

## Shelf height adjustment:

Repeat steps 1-3 from the wall-mounting procedure to reposition the pins.

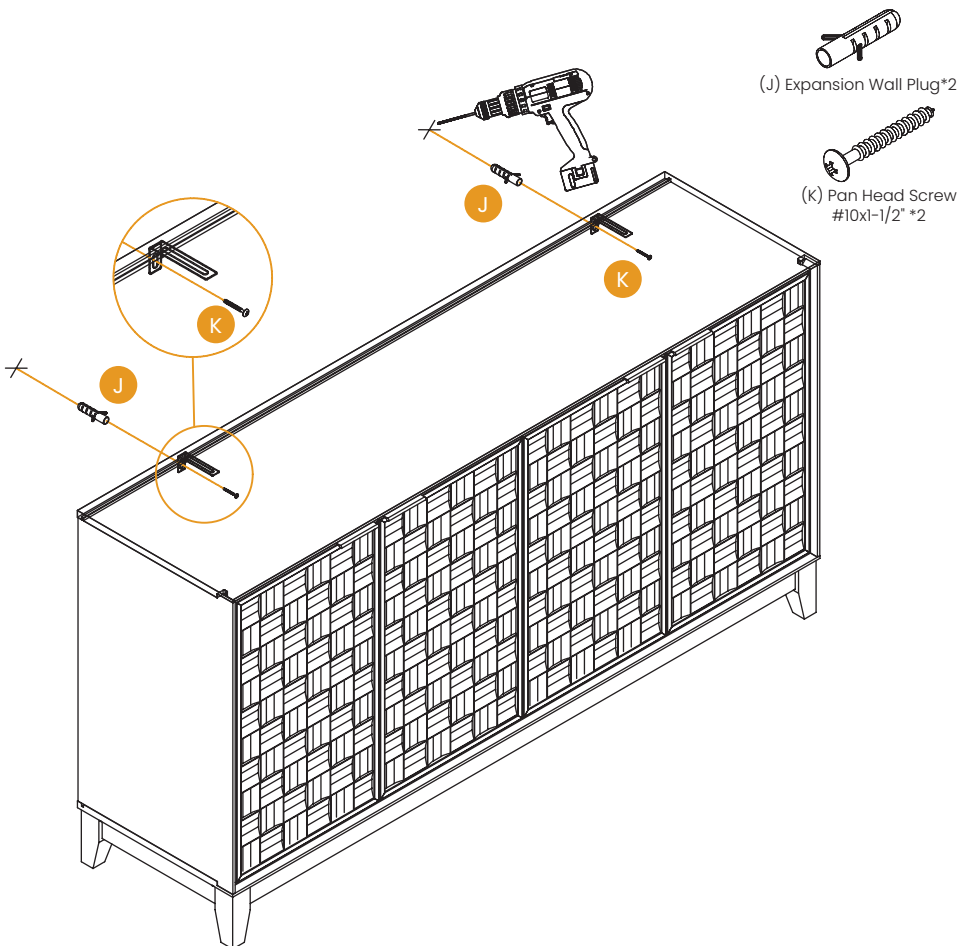

## LIMITED WARRANTY

We promise to repair or replace any product that is found to be defective in material or workmanship within one year from the date of original purchase, as long as you, the original purchaser, still own it. This is your sole and exclusive remedy under this warranty, subject to the provisions outlined below.

## EXCLUSIONS

This warranty does not apply to, and no other warranty applies to:

- Normal wear and tear, which is to be expected over the course of ownership.
- Misuse, abuse, or excessive use of the product.
- Modifications or attachments to the product that are not approved.
- Products that were not installed, used, or maintained in accordance with the product instructions and warnings.
- Products used for rental purposes or unauthorized retail activities.

## RETURN POLICY

We offer a 30-day return policy, meaning that all products purchased through this website may be returned to us within that timeframe. You must contact us within 30 days of receiving the product(s), and they must be returned to us without any undue delays.

## CONDITIONS:

- Returned products must be in the same condition as received and returned in their original packaging.
- If the product is not faulty (i.e., if you change your mind or are unhappy with the product for another reason), you are responsible for the cost of return shipping. You must ensure the package arrives safely to us, so we recommend using a courier service that offers tracking.
- If the product is faulty when received, please contact us, and we will assist you with the return, covering the shipping costs in this case.

## LIMITED WARRANTY

- We reserve the right to offer partial refunds for returned products that are not in unused condition, are damaged, or have missing parts not due to our error.

## HOW RETURNS WORK

To request a return, please attach a copy of your invoice as proof of purchase, along with the reason for the return.

We will provide the return address for the product as soon as possible. Once the returned product is received and inspected, we will provide a specific resolution.

If the return is approved, the refund amount will be automatically credited to your original payment method.

## MAINTENANCE INSTRUCTIONS



Dust and clean up spills immediately using a clean, non-colored, lint-free cloth.



For indoor use only. Do not place the furniture outside.



Do not place hot items directly on the furniture surface without using a protective barrier.



Do not place furniture near heating or cooling vents (keep at least 3 feet away)



Do not place furniture in direct sunlight.