

Shower Head Combo

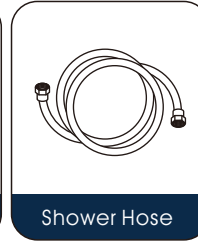

Inclusive Parts:

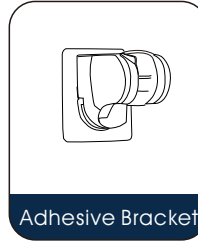
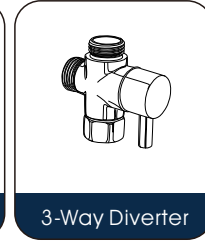
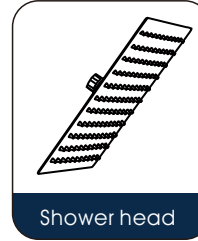

⚠ ATTENTION:

- *Using teflon tape to wrap around male pipe thread adapters to allow for a tighter connection. (Teflon tape overlapping about half the tape width, wrap to end of threads but not beyond to avoid causing obstruction.)
- *Do not force to screw into the shower head when you install otherwise, it will damage the thread of the shower head and cause leakage.
- *If fitting is removed simply replace tape.

⚠ IMPORTANT:

- *Please make sure to connect the hex nut to the 3-way diverter, and the conical nut to the hand shower. To avoid water leakage after installation.
- *Please dry your wall completely before you install the adhesive bracket, and leave the adhesive bracket on the wall for 24 hours without putting the shower head on it.

Handheld Shower Head Connector Warm Tips:



PRODUCT DRAWING

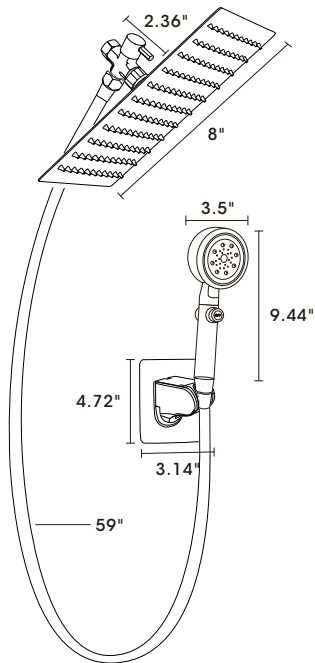

Other configuration shower

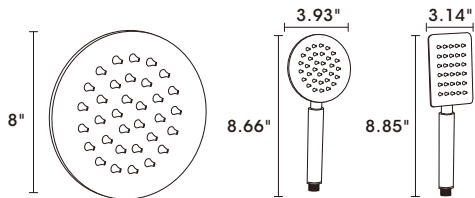

Before installation

Please check whether the accessories are complete. If there is any missing, contact us at the first time. Please feel free to contact us if you have any questions about the product and the installation.

Email : service24houronline@gmail.com

Rainfall Shower Head Installation Instructions:

1 Removed old shower head.

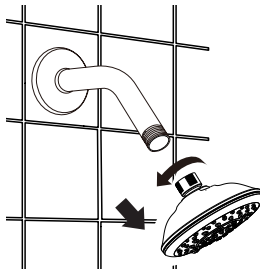

2 Make sure the rubber washer preset in free spinning nut, connect 3-way diverter to shower arm.

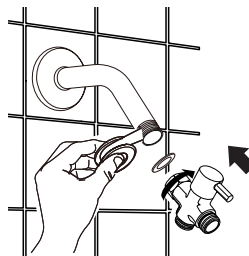

3 Tighten free spinning nut clockwise with wrench (Prevent scratch with cloth)

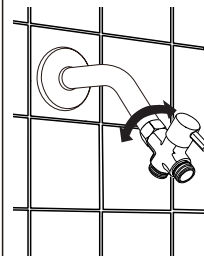

4 Make sure washer on shower head and connect it to 3-way diverter clockwise with wrench (Prevent scratch with cloth)

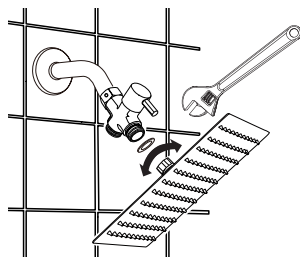

5 Make sure the washers are on both ends of the hose. Hex Nut into the 3-way diverter and conical Nut into the handheld shower.

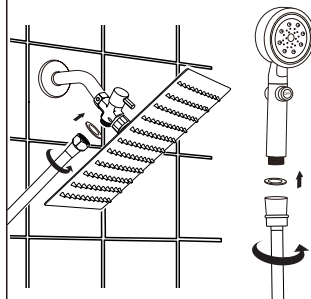

6 Clean and dry the wall, remove the self-adhesive protective film, stick the bracket at a suitable height and press it firmly.



Suggested waiting for 24 hours to make it more stable and reliable.

