

KING BED

(13 PCS LVL SLATS)

Read these instructions carefully. See hardware and furniture part list for guidance. Be sure all part is complete, before you assemble. Place all wooden furniture part on a clean and flat soft surface to prevent from being scratched. Follow the figure to start assembling.

CAUTION:

1. Do not FULLY-TIGHTEN the nut or bolt until all nut or nut bolt is ready to assembled.
2. Do not OVER-TIGHTEN the nut or nut bolt to avoid causing damages to the thread.
3. Keep all hardware part out of reach of children.

PART LIST

NO	DESCRIPTION	QTY
1a	HEADBOARD (UPPER)	1PC
1b	HEADBOARD (BOTTOM)	1PC
2	FOOTBOARD	1PC
3	SIDE RAIL	2PCS
4	CENTRE RAIL	2PCS
5	SUPPORT LEG	6PCS
6	SLAT	13PCS
7	HEADBOARD LEG	2PCS
8	FOOTBOARD LEG	2PCS

HARDWARE LIST

NO	DESCRIPTION	QTY
A	JCBB M8 X 40MM	16PCS
B	JCBB M8 X 100MM	6PCS
C	JCBC M6 X 35MM	6PCS
D	SPRING WASHER 5/16"	28PCS
E	FLAT WASHER 5/16"	22PCS
F	FLAT WASHER 1/4"	6PCS
G	CSK M4 X 30MM	46PCS
H	ALLEN KEY M4	1PC
I	ALLEN KEY M5 with ball	1PC

STEP 1

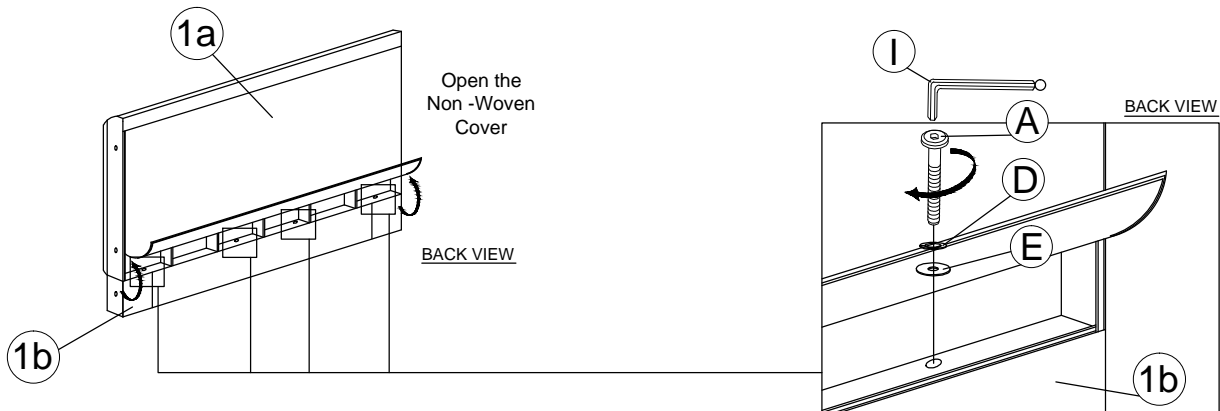

STEP 2

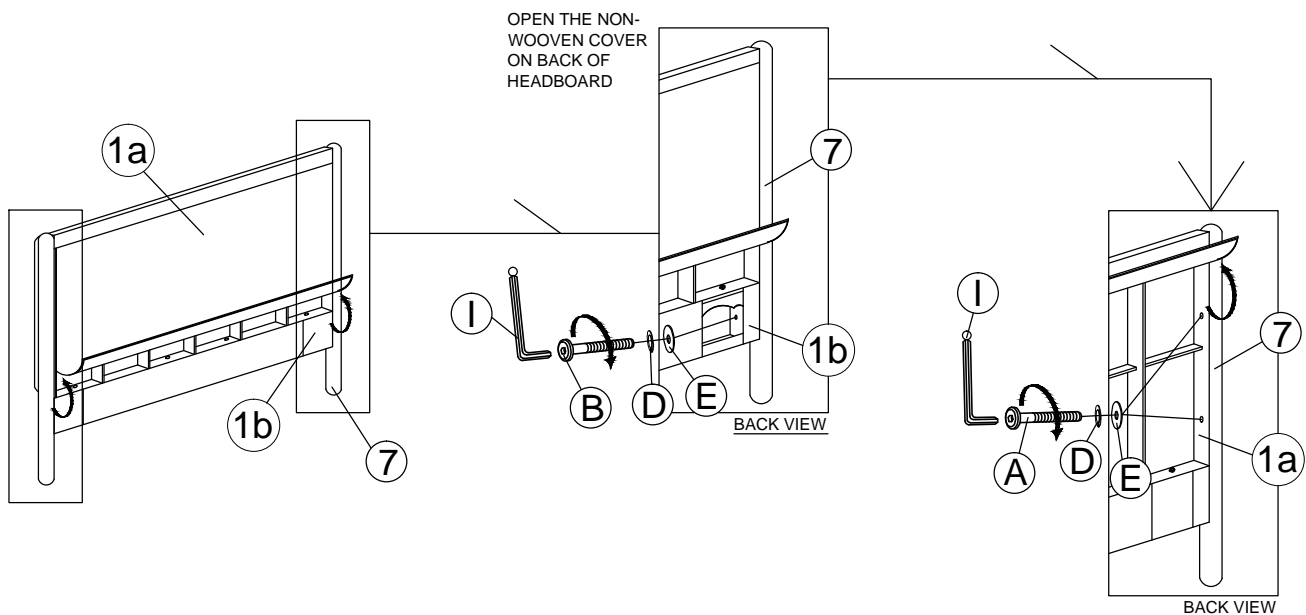

STEP 3

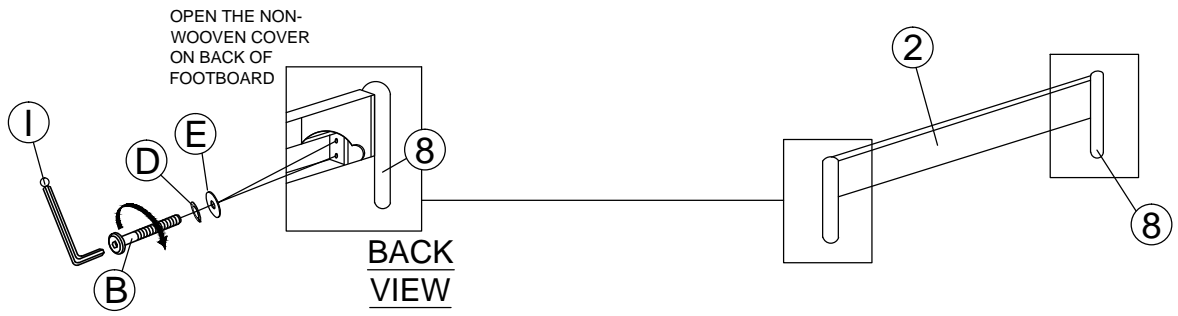

STEP 4

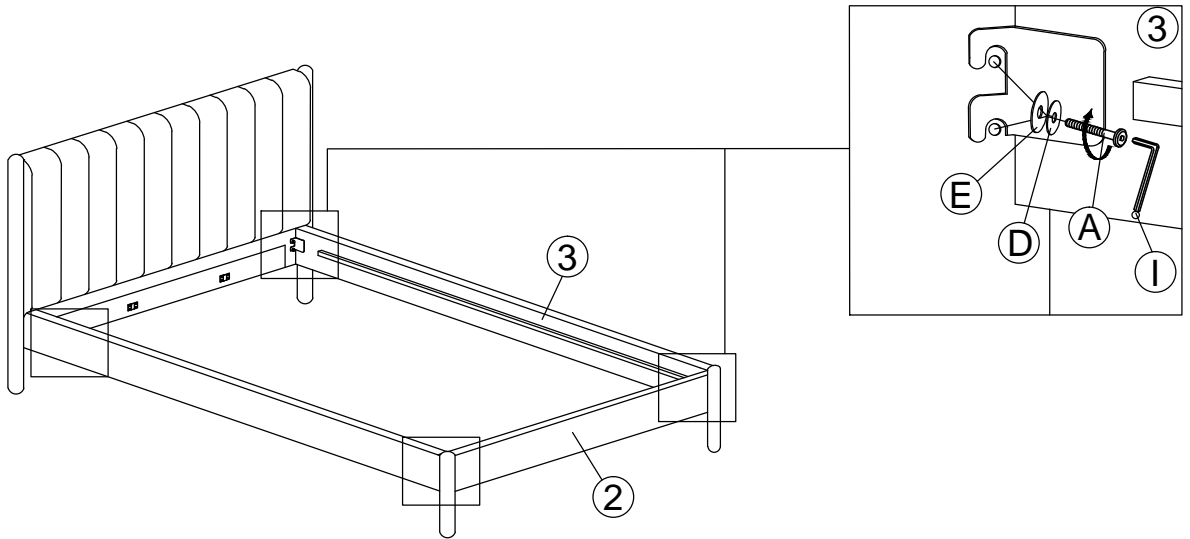

STEP 5

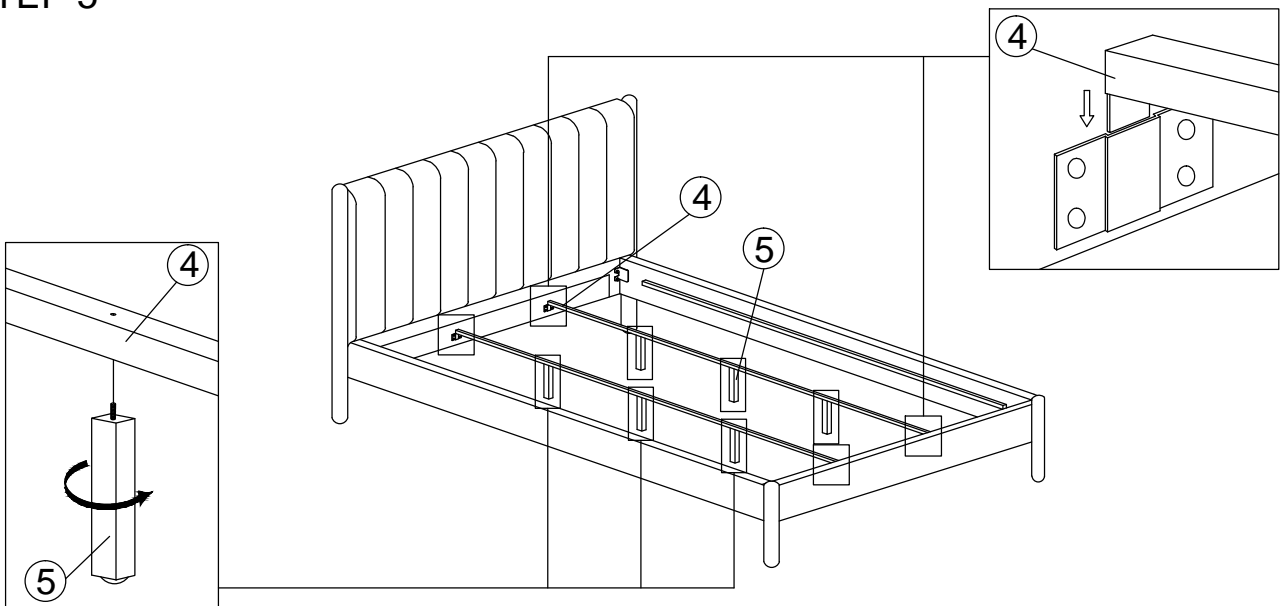

STEP 6

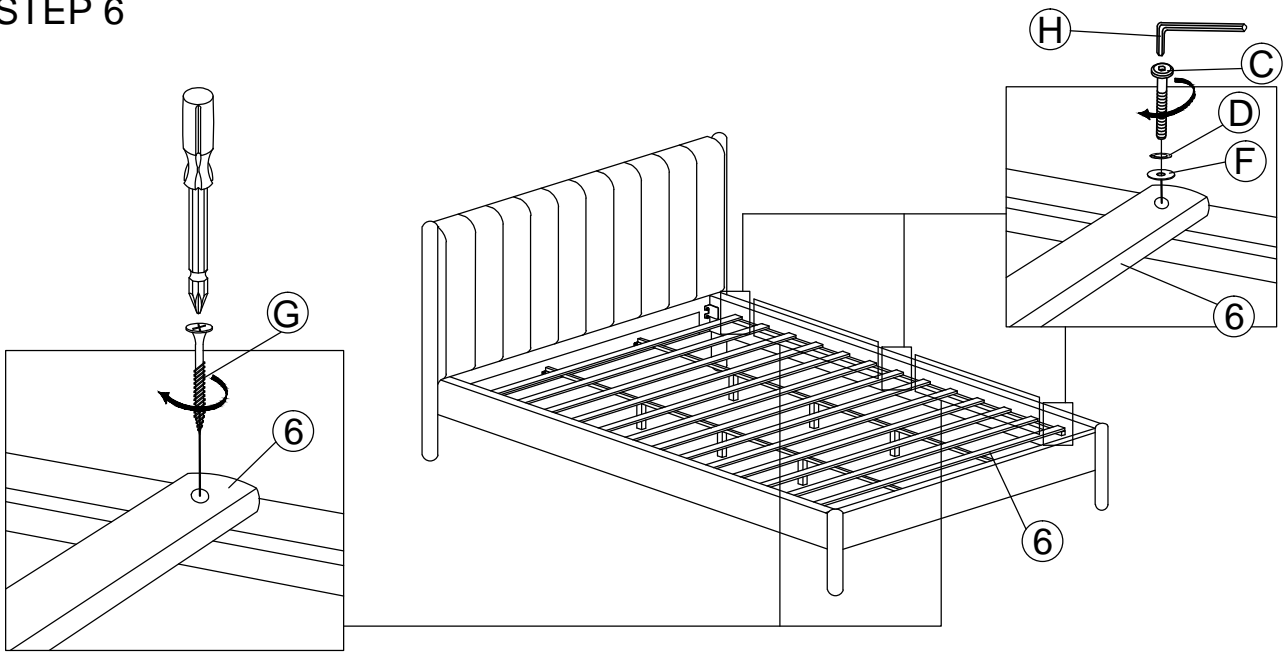

STEP 7

