

INSTRUCTION

Step 1



Lay out the frame pieces, fat side down. Show the channel facing upward. Insert corner connectors into two frame pieces, bringing the sides of the frames together.



For 1" depth Infinity frames, there will be 8 total corner connectors: (4 Part A's and 4 Part B's).

Stack Part A over each Part B corner connector before joining the sides of the frame.

Use the allen key to tighten, repeat to the closest corner. Insert the last two corner connectors into the remaining sides of the frame. Do not over-tighten corners.



Step 2

Slide support bars with open state indication (dot towards bolt by default) upward into connected infinity frame in cross shape & tighten them 180° clockwise with torx key.



(Only required for 24" x 46", 36" x 46", 24" x 60", 36" x 60", 46" x 60", 24" x 72", 36" x 72", 46" x 72" frames)



(Only required for 60" x 60", 72" x 72" frames)

Insert last two corner connectors into remaining infinity frame, slide into connected one & tight them with allen key & torx key.

Step 3



Lay your print over the frame, artwork side up! Fold the silicone edges down at one of the corners (like a pizza box). Press the folded corner into the channel of the frame at the corner. You should not be able to see any silicone once inserted.



Move to the opposite corner and repeat (similar to a fitted bed sheet). Insert the two remaining corners.

Step 4

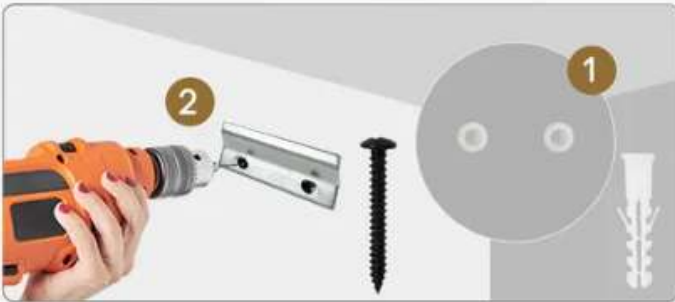

1. Pre-drill two holes in the location where you would like to secure the wall mount. Gently tap wall anchors into each hole with a hammer.
2. Hold the wall mount over the pre-drilled holes with the wall anchors. Fasten the screws into the wall anchors to secure the wall mount.

Step 5

Hang your artwork on the wall using the metal channel on the back of the frame.

