

**Jewenwils**

# Outdoor Wall Lamp

SKU: HOWL05A

[Instruction Manual]

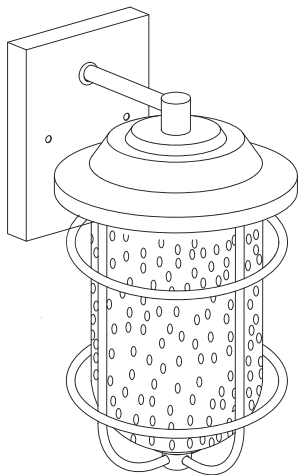

Please pay attention to the warning signs  
Read the instructions with caution before operating  
and keep it properly

V20823

## Installation Instructions

FIG.1. Place the wall switch to the “OFF” position.

Depending on which type of fuse box you have in your home:

FIG.2. Place either the main (Master) switch to the “OFF” position, cutting off power to your entire home OR turn off the individual switch that provides power to where the fixture will be installed.

OR

FIG.3. Place either the main (Master) switch to the “OFF” position, cutting off power to the entire home OR unscrew the fuse that provides power to where the fixture will be installed.

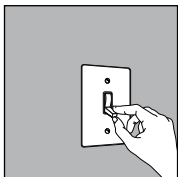

FIG.1 WALL SWITCH

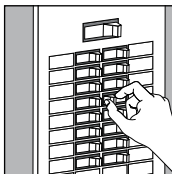

FIG.2 BREAKER PANEL

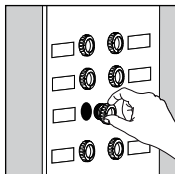
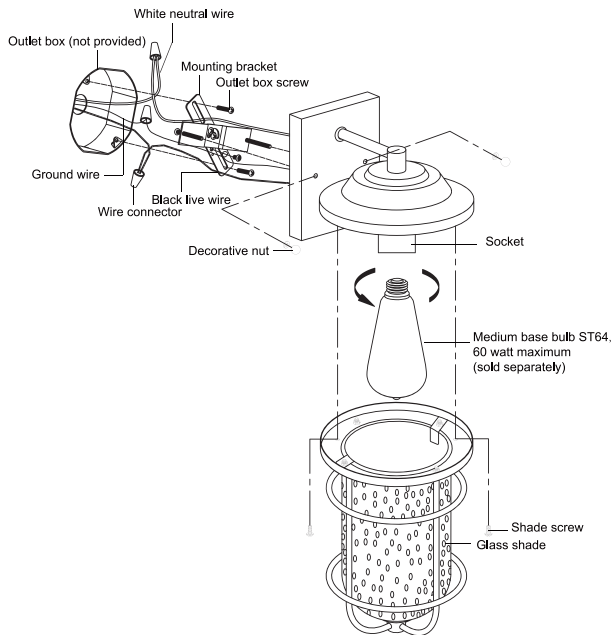

FIG.3 FUSE BOX

Cleaning: Before cleaning your fixture, turn off the switch or power source.

Wipe the fixture with a soft and damp cloth.



## One Year Limited Warranty

Supported by our professional R&D team and QC team, we provide One Year Warranty for materials and workmanship from the purchase date. Please note that the warranty does not cover damage caused by personal misuse or improper installation.

Please attach your Order ID and Name so that our dedicated customer service team can help you better.

