



VALLEY BLVD TRADING AND INVESTMENT CO LTD

5199 Brooks St Ste A Montclair CA 91763
(626)-258-9783 lubannus@gmail.com

Wooden Box Rail Sliding Hardware Set Quick Guide



Parts included:

LuBann aluminum sliding track door hardware kit set (part no. XC-40)

Alder wooden box:

1. Back board (4"H) +Top board (4" H) (pre-attached L shaped box);



2. aluminum track + mounting base

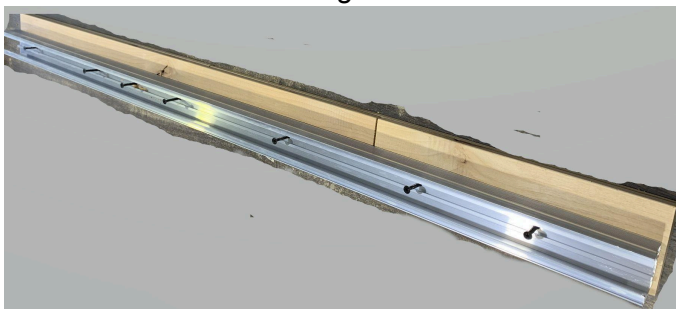

* The aluminum track edge aligns with the outside edge of the top board in 1.

3. Front cover (4" H) + end boards (pre-attached)

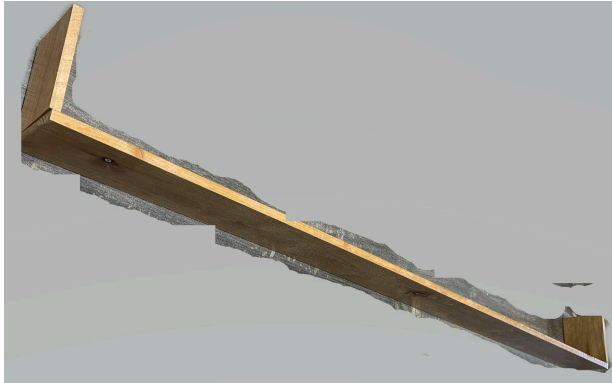

* The end boards are attached with pin nails and can be removed with a small force (i.e. a mallet) if needed during the installation. To put back the end boards, wood glue may be used.

4. LuBann aluminum track sliding door hardware kit XC-40 installation manual

PRE-INSTALLATION

TOOLS REQUIRED

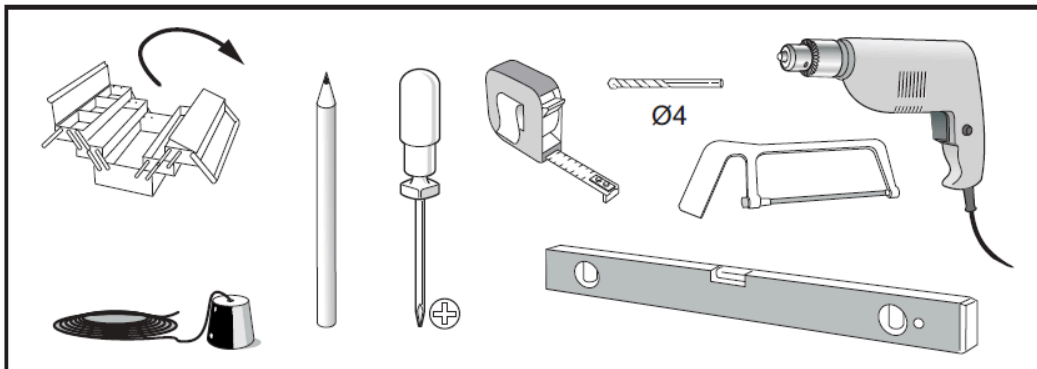



VALLEY BLVD TRADING AND INVESTMENT CO LTD

5199 Brooks St Ste A Montclair CA 91763

(626)-258-9783

lubannus@gmail.com

Wooden box rail sliding hardware set is an add-on feature of LuBann aluminum track sliding door hardware kit XC-40.

Please follow the LuBann aluminum track sliding door hardware kit XC-40 installation manual for preparations of the sliding barn door for installation.

Step 1: mark the position of the backboard+top board L box on the wall above the opening.

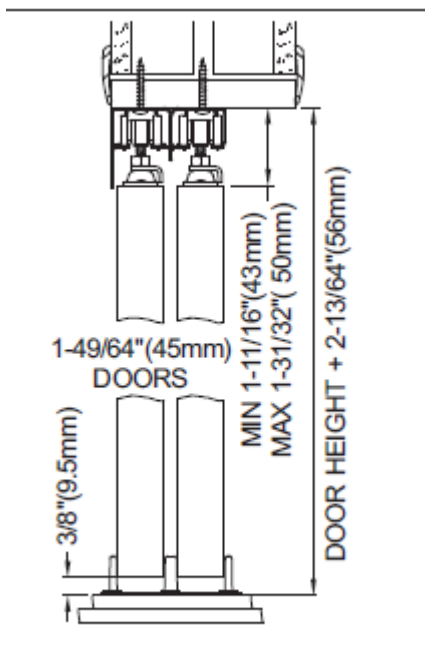

Refer to the diagram above to determine the height of the aluminum track.

Door height (i.e. 84") + $2-13/64"$

Then mark the positions for the backboard+top board L box, so the aluminum track will be installed at the right height.

Please use at least $2-3/4"$ L drywall screws or wood screws (not provided) to attach the backboard into the studs inside the wall. Two or more screws are recommended for each stud.

To make sure the backboard+top board is leveled on the wall.



VALLEY BLVD TRADING AND INVESTMENT CO LTD

5199 Brooks St Ste A Montclair CA 91763
(626)-258-9783 lubannus@gmail.com

Step 2: Install aluminum track + mounting base onto the top board by tightening the screws upward into the top board.



The aluminum track edge needs to align with the outside edge of the top board in 1.



Optional: if two sets are set up to merge into one track, the two aluminum tracks need to be end to end without a gap.



Step 3: Install the sliding barn door onto the track (following LuBann aluminum track sliding door hardware kit XC-40 installation manual)

Make sure the door is installed leveled and the door operation is good and as desired.

Step 4: attach the front cover+end boards to finish the wooden box using either pin nails or wood glue (not provided).

END.



VALLEY BLVD TRADING AND INVESTMENT CO LTD

5199 Brooks St Ste A Montclair CA 91763
(626)-258-9783 lubannus@gmail.com



For questions and technical support: call **626-2589783** or email: lubannus@gmail.com