

To deodorize the leather, leave the chair in a shady outdoor area for 1-2 days.

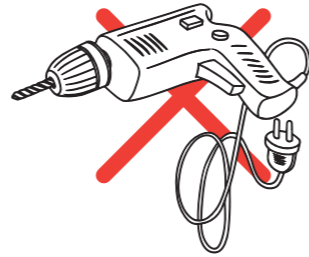

For longer use

Re-tighten bolts every 6 months by using the enclosed Allen-key.  
\*Using an electric drill can damage the chair. Please re-tighten the bolts manually.



## Safety Information



Sit in the center of the chair, with your back against the backrest



Do not sit on the front edge of the chair



Do not stand on the chair



Do not use the chair with more than one person



Do not push the chair around when a person is sitting in it



Do not push down on the backrest when a person is reclined



Do not place your entire weight on the backrest

## INSTRUCTION MANUAL

## INSTRUCTION MANUAL



### Package List



(A)\*1



(B)\*1

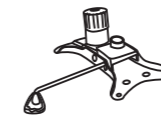

(C)\*1



(D)\*1



(E)\*1



(F)\*5



(G)\*5



(H)\*5



(I)\*1



(J)\*5  
M6\*18mm



(K)\*4  
M6\*20mm



(L)\*4  
M6\*30mm



(M)\*4  
M6\*25mm



(N)\*1

# Assembly Instruction

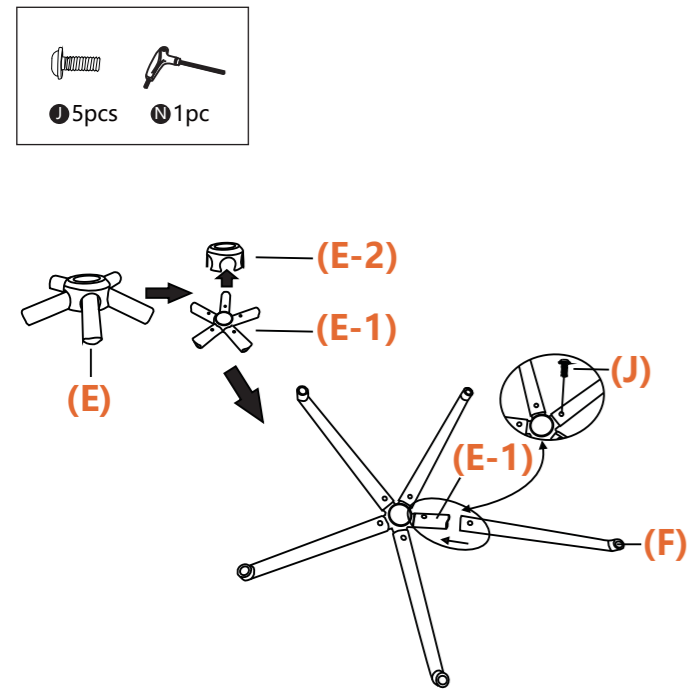

1

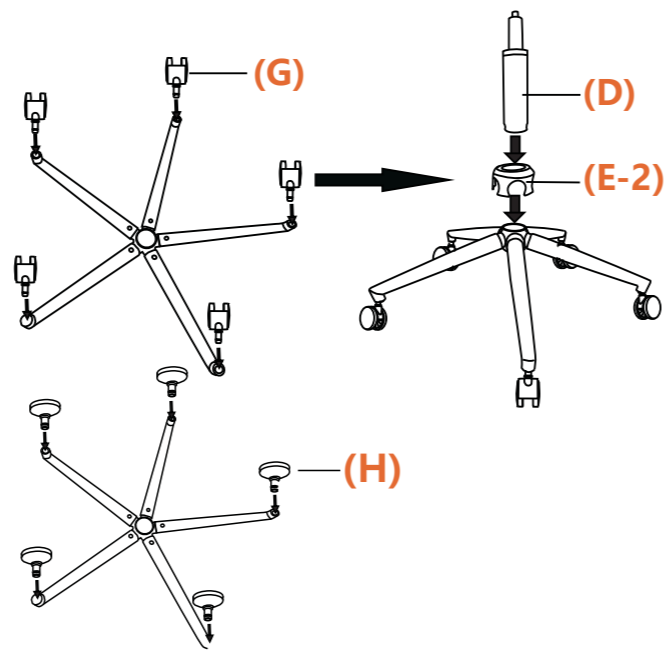

2

**NOTE:**  
Choose either (G) or (H) to install. The following illustration uses (G) as an example for installation.

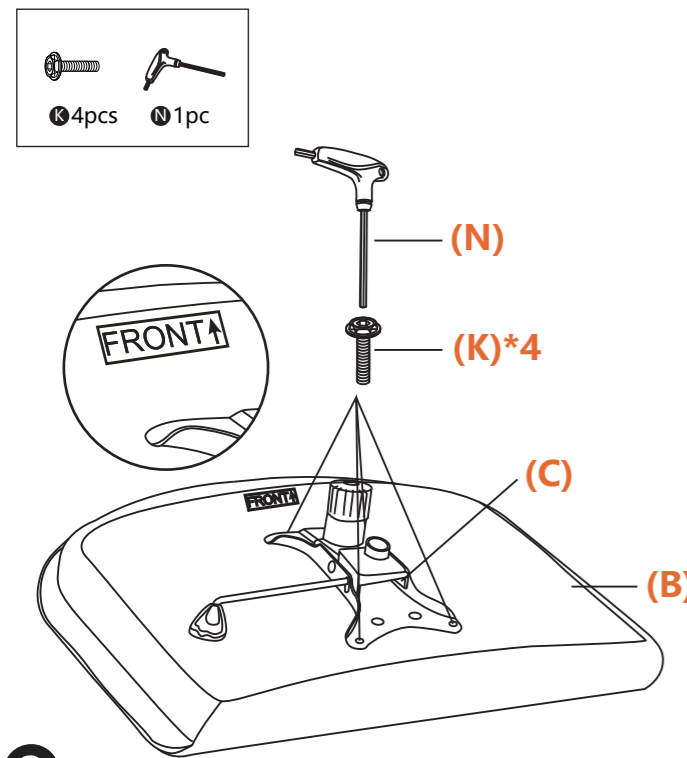

3

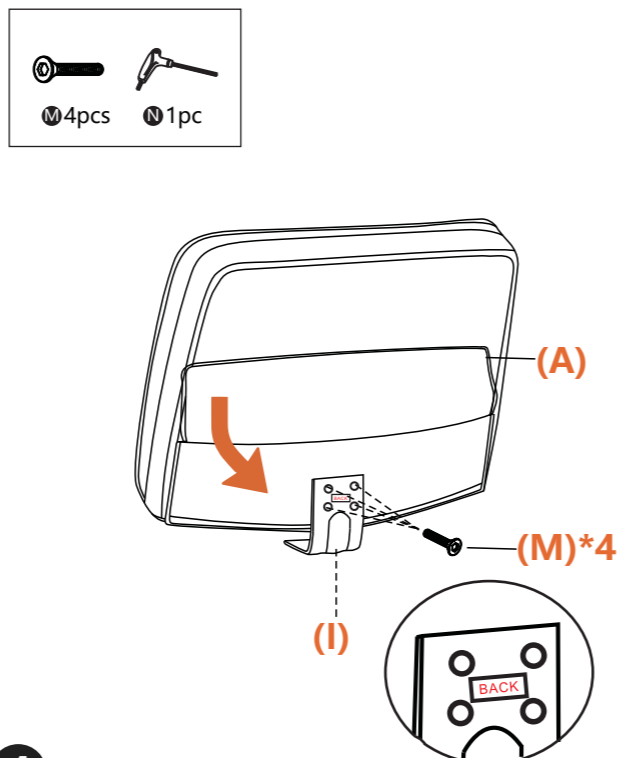

4

# Instructions For Use

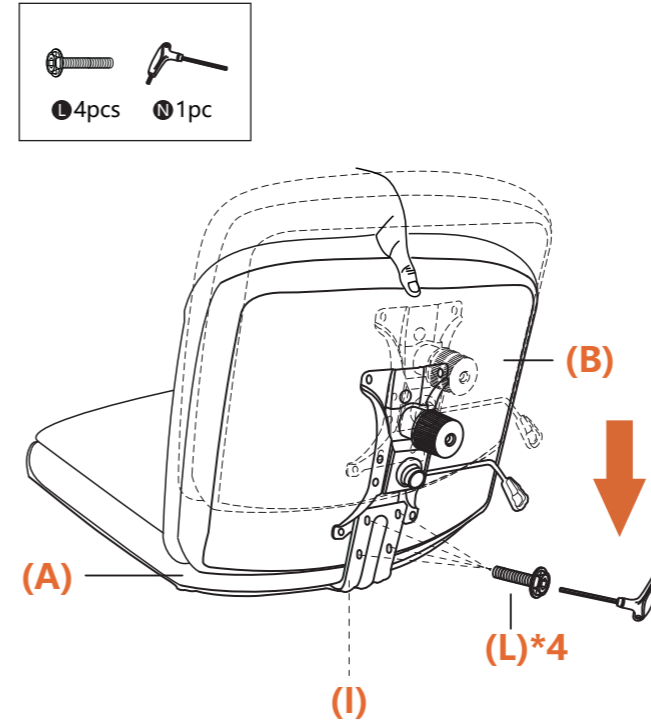

5

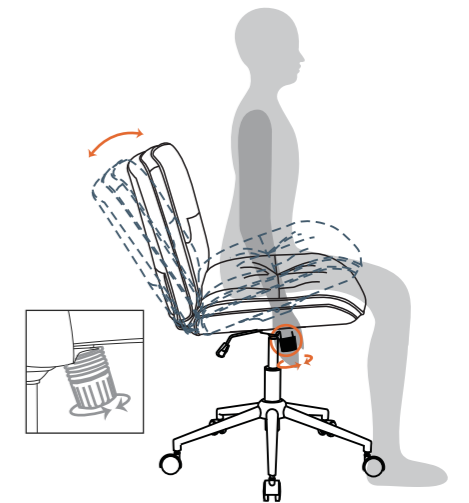
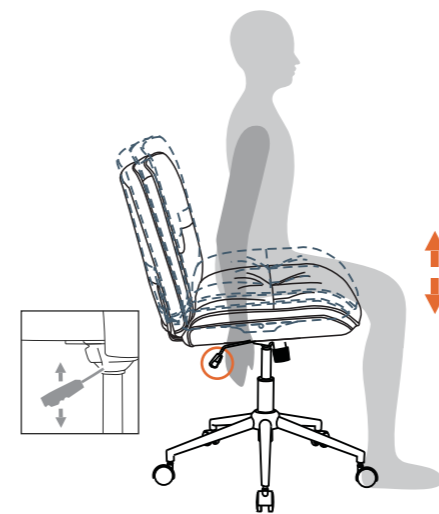
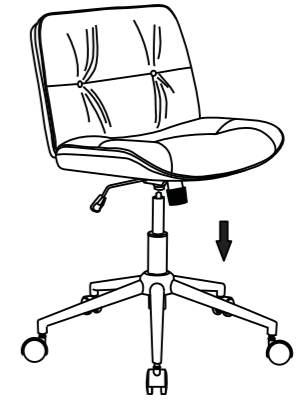

## CAUTION:

- \* Before using the chair, check to ensure that all bolts are fully tightened.
- \* Lubricate all parts and tighten all bolts every 6 months or whenever needed.