

Night Stand
Assembly Instructions
Contains One Night Stand and Hardware

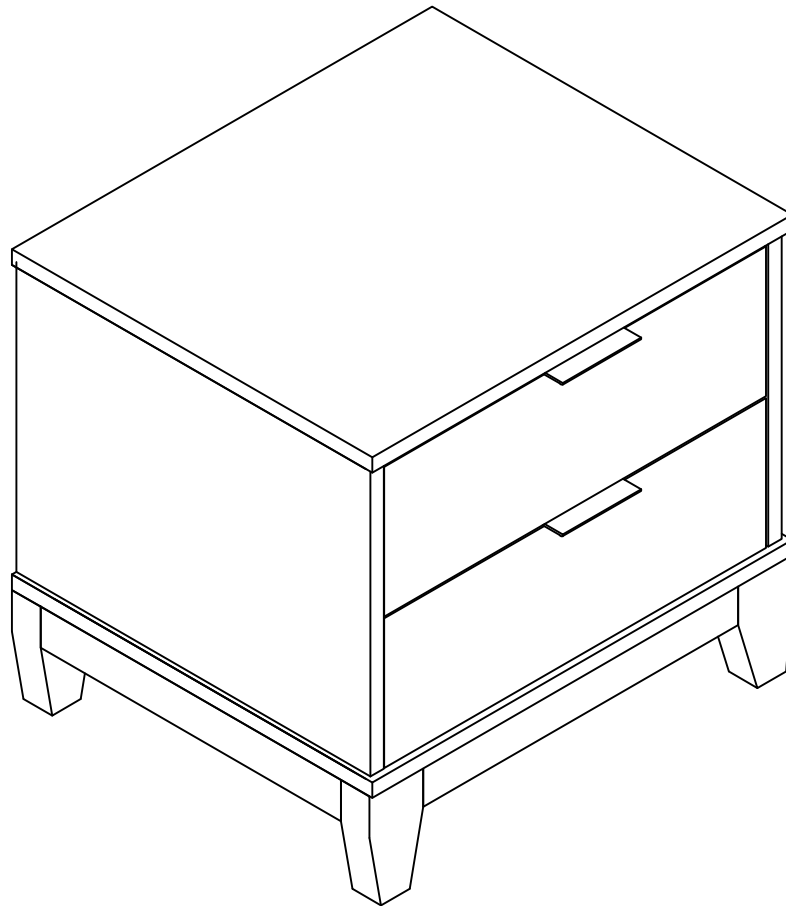

Night Stand

Contains One (1) Night Stand and Hardware

IMPORTANT NOTE:

Carefully remove all the parts from the box. Arrange on a flat surface and verify you have all of the following parts and hardware.
For customer support please call 314-993-2693.

TOOLS REQUIRED:

-Phillips Screwdriver
-Hammer

PARTS LIST

1.Top Panel (1 PC)

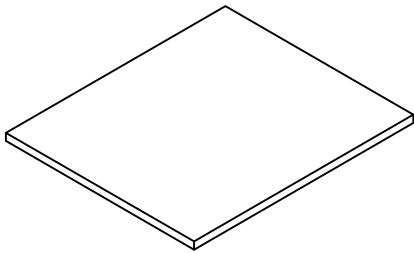

2.Left Side Panel (1 PC)

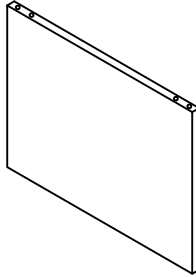

3.Right Side Panel (1 PC)

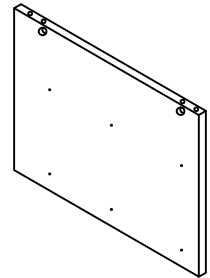

4.Bottom Panel (1 PC)

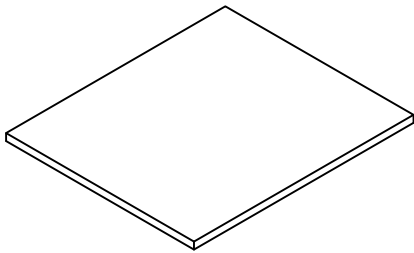

5.Back Panel (1 PC)

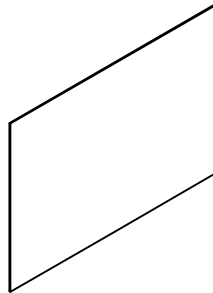

6.Front/Back Bar Panel
(2 PCS)

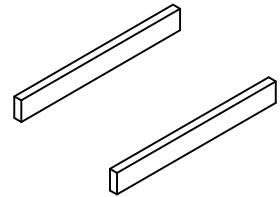

7.Side Bar Panel (2 PCS)

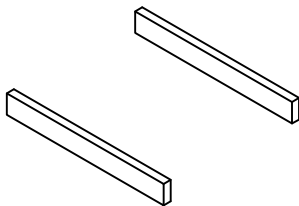

8.Legs L/R (4 PCS)

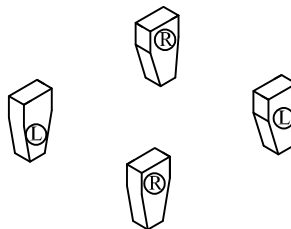

9.Drawer Front Panel
(2 PCS)

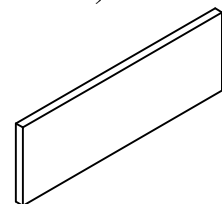

10.Drawer Back Panel
(2 PCS)

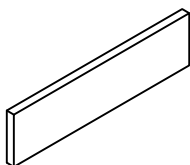

11.Drawer Side Panel
(4 PCS)

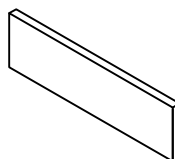

12.Drawer Bottom Panel
(2 PCS)

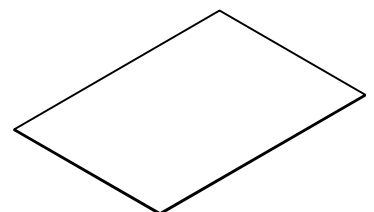

HARDWARE LIST

A.Allen Key (1 PC)

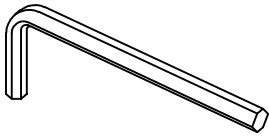

B.Dowel (8 PCS)

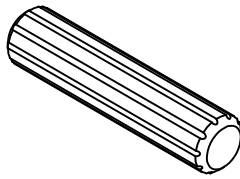

C.JCBC W Screw 40mm (4 PCS)

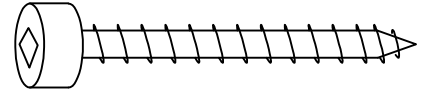

D.Minifix Bolt (20 PCS)

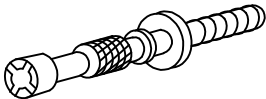

E.Minifix House (20 PCS)

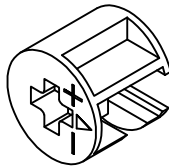

F.Minifix Cap (20 PCS)



G.Screw 16mm (36 PCS)



H.Screw 50mm (16 PCS)



I.L Bracket (4 PCS)

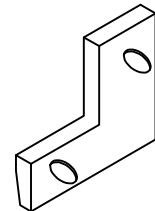

J.Handle (2PCS)

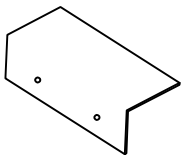

K.Drawer Slider (2 SET)

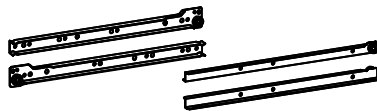

L.White Nail (4 PCS)

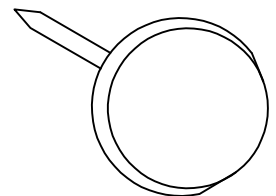

ASSEMBLY INSTRUCTIONS

STEP 1

Tap Dowels (Part B) into the Left and Right Side Panel (Part 2,3) in the larger holes provided.

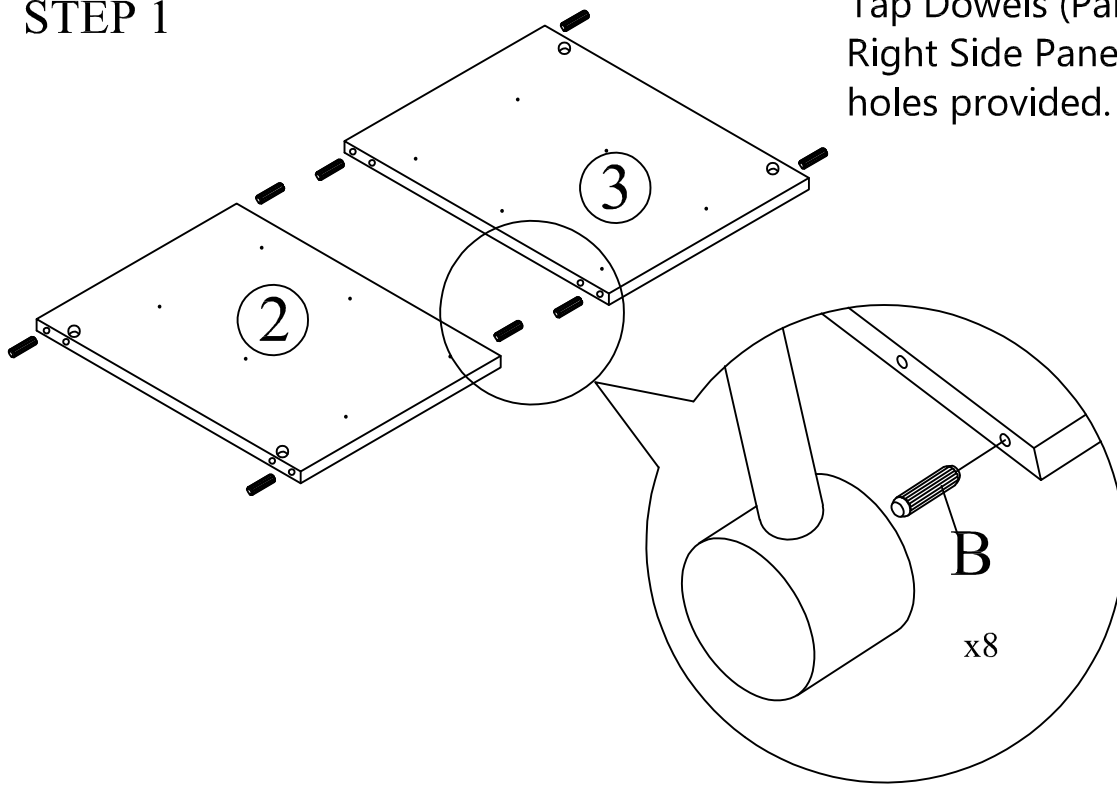

STEP 2

Using a Phillips Head Screwdriver, attach Minifix Bolts (Part D) to the Top Panel (Part 1) and Bottom Panel (Part 4) and to the Legs L/R (Part 8).

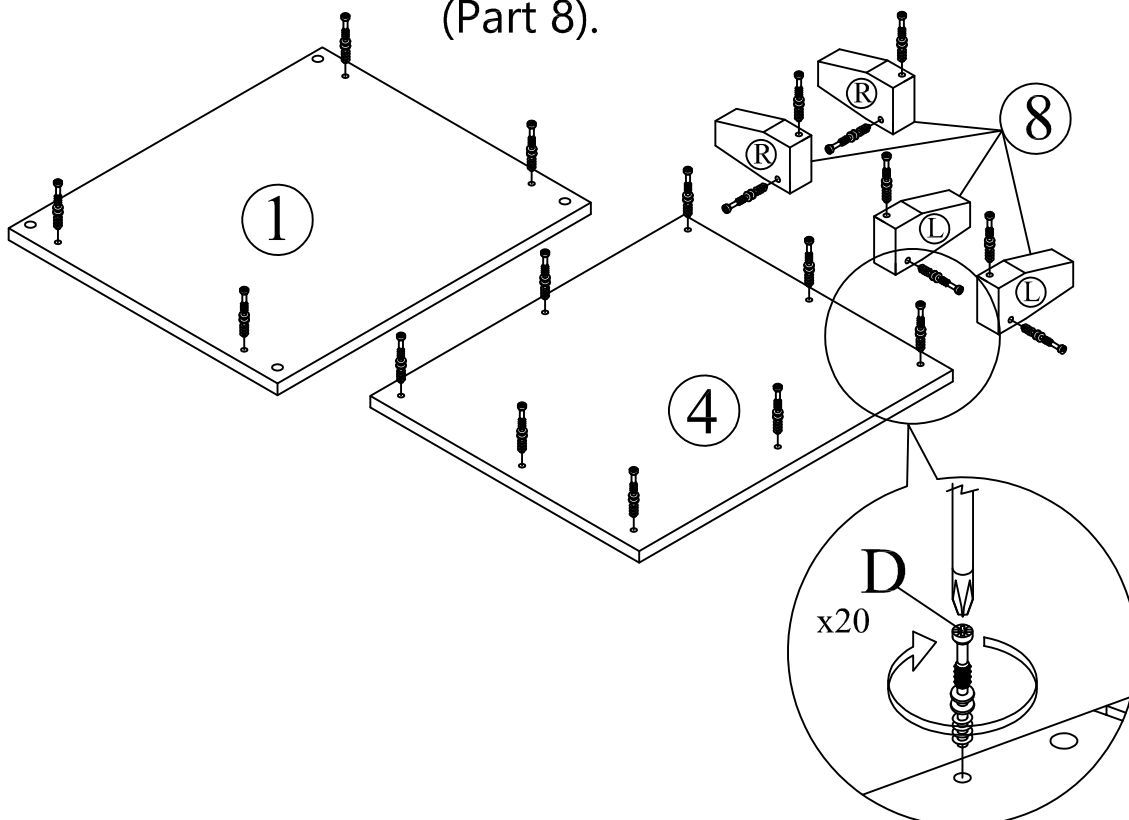

ASSEMBLY INSTRUCTIONS

STEP 3

Attach the Drawer Slider (Part K) to the Left Side Panel (Part 2) using Screw 16mm (Part G). Follow the Pilot Holes as marked.

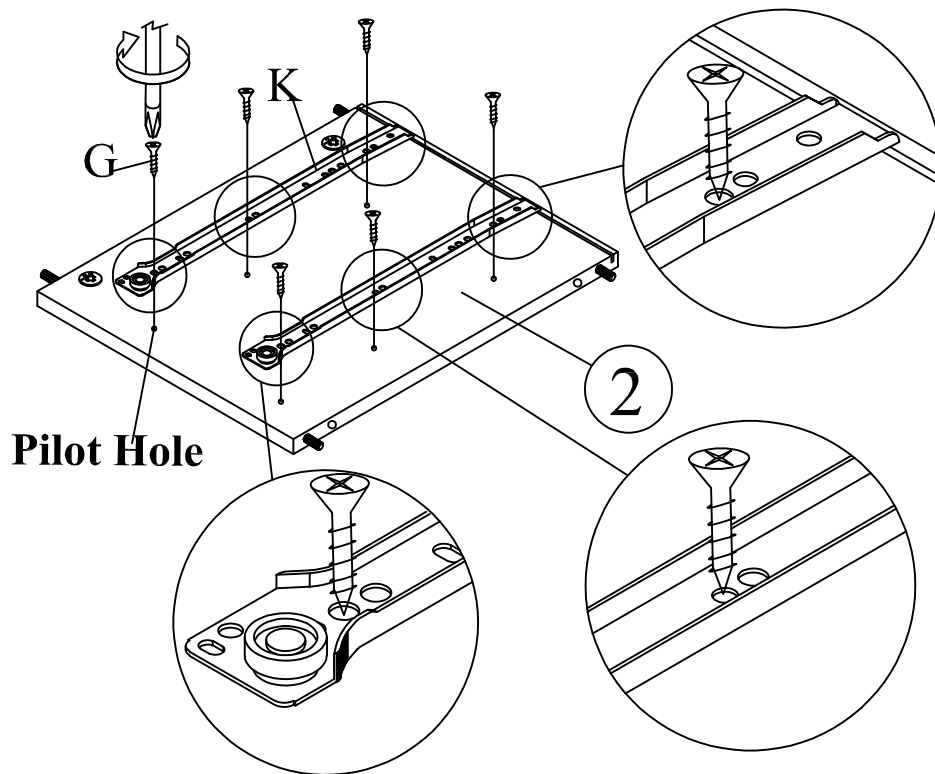

STEP 4

Attach the Drawer Slider (Part K) to the Right Side Panel (Part 3) using Screw 16mm (Part G). Follow the Pilot Holes as marked.

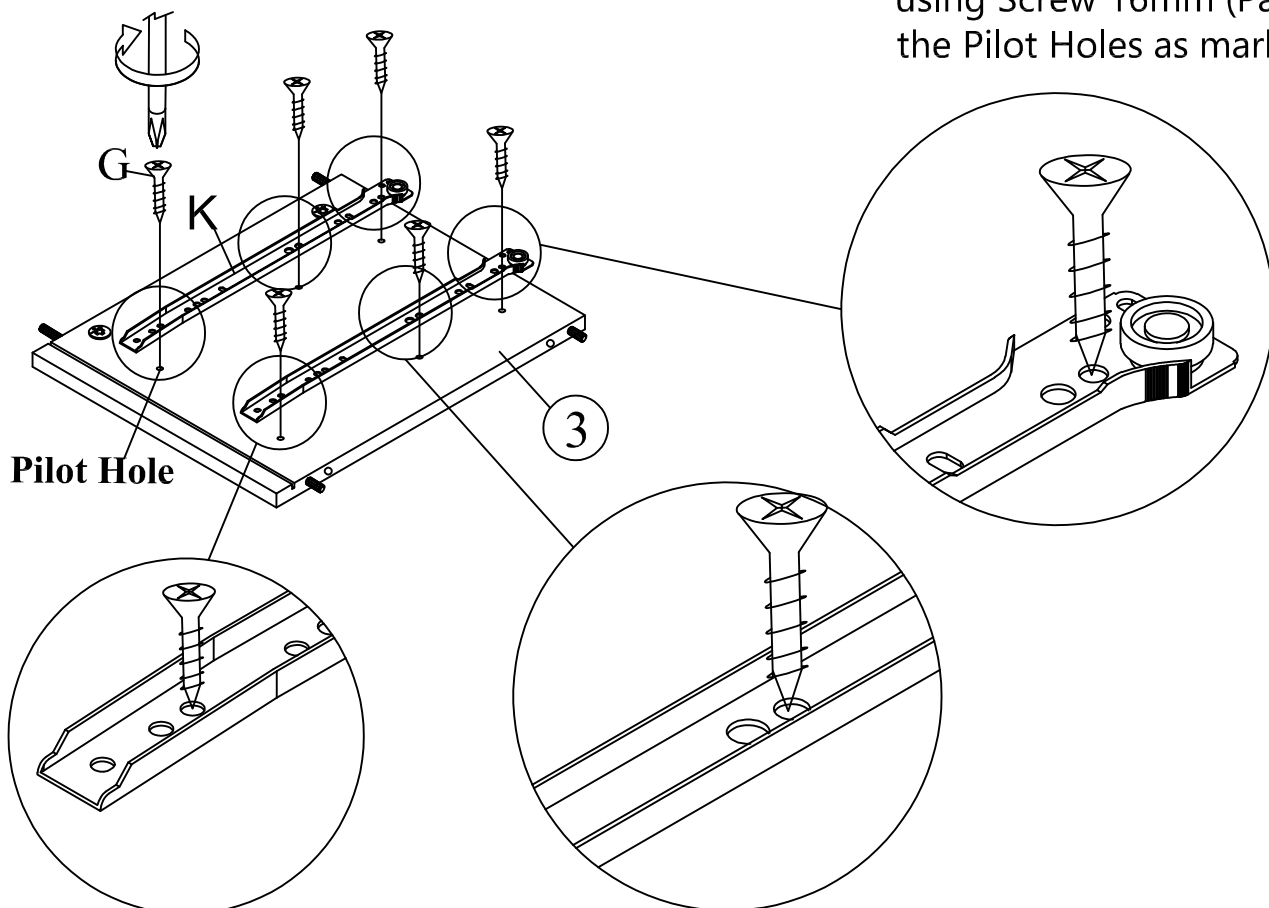

ASSEMBLY INSTRUCTIONS

STEP 5

This is how a mini fix works...

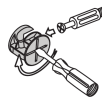

The head of the mini fix housing goes into the open mouth of the mini fix bolt. You then turn the mini fix housing so it tightens over the mini fix bolt.

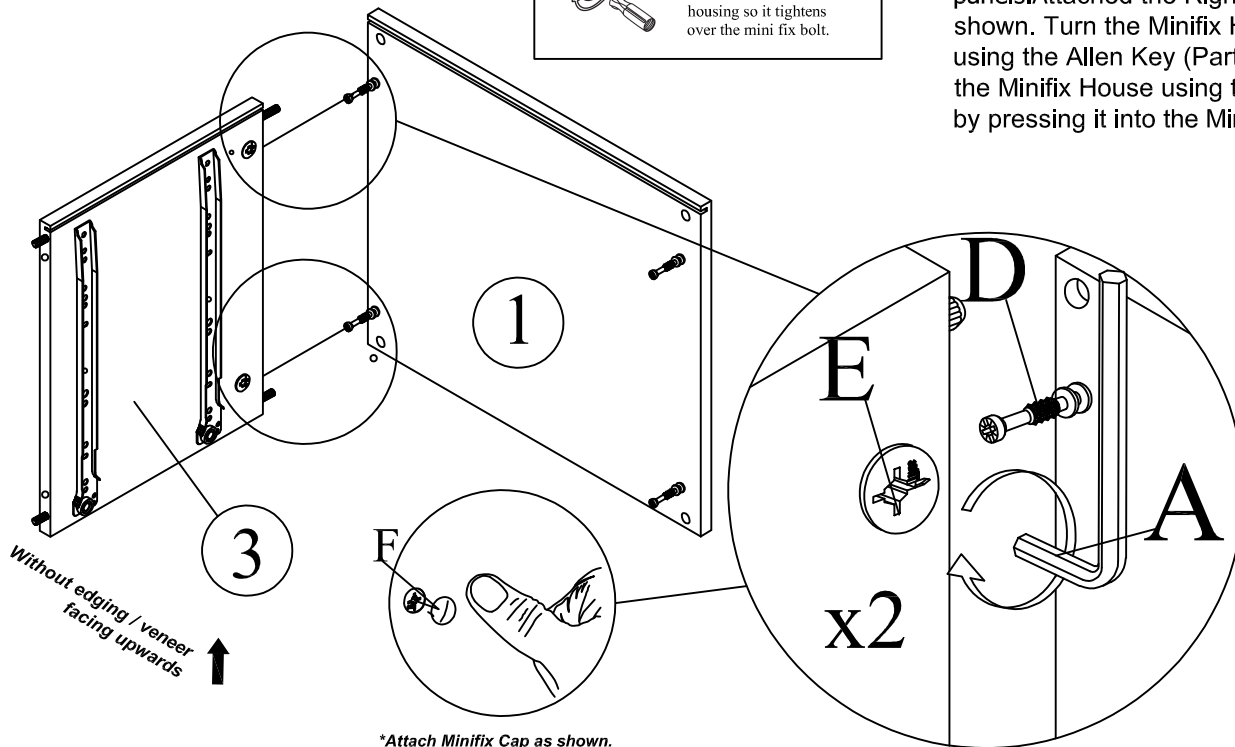

*Attach Minifix Cap as shown.

Insert the Minifix House (Part E) to the Right Side Panel (Part 3) and make sure the open side of the Minifix House (Part E) is facing the opening on panels. Attached the Right Side Panel (Part 3) as shown. Turn the Minifix House (Part E) to tighten using the Allen Key (Part A) or screwdriver. Cover the Minifix House using the Minifix Cap (Part F) by pressing it into the Minifix House.

STEP 6

This is how a mini fix works...

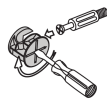

The head of the mini fix housing goes into the open mouth of the mini fix bolt. You then turn the mini fix housing so it tightens over the mini fix bolt.

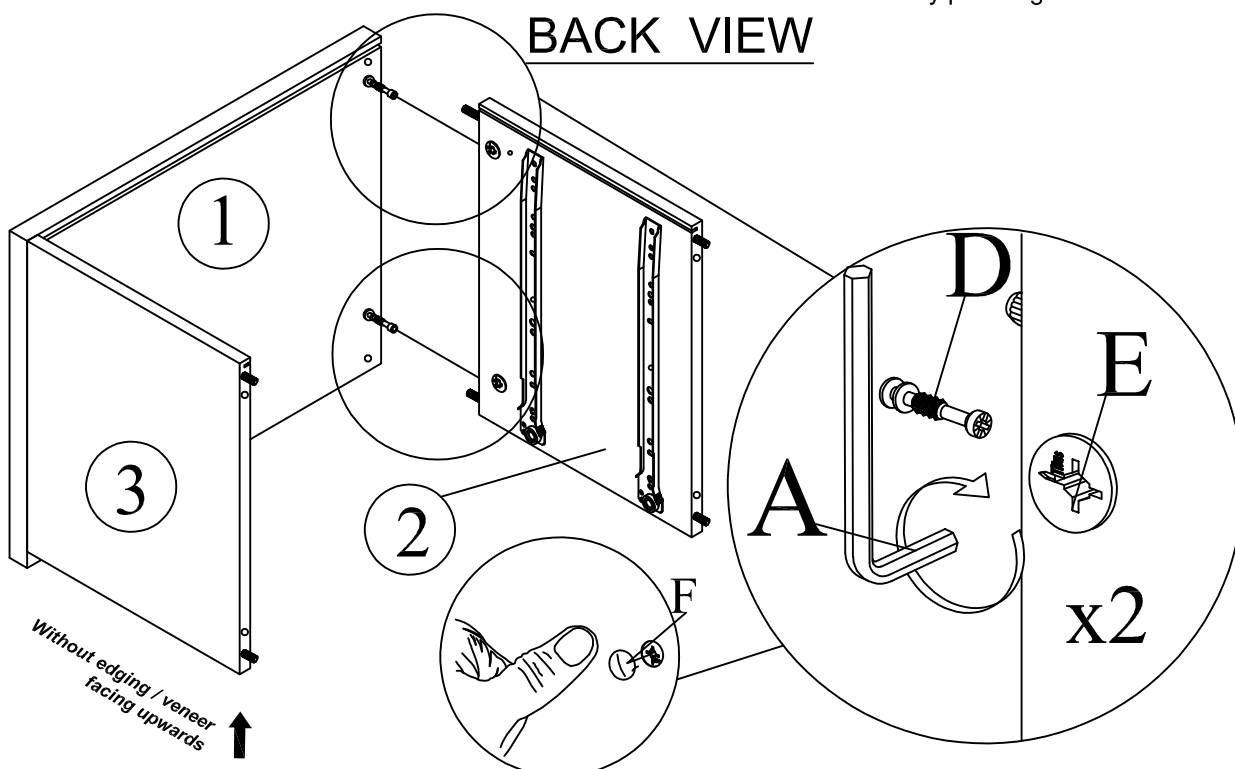

*Attach Minifix Cap as shown.

Insert the Minifix House (Part E) to the Left Side Panel (Part 2) and make sure the open side of the Minifix House (Part E) is facing the opening on panels. Attached the Left Side Panel (Part 2) as shown. Turn the Minifix House (Part E) to tighten using the Allen Key (Part A) or screwdriver. Cover the Minifix House using the Minifix Cap (Part F) by pressing it into the Minifix House.

ASSEMBLY INSTRUCTIONS

STEP 7

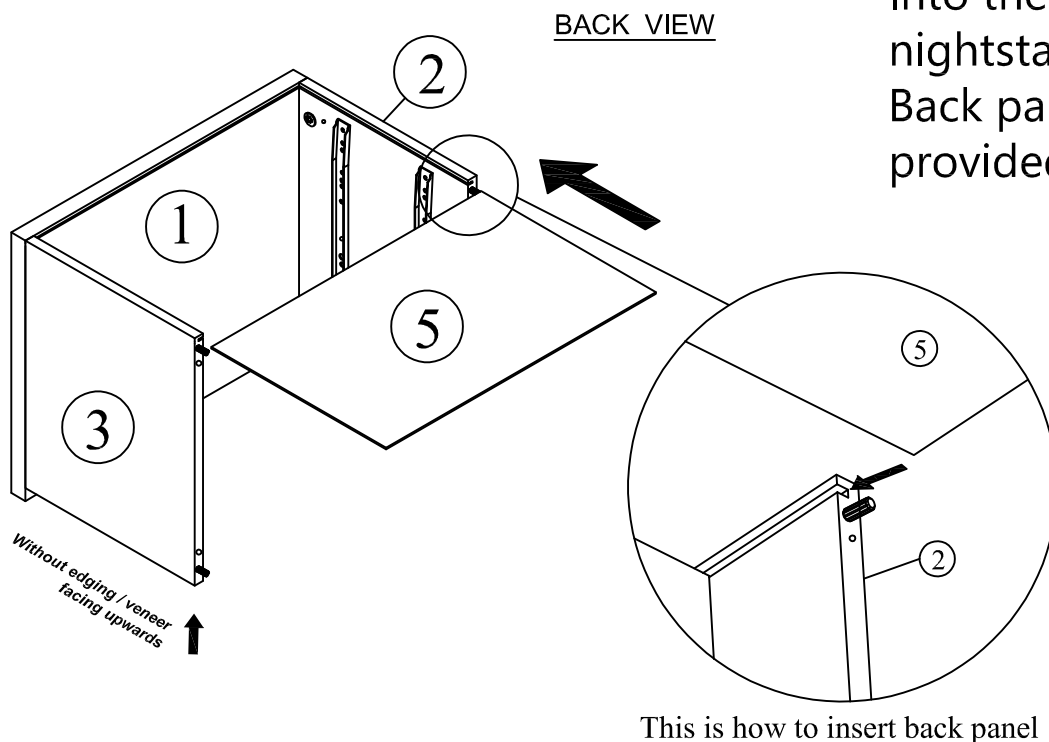

Insert the Back Panel (Part 5) into the back of the nightstand by sliding the Back panel into the slots provided.

STEP 8

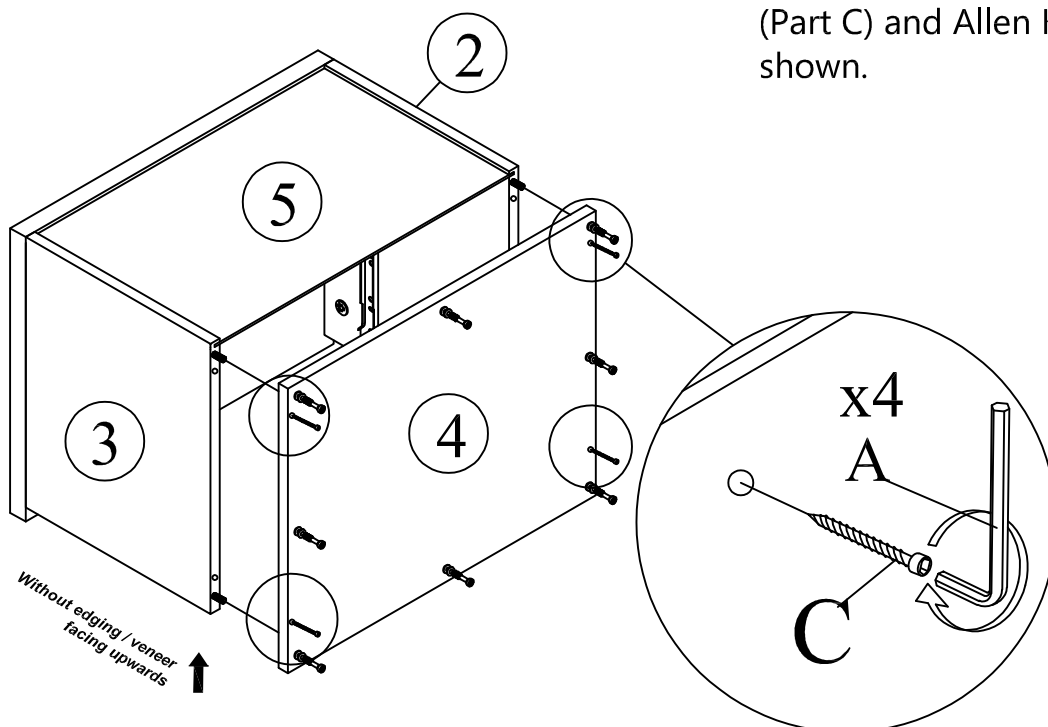

Attach the Bottom Panel (Part 4) to the Left and Right Side Panels (Part 2,3) using JCBC W Screw 40mm (Part C) and Allen Key (Part A) as shown.

ASSEMBLY INSTRUCTIONS

STEP 9

This is how a mini fix works...

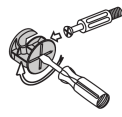

The head of the mini fix housing goes into the open mouth of the mini fix bolt. You then turn the mini fix housing so it tightens over the mini fix bolt.

Insert the Minifix House (Part E) to the Front and Back Bar Panel (Part 6) and Side Bar Panel (Part 7) and make sure the open side of the Minifix House (Part E) is facing the opening. Attach the Legs (Part 8) as shown. Turn the Minifix House (Part E) to tighten using the Allen Key (Part A) or screwdriver. Cover the Minifix House using the Minifix Cap (Part F) by pressing it into the Minifix House.

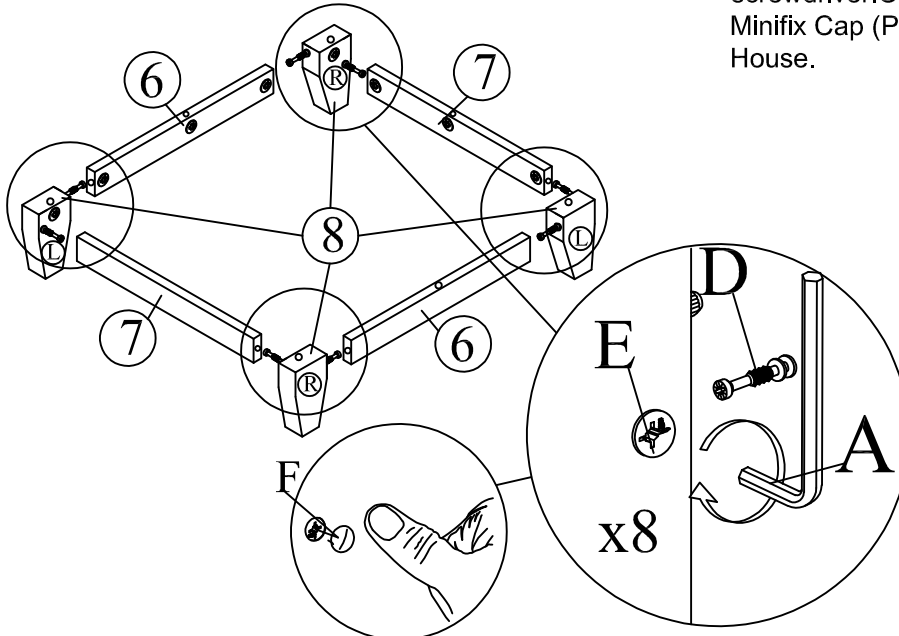

*Attach Minifix Cap as shown.

STEP 10

Attach L Bracket (Part I) to each corner of the Back panel (Part 5) using Screw 16mm (Part G) and a Phillip's screwdriver as shown.

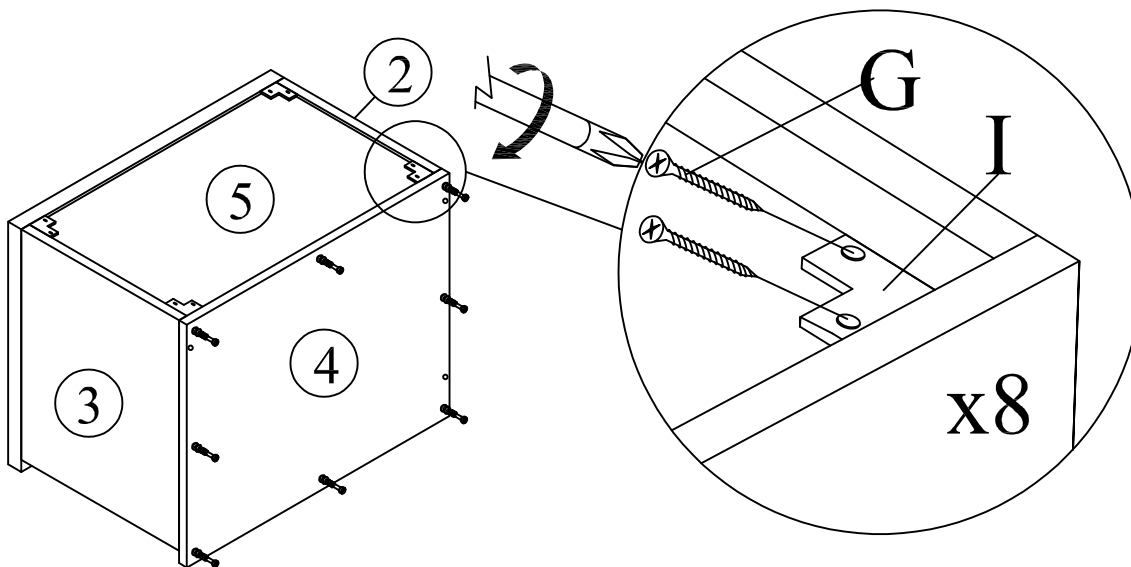

ASSEMBLY INSTRUCTIONS

STEP 11

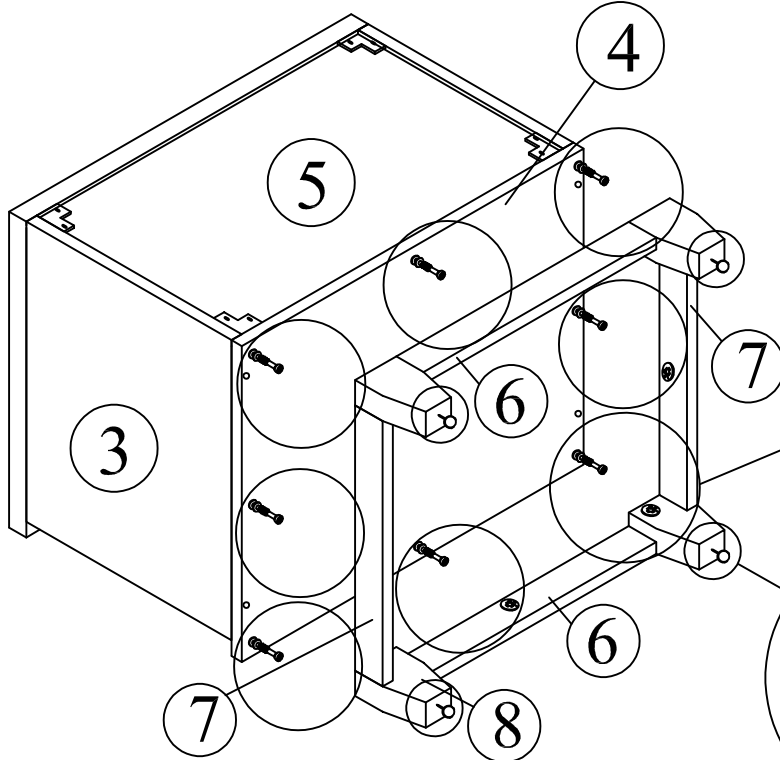
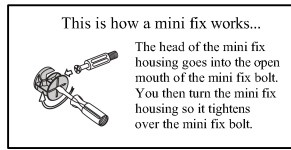

BACK VIEW

Insert the Minifix House (Part E) to the Legs (Part 8), make sure the open side of the Minifix House (Part E) is facing the opening. Turn the Minifix House (Part E) to Tighten using the Allen Key (Part A) or screwdriver. Cover the Minifix House using the Minifix Cap (Part F) by pressing it into the Minifix House. Attach White Nail (Part L) to each corner of the Left and Right Panel (Part 2,3) using hammer as shown.

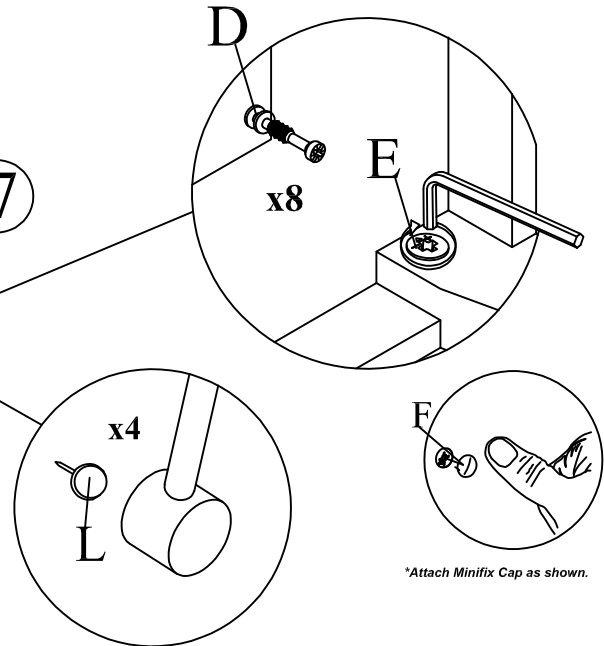

STEP 12

Attach the Drawer Side Panels (Part 11) to the Drawer Front Panel (Part 9) using Screw 50mm (Part H) and a Phillips Screwdriver. Insert the Drawer Bottom Panel (Part 12) as shown.

Step 12.1

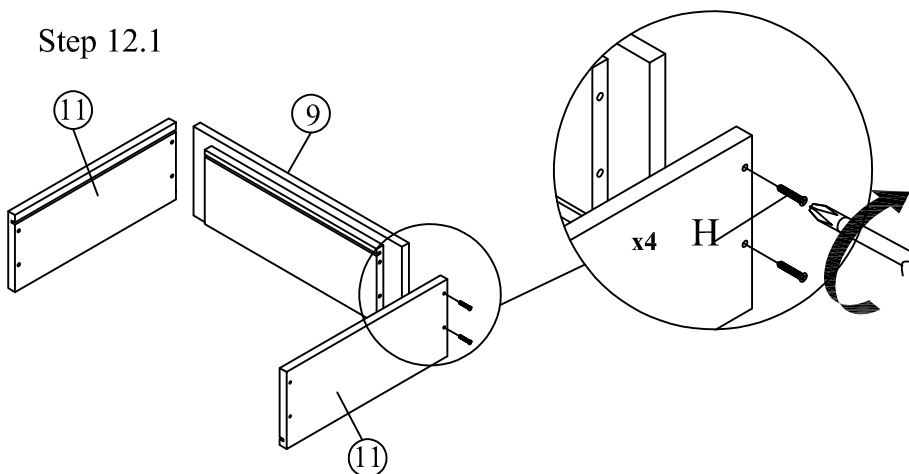

Step 12.2

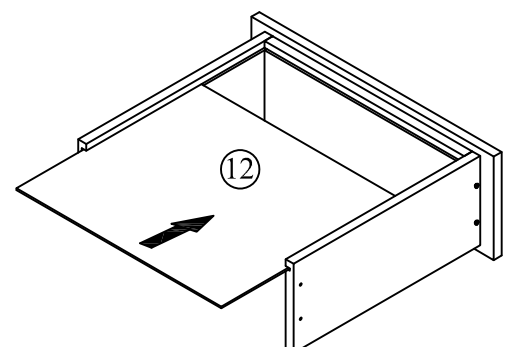

ASSEMBLY INSTRUCTIONS

STEP 13

Attach Drawer Back Panel (Part 10) to Drawer Side Panels (part 11) using Screw 50mm (Part H) and a Phillips Screwdriver as shown.

Back View

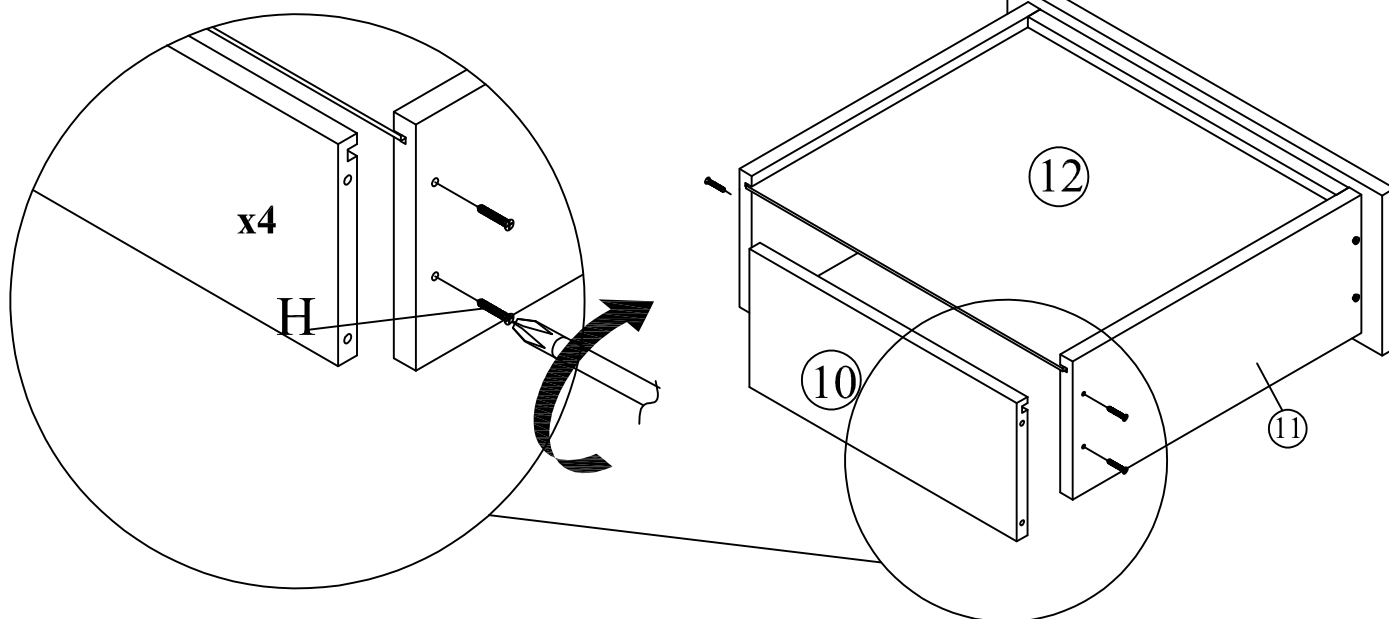

STEP 14

Attach Drawer Slider (Part K) to the Drawer Side Panels (Part 11) using Screw 16mm (Part G) and a Phillip's screwdriver. Attach the Handle (Part J) to the Drawer Front Panel (Part 9) using Handle Screw 16mm (Part G) and a Phillips screwdriver. Tighten the screws.

Back View

Step 14.1

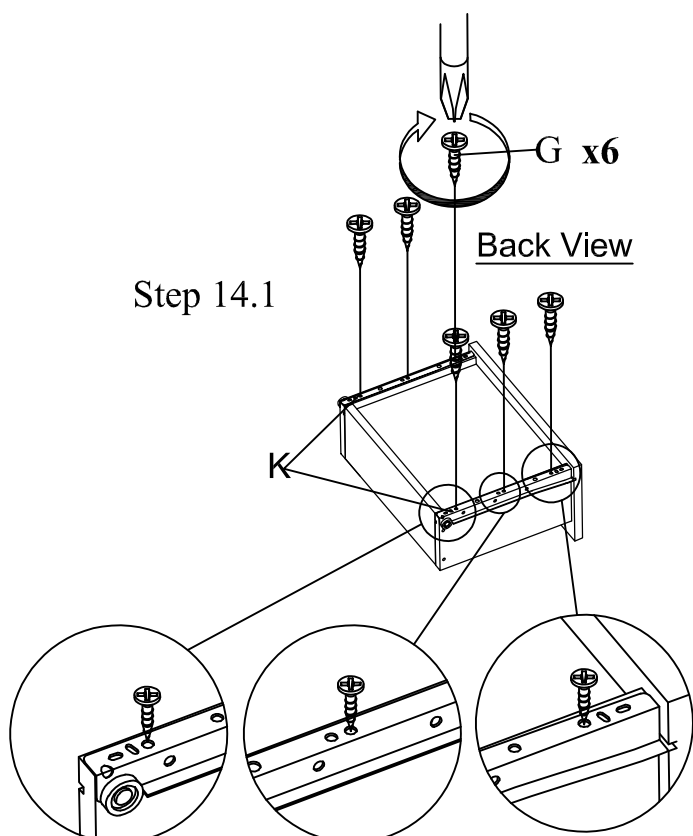

Back View

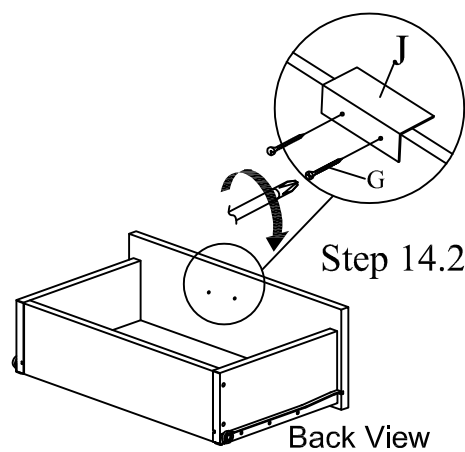

Back View

ASSEMBLY INSTRUCTIONS

Insert the drawers into the nightstand

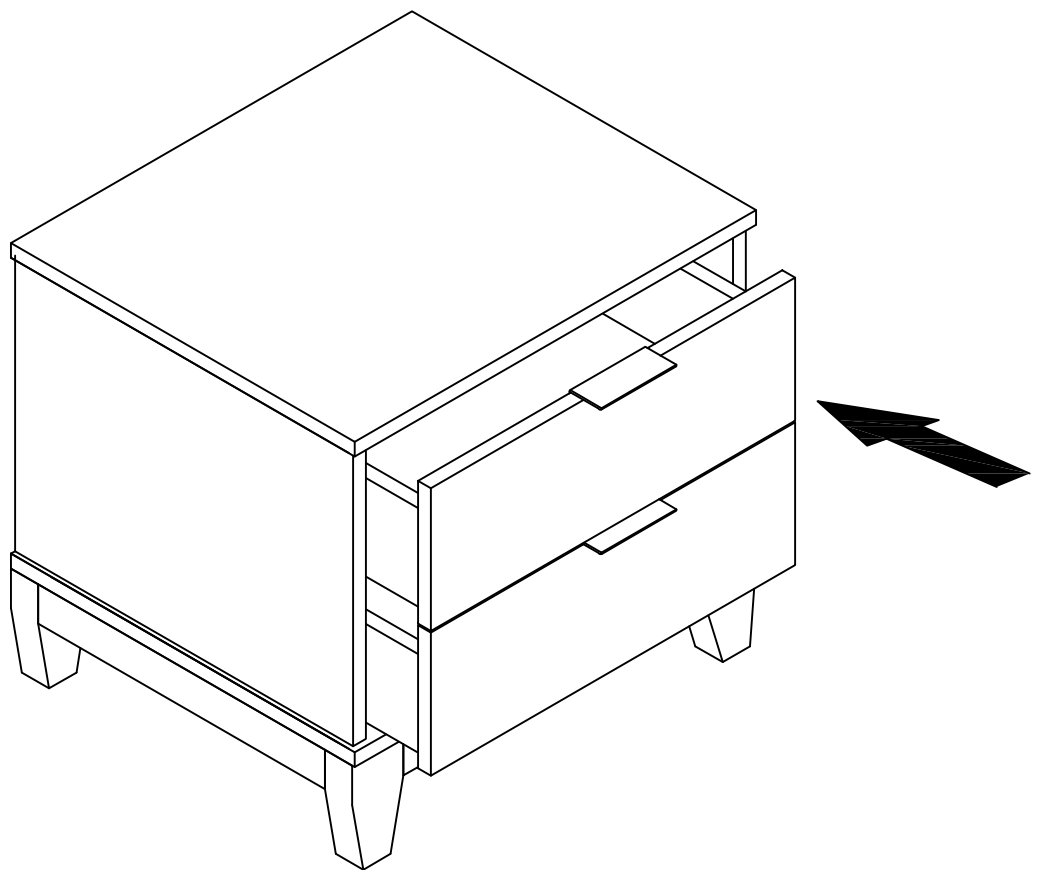

ASSEMBLY INSTRUCTIONS

YOUR NIGHTSTAND IS NOW READY FOR USE

