

# Guide: How To Assemble Artificial Christmas Tree

EN

## STEP 1: Choose your location

Pick a location that is big enough for the diameter of the bottom of the tree. You'll want to be sure the branches don't hit the walls and won't impede guests from walking by. Clear the area in preparation for the set up. Double check that the outlet in that location is operational, if desired.

## STEP 2: Open the box and remove all parts

Carefully open the box. Keep all the pieces organized so as not to lose anything (As following picture shown).



## STEP 3: Setting up the Tree Stand

Open the metal stand to form an — X shape. Line up the holes on the tube of the stand. Three eye bolts are included to secure the tree into the stand. Insert the eye bolts and thread them through the stand only until you see or feel the ends of the eye bolts flush with the inside of the tube (As following picture shown).



## STEP 4: Insert each section and shape the tree branches

Take the largest section, which will be the bottom, and place the pole gently into the base. Make sure the pole has been securely inserted into the base. Shape the branches by layers and sections. This way, you'll easily see if there are any gaps and adjust them accordingly. Don't insert the next section until you've properly fluffed the one before it (As following picture shown).

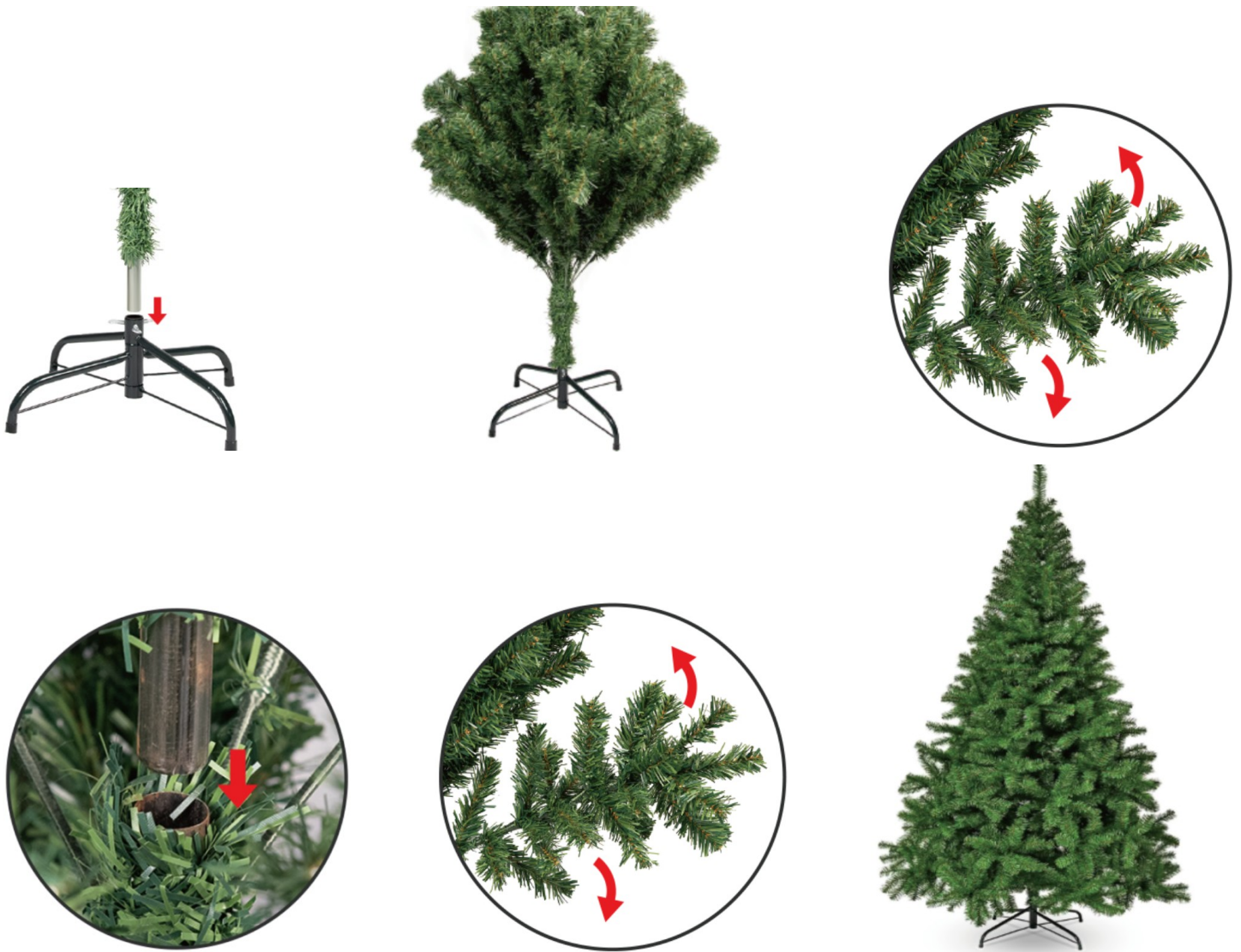

#### STEP 5: Enjoy

Once successfully assembled, the fun part of decorating can begin!

#### Recommendations

- 1 The tree must be assembled by an adult.
- 2 Keep an eye on young children.
- 3 Place the tree on a flat surface to ensure its stability.
- 4 Keep away from flammable materials.
- 5 Don't overload the tree with heavy and/or too many decorations.
- 6 If you are no longer using, do not throw it in areas that are not intended for this purpose.
- 7 Actively contribute to the preservation of our environment by sorting out your packaging.