

Instruction Manual

USB LED MAKEUP MIRROR

INFORMATION & WARRANTY

CUSTOMER SERVICE

If you are having difficulty with your product and require support, please contact

COPYRIGHT

All materials in this instruction manual are copyrighted |

Any unauthorized use may violate worldwide copyright, trademark, and other laws.

PRODUCT DISPOSAL INFORMATION

For electrical products sold within the European Community, at the end of the electrical product's useful life, it should not be disposed of with household waste. Please recycle where facilities exist.

Contact your local authority for details of collection schemes in your area. In all circumstances:

- Do not dispose of in domestic waste.
- Do not incinerate.



WARRANTY

Please retain a proof of purchase receipt or statement as proof of the purchase date. The warranty only applies if the product is used solely in the manner indicated in the Warnings page of this manual, and all other instructions have been followed accurately. Any abuse of the product or the manner in which it is used will invalidate the warranty.

Returned goods will not be accepted unless repackaged in its original packaging and accompanied by a relevant and completed returns form. This does not affect your statutory rights. No rights are given under this warranty to a person acquiring the product second-hand or for commercial or communal use.

COMPONENTS

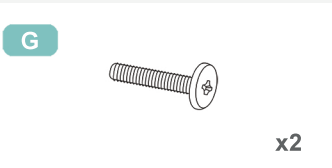
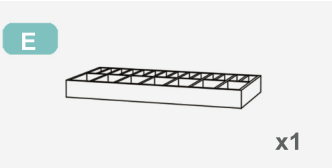
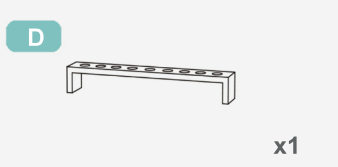
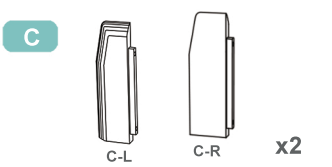
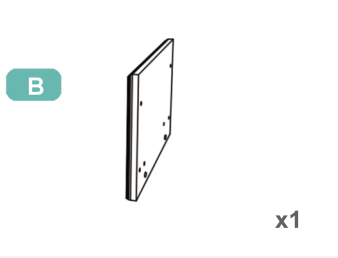
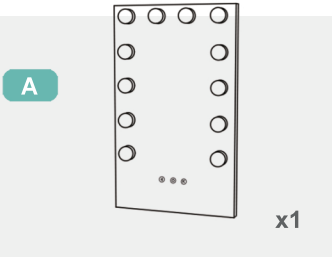

ASSEMBLY STEPS- FOR DOOR MOUNTING

STEP 1

- B** X1
- C** X2
- F** X4

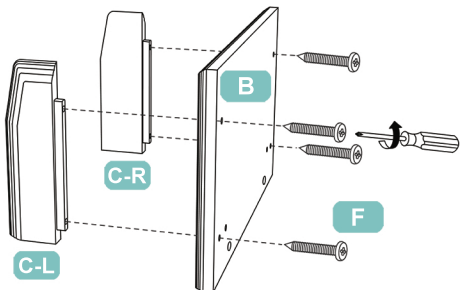

STEP 2

A X1

G X2

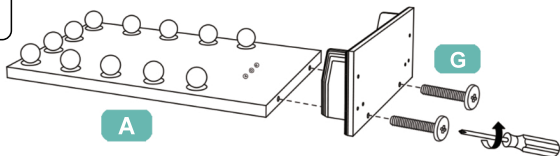

STEP 3

D X1

F X2

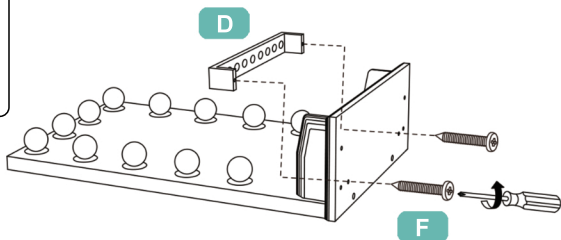

STEP 4

E X1

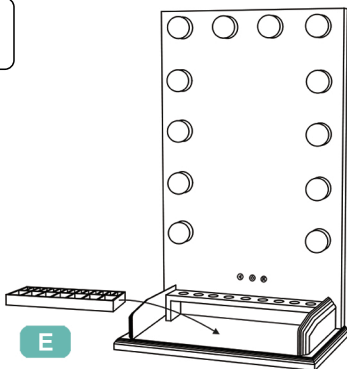

STEP 5

G X1



USB Socket



Power Bank





USB HUB

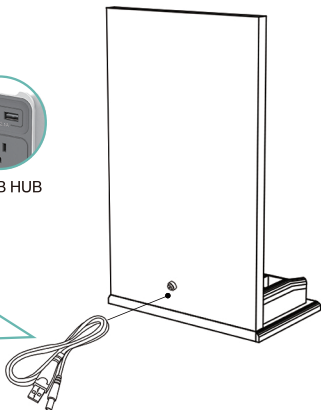

USB CABLE



- Plug the USB cable into the back of the mirror and power source (Output of adaptor needs to be 5V 2A) 
- Press the middle touch sensor located at the front to Power on the LED Lights
- Press the left button  to select the brightness of your choice. Press and hold after powering on. This action will initiate LED lights to change brightness.
- Press the right button  to select your desired color temperature or press and hold to change color temperature gradually.
- If the touch switch is not functioning properly, reset the chip by removing power for a few seconds only.

