

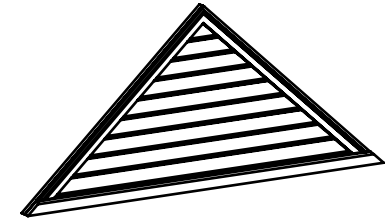

Technical drawing of a roof truss cross-section. The drawing shows a triangular truss structure with a base of 64" and a height of 29 3/8". The truss is filled with horizontal hatching. The base is divided into two segments: 5 1/8" on the left and 53 3/4" on the right. The height is divided into two segments: 24 5/8" on the left and 2 3/4" on the right. The angle of the roof slope is 42.55deg. The drawing includes dashed lines for dimensioning and a solid line for the truss structure.

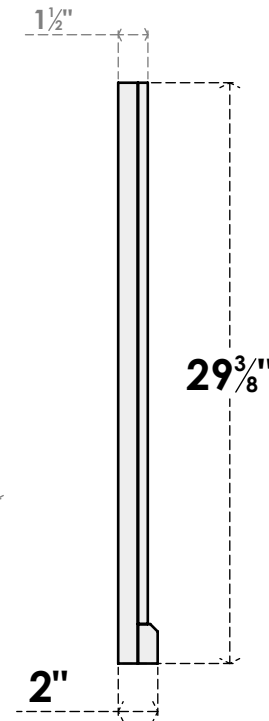

SIDE

VENTING AREA: 53.73 SQ IN
LOUVER HEIGHT: 2 3/4"
LOUVER QTY: 9

5. ARCHITECTURAL GRADE PVC PRODUCTS ARE MADE FROM EXPANDED CELLULAR PVC AND COME NATURALLY WHITE BUT MAY BE PAINTED

Generated Date : 08/23/2022