

The furniture finishing is obtained by painting in polyester and drying it in ultra-violet system.

Terminaciones de los muebles son obtenidos con pintura de poliéster y es secada a través del método ultravioleta.

Confiera la cantidad de volúmenes del producto. Identifique y separe las piezas.

Check the amount of volumes of the product. Identify and separate parts.

For cleaning do not use chemicals, use a damp and a dry cloth. When assembling, we suggest you to use the cartoon packing in the floor to protect the furniture

No utilizar productos químicos para la limpieza, utilizar un pañuelo húmedo y después un seco Para protección del producto, sugerimos que la propia caja sea utilizada para cubrir el suelo.

TV BOARD 70" WITH SHELF

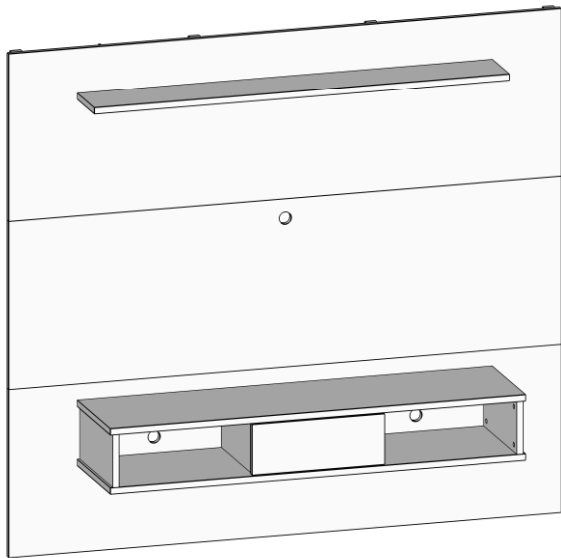

Parts identification Seq.

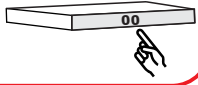

Seq.	Code	Description	Qty
1	I-DIV0089	Left division/División izquierda 13"1/8 X 6"3/4 X 3/4	1
2	I-DIV0091	Right division/División derecha 13"1/8 X 6"3/4 X 3/4	1
3	I-DIV0093	Division/División 13"3/4 X 6"3/4 X 3/4	2
4	I-COS0173	Back panel of drawer/Cajón inferior 13"3/4 X 3"3/4 X 5/8	1
5	I-BAS0199	Base/Base 53"1/8 X 13"3/4 X 3/4	2
6	I-PRA0086	Top shelf/Estante 53"1/8 X 7"1/8 X 3/4	1
7	I-LAT0295	Side of drawers/Cajón lateral 11"1/4 X 4"1/2 X 5/8	2
8	I-FUN0049	Bottoms of drawers/Fondo del cajón 13"1/8 X 12"1/4 X 1/8	1
9	I-TRA0134	Side cross/Travessa lateral 20"1/2 X 1"3/8 X 3/4	2
10	I-TRA0135	Side cross/Travessa lateral 43"1/4 X 1"3/8 X 3/4	2
11	I-TRA0136	Center cross/Travessa central 20"1/2 X 1"3/8 X 3/4	1
12	I-TRA0137	Center cross/Travessa central 43"1/4 X 1"3/8 X 3/4	2
13	I-SUP0006	Support/Soporte 4" X 3"1/4 X 3/4	8
14	I-FTE0056	Front of drawer/Frente del cajón 17" X 6"3/8 X 5/8	1
15	I-PAN0235	Top panel/Panel superior 70"5/8 X 21"1/4 X 5/8	1
16	I-PAN0236	Center panel/Panel central 70"5/8 X 21"1/4 X 5/8	1
17	I-PAN0237	Back panel/Panel inferior 70"5/8 X 21"1/4 X 5/8	1

Observe the finish on the side of the workpiece (9 and 10).

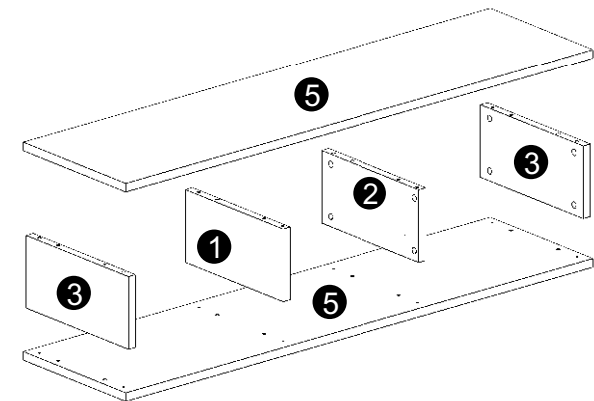
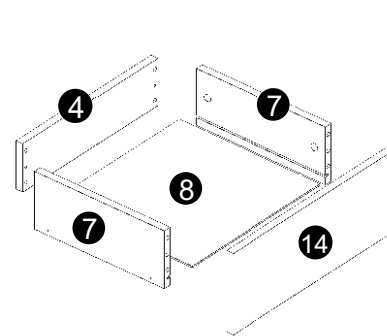
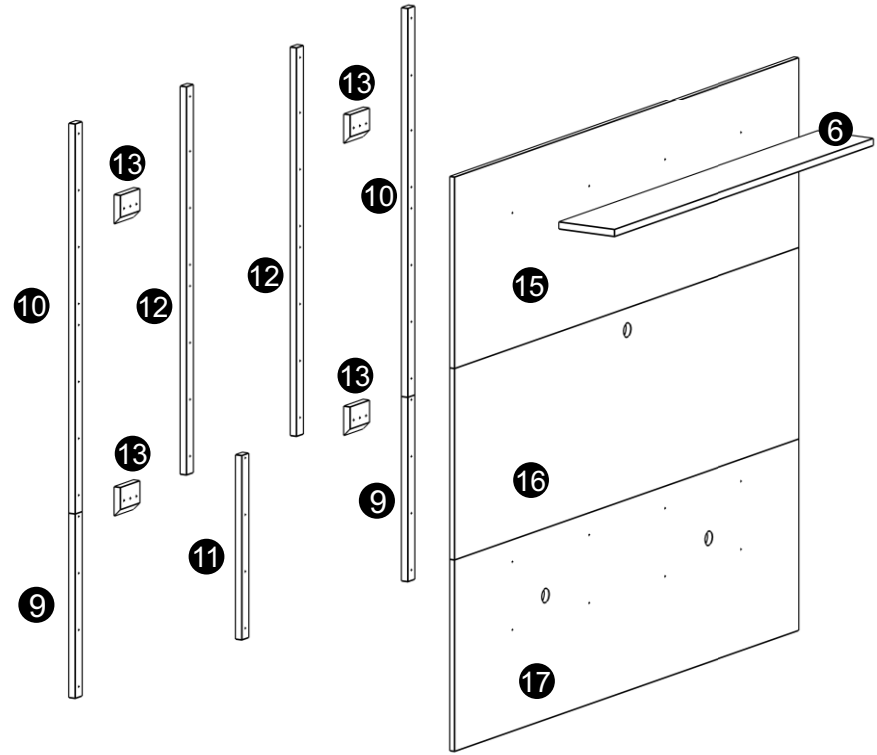

You will need:
Usted necesitará:



This piece of furniture is made with **non-toxic** materials. Light odor could be noticed upon opening the box due to the nature of the packaging but it will dissipate quickly after assembly.

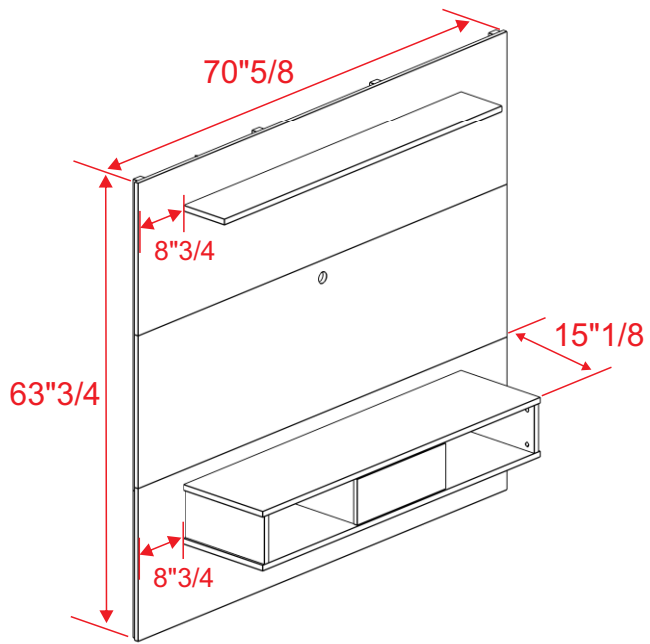

1.

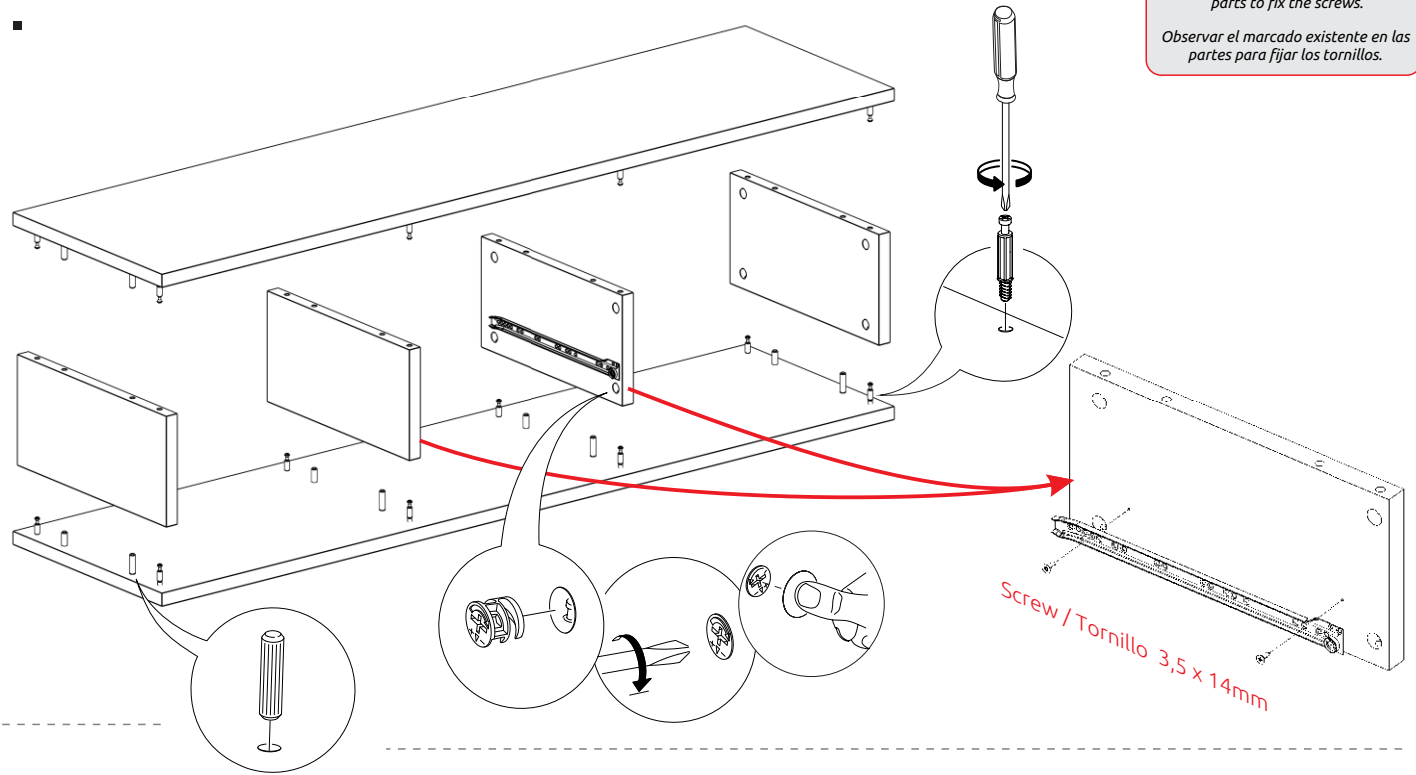

Observe the existing markup on the parts to fix the screws.
 Observar el marcado existente en las partes para fijar los tornillos.

2.

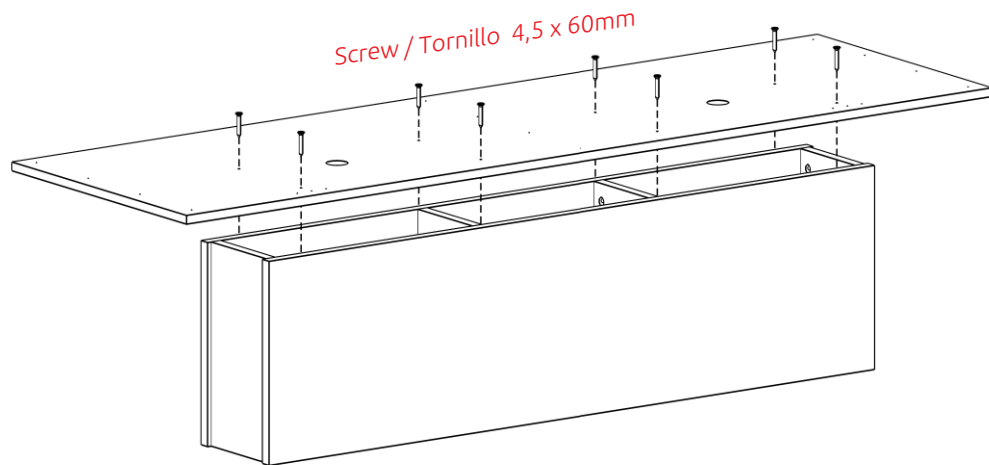

3.

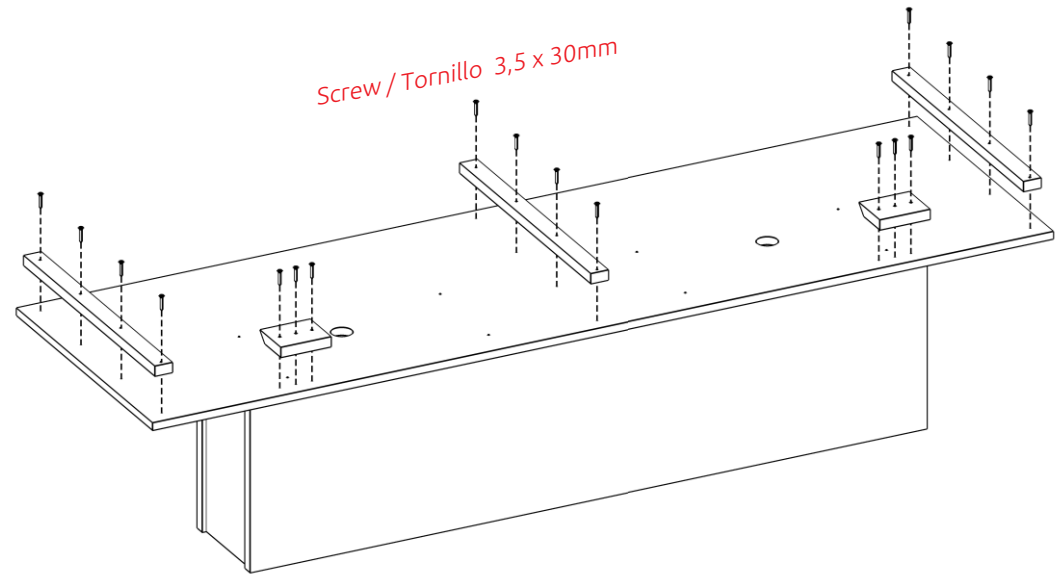

4.

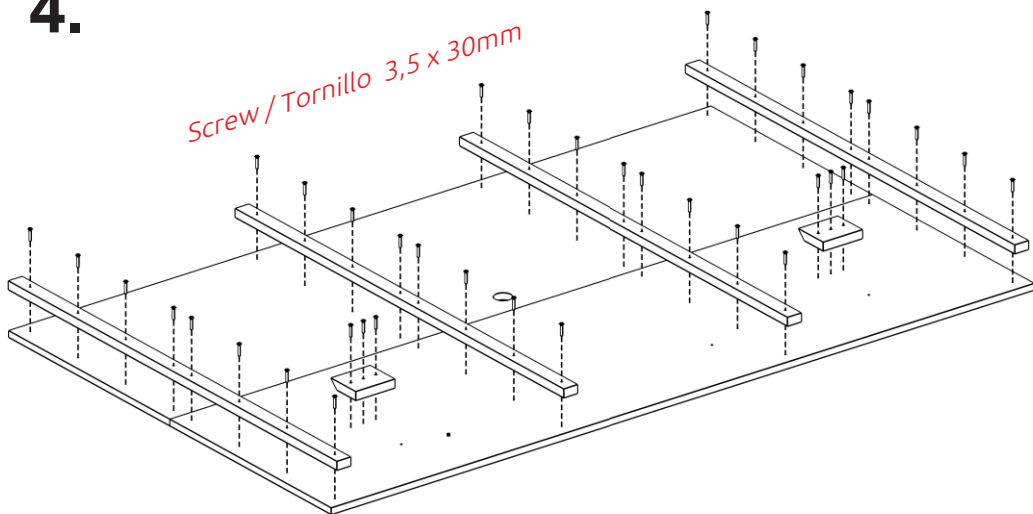

5.

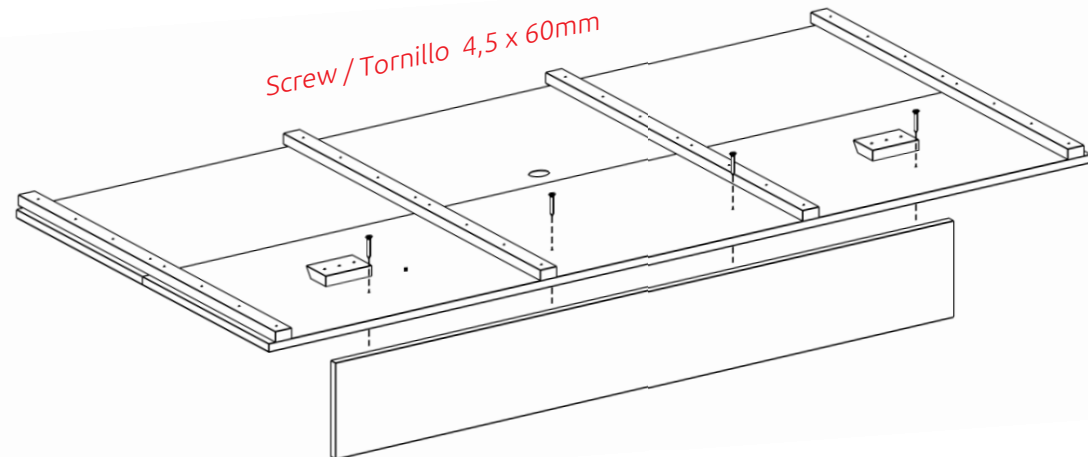

6.

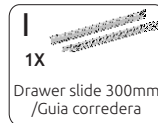
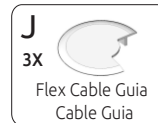
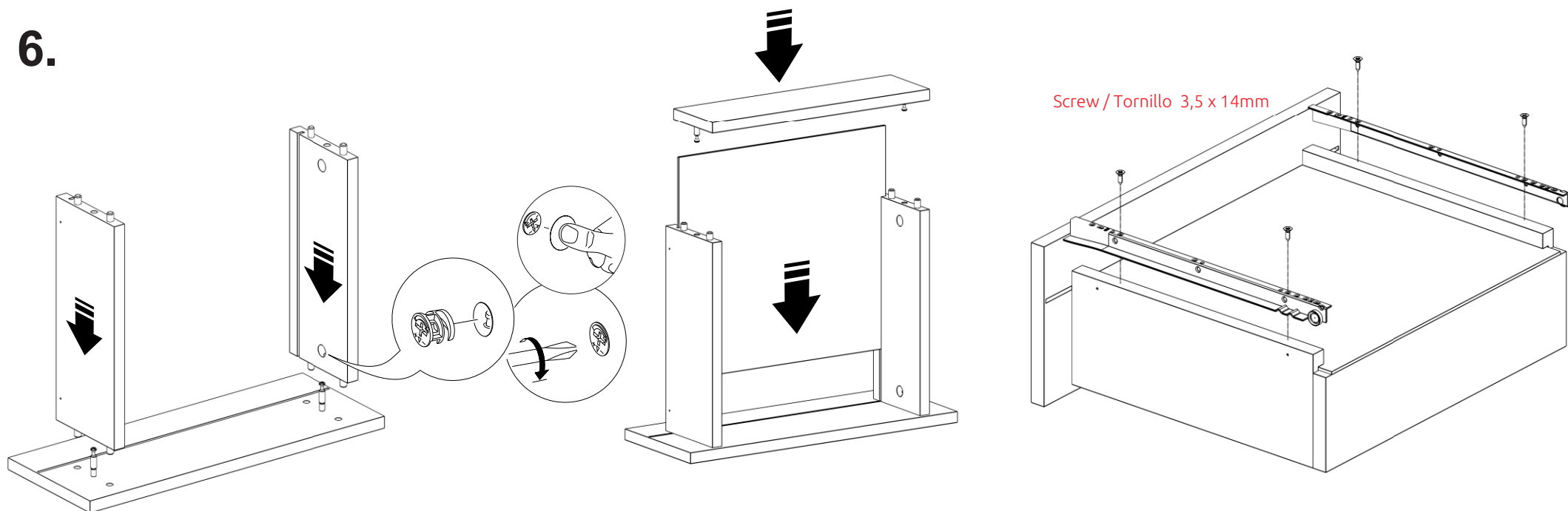

Observe the existing markup on the parts to fix the screws.
Observar el marcado existente en las partes para fijar los tornillos.

7.

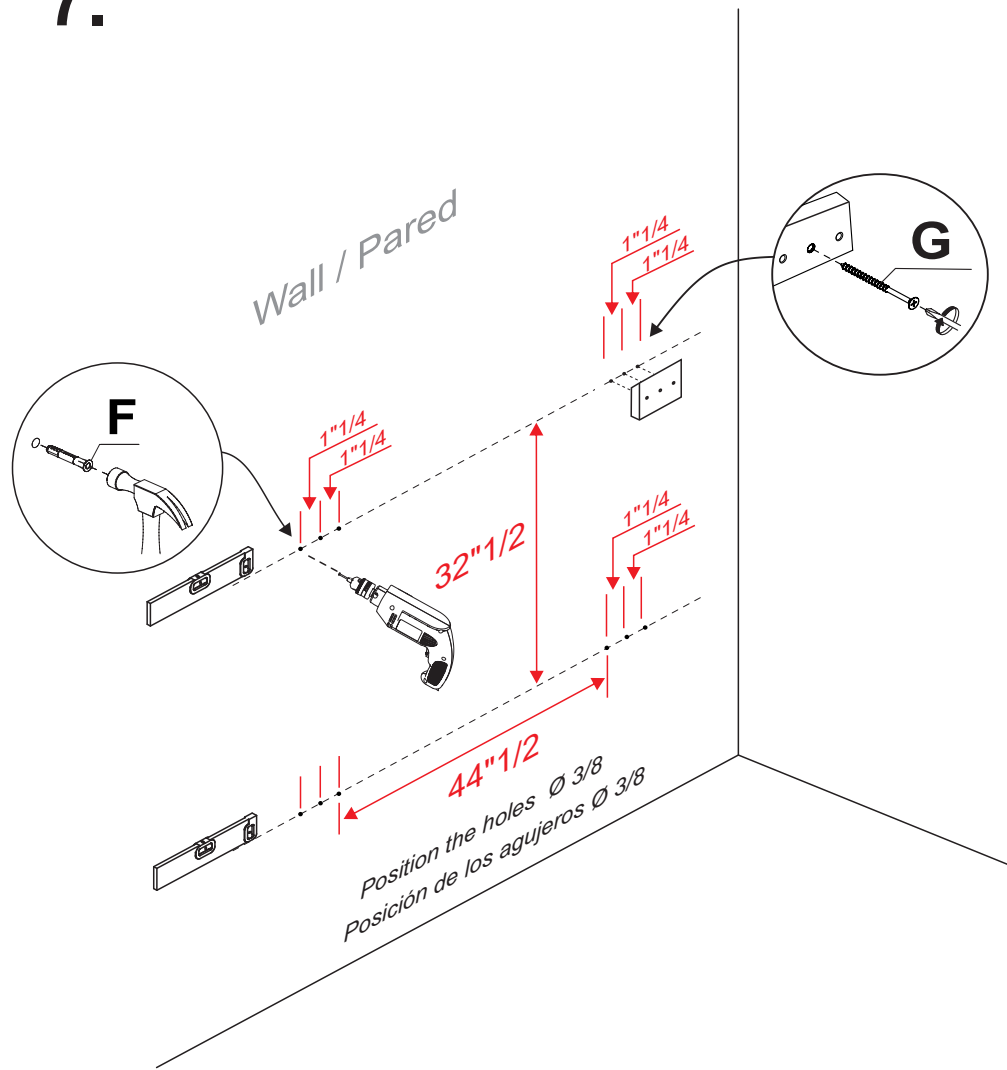

Recommended for masonry walls
Recomendado para pared de concreto

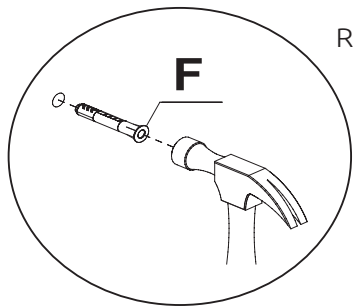

8.

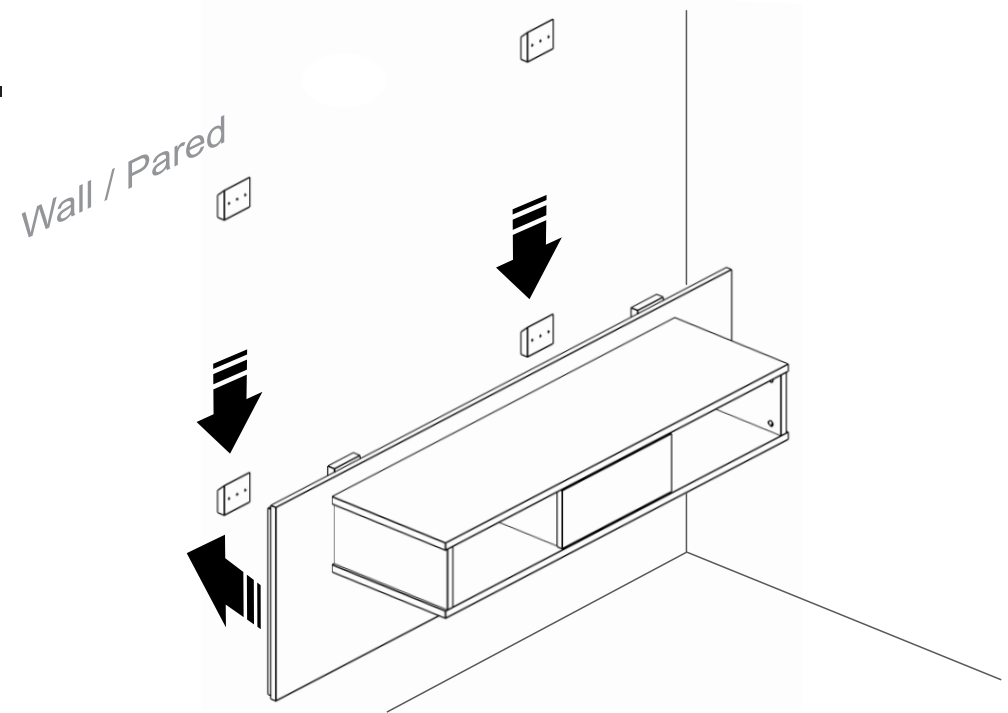

9.

