

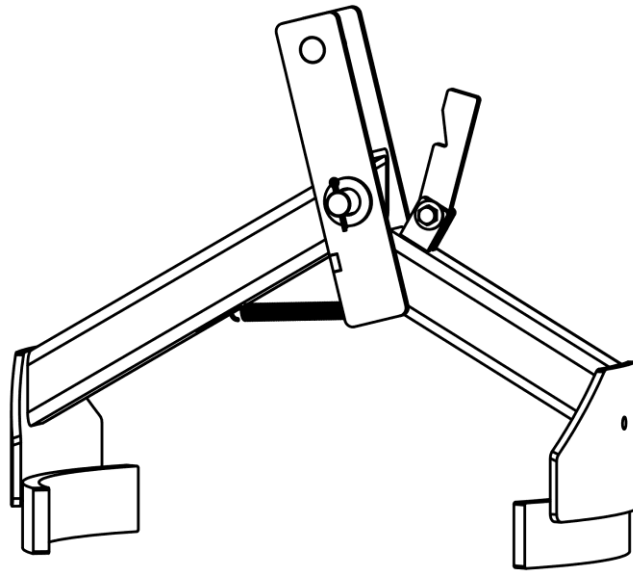

Vestil Manufacturing Company
 2999 North Wayne Street, P.O. Box 507, Angola, IN 46703
 Telephone: (260) 665-7586 -or- Toll Free (800) 348-0868
 Fax: (260) 665-1339
 Website: www.vestil.com e-mail: info@vestil.com

DCL-Series Drum Carriers



Receiving Instructions

After delivery, remove the packaging from the product. Inspect the product closely to determine whether it sustained damage during transport. If damage is discovered, record a complete description of it on the bill of lading. If the product is undamaged, discard the packaging.

NOTE: The end-user is solely responsible for confirming that product design, use, and maintenance comply with laws, regulations, codes, and mandatory standards applied where the product is used.

Technical Service & Replacement Parts

For answers to questions not addressed in these instructions and to order replacement parts, labels, and accessories, call our Technical Service and Parts Department at (260) 665-7586. The department can also be contacted online at <https://www.vestil.com/page-parts-request.php>.

Electronic Copies of Instruction Manuals

Additional copies of this manual may be downloaded from <https://www.vestil.com/page-manuals.php>.

Table of Contents		Page
1. Product Information.....		2
2. Regulatory and Consensus Standards.....		2
3. Receiving Instructions.....		2
4. Signal Words.....		2
5. Safety Instructions.....		3
6. Record of Satisfactory Condition.....		3
7. Specifications.....		4
8A. DCL-550 Exploded View and Bill of Materials.....		5
8B. DCL-1000 Exploded View and Bill of Materials.....		5
9. Using the Drum Lifter.....		6
10. Inspections		7
11. Maintenance.....		7
12. Labeling Diagram.....		7
13. Limited Warranty.....		8

1. PRODUCT INFORMATION

DCL Series Drum Lifters are mechanical below-the-hook lifting devices. They are designed for use with overhead hoists or lift trucks (e.g. forklifts). These drum lifters are intended to safely lift, transport, and position steel drums (not plastic or fiber drums) having a top lip or chime. Not for use with open-head drums. Units feature spring-biased arms that automatically close. This ensures that the arms solidly engage the intact top chime of a drum. Each unit is constructed from durable steel covered with a powder-coat finish for corrosion resistance. Drum lifters are suitable for unclassified industrial environments such as warehouses and manufacturing facilities.

- **Models Available:**
 - DCL-550: Designed for 30-gallon steel drums; uniform capacity 550 lb. (250 kg).
 - DCL-1000: Designed for 55-gallon steel drums; uniform capacity 1,000 lb. (454 kg).
- **Materials:** Welded steel construction with hardened steel jaws.
- **Finish:** Blue powder coat.
- **Lifting Mechanism:** Compatible with standard hoist hooks via integrated lifting eye.
- **Intended Use:** For lifting and transporting closed-head, rimmed steel drums only. Not suitable for open-head drums, plastic/fiber drums, or damaged/leaking containers.
- **Options:** Custom configurations available, such as extended reach or specialized jaw coatings.

2. REGULATORY AND CONSENSUS STANDARDS

This product is designed, tested, and manufactured to meet or exceed the following regulatory and US national consensus standards for below-the-hook lifting devices:

- **ASME B30.20:** Below-the-Hook Lifting Devices – Governs design, marking, construction, installation, inspection, testing, maintenance, and operation of lifting devices used with hoists or cranes.
- **OSHA 29 CFR 1910.179:** Overhead and Gantry Cranes – Applies to the use of this device in conjunction with overhead lifting equipment, including requirements for inspections, operator training, and safe operation.
- **AWS D14.1:** Specification for Welding of Industrial and Mill Cranes and Other Material Handling Equipment – Ensures structural integrity of welded components.

Regular inspections and maintenance must align with these standards to maintain safety and warranty validity.



Users should also comply with all applicable federal, state, and local regulations, including OSHA general duty clause (29 CFR 1910.132), regarding personal protective equipment and hazard assessments. Vestil recommends consulting qualified professionals for site-specific compliance evaluations.

3. RECEIVING INSTRUCTIONS

After delivery, IMMEDIATELY remove packaging from the product and inspect it closely. Compare the condition of all product parts to the parts list and exploded view diagram. If damage occurred during shipping, do NOT use the product. Contact the freight carrier to file a damage claim and notify your distributor or Vestil Manufacturing Co. for assistance. Retain all packaging until the product is inspected and found to be undamaged or until the freight claim is resolved.

4. SIGNAL WORDS

SIGNAL WORDS in this manual draw the reader's attention to important safety-related messages.

 DANGER	Identifies a hazardous situation which, if not avoided, <u>WILL</u> result in DEATH or SERIOUS INJURY. Use of this signal word is limited to the most extreme situations.
 WARNING	Identifies a hazardous situation which, if not avoided, COULD result in DEATH or SERIOUS INJURY.
 CAUTION	Indicates a hazardous situation which, if not avoided, COULD result in MINOR or MODERATE injury.
NOTICE	Identifies practices likely to result in product/property damage, such as operation that might damage the product.

5. SAFETY INSTRUCTIONS

Vestil strives to identify foreseeable hazards associated with the use of its products. However, no manual can address every conceivable risk. The end-user is responsible for conducting a hazard analysis before every use and must exercise sound judgment at all times. Only trained persons should use this device. Read and understand the entire manual before using, inspecting, or servicing this product. If you do not understand any instruction, contact Vestil for clarification. Failure to adhere to the following guidelines could result in serious personal injury or even death.

⚠ DANGER

Electrocution risk!

- Inspect the usage area for overhead wires and electric appliances prior to beginning work.
- DO NOT contact electrified wires or electric appliances with any part of this device, the drum, or the lifting apparatus.

⚠ WARNING

Improper or careless operation of this device could result in serious personal injuries or death.

- ALWAYS inspect the unit before each use as described in the "Inspections" section. DO NOT use the product unless it is in satisfactory condition. See [RECORD OF SATISFACTORY CONDITION](#) on p. 3.
- DO NOT lift loads over people.
- DO NOT lift loads higher than necessary to clear obstacles during transport.
- ALWAYS watch the assembly and load carefully when it is in motion.
- DO NOT use the product if it is structurally unsound or damaged in any way.
- DO NOT lift loads that exceed the rated capacity (DCL-550: 550 lb.; DCL-1000: 1,000 lb.).
- DO NOT lift a load higher than necessary. See [USING THE LIFTER](#) on p. 6.
- DO NOT lift or transport loads until all persons are clear of the product and load.
- DO NOT stand beneath or travel under the DCL or any suspended load.
- DO NOT lift loads over people.
- DO NOT modify the product in any way without first obtaining written authorization from Vestil. Unauthorized modifications void the [LIMITED WARRANTY](#) and might make the lifter unsafe to use.
- DO NOT get in front of or behind a suspended load while moving it. Stand to the side of the drum while moving it.
- DO NOT leave an elevated drum unattended.
- Review instruction manuals for your crane, hoist and any other equipment used in conjunction with the drum carrier. ALWAYS confirm that the hoist/crane and all other equipment used with this product are in satisfactory condition before each use.
- DO NOT use this product to lift anything other than an intact, undamaged, rimmed steel drum with a chime (not for open-head drums). Only engage the top rim with the lifter.
- DO NOT lift drums that are damaged, leaking, or otherwise compromised.
- DO NOT lift a drum lying on its side.
- DO NOT sit on or apply any weight/pressure to a suspended drum.
- DO NOT use the product if any product label is unreadable or missing. Contact Vestil to order replacement labels.
- ALWAYS attach this device to a hoist or crane that is properly rated for the combined weight of the device and the maximum rated load.
- ALWAYS maintain contact with the ground/floor with at least one leg during the entire loading/unloading process to enhance stability.

6. RECORD OF SATISFACTORY CONDITION

Before using the drum lifter for the first time, create a written record that describes the appearance, sound, and feel of the product in satisfactory (undamaged) condition. Thoroughly photograph and describe the device from multiple vantage points, including all contact surfaces, jaws, pivot points, welds, pins, and hardware. Collect the writings and photographs in a file. This record establishes "satisfactory condition" of the lifter. Compare inspection results to this record to determine whether a component is in satisfactory condition or requires repair/replacement. Purely cosmetic changes, like chipped paint, are not changes from satisfactory condition. However, touchup paint should be applied to all affected areas as soon as cosmetic damage occurs to prevent rusting.

7. SPECIFICATIONS

Documents that provide specifications for DCL series drum lifters are available online to anyone who visits Vestil's website. Specifications include dimensions, net weight, and capacity information. Navigate to <https://www.vestil.com/product.php?FID=82>. Scroll to the MODEL CHART portion of the page. Find the entry for the lifter you purchased and click the button in the "PDF" column that looks like a pencil inside a blue-bordered box. A PDF file will open. This file is the specifications document. Print a copy of the document and keep it with your copy of this manual. The following is an exemplar specifications document for model DCL-550. All dimensions and weights are approximate and subject to manufacturing tolerances ($\pm 1/4"$ (0.64 cm)).

DRUM CLUTCH - DCL-550

APPROX WEIGHT: 22.04 lbs.
DOES NOT INCLUDE WEIGHT OF POWER OR PACKAGING!!!

ANY ADDITIONS, DELETIONS, OR OMISSIONS MUST BE CORRECTED ON THIS DRAWING AS THIS DRAWING WILL BE CONSIDERED ALL INCLUSIVE

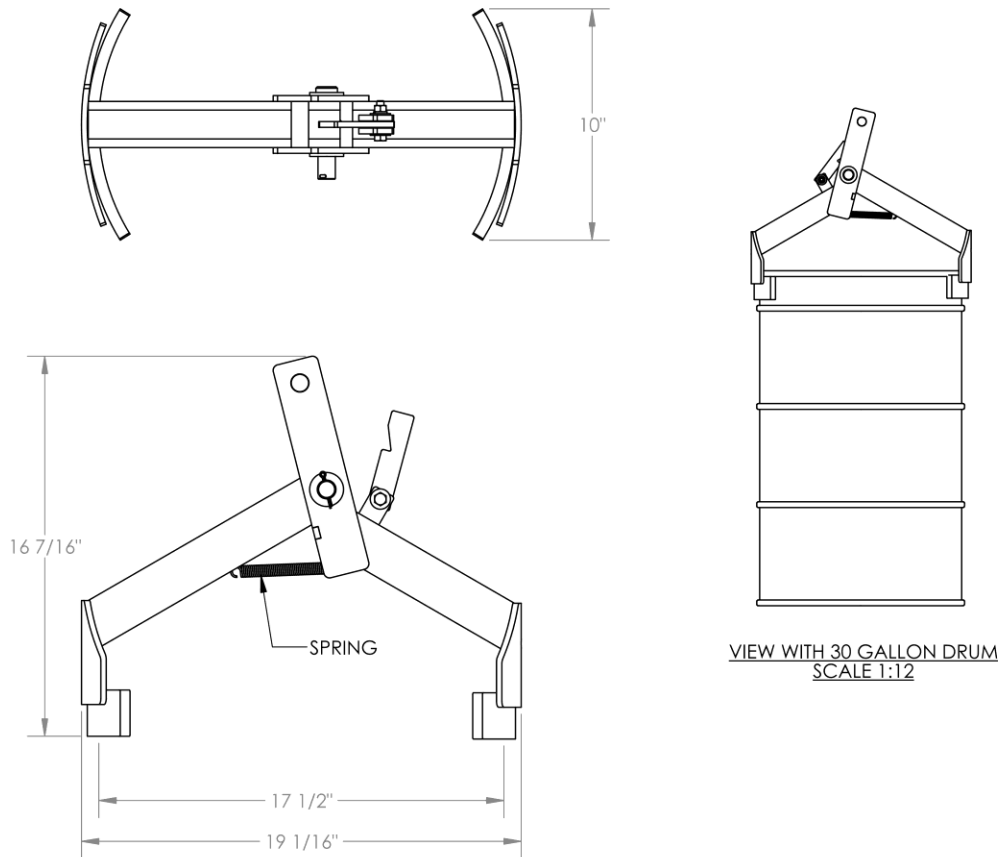

ALL GRAPHICS PROVIDED ARE FOR REFERENCE ONLY. IF CERTAIN DIMENSIONS ARE CRITICAL PLEASE VERIFY THOSE DIMENSIONS WITH YOUR SALESPERSON

DIMENSION TOLERANCE $\pm 1/4"$

STANDARD FEATURES

- MODEL NUMBER IS DCL-550
- CAPACITY IS 550 LBS.
- OVERALL WIDTH IS 10"
- USABLE WIDTH IS 10"
- OVERALL LENGTH IS 19 1/16"
- USABLE LENGTH IS 17 1/2"
- OVERALL HEIGHT IS 16 7/16"
- ACCEPTS 30 GALLON STEEL DRUMS
- SPRING LOADED ARMS
- DURABLE BAKED IN POWDER COATED BLUE FINISH

SPECIAL FEATURES

NONE

APPROVAL

I, THE UNDERSIGNED, AGREE THAT THE PRODUCT AS REPRESENTED SATISFIES DESIGN AND DIMENSION REQUIREMENTS. I ALSO ACKNOWLEDGE MY DUTY TO CONFIRM PRODUCT AND INSTALLATION COMPLIANCE WITH ALL APPLICABLE FEDERAL, STATE AND LOCAL REGULATIONS AND STANDARDS.
UNITS REQUIRING APPROVAL DRAWINGS OR MODIFIED ARE NON-RETURNABLE
[] As drawn [] As marked

Signed: _____ Date: _____

Printed Name: _____

LEAD TIME WILL START UPON RECEIPT OF SIGNED APPROVAL DRAWING

DISTRIBUTOR'S NAME:		P.O.#
VESTIL MANUFACTURING		X
DRAWN BY: FS		W.O.#
DATE: 6/20/2014		X
REFERENCE: X	SCALE: 1:6	SALES: X
QUOTED LEAD TIME: X	QUOTE # X	FILE NAME:
		09-007-002

8A: DCL-550 EXPLODED VIEW AND BILL OF MATERIALS (09-006-002)

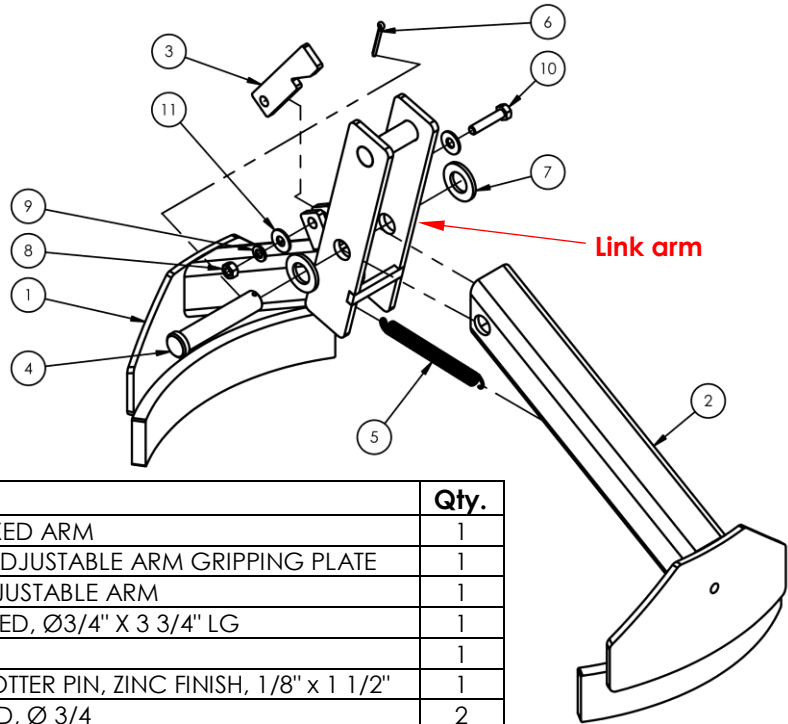

Item	Part no.	Description	Qty.
1	09-514-002	ASSEMBLY, FRAME, FIXED ARM	1
2	09-514-005	WELDMENT, FRAME, ADJUSTABLE ARM GRIPPING PLATE	1
3	09-037-001	RETAINING LOCK, ADJUSTABLE ARM	1
4	33-112-034	CLEVIS PIN, ZINC PLATED, Ø3/4" X 3 3/4" LG	1
5	99-146-027	SPRING, 5" LONG	1
6	65078	EXTENDED PRONG COTTER PIN, ZINC FINISH, 1/8" x 1 1/2"	1
7	33092	FLAT WASHER Z-PLATED, Ø 3/4	2
8	36104	HEX NUT, GRADE A, ZINC PLATED, 5/16-18	1
9	33620	LOCK WASHER, MEDIUM SPLIT, Ø5/16"	1
10	11059	Ø5/16-18 UNC x 1-1/2 LG, Z-PLATED, #2, GRADE A	1
11	33006	FLAT WASHER,ZINC PLATED,USS, Ø5/16"	2

8B: DCL-1000 EXPLODED VIEW AND BILL OF MATERIALS (09-006-186)

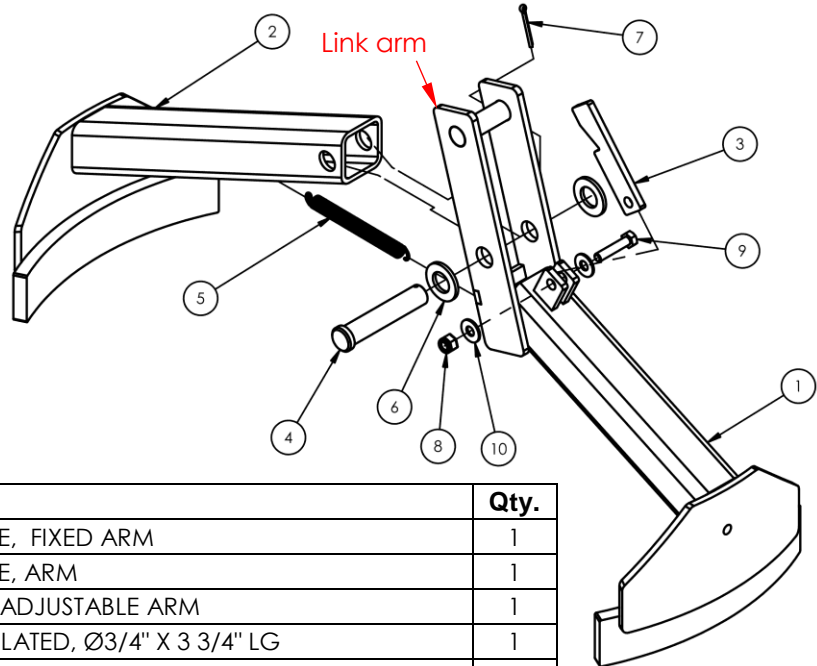

Item	Part no.	Description	Qty.
1	09-514-033	WELDMENT, FRAME, FIXED ARM	1
2	09-514-032	WELDMENT, FRAME, ARM	1
3	09-037-001	RETAINING LOCK, ADJUSTABLE ARM	1
4	33-112-034	CLEVIS PIN, ZINC PLATED, Ø3/4" X 3 3/4" LG	1
5	99-146-027	SPRING, 5" LONG	1
6	33092	FLAT WASHER Z-PLATED, Ø 3/4	2
7	65078	EXTENDED PRONG COTTER PIN, ZINC FINISH, 1/8" x 1 1/2"	1
8	37021	NYLON INSERT LOCK NUT, GRADE 2, ZINC FINISH, 5/16"-18	1
9	11059	Ø5/16-18 UNC x 1-1/2 LG, Z-PLATED, #2, GRADE A	1
10	33006	FLAT WASHER,ZINC PLATED,USS, Ø5/16"	2

9. USING THE DRUM LIFTER

⚠ WARNING

DO NOT attempt to lift or transport a drum with the DCL if a secure grasp on the rim cannot be achieved.

NOTE: This product complies with [ASME B30.20](#) standards for below-the-hook lifting devices. Users must also comply with all applicable OSHA regulations, including but not limited to 29 CFR 1910.179 (Overhead and Gantry Cranes) and 29 CFR 1910.184 (Slings), as well as all applicable state and local codes, rules, ordinances, etc.

DCL-series drum carriers are “below-the-hook” (BTH) lifting devices. American National Standard ASME B30.20 provides information about the use and maintenance of BTH devices. Vestil recommends that you acquire [a copy of ASME B30.20](#) and apply the use and maintenance recommendations applicable to “Structural and Mechanical Lifting Devices”. Instructions in this manual are intended to supplement the content of the standard.

Only trained, designated persons should operate this device. Training should include hands-on instruction for attaching the lifter to a hoist or forklift lifting attachment, engaging/disengaging drums, and transporting loads.

- 1. Inspect Drum and Lifter:** Inspect the drum and the drum lifter. Confirm that the rim is intact and structurally sound. Remove all debris built up around the rim of the drum that might interfere with or prevent the drum lifter from securely engaging the rim. Visually inspect the lifter to confirm that all parts are in satisfactory condition. The drum must be in an upright position for the lifter to properly engage the rim. DO NOT attempt to lift a drum lying on its side because the drum will swing as it is lifted off of the ground. Being struck by a swinging drum could result in serious injuries.
- 2. Attachment to Hoist or Fork Truck:** Confirm that your hoist or fork attachment is rated for at least the combined weight of the lifter and the maximum rated load of the lifter. Attach the lifting eye of the drum lifter to your hoist hook or to the hook of your fork attachment.
- 3. Positioning:** Raise the lifter and center it over the top of the drum. Then, open the arms by moving the link arm in the **OPEN** direction. Lower the lifter over the top of the drum. Engage the chime (top lip) of the drum with the rim supports (of the lifter). The spring causes the arms to automatically **CLOSE** under the rim as the hoist chain slackens (or forks are lowered).
- 4. Engagement Check:** Lift the drum a few inches off the ground. Verify that both rim supports securely engage the chime. If not, lower the drum to the ground and reposition the lifter. Do not use the lifter to move a drum unless secure connections can be made.
- 5. Lifting and Transport:** Raise the drum to the minimum height necessary to clear obstacles. Transport slowly, keeping the load stable and close to the ground where possible. Avoid sudden starts, stops, or turns. If using a manual hoist, stand to the side of the drum while moving it. Make sure that your clothing, feet, and all other parts of your body stay out from underneath the drum and do not become tangled in the carrier, chain/cable, etc. If using a forklift, apply the brakes gradually and reduce speed during all turns. **DO NOT leave a suspended load unattended.**
- 6. Lowering and Disengagement:** Make sure that the drum is not swinging or rotating. Then, slowly lower the drum onto a stable, level surface. Once the hoist chain (or forklift lifting attachment) is slackened, disengage the arms from the drum rim/chime. Raise the lifter off of the drum.

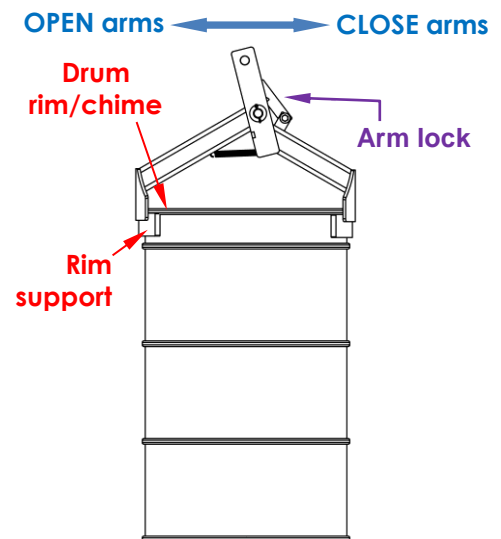

10. INSPECTIONS

Inspections should only be performed by qualified personnel. There are 3 categories of inspections, which are described below. Compare all inspection results to the [RECORD OF SATISFACTORY CONDITION](#). See section 6 on p. 3. Do not use the lifter unless all parts are in satisfactory condition. Replace parts that are not in satisfactory condition before returning the unit to service. Only use manufacturer-approved replacement parts to restore the unit to satisfactory condition. *Never make temporary repairs of damaged or missing parts. DON'T GUESS! If you have any questions about the condition of your lifter, contact the TECHNICAL SERVICE department.* The phone number is provided on the cover page of this manual.

- **Before Each Use:** Examine for damage, deformation, cracks, corrosion, or wear on arms, pivot points, lifting eye, and welds. Check that arms open and close freely. Ensure labels are readable. Confirm hoist connection is secure. DO NOT use if issues are found.
- **Frequent Inspections** (at least monthly for normal service; weekly for severe service): Performed by the operator. Inspect all features, fasteners, and contact surfaces. Look for excessive wear, loose parts, or unusual sounds.
- **Periodic Inspections** (at least annually for normal service; quarterly for severe service): Disassemble as necessary to inspect internal components. Check for cracks using non-destructive testing if required. Document results.

Repair or replace damaged components immediately. Only use manufacturer-approved replacement parts. If a lock nut is unfastened, it *must* be replaced with a new, unused lock nut.

11. MAINTENANCE

Regular maintenance is essential for preserving the safety, and extending the usable lifetime, of the lifter. Compare the results of each inspection to your [RECORD OF SATISFACTORY CONDITION](#).

- **Step 1:** Tag the unit "Out of Service."
- **Step 2:** Conduct a "Before Each Use" inspection. If issues exist, perform necessary adjustments, repairs, and/or replace damaged parts.
- **Step 3:** Lubricate all moving parts (jaws, pivots) with light machine oil or grease monthly or as needed. Remove excess lubricant.
- **Step 4:** Perform a load test if repairs affect load-bearing components, per ASME B30.20 (proof test to 125% of rated capacity).
- **Step 5:** Create a dated, written record describing the maintenance performed and parts replaced. Add to the file for this device.

Contact Vestil for approved replacement parts or technical assistance.

12. LABELING DIAGRAM

Each unit should be labeled as shown in the diagram. However, label content and locations are subject to change so your product might not be labeled exactly as shown. Compare the diagram below to your [RECORD OF SATISFACTORY CONDITION](#). If there are any differences between actual labeling and this diagram, adapt the diagram to reflect actual labeling. Replace all labels that are damaged, missing, or not easily readable (e.g. faded). To order replacement labels or to inquire whether your unit is properly labeled, contact the [TECHNICAL SERVICE AND PARTS DEPARTMENT](#) online at <https://www.vestil.com/page-parts-request.php> or by calling (260) 665-7586 and asking for the Parts Department.

A: Tag 993

Model No. _____	Serial No. _____
No. Modelo _____	No. Serie _____
Capacity _____ lbs.	Lifter Weight _____ lbs.
Capacidad _____ kgs.	Peso del Elevador _____ kgs.
BTH-1 Design Category: B	BTH-1 Service Category: 1
BTH-1 Categoría de Diseño: B	BTH-1 Categoría de Servicio: 1
Read Owners Manual for product safety warnings	
Lea Manual de Proprietarios para advertencias de seguridad de producto	

⚠ WARNING	⚠ ADVERTENCIA
<ul style="list-style-type: none"> • DO NOT exceed rated capacity • DO NOT use if damaged, malfunctioning, or missing parts • DO NOT lift people OR lift loads over people • DO NOT raise load higher than necessary • DO NOT leave a suspended load unattended • DO NOT use lifter unless you read and understand the owner's manual • DO NOT alter OR modify lifter • DO NOT remove OR obscure any label • STAY CLEAR of suspended loads • Secure load before using this device 	<ul style="list-style-type: none"> • NO exceda la capacidad tasada • NO USE si las partes estan dañadas, no funcionan correctamente o faltan partes. • NO eleve al personal o eleve cargas sobre el personal • NO eleve la carga mas alto de lo necesario • NO deje desatendida una carga que este suspendida • NO use el elevador a no ser que haya leído y entendido las instrucciones del manual del propietario • NO altere o modifique el elevador • NO quite u obscurezca ninguna etiqueta • MANTENGASE alejado de las cargas suspendidas • Asegure la carga antes de usar este dispositivo

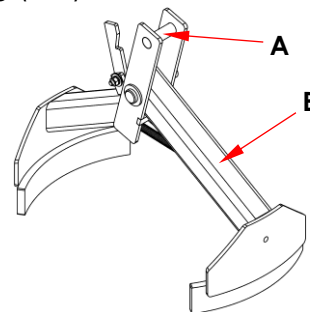

B: Label 643

⚠ WARNING	⚠ ADVERTENCIA	⚠ AVERTISSEMENT
KEEP CLEAR OF PINCH POINT	MANTENGASE ALEJADO DEL PUNTO DE CORTE	SE TENIR A DISTANCE DU POINT DE PINCEMENT

13. LIMITED WARRANTY

Vestil Manufacturing Company ("Vestil") warrants this product to be free of defects in material and workmanship during the warranty period. Our warranty obligation is to provide a replacement for a defective, original part covered by the warranty after we receive a proper request from the Warrantee (you) for warranty service.

Who may request service?

Only a warrantee may request service. You are a warrantee if you purchased the product from Vestil or from an authorized distributor AND Vestil has been fully paid.

Definition of "original part"?

An original part is a part used to make the product as shipped to the Warrantee.

What is a "proper request"?

A request for warranty service is proper if Vestil receives: 1) a photocopy of the [Customer Invoice](#) that displays the shipping date; AND 2) a written request for warranty service including your name and phone number. Send requests by one of the following methods:

<u>US Mail</u>	<u>Fax</u>	<u>Email</u>
Vestil Manufacturing Co. 2999 North Wayne Street, PO Box 507 Angola, IN 46703	(260) 665-1339 <u>Phone</u> (260) 665-7586	info@vestil.com Enter "Warranty service request" in subject field.

In the written request, list the parts believed to be defective and include the address where replacements should be delivered. After Vestil receives your request for warranty service, an authorized representative will contact you to determine whether your claim is covered by the warranty. Before providing warranty service, Vestil will require you to send the entire product, or just the defective part (or parts), to its facility in Angola, IN.

What is covered under the warranty?

The warranty covers defects in the following original, dynamic parts: motors, hydraulic pumps, motor controllers, and cylinders. It also covers defects in original parts that wear under normal usage conditions ("wearing parts"), such as bearings, hoses, wheels, seals, brushes, and batteries.

How long is the warranty period?

The warranty period for original dynamic components is 30 days. For wearing parts, the warranty period is 30 days. Both warranty periods begin on the date Vestil ships the product to the Warrantee. If the product was purchased from an authorized distributor, the periods begin when the distributor ships the product. Vestil may, at its sole discretion, extend a warranty period for products shipped from authorized distributors by up to 30 days to account for shipping time.

If a defective part is covered by the warranty, what will Vestil do to correct the problem?

Vestil will provide an appropriate replacement for any covered part. An authorized representative of Vestil will contact you to discuss your claim.

What is not covered by the warranty?

The Warrantee (you) is responsible for paying labor costs and freight costs to return the product to Vestil for warranty service.

Events that automatically void this Limited Warranty.

- Misuse;
- Negligent assembly, installation, operation or repair;
- Installation/use in corrosive environments;
- Inadequate or improper maintenance;
- Damage sustained during shipping;
- Collisions or other accidents that damage the product;
- Unauthorized modifications: Do not modify the product IN ANY WAY without first receiving written authorization from Vestil.

Do any other warranties apply to the product?

Vestil Manufacturing Co. makes no other express warranties. All implied warranties are disclaimed to the extent allowed by law. Any implied warranty not disclaimed is limited in scope to the terms of this Limited Warranty. Vestil makes no warranty or representation that this product complies with any state or local design, performance, or safety code or standard. Noncompliance with any such code or standard is not a defect in material or workmanship.

