

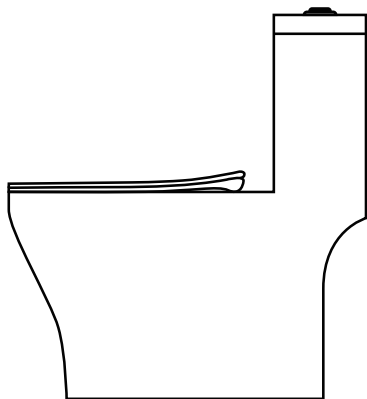

PRODUCT USER MANUAL

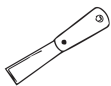

RECOMMENDED TOOLS AND MATERIALS



Putty Knife



Wrench



Tape Measure

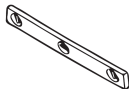

Level



Water Supply Kit



Flat Head Screwdriver



Cross Screwdriver

PACKAGING CHECKLIST

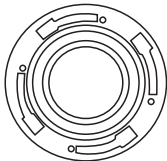

Flange Base

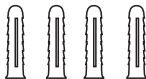

Expansion Bolt



Anchor Bolt

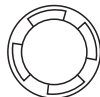

Large Square
Decorative Cover

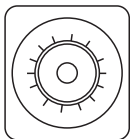

Flange Ring

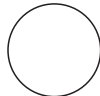

INSTALLATION STEPS

1. If there is an old toilet, first turn off the water supply, then remove the angle valve and move the old toilet away. If you are installing a new toilet, turn off the water supply before installation and check the position of its sewage outlet to ensure that its pit distance matches the toilet you purchased. Note: The installation surface should be flat; otherwise, it may cause the toilet to crack after installation. If you are not installing a new toilet immediately, please block the sewage pipe with a clean item to prevent cement, oil stains and other debris from falling into the pipe and clogging it.

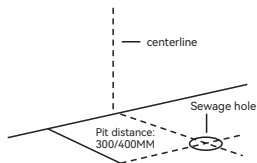

2. Take the prepared screws, align them with the flange ring, and insert vertically into the holes, then rotate to fix the screws in place.

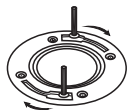

3. Place the toilet upside down gently on the opened packaging box (to prevent scratches on the surface). After leveling, fit the flange ring tightly onto the waste outlet of the toilet. Then turn it back upright and lift it slightly (to avoid pressing on the flange ring). Check that the tank fittings and toilet seat cover are all properly installed. Ensure there are no problems.

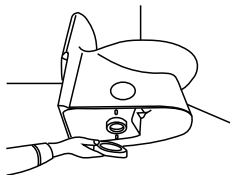

Note: Place the plastic side of the flange ring facing outward.

4. After installing the flange ring, proceed to install the floor bolts. Place the metal washers and nuts on the flange base. Tighten the bolts alternately until the toilet is firmly fixed to the floor.

Note: Do not over-tighten the nuts, as this may cause serious damage.

Note: Do not over-tighten the nuts, as it may cause serious damage.



5. Align with the pre-determined installation holes and place the screw parts into their corresponding positions.

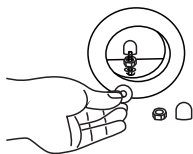

6. Using a wrench, insert through the reserved window of the toilet and tighten the screws clockwise to fix the toilet to the floor. Do not overtighten to avoid damaging the ceramic base. After confirming stability, cover with the provided plastic protective caps, ensuring they are tight and secure.



7. Connect the tank inlet pipe to the angle valve. First check the sealing ring for integrity, align the interface, then tighten the nut clockwise. Lightly reinforce with a wrench (avoid overtightening). Open the angle valve and check for leaks.

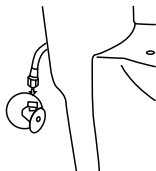

8. After confirming the toilet is installed properly, cover the tank lid. Apply anti-mold silicone evenly around the bottom edge of the toilet, wipe off any excess, and the installation is complete.

Note: The silicone curing time is about 24 hours. Do not use or move the toilet during this period. In the following days, repeatedly check all joints for leaks. Refer to the troubleshooting guide for minor issues.

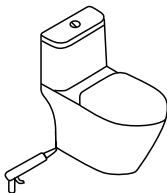

TOILET SEAT INSTALLATION

(1) Unfold the toilet seat installation package. The small plastic bag contains matching fixing screws, and next to them are plastic expansion tubes and metal washers in sequence.

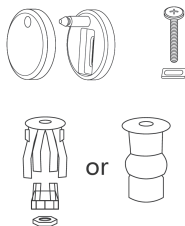

(3) First confirm the placement position of the toilet seat, then take out the seat and install it in place to ensure it is firmly installed.

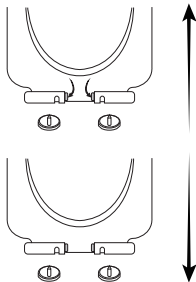

(2) Place the accessories needed for installation in sequence, then tighten the screws and adjust the angle slightly.

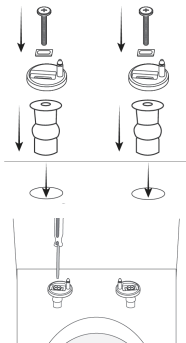

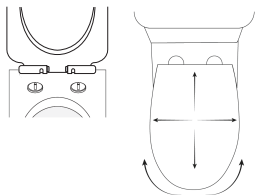

(4) After inserting the toilet seat, adjust the position of the seat to ensure that the seat fits well with the main body of the toilet without loosening or wobbling, which will affect the stability during use.



PRECAUTIONS

Carefully read the relevant precautions before operation. This manual details various safety notices, aiming to avoid causing harm to the human body or loss to property. The following warnings and instructions are provided. Please keep it in a prominent place.

 **Warning:** If you ignore this notice, it may cause personal injury or damage to items.

 Do not stand on the toilet seat or place heavy objects on it. (Otherwise, it may cause cracking.)



 Do not use volatile, solvent-based, or stripping household cleaners, or nylon brushes. Corrosive, abrasive, or chlorine-containing cleaners may cause scratches or cracks. Clean regularly with a soft cloth and clean water to maintain a smooth surface.



 Do not let children play with the toilet lid to avoid finger injuries and other accidents.



MAINTENANCE

Lift and put down the toilet seat gently; otherwise, it may cause cracking.



Regular maintenance: It can be cleaned with neutral detergent and wiped lightly with a damp cloth.



Avoid exposure to direct sunlight from the sun or other household lamps; otherwise, it may cause color change.



Do not use disinfectants, bleaches or other spray cleaners. Some chemicals in the bathroom may damage the toilet seat and lid.

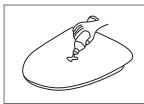

COMPLIANCE NOTES

- 1.If there is no flange or sealing ring, the floor waste pipe should be reserved at 10–13 mm above the ground so the toilet outlet directly inserts into the waste pipe. This prevents leaks after installation.If the floor waste pipe is flush with the ground, you must use a flange base.
2. Be familiar with outlet installation distances:
For floor-outlet toilets: distance from outlet center to finished wall.
For rear-outlet toilets: distance from outlet center to finished floor.
- 3.Use neutral silicone sealant for installation. If cement is used, it will cause expansion at the bottom of the toilet.
4. On hard dry surfaces, the toilet outlet should connect directly to the waste outlet. Do not install a trap, as this will affect flushing performance.
- 5.Do not flush newspapers, sanitary napkins, or other items that may cause blockage.
6. Do not use the toilet in environments below 0°C to prevent cracking due to freezing.
- 7.If you have any questions about the product, please scan the WhatsApp QR code below or contact us via email: SUPPORT@bcanhome.com



INSTALLATION VIDEO QR CODE

Note: This product requires a rough-in of ≥ 12 inches (305 mm); floor-mounted design for easy setup; toilet water inlet size: 7/8 inch (≈ 22.2 mm); supply hose not included; one-year warranty covering all defects for peace of mind.



Installation Video Tutorial for Flange
Mounting Fixation

Either of the two installation methods is applicable; simply choose the one that is more convenient for you!



Installation Video Tutorial for Glass Adhesive
Mounting Fixation (Without Flange)

Either of the two installation methods is applicable; simply choose the one that is more convenient for you!