



**300-WATT PORTABLE  
BULLET BLENDER  
Model: HL2576**



**User Manual**

**- READ ALL INSTRUCTIONS BEFORE USE -**

# IMPORTANT SAFEGUARDS

## READ ALL INSTSRUCTIONS

When using electrical appliances, basic safety precautions should always be taken:

1. To protect against risk of electrical shock do not put cord, plug, or base in water or other liquid.
2. Close supervision is necessary when the appliance is used by or near children.
3. Unplug from the outlet when not in use, before putting on or taking off parts, and before cleaning.
4. Avoid contact with moving parts.
5. Do not operate any appliance with a damaged cord or plug, or after the appliance malfunctions or is dropped or damaged in any manner. Contact our customer service for information on examination, electrical repair, mechanical repair, or adjustment.
6. The use of attachments not recommended by the manufacturer may cause a risk of injury to persons.
7. Do not use outdoors.
8. Do not let the cord hang over edge of table or counter or touch hot surface including the stove.
9. Keep hands and utensils away from moving blades while processing food to reduce the risk of severe injury to persons or damage to the food chopper. A scraper may be used but must be used only when the food chopper is not running.
10. Blades are sharp. Handle carefully.
11. This appliance is intended for processing small quantities of food for immediate consumption. This appliance is not intended to prepare large quantities of food at one time.
12. To reduce the risk of injury, never place the cutting blade on base without first putting bowl properly in place.
13. Be certain the Cup Assembly is securely locked in place before operating appliance.
14. Keep the product and the Power Cord away from heat sources.
15. This product is intended solely for indoor, non-commercial, non-industrial use in processing liquids and foods for human consumption; do not use the product outdoors or for any other purpose.
16. Do not blend hot liquids.
17. Always operate the product with the Blade Assembly in place.
18. Do not attempt to place the Jar on the Base or remove the Jar from the base

while the motor is running.

19. To disconnect the product from an electrical outlet, pull directly on the plug; do not pull on the Power Cord.
20. Do not put any stress on the Power Cord where it connects to the product, as the Power Cord could fray and break.
21. If using an extension cord with this product, the marked electrical rating of the cord set must be at least as great as the electrical rating of the product.
22. Always operate the product on a flat, level, stable surface.
23. Do not allow the Power Cord to hang, such as over the edge of a table or counter, where it may be tripped over or pulled.
24. Each time the product is used, do not plug into an electrical outlet until the Blade Assembly and Cup are securely attached to each other and then locked in place on the Base.

**SAVE THESE INSTRUCTIONS!**  
**FOR HOUSEHOLD USE ONLY**

# PARTS AND ACCESSORIES

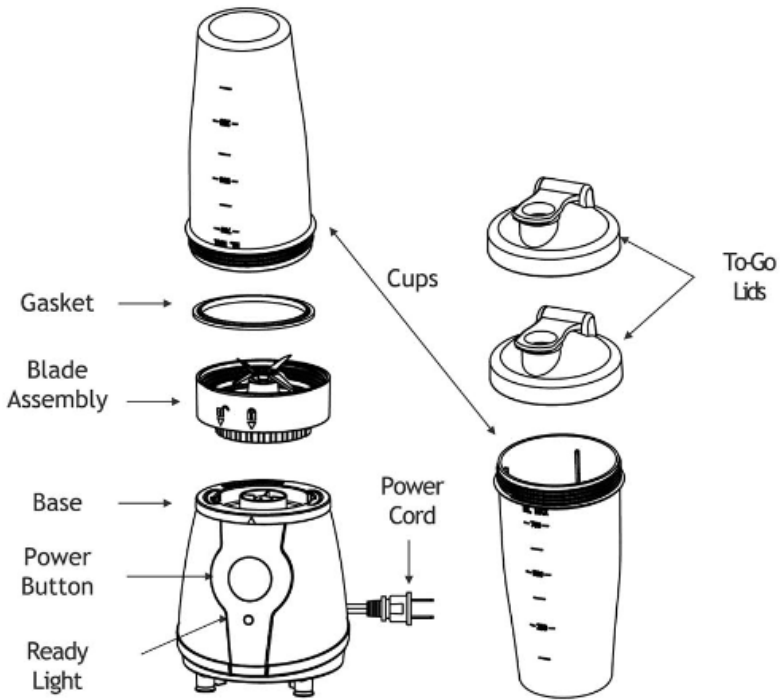

- 1 X 300W Motor Base
- 1 X Blade Assembly
- 2 X 750ml Blending/Drinking Jars (Cups)
- 2 X To-Go Lids

## TO ASSEMBLE



**CAUTION:** Do not plug the product into an electrical outlet until it is fully assembled.

1. Before using the product for the first time, disassemble and wash as follows:
  - a. Remove the Blade Assembly from the Jar by turning the Blade Assembly counterclockwise.
  - b. Remove the Gasket from the Blade Assembly.

**CAUTION:** Handle Blades carefully, as they are sharp. Do not use anything sharp to remove Gasket.

- c. Wash all parts except the Motor Housing and Power Cord in warm, soapy water and then rinse and dry thoroughly.

**WARNING:** Do not immerse the Motor Housing or Power Cord in water or other liquids. Do not use abrasive cleaners to clean any part of the product.



- d. Reassemble by replacing the Gasket into the Blade Assembly and attaching the Blade Assembly onto the top of the Jar. Securely tighten by turning clockwise.
      - e. When inserting the Gasket into the groove, press the Gasket firmly around all sides and test it by turning the Blade Assembly upside down to make sure the Gasket is not loose or does not fall out. There will be a small bump underneath the Gasket where the safety interlock mechanism protrudes; it is normal.
2. Place the Motor Housing on a flat, level, stable surface. To attach the Cup Assembly (the Cup and the Blade Assembly securely attached together), align the  symbol on the bottom edge of the Blade Assembly with the  mark on the Base and turn clockwise until it is firmly in place, aligned with the  symbol.

# OPERATION

**NOTICE:** The Jar has a 28 fl. Oz. (750ml) capacity. Do not fill the Jar with food or liquids past the Max mark.

- Do not use the product for mashing or grinding heavy foods (e.g., potatoes or meats) or to stir thick mixtures (e.g., dough).
- Do not operate the product empty.

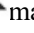
**Note:** Product will not operate, and Ready Light will not illuminate unless the Jar is attached securely to the Blade Assembly and both parts locked in to place on the Base.

1. Ensure the product is unplugged from the electrical outlet.
2. Pour liquid ingredients into the Jar, and/or cut all solid ingredients into pieces small enough to fit into the Jar.
3. Ensure the Gasket is securely placed in the Blade Assembly, then tighten the Blade Assembly clockwise onto the top of the Cup.
4. To attach the Cup Assembly, align the  symbol on the bottom edge of the Blade Assembly with the  mark on the Base and turn clockwise until it is firmly in place, aligned with the  symbol.
5. Plug the Power Cord into a standard electrical outlet. If all components are assembled and attached properly, the orange Ready Light will illuminate.
6. Press the Power Button to start blending.

**NOTICE:** Do not operate the product's motor for more than 1 minute at a time. Allow the motor to cool for 1 minute before operation. If the Blades are not operating smoothly, stop the product and add some liquid, or reduce the contents.

7. Press the Power Button to turn the blender off.
8. When the blades have stopped, unplug the Power Cord from the outlet, remove the Cup Assembly from the Base, and turn the Cup right-side up.
9. Unscrew the Blade Assembly from the Cup; and empty the contents into a separate container or use To-Go Lid to consume.

## **MAINTENANCE AND CARE**

**CAUTION:** Always ensure the product is unplugged from the electrical outlet before relocating, assembling, disassembling, or cleaning it.

- Immediately after each use, clean the product as instructed under the “To Assemble” section. Use a small brush (not included) to remove particles of food lodged underneath the Blades.
- Store the product in a cool, dry place.

## ELECTRICAL SPECIFICATIONS

Voltage	Frequency	Wattage
120 V	60 Hz	300 W

## ICUCINA LIMITED WARRANTY

**LIMITED ONE-YEAR WARRANTY:** Thank you for choosing iCucina Portable Bullet Blender. This product is warranted to be free from defects in material and workmanship under normal household use during the first one year from the date of original purchase with receipt. We will repair or replace it at our option. The limited warranty shall not apply to damages resulting from accidents, abuse, misuse, damage caused by shipping, or failure to follow safety instruction. The warranty is valid only for first quality goods purchased from an authorized resale and only valid in the United States.

## CUSTOMER SERVICE INFORMATION

If you have any questions regarding to the warranty, the operation of iCucina appliances, or need parts for your appliance, please contact us via email: [service@icucinakitchen.com](mailto:service@icucinakitchen.com). Inquires will be answered promptly. Thank you for purchasing!



**Thimax Inc. Irvine, CA 92618**