











Assembly Instruction

Instructions d'assemblage

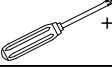
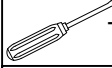
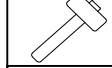
Twin Bed with 2 Drawers

Lit double avec 2 tiroirs

 REQUIRED ASSEMBLY TOOLS	 REQUIRED ASSEMBLY TOOLS	 REQUIRED ASSEMBLY TOOLS	 REQUIRED ASSEMBLY TOOLS	 NO POWER TOOLS NEEDED	 2 PERSON ASSEMBLY
 OUTILS D'ASSEMBLAGE NÉCESSAIRES	 OUTILS D'ASSEMBLAGE NÉCESSAIRES	 OUTILS D'ASSEMBLAGE NÉCESSAIRES	 OUTILS D'ASSEMBLAGE NÉCESSAIRES	 AUCUN OUTIL ÉLECTRIQUE N'EST NÉCESSAIRE	 ASSEMBLAGE PAR 2 PERSONNES

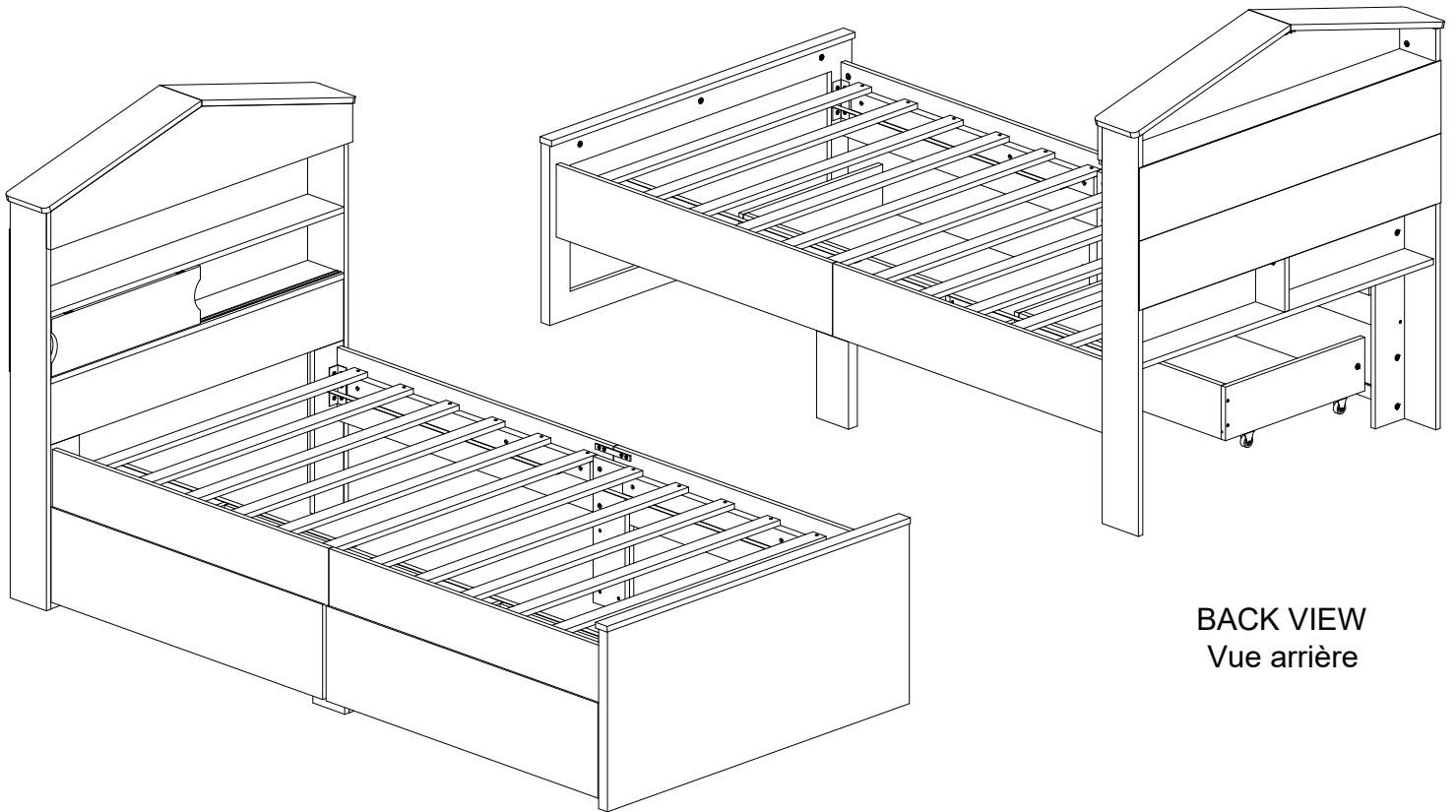

FRONT VIEW
Vue de Face

BACK VIEW
Vue arrière

Product Dimensions: Height 47.28" x Width 81.41" x Depth 42.44"

Dimensions du produit : Hauteur 47.28" x Largeur 81.41" x Profondeur 42.44"

The Breakdown La répartition

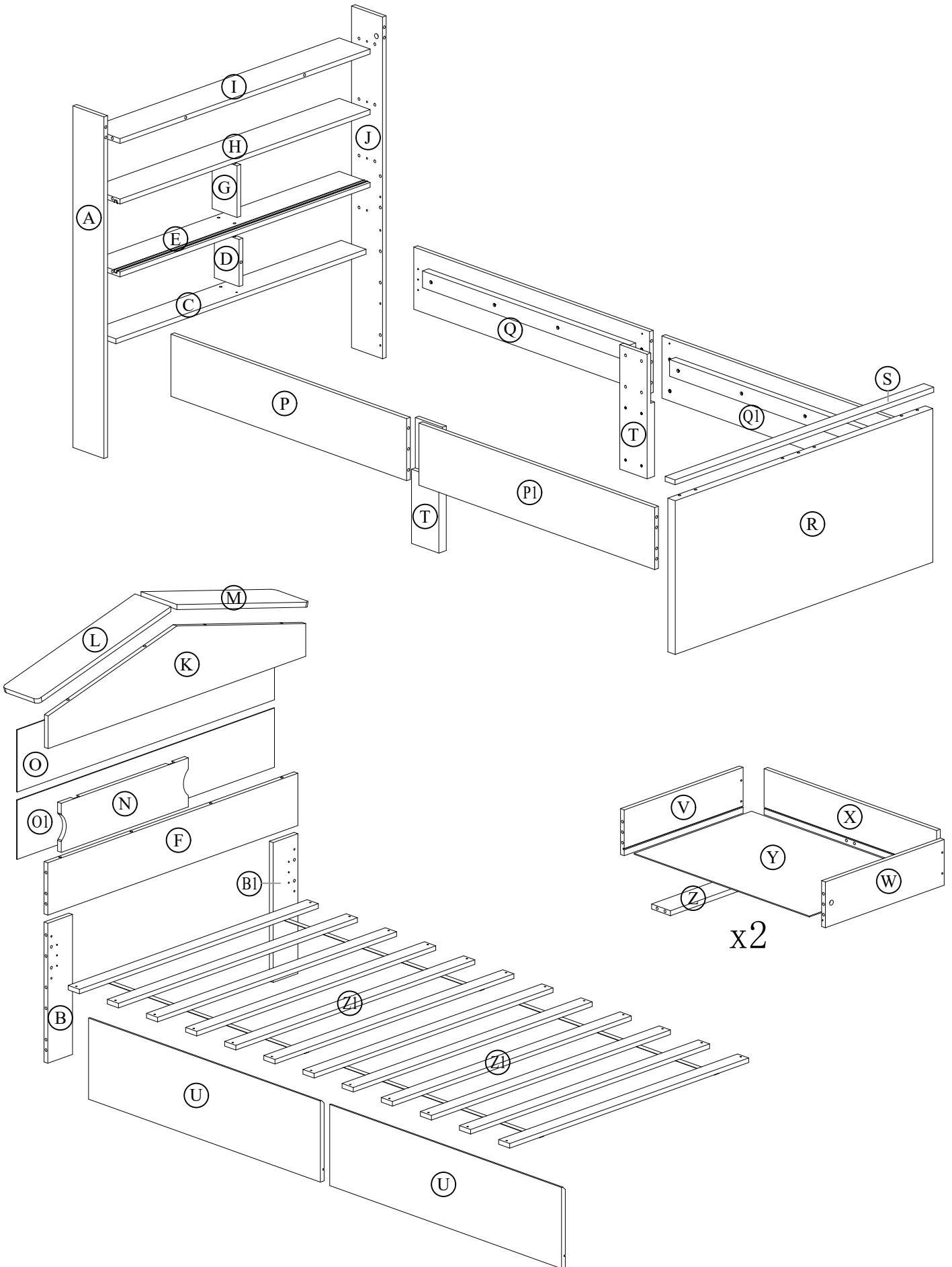

Assembly Instruction

Instructions d'assemblage

Parts List

Liste des pièces

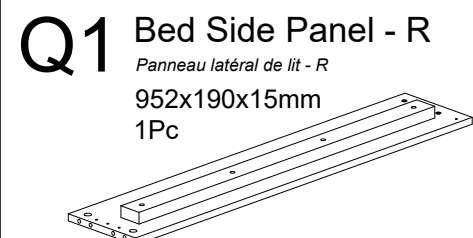
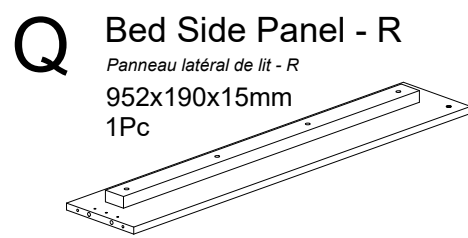
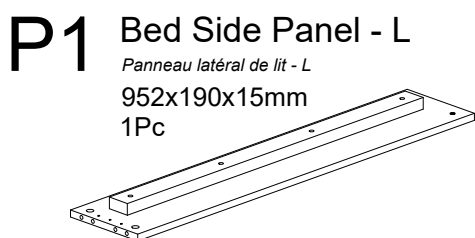
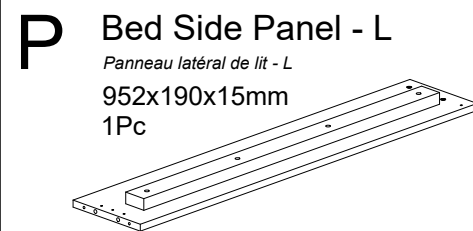
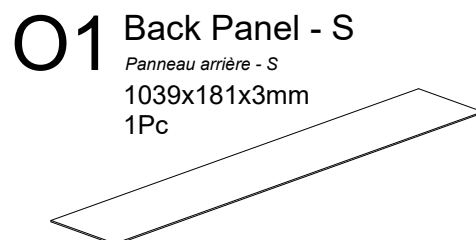
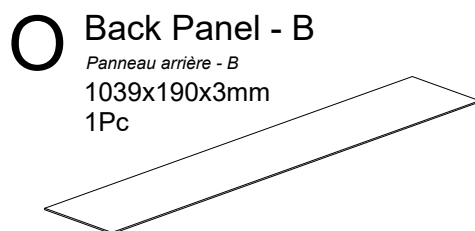
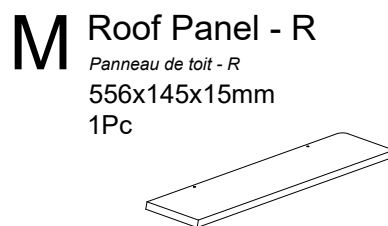
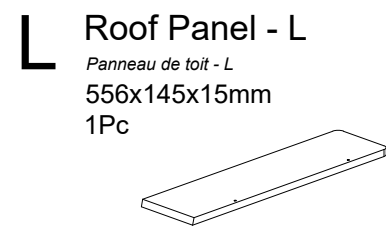
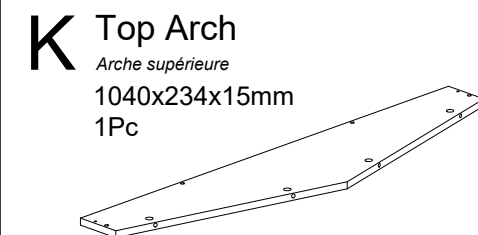
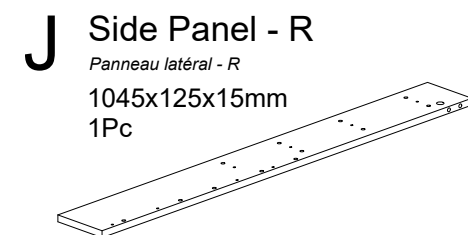
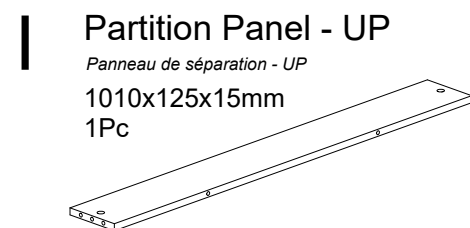
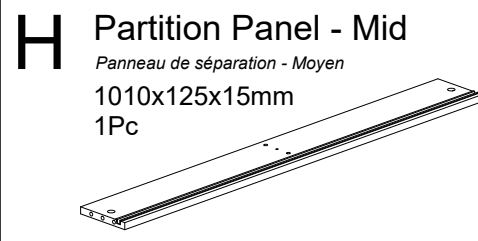
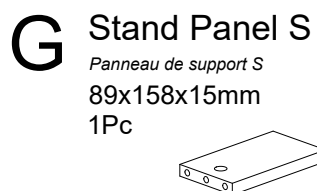
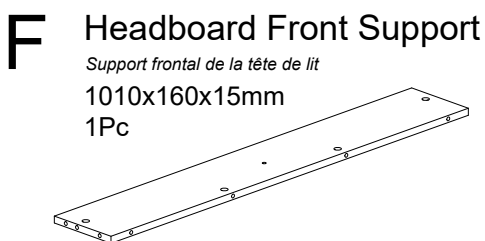
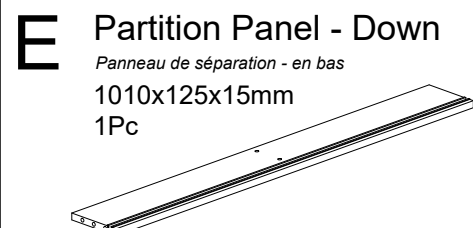
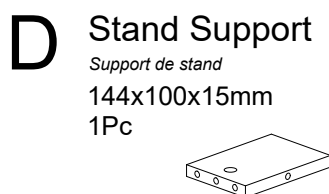
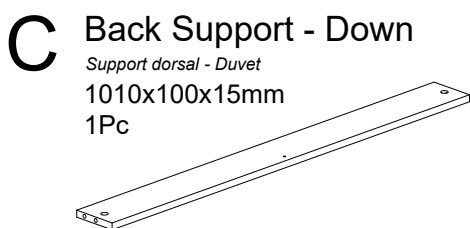
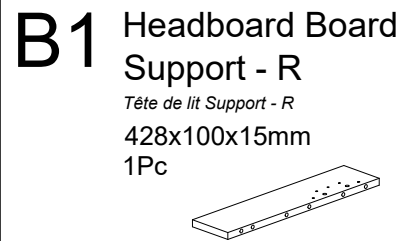
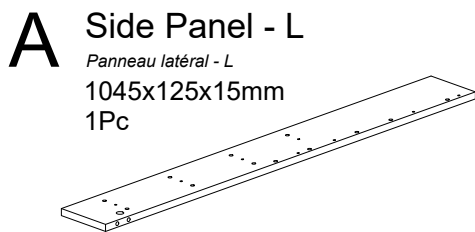

Assembly Instruction

Instructions d'assemblage

Parts List

Liste des pièces

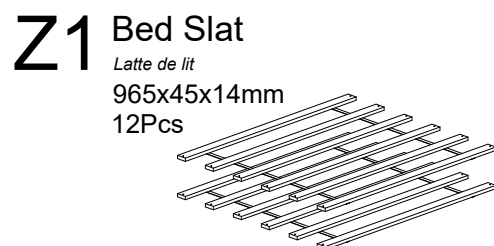
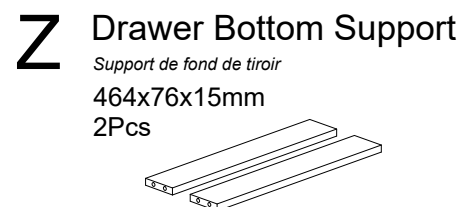
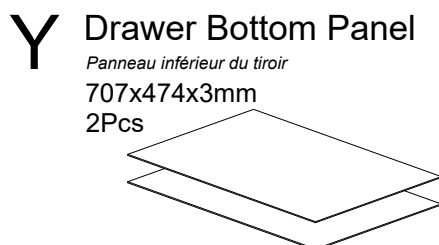
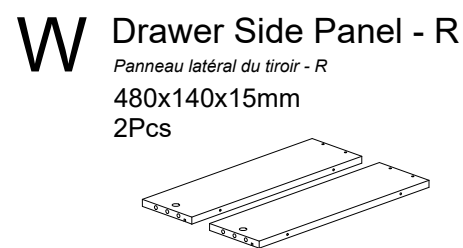
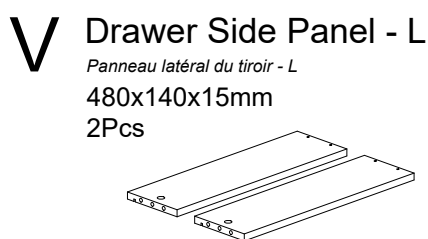
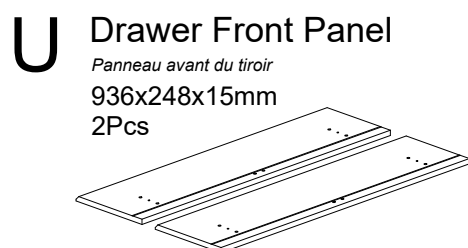
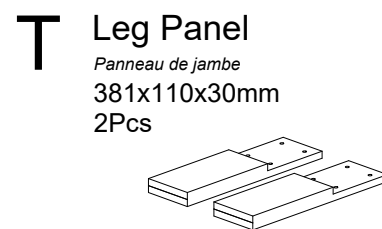
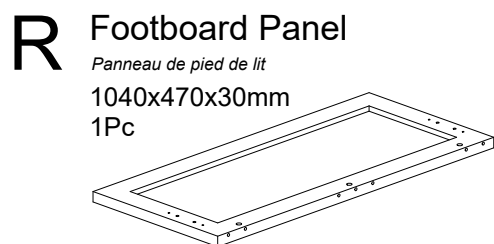

Hardware List

Liste du matériel

No. No.	SHAPE FORME	DESCRIPTION DESCRIPTIO	Qty. Quantité
1		8x30mm Wood Dowel Cheville en bois 8x30mm	72Pcs
2		M3.5x14mm Screw Vis M3.5x14mm	44Pcs
3		TP 10#x1/2" Screw Vis TP 10#x1/2	24Pcs
4		M6x25mm Bolt Boulon M6x25mm	8Pcs
5		M4x32mm Screw Vis M4x32mm	32Pcs
6		M6x40mm Screw Vis M6x40mm	1Pc
7		M6x70mm Screw Vis M6x70mm	4Pcs
8		15MM Screw Cap Capuchon à vis 15MM	5Pcs
9		15MM Myfix Minifix 15MM Myfix Minifix	37Sets
10		17 MM MiniFix Cap 17 MM MiniFix Capuchon	37Pcs
11		K445 Door Sliding Roller K445 Rouleau coulissant pour portes	2Sets
12		Metal Support (120x15x2.7mm) Support métallique (120x15x2,7mm)	2Pcs
13		L-Bracket (100mmx30mm) (Black) Support en L (100mmx30mm) (Noir)	4Pcs
14		Rigid Caster(Ø29,H39mm) Roulette rigide (Ø29,H39mm)	8Pcs
15		Metal Hinges (4Holes) Charnières en métal (4 trous)	1Pc
16		L-Bracket 22x18mm Support en L 22x18mm	4Pcs
17		Nail Clou	48Pcs
18		M4 Allen Key Clé Allen M4	1Pc

Assembly Instruction

Instructions d'assemblage

Step 1

Étape 1

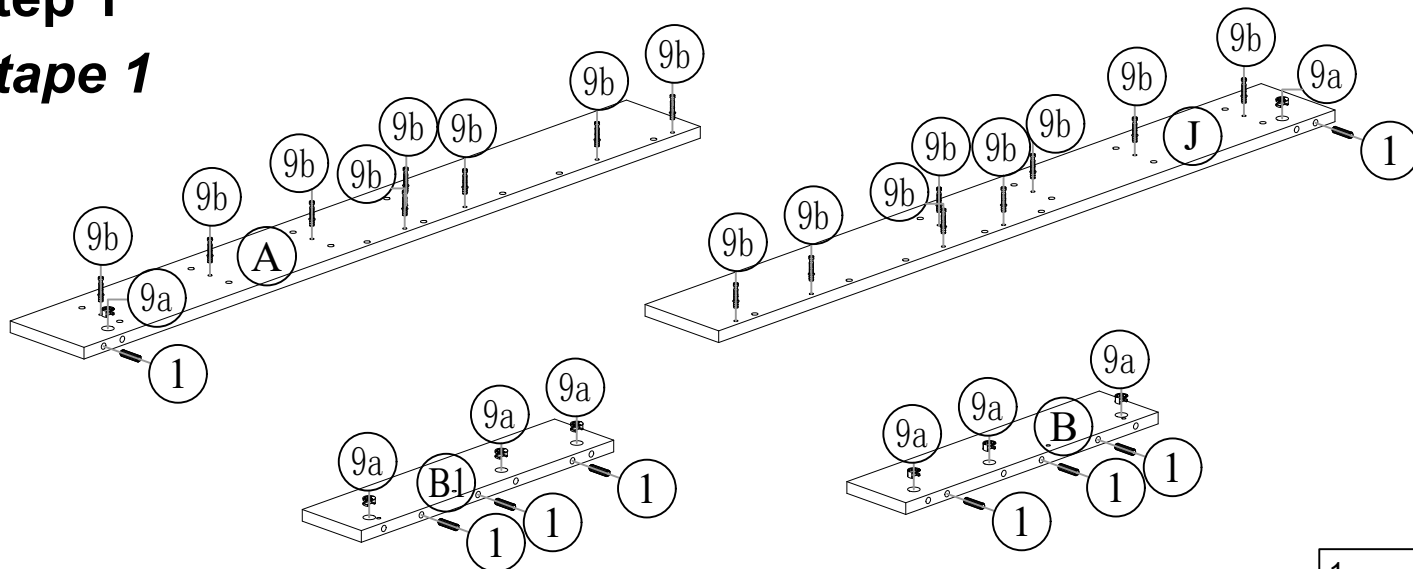

- Install the 8x30mm wood dowel (1) to each Panel (A), (B), (Bl) & (J). Next, install the minifix nuts (9a) & the minifix screws (9b) to each panel as shown above.

Installez la cheville en bois 8x30mm (1) sur chaque panneau (A), (B), (Bl) & (J). Ensuite, installez les écrous minifix (9a) et les vis minifix (9b) sur chaque panneau comme indiqué ci-dessus.

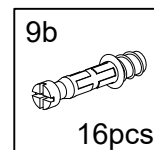
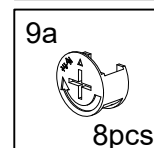
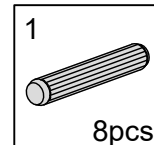

Step 2

Étape 2

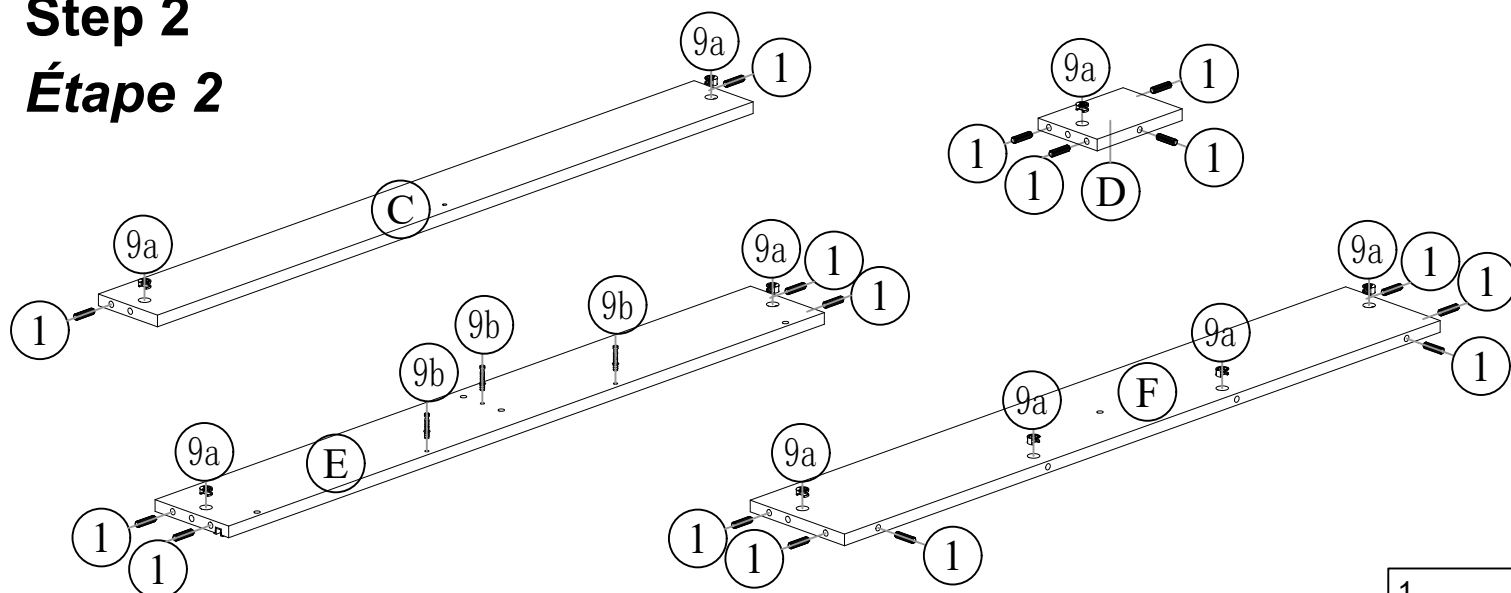

- Install the 8x30mm wood dowel (1) & the minifix nuts (9a) to each Panel (C), (D), (E) & (F). Next, install the minifix screws (9b) to Panel (E).

Installez la cheville en bois 8x30mm (1) et les écrous minifix (9a) sur chaque panneau (C), (D), (E) & (F). Ensuite, installez les vis minifix (9b) sur le panneau (E).

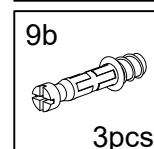
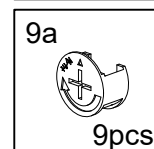
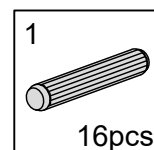

Step 3

Étape 3

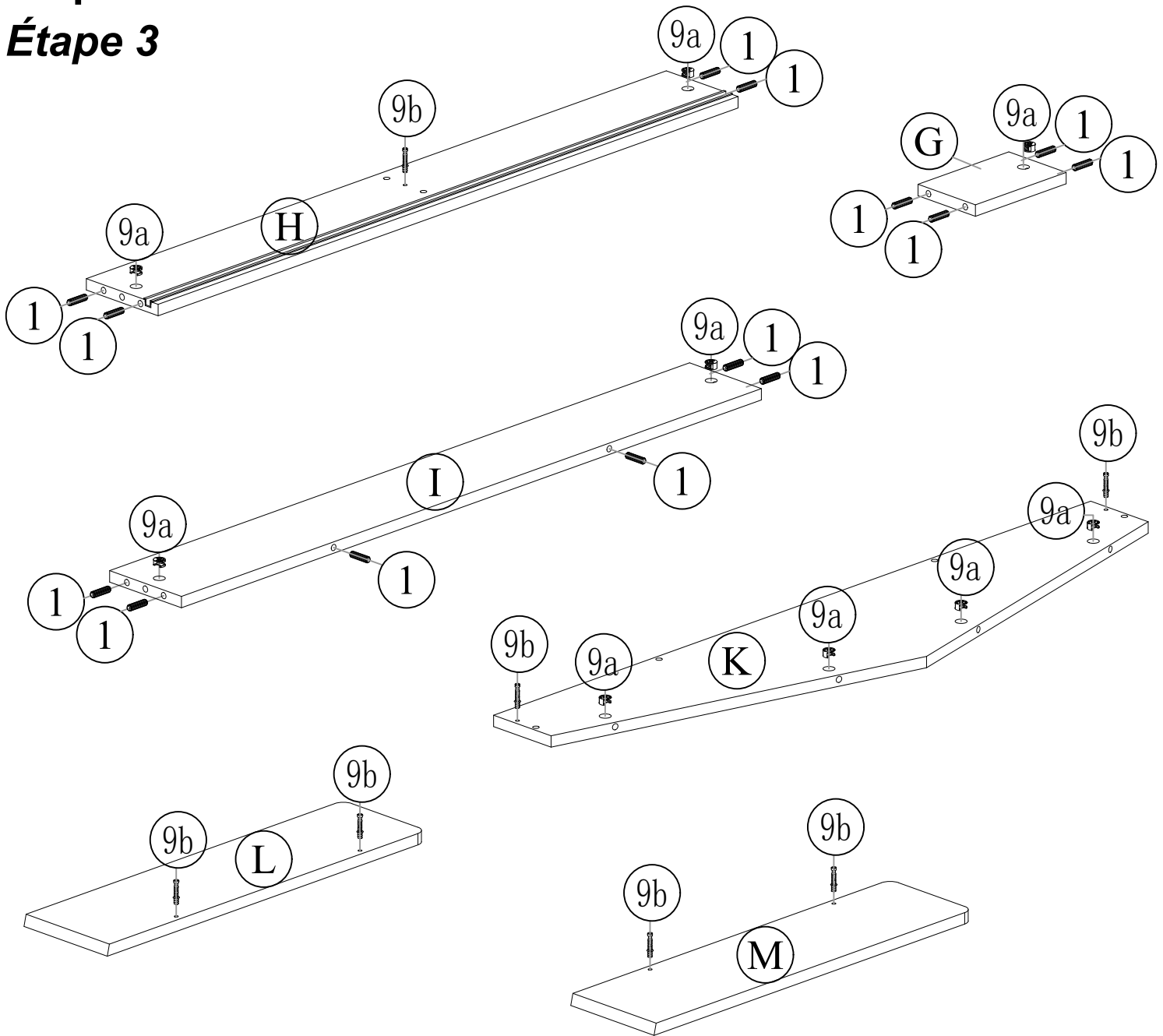

- **Install the 8x30mm wood dowel (1) to Panel (G), (H) & (I).**
Next, install the minifix nuts (9a) to Panel (G), (H), (I) & (K).
Installez la cheville en bois 8x30mm (1) sur le panneau (G), (H) & (I).
Ensuite, installez les écrous minifix (9a) sur les panneaux (G), (H), (I) & (K).
- **Continue to install the minifix screws (9b) to Panel (H), (K), (L) & (M).**
Continuez à installer les vis minifix (9a) sur les panneaux (H), (K), (L) & (M).

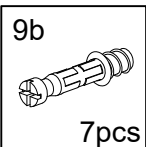
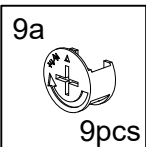
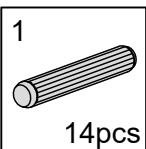

Step 4
Étape 4

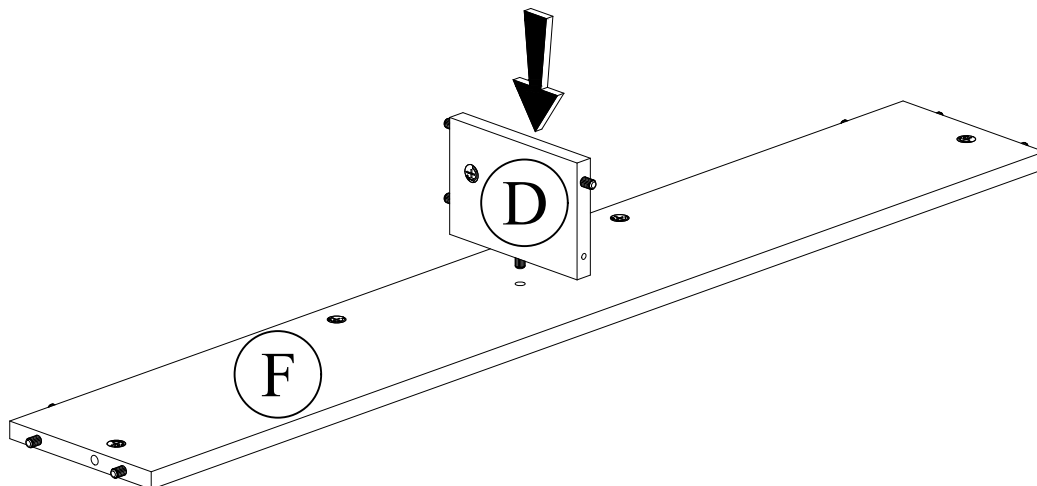

- Start assembly with Panel (D) & Panel (F).
Commencer l'assemblage avec le panneau (D) et le panneau (F).

Step 5
Étape 5

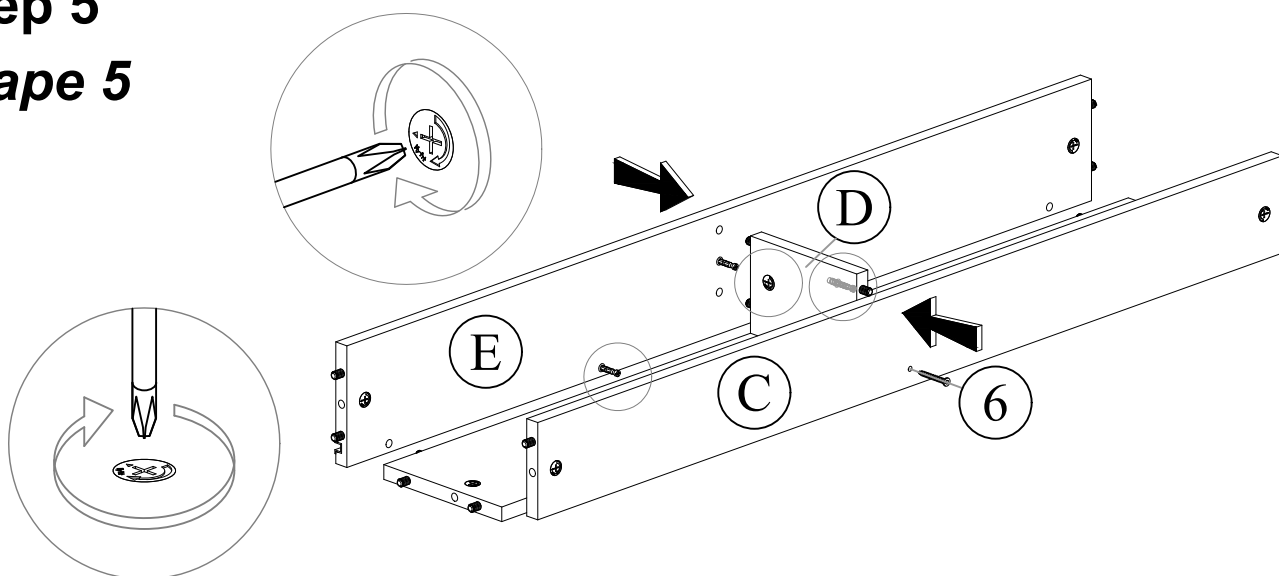

- Then, assembly Panel (C) to Panel (D) & secure both panels using M6x40mm screws (6). Meanwhile, rotate the minifix nut at Panel (D) & (F) to tighten the minifix screw Panel (E) as shown in the diagram.

Assembler ensuite le panneau (C) au panneau (D) et fixer les deux panneaux à l'aide de vis M6x40mm (6). Pendant ce temps, tourner l'écrou minifix sur les panneaux (D) & (F) pour serrer la vis minifix sur le panneau (E) comme indiqué sur le schéma.

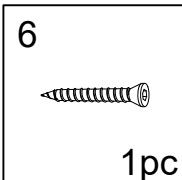

Step 6

Étape 6

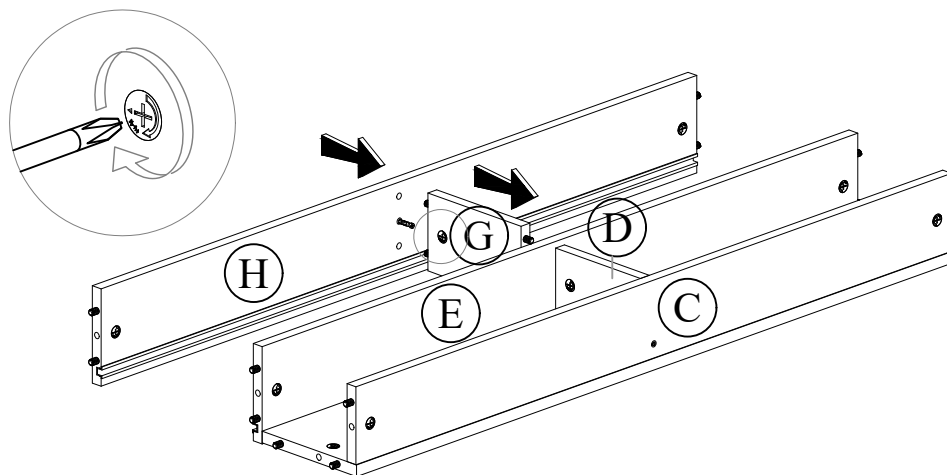

- **Assembly Panel ⑥ to Panel ④ & continue with Panel ③. Rotate the minifix nuts at Panel ⑥ to tighten the minifix screw at Panel ③. Assembler le panneau ⑥ au panneau ④ et continuer avec le panneau ③. Tourner les écrous minifix du panneau ⑥ pour serrer la vis minifix du panneau ③.**

Step 7

Étape 7

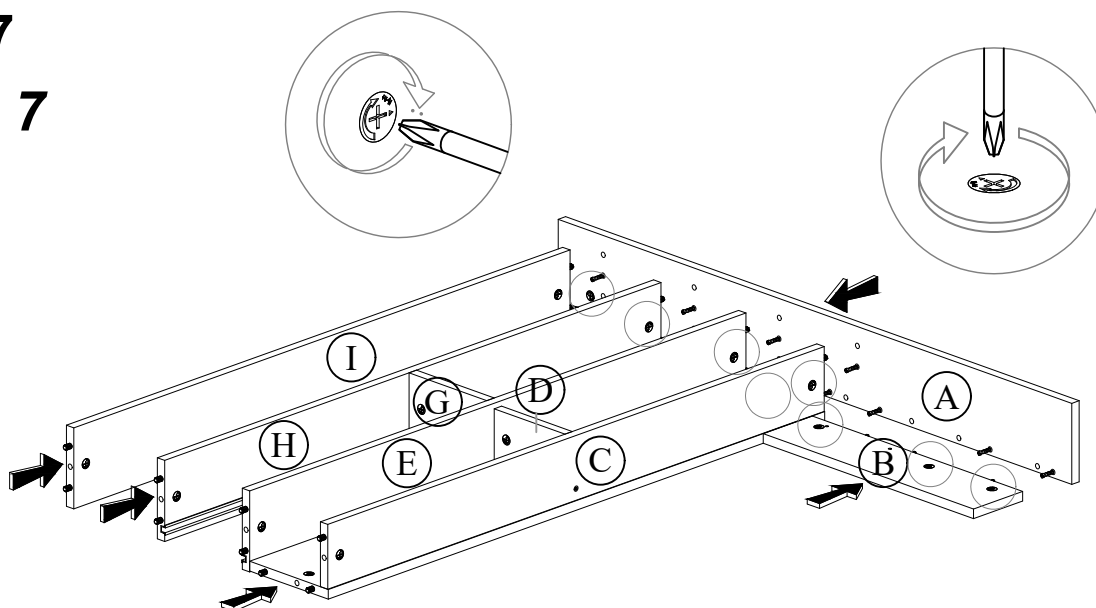

- **Next, assembly Panel ③, ④, ⑤, ⑥, ⑦ & ⑧ to Panel ①. Add also Panel ⑨ & Panel ② to Panel ①. Rotate the minifix nuts at each panels to tighten the minifix screws at Panel ①. Ensuite, assemblez les panneaux ③, ④, ⑤, ⑥, ⑦ & ⑧ au panneau. Ajoutez également le panneau ② & le panneau ⑨ au panneau ①. Tournez les écrous minifix à chaque panneau pour serrer les vis minifix au panneau ①.**

Step 8 ←



Step 8

Étape 8

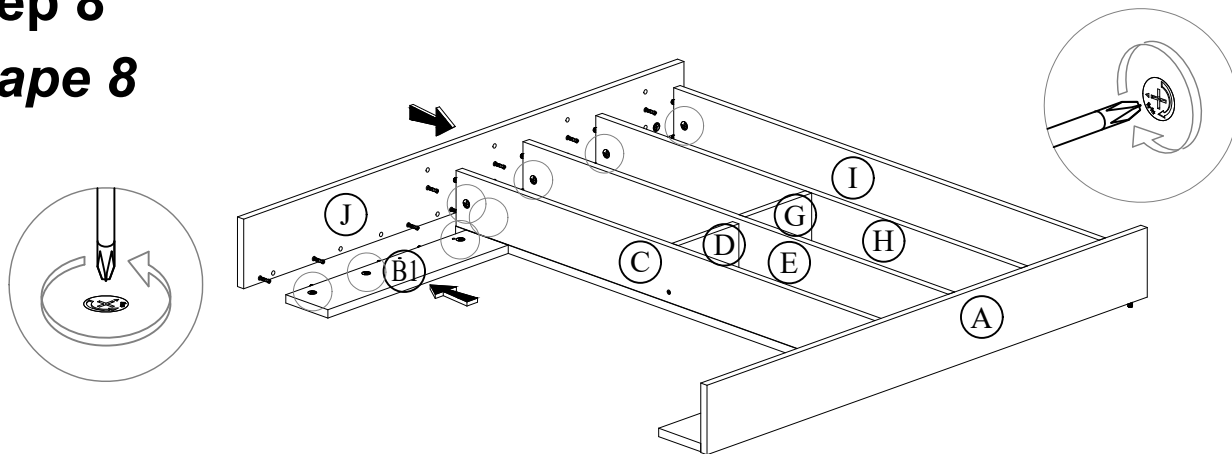

- From Step 7, rotate 90° & assembly Panel (C), (D), (E), (F), (G), (H) & (I) to Panel (J). Also add Panel (B1). Rotate the minifix nuts at each panels to tighten the minifix screws at Panel (J).

A partir de l'étape 7, tourner de 90° et assembler les panneaux (C), (D), (E), (F), (G), (H) & (I) au panneau (J). Ajouter également le panneau (B1). Tourner les écrous minifix à chaque panneau pour serrer les vis minifix au panneau (J).

Step 9 ←

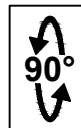

Step 9

Étape 9

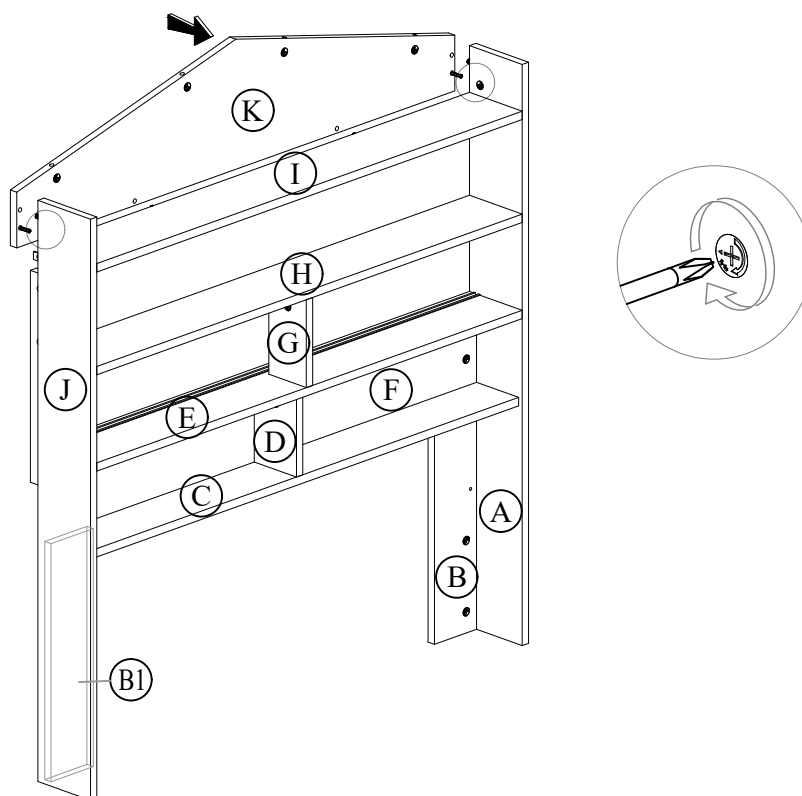

- Rotate 90° from Step 8, continue to assembly Panel (K) to Panel (A) & (J). Rotate the minifix nuts to tighten the minifix screws as shown in the diagram. Also make sure the dowels well-fitted into the holes.

Tourner de 90° à partir de l'étape 8, continuer à assembler le panneau (K) au panneau (A) & (J). Tourner les écrous minifix pour serrer les vis minifix comme indiqué dans le diagramme. Veillez également à ce que les chevilles soient bien insérées dans les trous.

Step 10
Étape 10

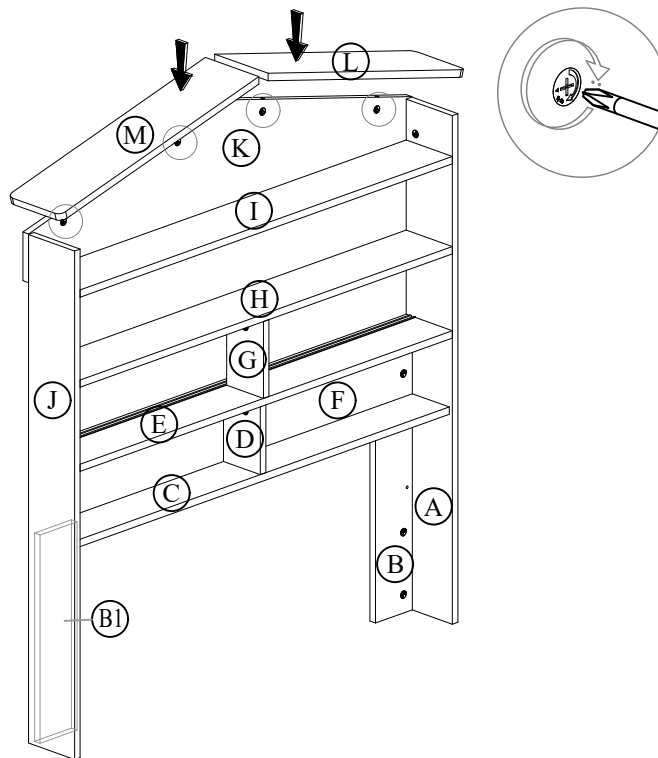

- **Assembly Panel (L) & Panel (M) to Panel (K). Rotate the minifix nuts to tighten the minifix screws as shown above.**
Assemblage du panneau (L) et du panneau (M) au panneau (K).
Tourner les écrous minifix pour serrer les vis minifix comme indiqué ci-dessus.

Step 11
Étape 11

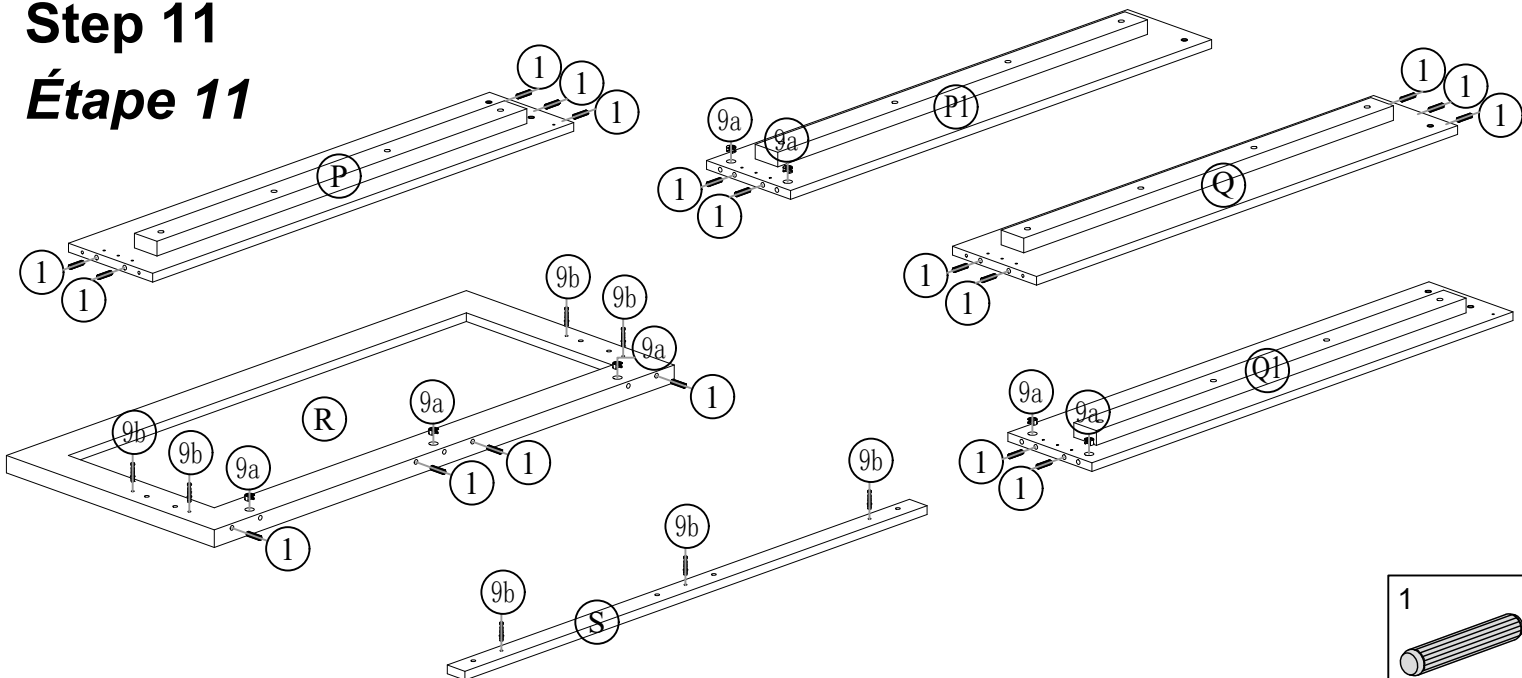

- **Before continue assembly, install 8x30mm wood dowel (1) to Panel (P), (P1), (Q), (Q1) & (R). Install the minifix nuts (9a) to Panel (P1), (Q1) & (R). Then, install the minifix screw (9b) to Panel (R) & (S).**
Avant de poursuivre l'assemblage, installez une cheville en bois (1) de 8x30mm sur le panneau (P), (P1), (Q), (Q1) & (R). Installez les écrous minifix (9a) sur le panneau (P1), (Q1) & (R). Ensuite, installez la vis minifix (9b) sur le panneau (R) & (S).

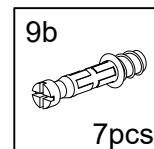
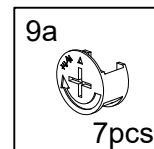
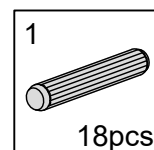

Step 12
Étape 12

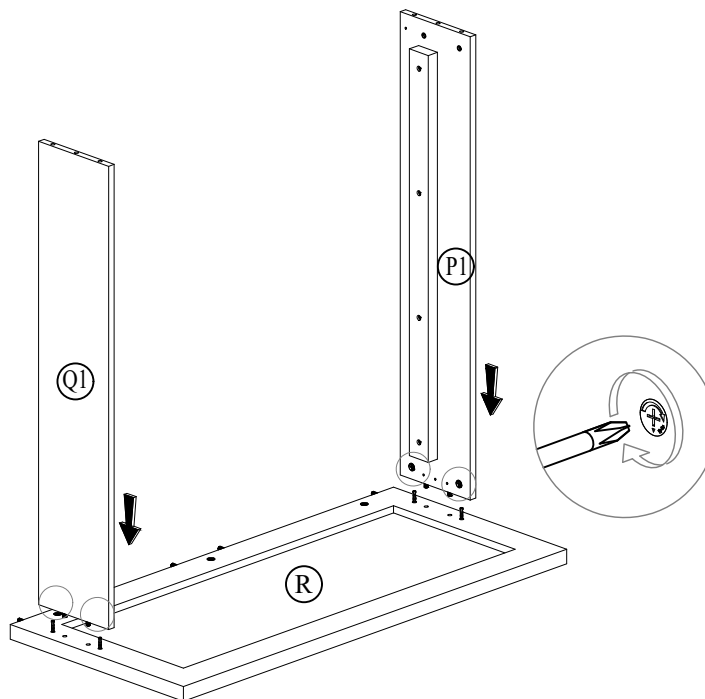

- **Assemble Panel (P1) & Panel (Q1) to Panel (R). Rotate the minifix nuts to tighten the minifix screws as shown above.**
Assembler le panneau (P1) et le panneau (Q1) au panneau (R). Tourner les écrous minifix pour serrer les vis minifix comme indiqué ci-dessus.

Step 14 ←

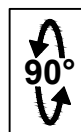

Step 13
Étape 13

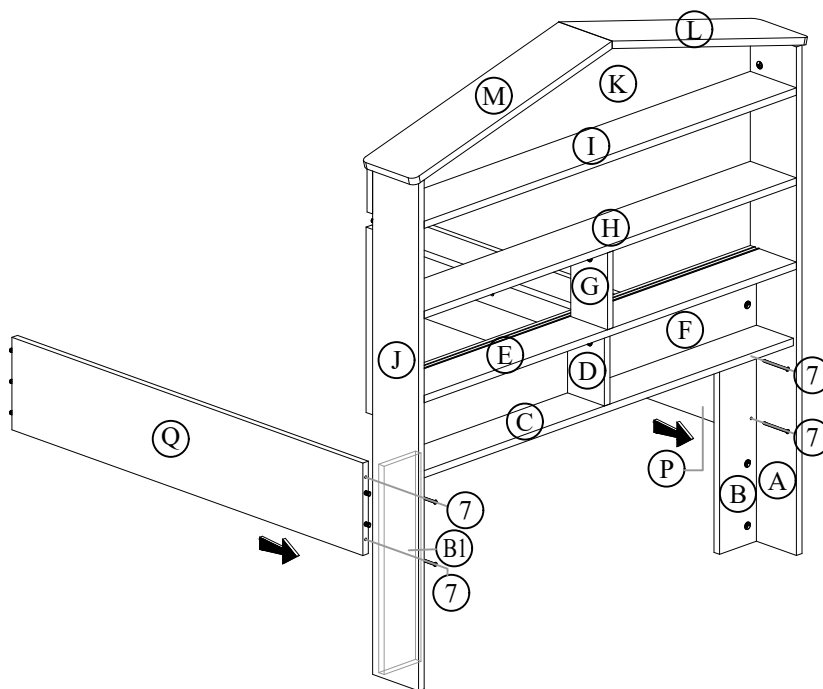

- **Using M6x70mm screws (7), assemble Panel (P) & (Q) to Panel (B) & (B1). Secure tightly.**
A l'aide de vis M6x70mm (7), assembler les panneaux (P) & (Q) aux panneaux (B) & (B1). Fixer fermement.

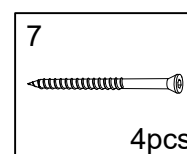

Step 14
Étape 14

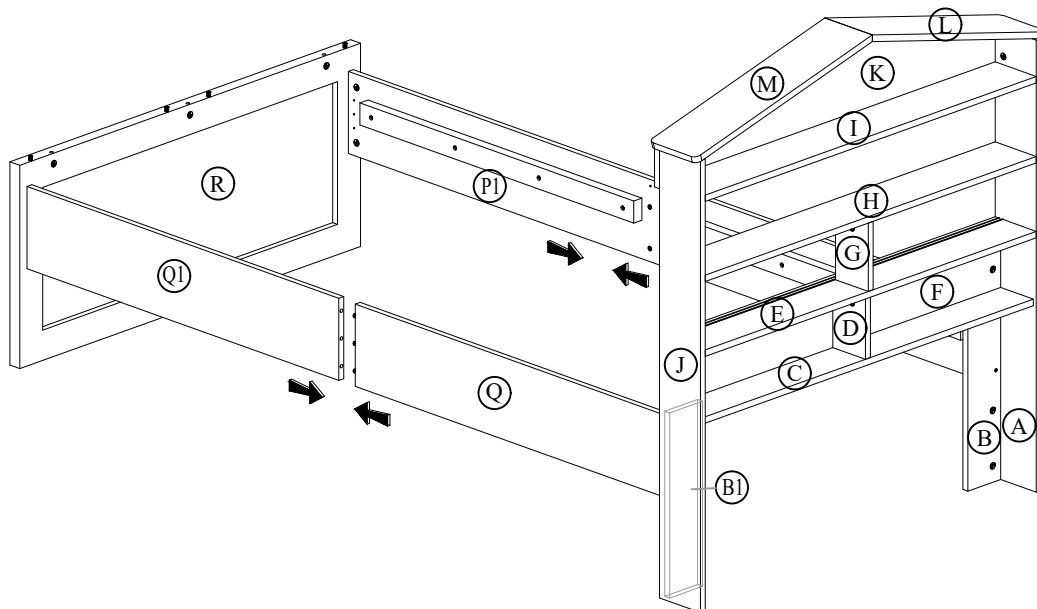

- From Step 12, Rotate 90° & combine between Panel (P) & (PI) followed by Panel (Q) & (QI). Make sure they are well-fitted each other.
À partir de l'étape 12, tourner de 90° et combiner les panneaux (P) et (PI), puis les panneaux (Q) et (QI). S'assurer qu'ils sont bien ajustés l'un à l'autre.

Step 15
Étape 15

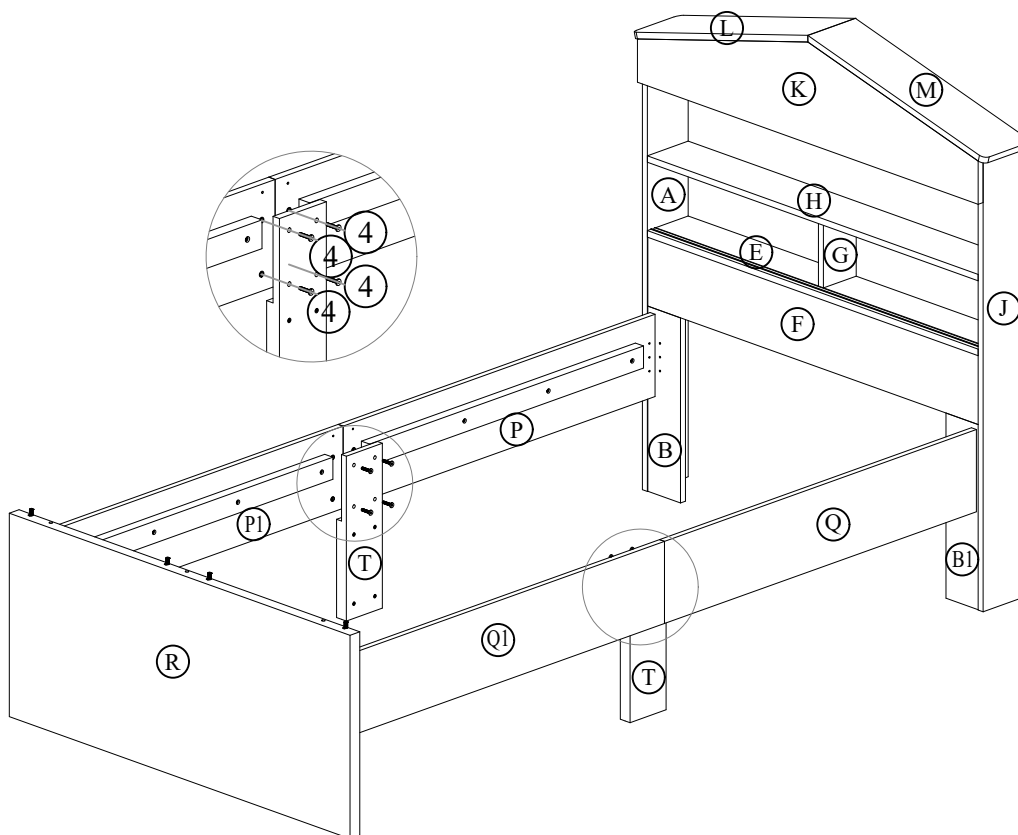

- To strengthen the side panel, add Panel (T) to each side & use M6x25mm Bolt screw (4) to secure the panels.
Pour renforcer le panneau latéral, ajoutez le panneau (T) de chaque côté et utilisez les vis M6x25mm (4) pour fixer les panneaux.

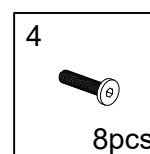

Step 16
Étape 16

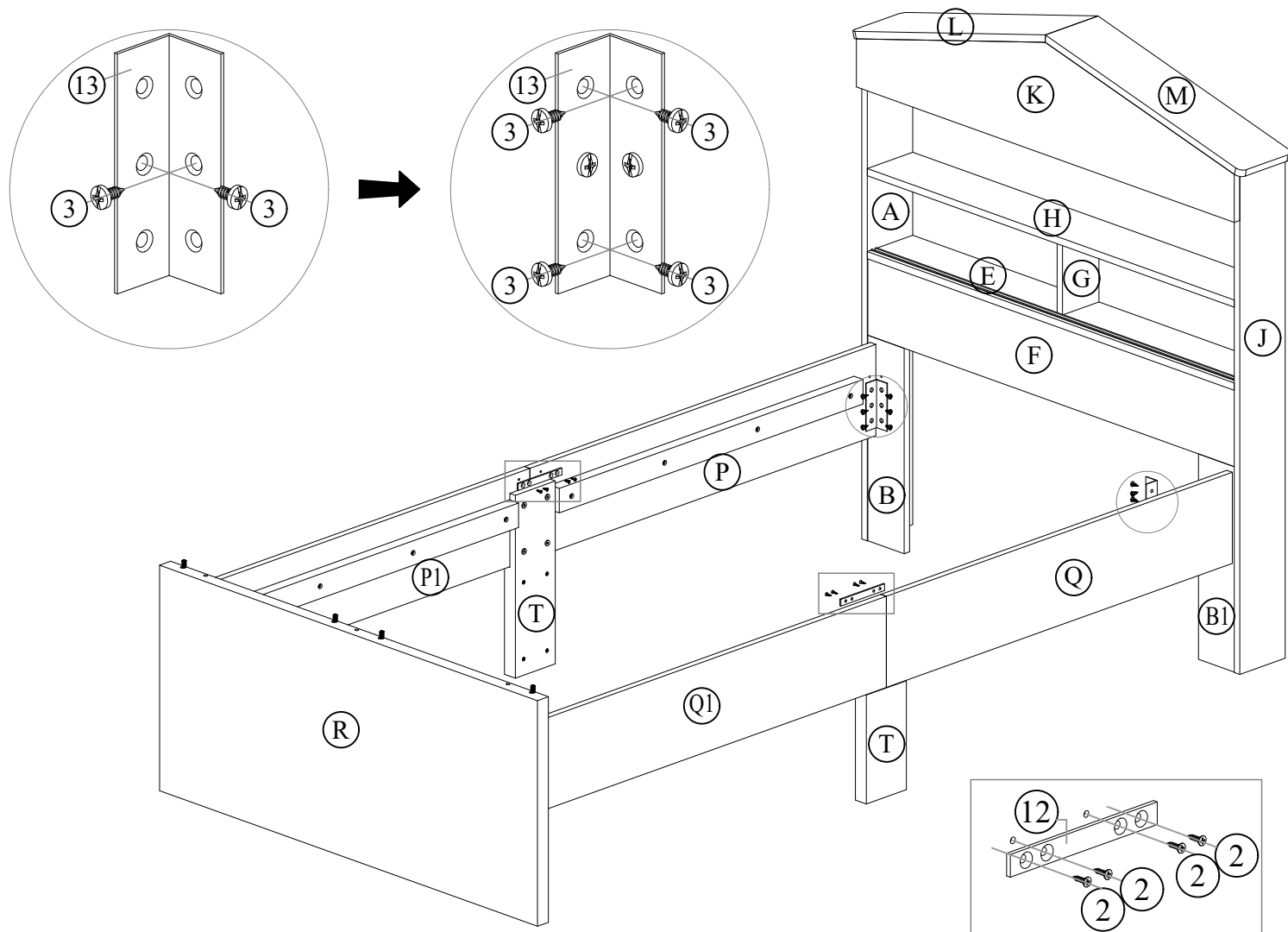

- Install Metal Support ⑫ in between Panel ⑰ & ⑰① followed by Panel ①① & ①①①. Secure them with M3.5x14mm screws ② tightly. Then, install L-Bracket ⑬ to Panel ②, ⑰, ②① & ① using TP10#x1/2" screw ③ to secure them.

Installer le support métallique ⑫ entre les panneaux ⑰ et ⑰①, puis les panneaux Panneau ①① & ①①①. Fixez-les avec des vis M3.5x14mm ② fermement. Ensuite, installer le support en L ⑬ sur les panneaux ②, ⑰, ②① et ① en utilisant des vis TP10#x1/2" ③ pour les fixer.

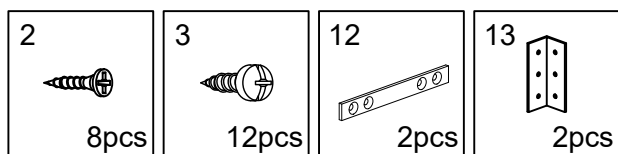

Step 17 ←





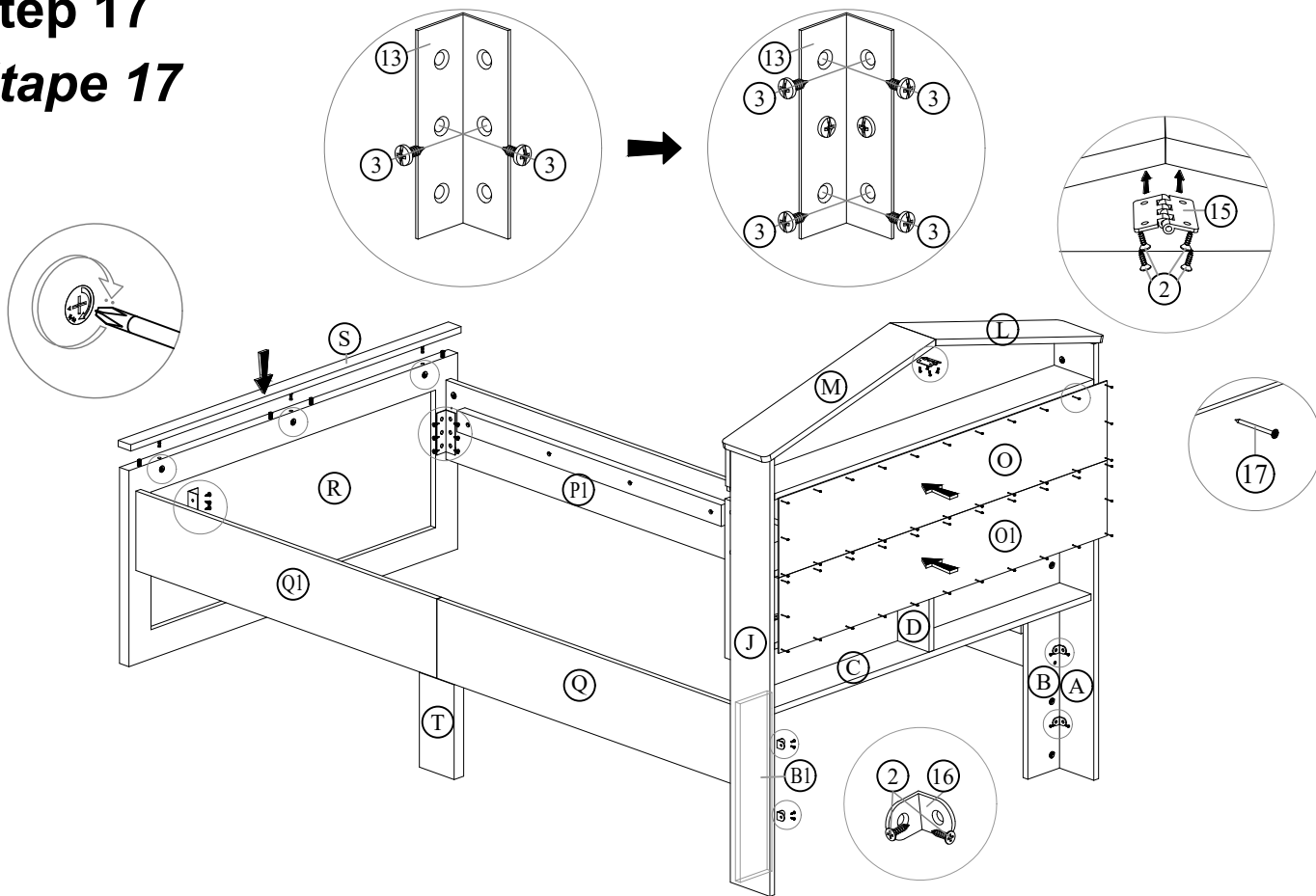

Step 17 Étape 17



- Rotate 90°, install L-Bracket (13) to Panel (R), (PI) & (QI) . Secure with TP10#x1/2" screws (3) . Next, assembly Panel (S) to Panel (R) by rotate the minifix nuts to tighten the minifix screws as shown above.
Tourner de 90°, installer le support en L (13) sur le panneau (R), (PI) & (QI). Fixer avec des vis TP10#x1/2 " (3) . Assembler le panneau (S) sur le panneau (R) en tournant les écrous minifix pour serrer les vis minifix comme indiqué ci-dessus.

- Assembly Panel (O) & (OI) to Panel (A), (E), (H), (I) & (J) . Make sure it is evenly positioned before secure them with nails (17) . Next, install Metal Hinges (15) between Panel (L) & (M) . Secure it with M3.5x14mm screws (2) .
Assemblez les panneaux (O) & (OI) aux panneaux (A), (E), (H), (I) & (J). Assurez-vous qu'ils sont positionnés uniformément avant de les fixer à l'aide de clous (17) . Ensuite, installez les charnières métalliques (15) entre les panneaux (L) et (M) . Fixez-les avec des vis M3.5x14mm (2) .

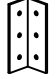
- Install L-bracket (22x18mm) (16) & secure with M3.5x14mm screws (2) at Panel (B) & (B1) .
Installer le support en L (22x18mm) (16) et le fixer avec des vis M3.5x14mm au panneau (B) et (B1) .

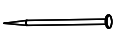
2  12pcs	3  12pcs	13  2pcs	15  1pc	16  4pcs	17  48pcs
---	---	---	--	---	--

Step 18
Étape 18

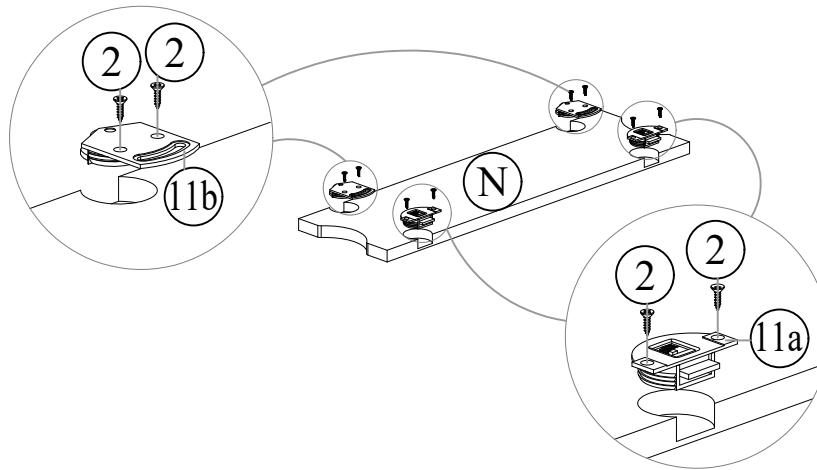

- Install K445 Door Sliding Roller (11) to Panel (N). Use M3.5x14mm screws (2) to secure them. Take note, diameter hole for (11a) is larger than (11b).
Installer le rouleau coulissant de porte K445 (11) sur le panneau (N). Utiliser des vis M3.5x14mm (2) pour les fixer. Attention, le diamètre du trou pour (11a) est plus grand que celui de (11b).

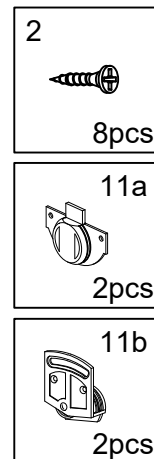

Step 19
Étape 19

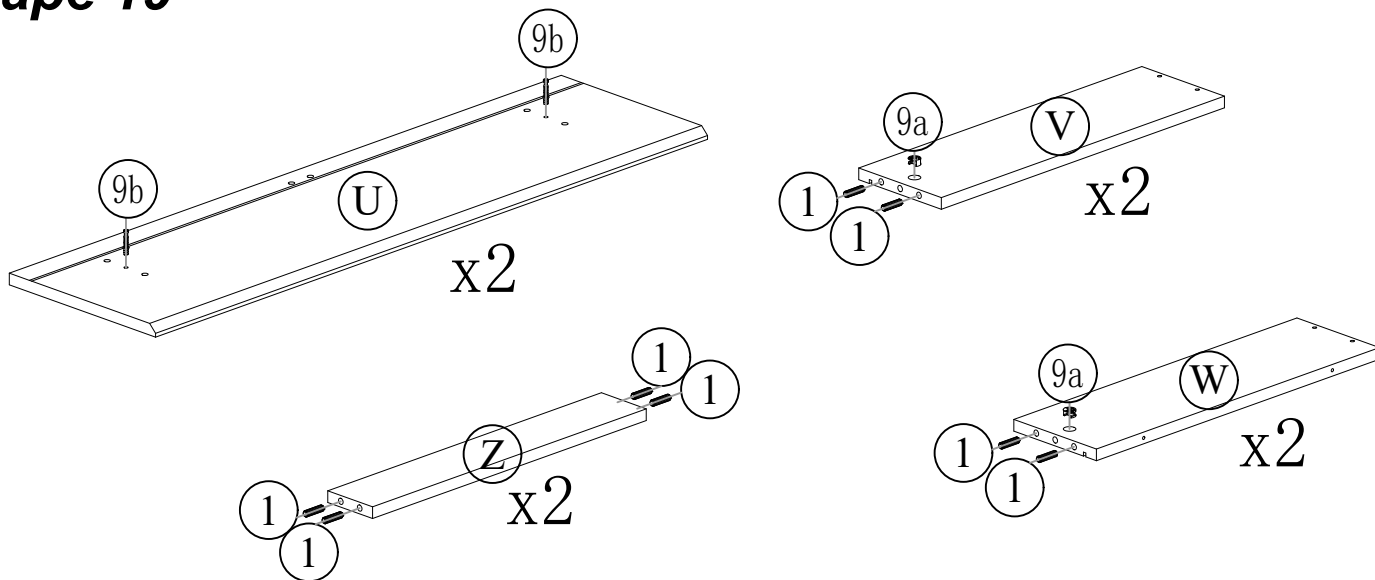

- Install 8x30mm wood dowel (1) to Panel (V), (W) & (Z). Next, install the minifix nuts (9a) to Panel (V) & (W). Install the minifix screws (9b) to Panel (U).
Installer la cheville à bois 8x30mm (1) sur le panneau (V), (W) & (Z). Ensuite, installer les écrous minifix (9a) sur le panneau (V) & (W). Installer les vis minifix (9b) sur le panneau (U).

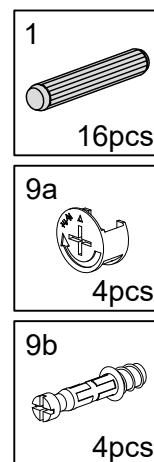

Step 20
Étape 20

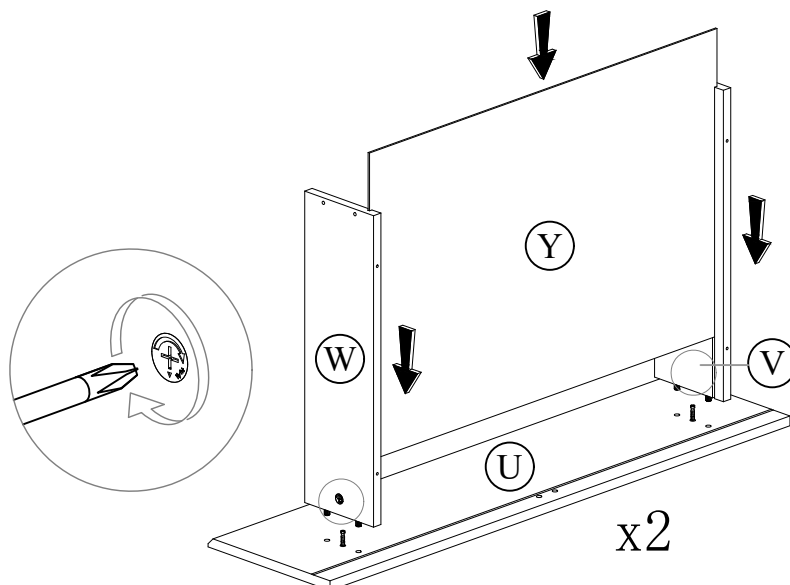

- **Assembly Panel (W) & Panel (V) to Panel (U) . Rotate the minifix nuts to tighten the minifix screws as shown above. Insert Panel (Y) in the groove line at Panel (W) & (V) carefully.**
Assembler le panneau (W) et le panneau (V) au panneau (U) . Tourner les écrous minifix pour serrer les vis minifix comme indiqué ci-dessus. Insérer le panneau (Y) dans la ligne de rainure des panneaux (W) & (V) avec précaution.

Step 21
Étape 21

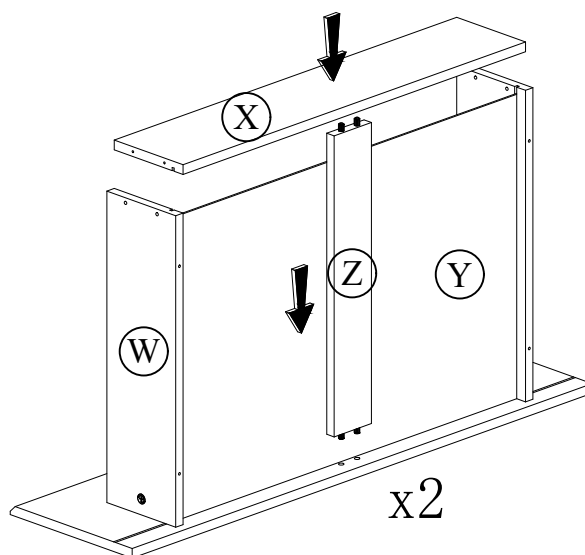

- **Insert Panel (Z) to Panel (U) followed by Panel (X) . Make sure the dowel fit to the hole.**
Insérez le panneau (Z) dans le panneau (U) , puis dans le panneau (X) . Assurez-vous que la cheville s'insère dans le trou.

Step 22
Étape 22

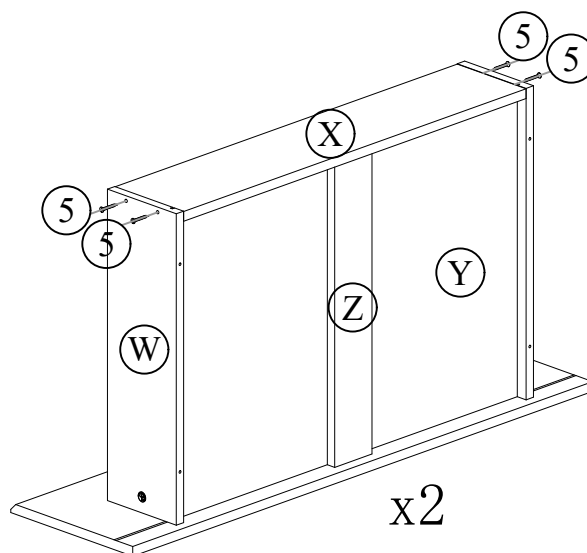

- From Step 21, secure tightly Panel (X) using M4x32mm screws (5) with Panel (V) & (W).
A partir de l'étape 21, fixer solidement le panneau (X) à l'aide de vis M4x32mm (5) avec le panneau (V) & (W).

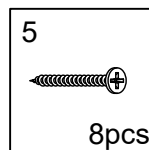

Step 23
Étape 23

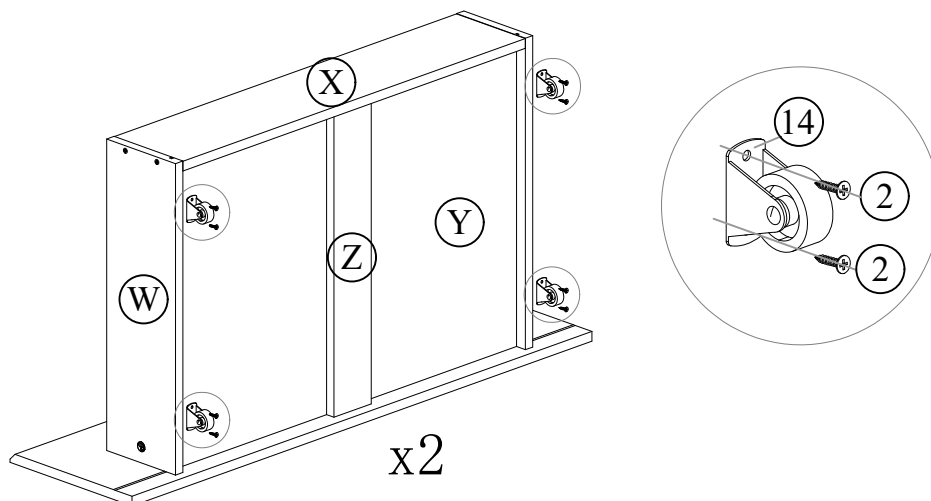

- Install Rigid Caster (14) to Panel (V) & Panel (W). Use M3.5x14mm (2) screws to secure the caster. Make sure the hole is evenly at center position of the panel before tighten the screws.
Installer la roulette rigide (14) sur le panneau (V) et le panneau (W). Utiliser des vis M3.5x14mm (2) pour fixer la roulette.
S'assurer que le trou est bien au centre du panneau avant de serrer les vis.

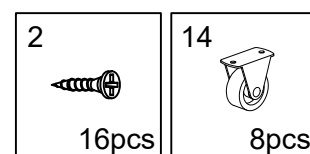

Step 24

Étape 24

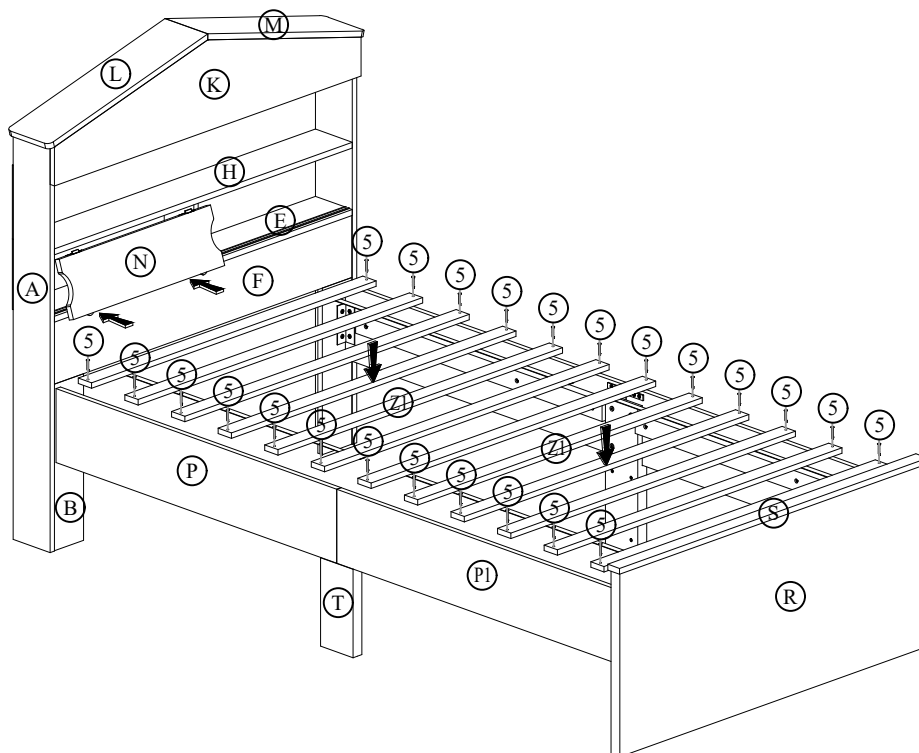
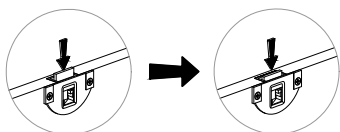
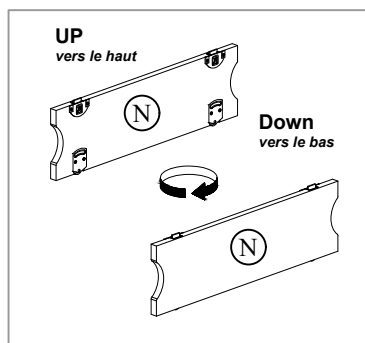

- Assemble Panel (N) as shown above. Make sure position of door sliding roller in a correct position. Then, assemble bed slat (Z1) to Panel (P), (P1), (Q) & (Q1). Secure all panels using M4x32mm screws (5).
Assembler le panneau (N) comme indiqué ci-dessus. S'assurer que la position du rouleau coulissant de la porte est correcte. Assemblez ensuite la latte (Z1) aux panneaux (P), (P1), (Q) et (Q1). Fixez tous les panneaux à l'aide des vis M4x32mm (5).

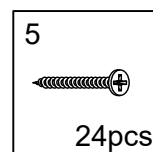

Step 25

Étape 25

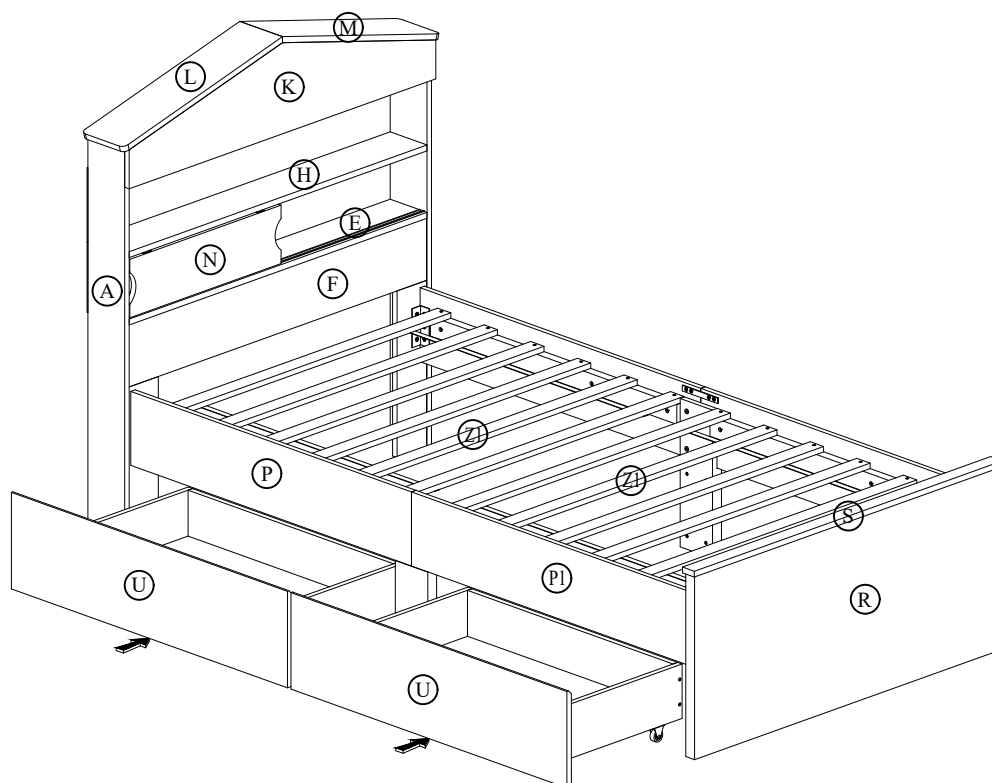

- Insert the drawers under the bed side panel (P) & (P1) properly.
Insérer correctement les tiroirs sous les panneaux latéraux (P) et (P1).

Step 26

Étape 26

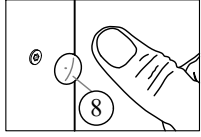

* Cover all the screw (6)(7)'s head with the pvc cap provided by pushing the cover's stem onto the hole of screw head.

* Couvrez toutes les têtes de vis (6)(7) avec le capuchon en pvc fourni en poussant la tige du capuchon sur le trou de la tête de vis.

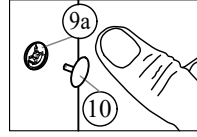

* Cover all the mini fix (nuts) (9a)'s head with the pvc cap provided by pushing the cover's stem onto the hole mini fix (nuts).

* Recouvrir toutes les têtes des mini-fixes (écrous) (9a) avec le bouchon en pvc fourni en poussant la tige du bouchon sur le trou des mini-fixes (écrous).

Complete Compléter

